

Nettleton

FORM 9-1642 (1-68)

Well No. B 33

WELL SCHEDULE

PUNCHED

U. S. DEPT. OF THE INTERIOR

GEOLOGICAL SURVEY

WATER RESOURCES DIVISION

MASTER CARD

Record by B.D. Source of data BOWC Date 3-72 Map MAR 11 1973

State 28 County Mineral Sequential number 48

Latitude: 34 0 44 5 N Longitude: 0 8 8 3 5 2 7 Sequential number: 1

Lat-long accuracy: 1 T 11 N 7 W Sec 32 NE SW SW

Local well number: B 0 3 3 C C 3 2 1 1 5 0 7 E Other number: B & H

Local use: 28 Owner or name:

Owner or name: GLEN RICKS Address: Nettleton

Ownership: County, Fed Gov't, City, Corp or Co, Private, State Agency, Water Dist P

Use of water: (A) (B) (C) (D) (E) (F) (H) (I) (M) (N) (P) (R) (S) (T) (U) (V) (W) (X) (Y) (Z) H

Use of well: (A) (D) (G) (H) (I) (P) (R) (T) (U) (W) (X) (Z) W

DATA AVAILABLE: Well data Freq. W/L meas. Field aquifer char.

Hyd. lab. data: Qual. water data; type: Freq. sampling: Pumpage inventory: Aperture cards: Log data:

WELL-DESCRIPTION CARD

SAME AS ON MASTER CARD Depth well: 229 Meas. rept. accuracy 3

Depth cased: 26 Casing type: Diam. 4

Finish: porous concrete, gravel w. (perf.), gravel w. (screen), horiz. gallery, open end, other X

Method Drilled: air rot, bored, cable, dug, hyd, jetted, air percussion, rotary, reverse, driven, drive wash, other H

Date Drilled: 9 6 2 Pump intake setting: ft 36 38

Driller: James Souler name address

Lift (type): air, bucket, cent, jet, multiple, multiple, none, piston, rot, submerg, turb, other Deep Shallow

Power (type): diesel, elec, gas, gasoline, hand, gas, wind; H.P. Trans. or meter no.

Descrip. MP ft above below LSD, Alt. MP

Alt. LSD: 250 Accuracy: (source) 4

Water Level 40 ft above below MP; Ft below LSD 40 Accuracy: 1

Date meas: 3 6 2 Yield: gpm Method determined

Drawdown: ft Accuracy: Pumping period hrs

QUALITY OF WATER DATA: Iron Sulfate Chloride Hard.

Sp. Conduct K x 10 Temp. Date sampled

Taste, color, etc.

Well No. B 33

Latitude-longitude _____ N _____ S _____ d _____ m _____ s _____

HYDROLOGIC DISTRICT: **PHINCH**
SAME AS ON MASTER CARD

Physiographic Province: _____ Section: **03**

Drainage Basin: **D** Subbasin: **13C**

Topo of well site: **RAM** (C) (E) (P) (H) (K) (L)
depression, stream channel, dunes, flat, hilltop, sink, swamp,
(O) (P) (S) (T) (U) (V)
offshore, pediment, hillside, terrace, undulating, valley flat

MAJOR AQUIFER: **R3** **EZ**
system series aquifer, formation, group

Lithology: **U.S.** Origin: **6** Aquifer Thickness: _____ ft

Length of well open to: _____ ft Depth to top of: _____ ft

MINOR AQUIFER: _____
system series aquifer, formation, group

Lithology: _____ Origin: _____ Aquifer Thickness: _____ ft

Length of well open to: _____ ft Depth to top of: _____ ft

Intervals Screened: _____

Depth to consolidated rock: _____ ft Source of data: _____

Depth to basement: _____ ft Source of data: _____

Surficial material: _____ Infiltration characteristics: _____

Coefficient Trans: _____ gpd/ft Coefficient Storage: _____

Coefficient Perm: _____ gpd/ft²; Spec cap: _____ gpm/ft; Number of geologic cards: _____

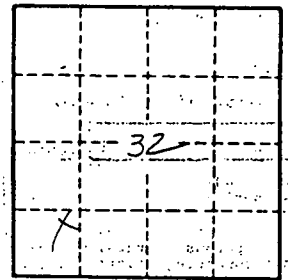

Well No. 033

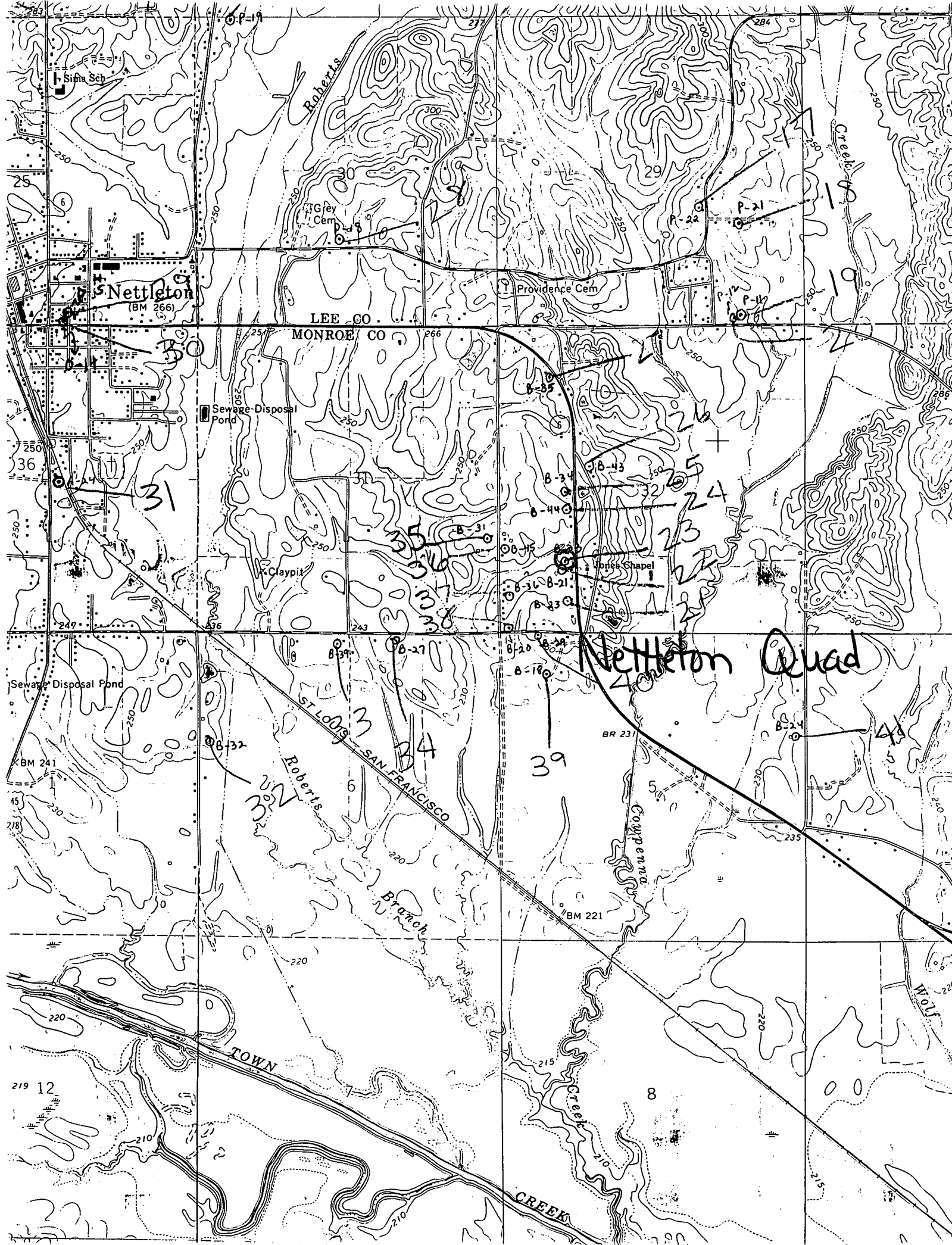

Nettleton
(BM 266)

LEE CO.
MONROE CO

Nettleton Quad

Sewage Disposal Pond

Sewage Disposal Pond

Claypit

Jones Chapel

ST LOUIS
SAN FRANCISCO

Roberts

Roberts Branch

Cooper Creek

Wolf

TOWN

CREEK

219 12

25

36

45

218

219 12

210

210

30

31

32

33

34

35

36

37

38

39

40

41

42

43

44

45

46

P-19

P-20

P-21

P-22

P-23

P-24

P-25

P-26

P-27

P-28

P-29

P-30

P-31

P-32

P-33

P-34

P-19

P-20

P-21

P-22

P-23

P-24

P-25

P-26

P-27

P-28

P-29

P-30

P-31

P-32

P-33

P-34

P-19

P-20

P-21

P-22

P-23

P-24

P-25

P-26

P-27

P-28

P-29

P-30

P-31

P-32

P-33

P-34

P-19

P-20

P-21

P-22

P-23

P-24

P-25

P-26

P-27

P-28

P-29

P-30

P-31

P-32

P-33

P-34

P-19

P-20

P-21

P-22

P-23

P-24

P-25

P-26

P-27

P-28

P-29

P-30

P-31

P-32

P-33

P-34

P-19

P-20

P-21

P-22

P-23

P-24

P-25

P-26

P-27

P-28

P-29

P-30

P-31

P-32

P-33

P-34

P-19

P-20

P-21

P-22

P-23

P-24

P-25

P-26

P-27

P-28

P-29

P-30

P-31

P-32

P-33

P-34

P-19

P-20

P-21

P-22

P-23

P-24

P-25

P-26

P-27

P-28

P-29

P-30

P-31

P-32

P-33

P-34

P-19

P-20

P-21

P-22

P-23

P-24

P-25

P-26

P-27

P-28

P-29

P-30

P-31

P-32

P-33

P-34

P-19

P-20

P-21

P-22

P-23

P-24

P-25

P-26

P-27

P-28

P-29

P-30

P-31

P-32

P-33

P-34

P-19

P-20

P-21

P-22

P-23

P-24

P-25

P-26

P-27

P-28

P-29

P-30

P-31

P-32

P-33

P-34

P-19

P-20

P-21

P-22

P-23

P-24

P-25

P-26

P-27

P-28

P-29

P-30

P-31

P-32

P-33

P-34

P-19

P-20

P-21

P-22

P-23

P-24

P-25

P-26

P-27

P-28

P-29

P-30

P-31

P-32

P-33

P-34

P-19

P-20

P-21

P-22

P-23

P-24

P-25

P-26

P-27

P-28

P-29

P-30

P-31

P-32

P-33

P-34

P-19

P-20

P-21

P-22

P-23

P-24

P-25

P-26

P-27

P-28

P-29

P-30

P-31

P-32

P-33

P-34

P-19

P-20

P-21

P-22

P-23

P-24

P-25

P-26

P-27

P-28

P-29

P-30

P-31

P-32

P-33

P-34