

WELL SCHEDULE

PUNCHED

U. S. DEPT. OF THE INTERIOR

GEOLOGICAL SURVEY

WATER RESOURCES DIVISION

MASTER CARD

MAR 11 1973

Record by J.S. Source of data Flow Date 11/69 Map _____

State 28 County (or town) Monroe 48

Latitude: 34⁰⁸ 04³⁰ 30^W Longitude: 088³⁵ 30^W Sequential number: 1

Lat-long accuracy: 1⁰ T. 11⁰ S. R. 7⁰ W. Sec. 32 NE SE SW SW

Local well number: 9023⁰¹ CC32²⁵ 11³⁰ SO7E³⁴ Other number: _____ B & M

Local use: 021³⁵ _____ Owner or name: _____

Owner or name: L. O. HODGES³² Address: Nettleton, Ms⁶⁶

Ownership: County, Fed Gov't, (C) (F) (H) (N) (P) (S) (W) _____

Use of water: (A) (B) (C) (D) (E) (F) (H) (I) (M) (N) (P) (R) _____

Use of well: (S) (T) (U) (V) (W) (X) (Y) (Z) _____

DATA AVAILABLE: Well data Freq. W/L meas.: Field aquifer char.

Hyd. lab. data: _____

Qual. water data; type: _____

Freq. sampling: _____ Pumpage inventory: yes no period: _____

Aperture cards: _____ yes

Log data: D⁷⁸ 79

WELL-DESCRIPTION CARD

SAME AS ON MASTER CARD Depth well: 220¹⁹ ft Meas. rept accuracy 3²⁴

Depth cased; (first perf.) 60²⁵ ft Casing type: steel²⁸; Diam. 4²⁹ in

Finish: porous concrete, gravel w. (perf.), gravel w. (screen), horiz. gallery, open end, perf., screen, sd. pt., shored, open hole, other

Method Drilled: (A) (B) (C) (D) (H) (J) (P) (R) (T) (V) (W) (Z) other

Date Drilled: 969³³ Pump intake setting: _____ ft 36³⁶

Driller: _____ name _____ address _____

Lift (type): (A) (B) (C) (J) (L) (M) (N) (P) (R) (S) (T) (Z) other Deep Shallow

Power (type): diesel, elec, gas, gasoline, hand, gas, wind; H.P. 3/4³⁹ Trans. or meter no. S⁴¹

Descrip. MP _____ ft above below LSD, Alt. MP _____

Alt. LSD: 260⁴² Accuracy: (source) 4⁴⁷

Water Level 61⁴² ft above below MP; Ft. above below LSD 67⁴⁸ Accuracy: D⁵²

Date meas: 869⁵³ Yield: _____ gpm 4⁵⁶ Method determined

Drawdown: _____ ft Accuracy: _____ Pumping period _____ hrs _____

QUALITY OF WATER DATA: Iron _____ ppm Sulfate _____ ppm Chloride _____ ppm Hard. _____ ppm

Sp. Conduct _____ K x 10⁶ Temp. _____ °F Date sampled _____

Taste, color, etc. _____

Well No.

B23

Monroe
B23
8-69

48 3

MISSISSIPPI
BOARD OF WATER COMMISSIONERS
416 North State Street
Jackson, Mississippi 39201

CODED

WATER WELL DRILLERS LOG

8-6 1969 Herndon-Homan Well Supply Monroe
date well completed firm name county well located

LANDOWNER:	description of formations encountered	from	to
G. Q. Hodges	Surface soil & clay	0	55
Nittleton, Miss	Blue clay	55	100
NW 65 9632744	Sand	100	220
(mailing address)	Bottom	220	
WELL LOCATION:			
sec 22 T 11 N R 7 E			
1 miles E of Nittleton			
(distance) (direction) (nearest town)			
WELL PURPOSE: Home			
(home, irrigation, municipal, industrial)			
WELL COMPLETION DATA:			
(1) diameter (inches) 4"			
(2) total depth (feet) 230'			
(3) static water level (feet) 61 below top of ground.			
(4) casing Steel 60' (material) (depth)			
4" (size) if telescope see back.			
(5) screen no (length) (depth to top)			
(6) pump 3/4 (HP) 1/2 (yield gpm)			
Electric (type power)			
(7) electric log no (yes or no)			
(organization running log)			
(8) how well bottom plugged open			
DRILLERS REMARKS:			

CODED

SEP 4 1969
MISS. BD. OF WATER COMMISSIONERS

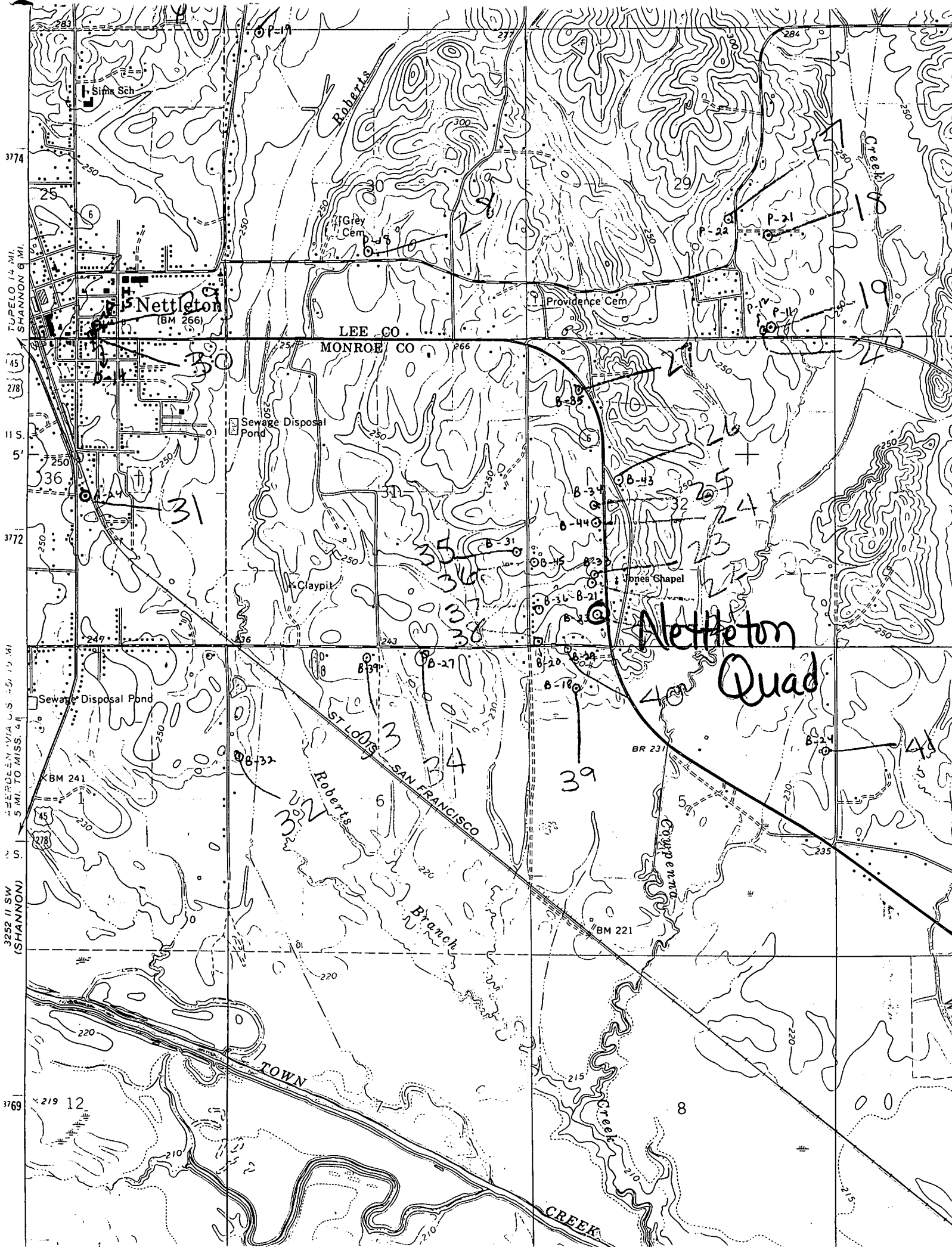

3774
TUPELO 14 MI.
SHANNON 8 MI.
15
278
11 S.
5'
3772
3250 11 SW
(SHANNON)
3769

Nettleton
(BM 266)

LEE CO.
MONROE CO

Nettleton
Quad

Sewage Disposal Pond

Sewage Disposal Pond

Sewage Disposal Pond

ST. LOUIS
BRANCH
SAN FRANCISCO

Roberts
Creek

Carpenter
Creek

Creek

CREEK

Grey Cem

Providence Cem

Jones Chapel

Sims Sch

Claypit

BM 241

BM 221

BM 266

3774

15

278

11 S.

5'

3772

3250 11 SW

(SHANNON)

3769

3769

3769

3769

3769

3769

3769

3769

BM 266

BM 241

BM 221

Sims Sch

Claypit

BM 241

BM 221

BM 266

3774

15

278

11 S.

5'

3772

3250 11 SW

(SHANNON)

3769

3769

3769

3769

3769

3769

3769

3769

BM 266

BM 241

BM 221

Sims Sch

Claypit

BM 241

BM 221

BM 266

3774

15

278

11 S.

5'

3772

3250 11 SW

(SHANNON)

3769

3769

3769

3769

3769

3769

3769

3769

BM 266

BM 241

BM 221

Sims Sch

Claypit

BM 241

BM 221

BM 266

3774

15

278

11 S.

5'

3772

3250 11 SW

(SHANNON)

3769

3769

3769

3769

3769

3769

3769

3769

BM 266

BM 241

BM 221

Sims Sch

Claypit

BM 241

BM 221

BM 266

3774

15

278

11 S.

5'

3772

3250 11 SW

(SHANNON)

3769

3769

3769

3769

3769

3769

3769

3769

BM 266

BM 241

BM 221

Sims Sch

Claypit

BM 241

BM 221

BM 266

3774

15

278

11 S.

5'

3772

3250 11 SW

(SHANNON)

3769

3769

3769

3769

3769

3769

3769

3769

BM 266

BM 241

BM 221

Sims Sch

Claypit

BM 241

BM 221

BM 266

3774

15

278

11 S.

5'

3772

3250 11 SW

(SHANNON)

3769

3769

3769

3769

3769

3769

3769

3769

BM 266

BM 241

BM 221

Sims Sch

Claypit

BM 241

BM 221

BM 266

3774

15

278

11 S.

5'

3772

3250 11 SW

(SHANNON)

3769

3769

3769

3769

3769

3769

3769

3769

BM 266

BM 241

BM 221

Sims Sch

Claypit

BM 241

BM 221

BM 266

3774

15

278

11 S.

5'

3772

3250 11 SW

(SHANNON)

3769

3769

3769

3769

3769

3769

3769

3769

BM 266

BM 241

BM 221

Sims Sch

Claypit

BM 241

BM 221

BM 266

3774

15

278

11 S.

5'

3772

3250 11 SW

(SHANNON)

3769

3769

3769

3769

3769

3769

3769

3769

BM 266

BM 241

BM 221

Sims Sch

Claypit

BM 241

BM 221

BM 266

3774

15

278

11 S.

5'

3772

3250 11 SW

(SHANNON)

3769

3769

3769

3769

3769

3769

3769

3769

BM 266

BM 241

BM 221

Sims Sch

Claypit

BM 241

BM 221

BM 266

3774

15

278

11 S.

5'

3772

3250 11 SW

(SHANNON)

3769

3769

3769

3769

3769

3769

3769

3769

BM 266

BM 241

BM 221

Sims Sch

Claypit

BM 241

BM 221

BM 266

3774

15

278

11 S.

5'

3772

3250 11 SW

(SHANNON)

3769

3769

3769

3769

3769

3769

3769

3769

BM 266

BM 241

BM 221

Sims Sch

Claypit