

Nettleton

FORM 9-1642 (1-68)

Well No. B 18

PUNCHED

WELL SCHEDULE

U. S. DEPT. OF THE INTERIOR

GEOLOGICAL SURVEY

WATER RESOURCES DIVISION

MASTER CARD

MAR 11 1973

Record by B.D. Source of data Bowc Date 7-71 Map

State 28 County (or town) Mineral 48

Latitude: 34 04 57 N Longitude: 08 83 10 W

Lat-long accuracy: 1 T 12 S R 7 D W, Sec 5 NW SE NW

Local well number: B 01 8 B B 05 1 2 5 0 7 E Other number:

Local use: 0 2 1 Owner or name:

Owner or name: AUBREY PLUNKETT Address: Nettleton

Ownership: County, Fed Gov't, City, Corp or Co, Private, State Agency, Water Dist P

Use of Air cond, Bottling, Comm, Dewater, Power, Fire, Dom, Irr, Med, Ind, P S, Rec, water:

Stock, Inatit, Unused, Repressure, Recharge, Desal-P.S, Desal-other, Other H

Use of well: Anode, Drain, Seismic, Heat Res, Obs, Oil-gas, Recharge, Test, Unused, Withdraw, Waste, Destroyed. W

DATA AVAILABLE: Well data Freq. W/L meas.: Field aquifer char.

Hyd. lab. data:

Qual. water data; type:

Freq. sampling: Pumpage inventory: no, period:

Aperture cards: yes

Log data: D

WELL-DESCRIPTION CARD

SAME AS ON MASTER CARD Depth well: 190 Meas. rept accuracy 3

Depth cased: 63 Casing type: steel Diam: 5

Finish: porous gravel w. gravel w. horiz. open perf., screen, sd. pt., shored, open hole X

Method Drilled: air bored, cable, dug, hyd jetted, air rot., percussion, rotary, other H

Date Drilled: 9 7 1 Pump intake setting: ft

Driller: H H name address

Lift (type): air, bucket, cent, jet, multiple, multiple, open, none, piston, rot, submerg, turb, other Deep Shallow

Power (type): diesel, elec, gas, gasoline, hand, gas, wind; H.P. 5 Trans. or meter no.

Descrip. MP above ft below LSD, Alt. MP

Alt. LSD: 245 Accuracy: (source) 4

Water Level: 16 ft above below MP; 16 ft below LSD Accuracy: D

Date meas: 7 7 1 Yield: 10 gpm Method determined

Drawdown: Accuracy: Pumping period hrs

QUALITY OF WATER DATA: Iron Sulfate Chloride Hard. ppm

Sp. Conduct K x 10 Temp. Date sampled

Taste, color, etc.

Well No.

B 18

Latitude-longitude _____ N _____ S _____ d _____ m _____ s _____

HYDROLOGIC CARD

SAME AS ON MASTER CARD

Physiographic Province: _____

Section: 03

Drainage Basin: D

Subbasin: 13C

Topo of well site: (D) depression, stream channel, dunes, flat, hilltop, sink, swamp, (E) offshore, pediment, hillside, terrace, undulating, valley-flat

MAJOR AQUIFER:

K3

EZ

Lithology: _____

Origin: _____

Origin: 6

Thickness: 105 ft

Length of well open to: 105 ft

Depth to top of: 85 ft

MINOR AQUIFER:

Lithology: _____

Origin: _____

Thickness: _____ ft

Length of well open to: _____ ft

Depth to top of: _____ ft

Intervals Screened:

Depth to consolidated rock: _____ ft

Source of data: _____

Depth to basement: _____ ft

Source of data: _____

Surficial material: _____

Infiltration characteristics: _____

Coefficient Trans: _____ gpd/ft

Coefficient Storage: _____

Coefficient Perm: _____ gpd/ft²

Spec cap: _____ gpm/ft; Number of geologic cards: _____

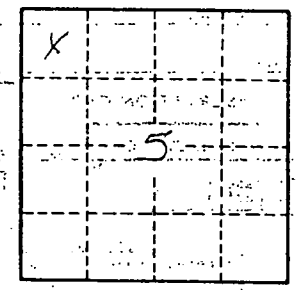

Well No. 1718

MONROE
BIB
7-1-71
7-1

MISSISSIPPI
BOARD OF WATER COMMISSIONERS
416 North State Street
Jackson, Mississippi 39201

CODED

WATER WELL DRILLERS LOG

Herndon-Homan Well & Supply, Inc.

data well completed 19 71 F. O. Box 12 Monroe county well located
SEARNOX MISSISSIPPI 38888

LANDOWNER: Dorsey Plunkett
Box 50 HW 6E 9632074
Natchitoches, Miss.
(mailing address)

description of formations encountered	from	to
<u>Five feet sand & clay</u>	<u>0</u>	<u>59</u>
<u>Blue clay</u>	<u>59</u>	<u>85</u>
<u>Sand</u>	<u>85</u>	<u>190</u>
<u>Bottom</u>	<u>190</u>	

WELL LOCATION:
sec. 5 T. 12 R. 7E
1 miles SE of Natchitoches
(distance) (direction) (nearest town)

WELL PURPOSE: Home
(home, irrigation, municipal, industrial)

- WELL COMPLETION DATA:
- diameter (inches) 5"
 - total depth (feet) 190'
 - static water level (feet) 16 below above top of ground.
 - casing Steel 13' (material) (depth)
5' (size) if telescope see back.
 - screen no (length) (depth to top)
(size) (material)
 - pump 1/2 10 (HP) (yield gpm)
electric (type power)
 - electric log no (yes or no)
(organization running log)
 - how well bottom plugged open

CODED

JUL 7 1971

MISS. Bd. OF WATER COMMISSIONERS

DRILLERS REMARKS:

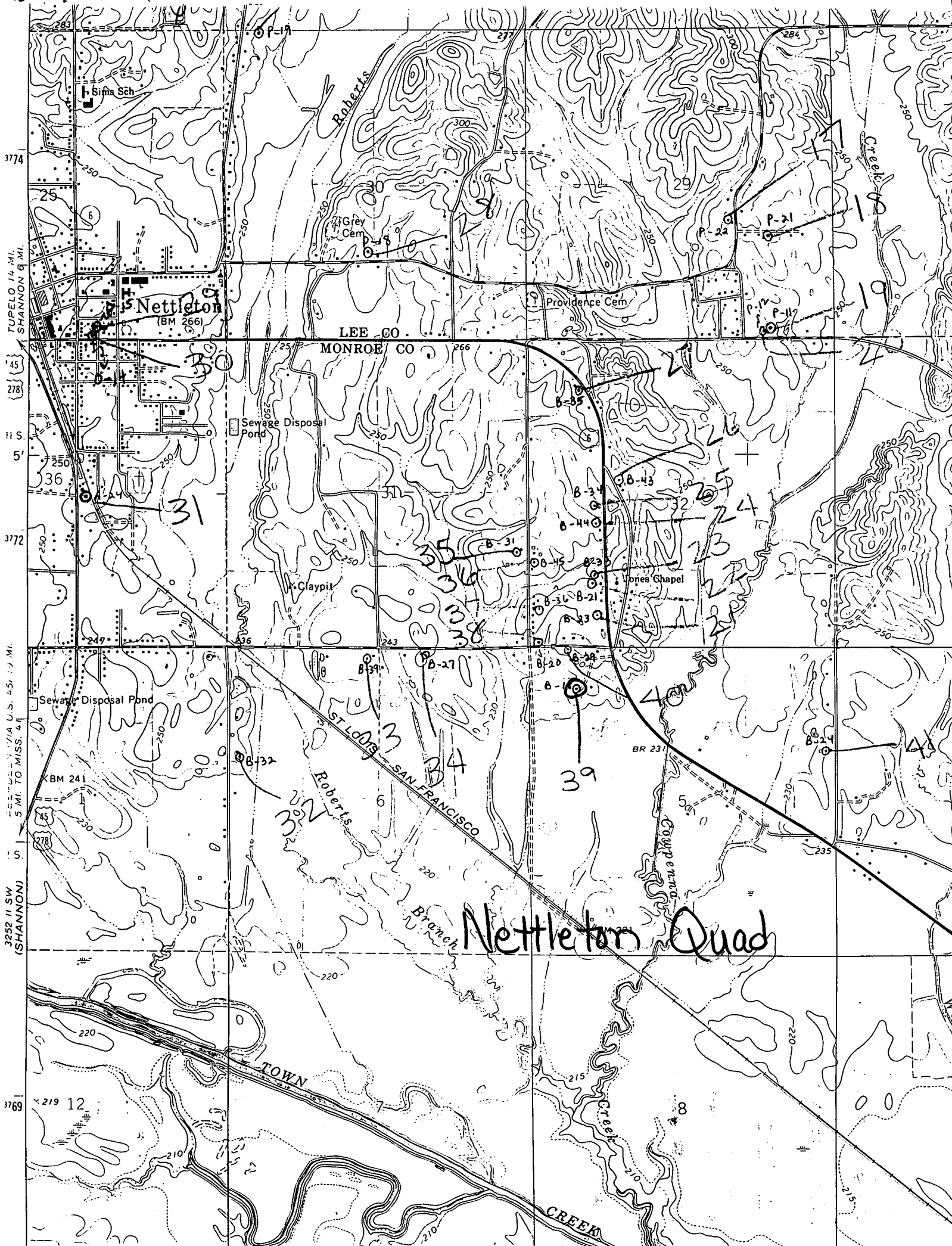

3774
TUPALO 14 MI.
SHANNON 9 MI.
45
278
11 S.
5'
3772
36
31
3770
5 MI. TO MISS. 41
5
3252 II SW (SHANNON)
3769

LEE CO.
MONROE CO.

Nettleton Quad

ST. LOUIS
SAN FRANCISCO
Robert's Branch

Nettleton
(BM 266)

Sewage Disposal Pond

Sewage Disposal Pond

Claypit

Jones Chapel

TOWN

CREEK