

### WELL SCHEDULE

U. S. DEPT. OF THE INTERIOR

GEOLOGICAL SURVEY

WATER RESOURCES DIVISION

#### MASTER CARD

Record by Grantham Taylor Source of data Observation Date 4-24-63 Map \_\_\_\_\_

State Mississippi 28 County (or town) Marion 46

Latitude: 31° 08' 33" N Longitude: 089° 40' 16" W Sequential number: 1

Lat-long accuracy: 3' T. 2 S. R. 17 E. Sec. 12 SW SW

Local well number: P027CC1202N17W Other number: \_\_\_\_\_ B & M

Local use: \_\_\_\_\_ Owner or name: Marion Kelly

Owner or name: MARION KELLY Address: \_\_\_\_\_

Ownership: County, Fed Gov't, City, Corp or Co, Private, State Agency, Water Dist \_\_\_\_\_ P

Use of water: (A) Air cond, Bottling, Comm, Dewater, Power, Fire, Dom, Irr, Med, Ind, P S, Rec, (B) Stock, Instit, Unused, Repressure, Recharge, Desal-P S, Desal-other, Other \_\_\_\_\_ H

Use of well: (A) Anode, Drain, Seismic, Heat Res, Obs, Oil-gas, Recharge, Test, Unused, Withdraw, Waste, Destroyed \_\_\_\_\_ W

DATA AVAILABLE: Well data \_\_\_\_\_ Freq. W/L meas.: \_\_\_\_\_ N Field aquifer char. \_\_\_\_\_

Hyd. lab. data: \_\_\_\_\_

Qual. water data; type: \_\_\_\_\_

Freq. sampling: \_\_\_\_\_ Pumpage inventory: \_\_\_\_\_ yes \_\_\_\_\_ no \_\_\_\_\_ period: \_\_\_\_\_

Aperture cards: \_\_\_\_\_ yes \_\_\_\_\_

Log data: \_\_\_\_\_

#### WELL-DESCRIPTION CARD

SAME AS ON MASTER CARD Depth well: 20' ft 20 Meas. rept \_\_\_\_\_ accuracy \_\_\_\_\_ 6

Depth cased: \_\_\_\_\_ ft \_\_\_\_\_ Casing type: \_\_\_\_\_; Diam. \_\_\_\_\_ in \_\_\_\_\_

Finish: porous concrete, gravel w. (perf.), gravel w. (screen), horiz. gallery, open end, perf., screen, sd. pt., shored, open hole, other \_\_\_\_\_ 31

Method Drilled: (A) air bored, (B) cable, (C) dug, (D) hyd jetted, (E) air rot, (F) reverse, (G) trenching, (H) driven, (I) drive wash, (J) other \_\_\_\_\_ 32

Date Drilled: ? Pump intake setting: \_\_\_\_\_ ft \_\_\_\_\_

Driller: \_\_\_\_\_ name \_\_\_\_\_ address \_\_\_\_\_

Lift (type): (A) air, (B) bucket, (C) cent, (D) jet, (E) multiple, (F) multiple, (G) none, (H) piston, (I) rot, (J) submerg, (K) turb, (L) other \_\_\_\_\_ J Deep \_\_\_\_\_ Shallow \_\_\_\_\_ S

Power (type): diesel, elec, gas, gasoline, hand, gas, wind; H.P. 1/2 Trans. or meter no. \_\_\_\_\_ S

Descrip. MP \_\_\_\_\_ ft above \_\_\_\_\_ below LSD, Alt. MP \_\_\_\_\_

Alt. LSD: \_\_\_\_\_ Accuracy: \_\_\_\_\_ (source) \_\_\_\_\_ 47

Water Level: \_\_\_\_\_ ft above \_\_\_\_\_ below MP; \_\_\_\_\_ ft above \_\_\_\_\_ below LSD \_\_\_\_\_ Accuracy: \_\_\_\_\_ 52

Date meag: \_\_\_\_\_ Yield: \_\_\_\_\_ gpm \_\_\_\_\_ Method determined \_\_\_\_\_ 61

Drawdown: \_\_\_\_\_ ft \_\_\_\_\_ Accuracy: \_\_\_\_\_ Pumping period \_\_\_\_\_ hrs \_\_\_\_\_ 68

QUALITY OF WATER DATA: Iron \_\_\_\_\_ ppm \_\_\_\_\_ Sulfate \_\_\_\_\_ ppm \_\_\_\_\_ Chloride \_\_\_\_\_ ppm \_\_\_\_\_ Hard. \_\_\_\_\_ ppm \_\_\_\_\_ 72

Sp. Conduct \_\_\_\_\_ K x 10<sup>6</sup> \_\_\_\_\_ Temp. \_\_\_\_\_ °F \_\_\_\_\_ Date sampled \_\_\_\_\_ 77 79

Taste, color, etc. Good

Well No. P27

Latitude-longitude \_\_\_\_\_  
d m s d m s

HYDROGEOLOGIC CARD

SAME AS ON MASTER CARD 03 Section: \_\_\_\_\_  
 Province: \_\_\_\_\_  
D Drainage Basin: 13U Subbasin: \_\_\_\_\_  
 (D) (C) (E) (F) (H) (K) (L)  
 Topo of well site: depression, stream channel, dunes, flat, hilltop, sink, swamp,  
 (Ø) (P) (S) (T) (U) (V) offshore, pediment, hillside, terrace, undulating, valley flat \_\_\_\_\_  
 MAJOR AQUIFER: \_\_\_\_\_ system \_\_\_\_\_ series TP \_\_\_\_\_ aquifer, formation, group CI  
 Lithology: \_\_\_\_\_ Origin: \_\_\_\_\_ Aquifer Thickness: \_\_\_\_\_ ft  
 Length of well open to: \_\_\_\_\_ ft \_\_\_\_\_ Depth to top of: \_\_\_\_\_ ft \_\_\_\_\_  
 MINOR AQUIFER: \_\_\_\_\_ system \_\_\_\_\_ series \_\_\_\_\_ aquifer, formation, group \_\_\_\_\_  
 Lithology: \_\_\_\_\_ Origin: \_\_\_\_\_ Aquifer Thickness: \_\_\_\_\_ ft  
 Length of well open to: \_\_\_\_\_ ft \_\_\_\_\_ Depth to top of: \_\_\_\_\_ ft \_\_\_\_\_  
 Intervals Screened: \_\_\_\_\_  
 Depth to consolidated rock: \_\_\_\_\_ ft \_\_\_\_\_ Source of data: \_\_\_\_\_  
 Depth to basement: \_\_\_\_\_ ft \_\_\_\_\_ Source of data: \_\_\_\_\_  
 Surficial material: \_\_\_\_\_ Infiltration characteristics: \_\_\_\_\_  
 Coefficient Trans: \_\_\_\_\_ gpd/ft \_\_\_\_\_ Coefficient Storage: \_\_\_\_\_  
 Perm: \_\_\_\_\_ gpd/ft<sup>2</sup>; Spec cap: \_\_\_\_\_ gpm/ft; Number of geologic cards: \_\_\_\_\_

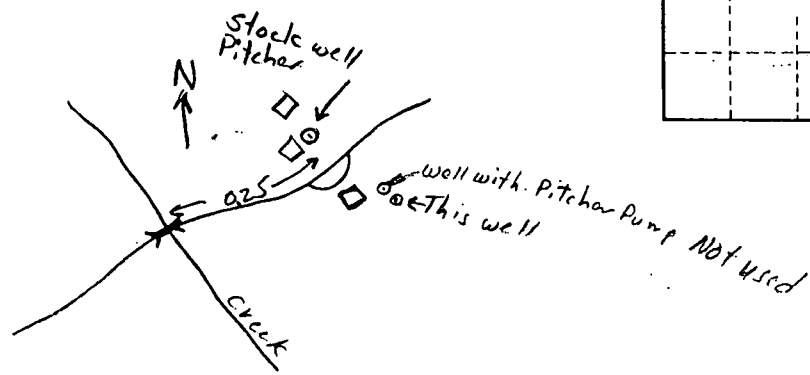
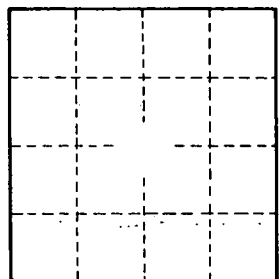

Well No.

P27