

WRD Exp. (GW)  
April 1966

Well No. \_\_\_\_\_

L24 ✓

### WELL SCHEDULE

E Log 61

U. S. DEPT. OF THE INTERIOR

GEOLOGICAL SURVEY

WATER RESOURCES DIVISION

#### MASTER CARD

Record by P.E. Grantham Source of data E Log + Driv. Date 2-3-67 Map \_\_\_\_\_

State Mississippi County 28 (or town) Marion 46

Latitude: 31° 14' 05" N Longitude: 089° 50' 38" W Sequential number: 1

Lat-long accuracy: 3 T, 3 S, R 14 W, Sec 7, SE 1/4, NW 1/4, SE 1/4

Local well number: L0245D0703NLE Other number: \_\_\_\_\_ B & M

Local use: \_\_\_\_\_ Owner or name: Sands Motel

Owner or name: SANDS MOTEL Address: Columbia, Miss

Ownership: County, Fed Gov't, City, Corp or Co, Private, State Agency, Water Dist \_\_\_\_\_ P

Use of water: (A) Air cond, Bottling, Comm, Dewater, Power, Fire, Dom, Irr, Med, Ind, P S, Rec, (S) Stock, Instit, Unused, Repressure, Recharge, Desal-P S, Desal-other, Other \_\_\_\_\_ C

Use of well: (A) Anode, Drain, Seismic, Heat Res, Obs, Oil-gas, Recharge, Test, Unused, Withdraw, Waste, Destroyed, (W) \_\_\_\_\_ W

DATA AVAILABLE: Well data \_\_\_\_\_ Freq. W/L meas.: Original Field aquifer char. \_\_\_\_\_

Hyd. lab. data: \_\_\_\_\_

Qual. water data; type: \_\_\_\_\_

Freq. sampling: \_\_\_\_\_ Pumpage inventory: no period: \_\_\_\_\_

Aperture cards: \_\_\_\_\_

Log data: E Log 9' to 92.5' # 61 \_\_\_\_\_ E

#### WELL-DESCRIPTION CARD

SAME AS ON MASTER CARD Depth well: 738 ft Meas. 738 Meas. rept reported accuracy \_\_\_\_\_

Depth cased: 723 ft Casing type: steel Diam. 4 in \_\_\_\_\_

Finish: (C) porous concrete, (F) gravel w. (perf.), (G) gravel w. (screen), (H) horiz. gallery, (I) open end, (J) perf., (K) screen, (L) sd. pt., (M) shored, (N) open hole, (O) other \_\_\_\_\_ S

Method Drilled: (A) air rot, (B) bored, (C) cable, (D) dug, (E) hyd. rot., (F) jetted, (G) air percussion, (H) rotary, (I) reverse, (J) trenching, (K) driven, (L) drive wash, (M) other \_\_\_\_\_ H

Date Drilled: March 1967 Pump intake setting: 140 ft \_\_\_\_\_ 140

Driller: Dean Griner Columbia, Miss

Lift (type): (A) air, (B) bucket, (C) cent., (D) jet, (E) multiple (cent.), (F) multiple (turb.), (G) none, (H) piston, (I) rot., (J) submerg, (K) turb, (L) other \_\_\_\_\_ S Deep. S Shallow \_\_\_\_\_

Power (type): (A) diesel, (B) elec, (C) nat, (D) gas, (E) gasoline, (F) hand, (G) gas, (H) wind, (I) H.P., (J) LP \_\_\_\_\_ 3 Trans. or meter no. \_\_\_\_\_ T

Descrip. MP top of access hole in casing ft above \_\_\_\_\_ below \_\_\_\_\_ LSD, Alt. MP \_\_\_\_\_

Alt. LSD: 140' EST Accuracy: \_\_\_\_\_ 140

Water Level: +6 ft above MP; \_\_\_\_\_ ft below LSD Accuracy: estimated \_\_\_\_\_ F

Date meas: Apr. 1967 Yield: 40 gpm \_\_\_\_\_ 40 Method determined \_\_\_\_\_

Drawdown: \_\_\_\_\_ ft Accuracy: \_\_\_\_\_ Pumping period \_\_\_\_\_ hrs \_\_\_\_\_

QUALITY OF WATER DATA: Iron \_\_\_\_\_ ppm Sulfate \_\_\_\_\_ ppm Chloride \_\_\_\_\_ ppm Hard. \_\_\_\_\_ ppm

Sp. Conduct 100 K x 10<sup>6</sup> \_\_\_\_\_ Temp. 69.5 °F \_\_\_\_\_ 70 Date sampled \_\_\_\_\_ 267

Taste, color, etc. \_\_\_\_\_

Well No.

L24

Well No. L24

Latitude-longitude N  
S  
d m s d m s

HYDROGEOLOGIC CARD

SAME AS ON MASTER CARD Physiographic Province: Coastal Plain Section: East Gulf

Coastal Plain Drainage Basin: 113V Subbasin:         

Topo of well site: (D) depression, (C) stream channel, (E) dunes, (F) flat, (H) hilltop, (K) sink, (L) swamp, (V) offshore, pediment, hillside, terrace, undulating, valley flat 27

MAJOR AQUIFER: Tertiary, Miocene T.M aquifer, formation, group M:2

Lithology: Unconsolidated S U:3 Origin: Deltaic Aquifer Thickness: 24 ft

24 Length of well open to: 15 ft 115 Depth to top of: 711 ft 711

MINOR AQUIFER:          aquifer, formation, group         

Lithology:          Origin:          Aquifer Thickness:          ft

         Length of well open to:          ft          Depth to top of:          ft         

Intervals Screened: 723 - 738 ft 4" 0.008

Depth to consolidated rock:          ft Source of data:         

Depth to basement:          ft Source of data:         

Surficial material: Sandy Unconsolidated S:U Infiltration characteristics:         

Coefficient Trans:          gpd/ft Coefficient Storage:         

Perm:          gpd/ft<sup>2</sup>; Spec cap:          gpm/ft; Number of geologic cards:         

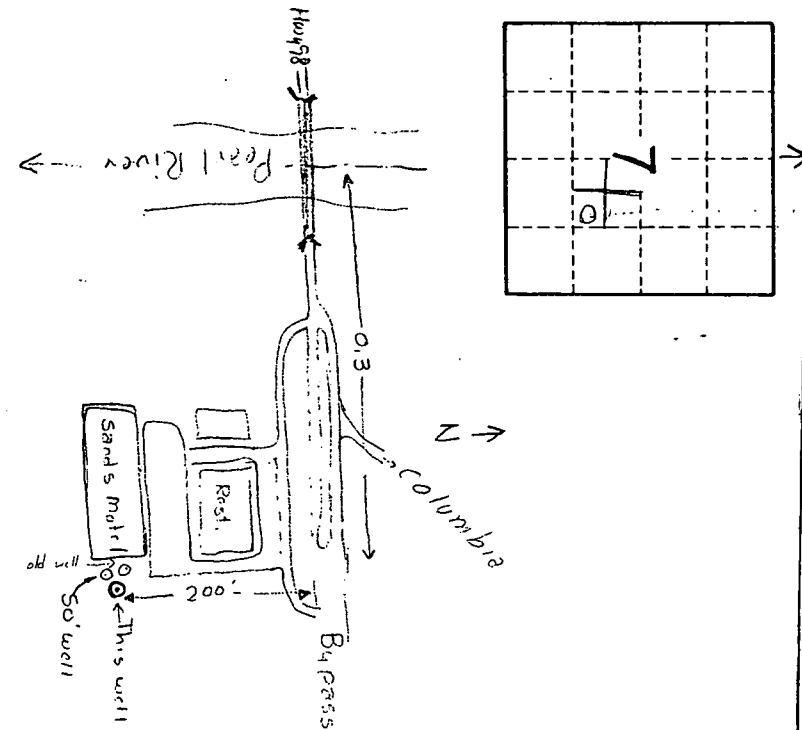

Well No.

L24