

WELL SCHEDULE

U. S. DEPT. OF THE INTERIOR

GEOLOGICAL SURVEY

WATER RESOURCES DIVISION

L1

Plugged and Abandoned

by Griner 6/8/00

TRANSMITTED FOR ADP

MASTER CARD

Record by PEG + WTO Source of data Water Supt. Pete Roberts Date Aug 3, 1965 Map County

State Miss County (or town) 28 Marion 46

Latitude: 311452N Longitude: 0894910 Sequential number: 1

Lat-long accuracy: 30 T 3 S, R 18 Sec 4, NW 1/4, SW 1/4

Local well number: 1001 bc 0403 N18W Other number: B & M

Local use: City of Columbia Owner or name: City of Columbia

Owner or name: COLUMBIA CITY Address: Columbia, Miss.

Ownership: County, Fed Gov't, (M) City, Corp or Co, (N) Private, (P) State Agency, (S) Water Dist M

Use of water: (A) Air cond, (B) Bottling, (C) Comm, (D) Dewater, (E) Power, (F) Fire, (G) Dom, (H) Irr, (I) Med, (J) Ind, (K) Rec, (L) Stock, (M) Instit, (N) Unused, (O) Recharge, (P) Recharge, (Q) Desal-P S, (R) Desal-other, (S) Other P

Use of well: (A) Anode, (B) Drain, (C) Seismic, (D) Heat Res, (E) Obs, (F) Oil-gas, (G) Recharge, (H) Test, (I) Unused, (J) Withdraw, (K) Waste, (L) Destroyed W

DATA AVAILABLE: Well data 70 Freq. W/L meas.: Monthly M Field aquifer char. 71

Hyd. lab. data: 73

Qual. water data; type: Complete Chemical Analysis C 74

Freq. sampling: Original 75 Pumpage inventory: no period: 76

Aperture cards: 77

Log data: 78 79

WELL-DESCRIPTION CARD

SAME AS ON MASTER CARD Depth well: 147 ft 147 Meas. rept 24 6

Depth cased; (first perf.) 25 ft 28 Casing type: 20 23 rept accuracy 29 30 Diam. 20 in 29 30

Finish: porous concrete, gravel w. (perf.), (C) gravel w. (screen), (G) horiz. gallery, (H) open end, (I) open perf., (J) screen, (K) sd. pt., (L) shored, (M) open hole, (N) other 31 3

Method Drilled: (A) air rot, (B) bored, (C) cable, (D) dug, (E) hyd rot, (F) jetted, (G) percussion, (H) rotary, (I) air reverse, (J) trenching, (K) driven, (L) wash, (M) other 32 1

Date Drilled: May 1963 9:6:3 Pump intake setting: 36 ft 38

Driller: Dean Griner Columbia Miss.

Lift (type): (A) air, (B) bucket, (C) cent. jet, (D) multiple, (E) multiple, (F) none, (G) piston, (H) rot, (I) submerg, (J) turb, (K) other 39 T Deep 40

Power (type): diesel, elec, gas, gasoline, hand, gas, wind, H.P. 50 Y Trans. or meter no. 41

Descrip. MP 42 ft above LSD, Alt. MP 43

Alt. LSD: 47 Accuracy: (source) 47

Water Level: -16+ ft above MP; 16 ft below LSD Accuracy: less than 1' Acc 57 3

Date meas: Apr 3, 1965 4:6:5 Yield: 857 gpm 8:5:7 Method determined 61

Drawdown: 67 ft Accuracy: 68 Pumping period 69 hrs 68

QUALITY OF WATER DATA: Iron 0.1 ppm 69 Sulfate 0.2 ppm 70 Chloride 4.3 ppm 71 Hard. 8 72

Sp. Conduct 39 K x 10<sup>6</sup> 0 Temp. 69 °F 69 Date sampled Apr 27, 1966 4:6:6 77 79

Taste, color, etc. 78

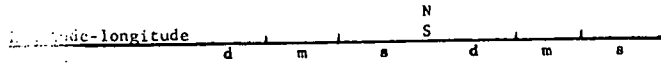

**GEOLOGIC CARD**

REGION MASTER CARD **Physiographic Province: Coastal Plain** **03** Section: **East Gulf**  
 Drainage Basin: **131V** Subbasin:   
 Topography: (D) depression, stream channel, dunes, flat, hilltop, sink, swamp, (E) (F) (H) (K) (L)  
 Well site: (O) offshore, pediment, hillside, terrace, undulating, valley flat (P) (S) (T) (U) (V) **F**  
 MAJOR AQUIFER: **Tertiary** system **Miocene** series **TM** **Undiff. Miocene Sand** aquifer, formation, group **M2**  
 Lithology: **Unconsolidated sd.** **U.S** Origin: **Deltaic** **3** Aquifer Thickness:  ft  
 Length of well open to:  ft Depth to top of:  ft  
 MINOR AQUIFER:  system  series  aquifer, formation, group    
 Lithology:  Origin:  Aquifer Thickness:  ft  
 Length of well open to:  ft Depth to top of:  ft  
 Intervals Screened:   
 Depth to consolidated rock:  ft Source of data:   
 Depth to basement:  ft Source of data:   
 Surficial material:  Infiltration characteristics:   
 Coefficient Trans:  gpd/ft Coefficient Storage:   
 Coefficient Perm:  gpd/ft<sup>2</sup>; Spec cap:  gpm/ft; Number of geologic cards:

Pumping Test

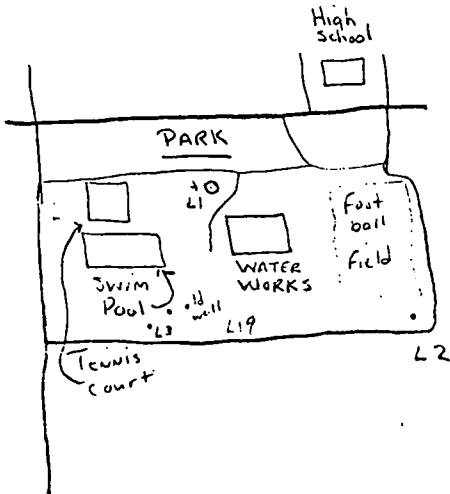
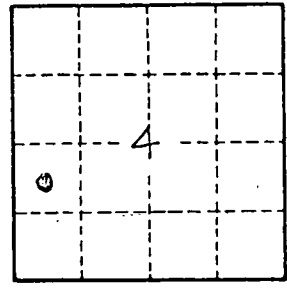

Well No.