

ID 31425089521001

330 ~~AS~~
K5

PUNCHED

WRD Exp. (GW)
April 1966

Well No.

WELL SCHEDULE

U. S. DEPT. OF THE INTERIOR

GEOLOGICAL SURVEY

E log # 5 APR 66
WATER RESOURCES DIVISION
COLUMBIA SOUTH 197

TRANSMITTED FOR ADP

MASTER CARD

Record by WT Oakley Source of data Hub Griner Date 4-66 Map County

State Miss 28 County (or town) Marion 46

Latitude: 31 14 25 N Longitude: 08 95 21 0 Sequential number: 1

Lat-long accuracy: 3 3 13 E Sec 11, NW SW

Local well number: K1005BC1103N13E Other number: B & M

Local use: 184057 766 27 Owner or name: TOWN OF FOXWORTH

Owner or name: FOXWORTH Address: Foxworth, Miss.

Ownership: County, Fed Gov., City, Corp or Co, Private, State Agency, Water Dist M

Use of Air cond, Bottling, Comm, Dewater, Power, Fire, Dom, Irr, Med, Ind, P S, Rec, water: P

Use of well: Anode, Drain, Seismic, Heat Res, Obs, Oil-gas, Recharge, Test, Unused, Withdraw, Waste, Destroyed. W

DATA AVAILABLE: Well data Freq. W/L meas.: Original Field aquifer char. Z

Hyd. lab. data:

Qual. water data; type: USGS complete

Freq. sampling: Original Pumpage inventory: no Period:

Aperture cards:

Log data: Elog to 1050' of drillers DE

WELL-DESCRIPTION CARD

SAME AS ON MASTER CARD Depth well: 1713 ft 713 Meas. E-log 4

Depth cased: 688 ft 688 Casing type: steel Diam. 8-4 in 8

Finish: porous concrete, gravel w. (perf.), (screen), gravel w. gallery, horz. open end, other S

Method Drilled: air rot, bored, cable, dug, hyd. rot, jetted, percussion, air reverse, rotary, trenching, driven, wash, other H

Date Drilled: 4-66 966 Pump intake setting: 9 ft 38

Driller: Hub Griner, Columbia Miss

Lift (type): air, bucket, cent, jet, multiple, multiple, none, piston, rot, submerg, turb, other T Deep Shallow

Power (type): diesel, elec, gas, gasoline, hand, gas, wind; H.P. 15 hp U Trans. or meter no. U

Descrip. MP top of 2' square concrete base at 1.0' below LSD, Alt. MP 1.0'

Alt. LSD: ± 155 155 Accuracy: topo, estimate 6

Water Level: 155 8 ft above below MP; Ft below LSD 8 Accuracy: topo A

Date meas: Jun 1966 666 Yield: 110 gpm 110 Method determined 1

Drawdown: 193 ft 193 Accuracy: topo 2 hrs 2

QUALITY OF WATER DATA: Iron 0.00 Sulfate 9.2 Chloride 2.1 Hard. 8

Sp. Conduct 214 K x 10⁶ 2 Temp. 74 °F 74 Date sampled 7-29-66 766

Taste, color, etc. Field Sp. Cond 220

11/12/81
W-L = +.17
M.P. 1.0
+ 1.7

Well No. 1
K5

Latitude-longitude

HYDROGEOLOGIC CARD

Province: Coastal Plain Section: East Gulf

Drainage Basin: Coastal Plain Subbasin: _____

Topo of well site: (D) depression, stream channel, dunes, (P) flat, hilltop, sink, swamp, offshore, pediment, hillside, terrace, undulating, valley flat

MAJOR AQUIFER: Tertiary system, Miocene series, T.M. aquifer, Catahoula formation, SS group, CA

Lithology: Unconsolidated sd Origin: Deltaic Aquifer Thickness: 22 ft

Length of well open to: 25 ft Depth to top of: 690 ft

MINOR AQUIFER: _____

Lithology: _____ Origin: _____ Aquifer Thickness: _____ ft

Length of well open to: _____ ft Depth to top of: _____ ft

Intervals Screened: 688 - 713 ft. 6" 0.010 SS

Depth to consolidated rock: _____ ft Source of data: _____

Depth to basement: _____ ft Source of data: _____

Surficial material: Sandy Unconsolidated Infiltration characteristics: _____

Coefficient Trans: 2000 gpd/ft 2.02 Coefficient Storage: _____

Coefficient Perm: 100 gpd/ft²; Spec cap: 0.7 gpm/ft; Number of geologic cards: _____

5-15-96
Wk 23.5

- 0-10 top soil
- 10-265 Coarse Sd + Gravel
- 265-365 Blue shale
- 365-391 Sand + Shale
- 391-564 Coarse Sd + Gravel
- 564-625 Shale w/ Sand Breaks
- 625-664 sand w/ shale Breaks
- 664-690 Shale
- 690-712 Sand
- 712-828 Shale w/ Sd Breaks
- 828-866 Sand
- 866-980 Sd + Shale
- 980-1036 Sand
- 1036-1050 Shale

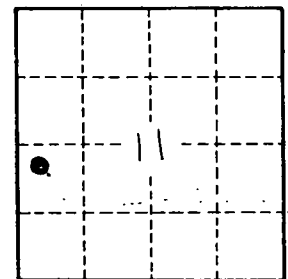
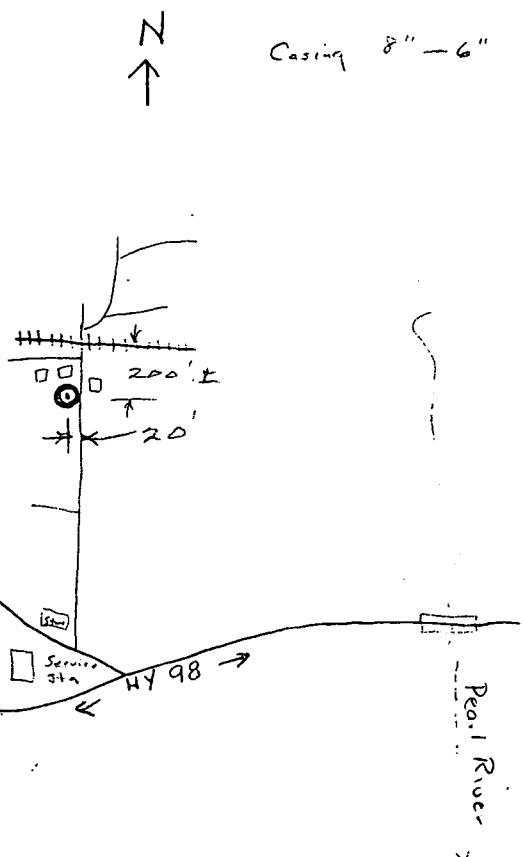

Columbia

Well No.

K5