

U.S. GEOLOGICAL SURVEY
WATER RESOURCES DIVISION
MISSISSIPPI DISTRICT

TRANSMITTED FOR ADP
2/77

(V) Canton Quad
CANTON 2040

10/26/89

137.60

4/17/95

124.49

Record by WTO Date 7-13-76 County Madison Well No. N44

E-log No. 239

GEN. SITE DATA

Site ID

3	2	3	6	5	8	0	9	0	0	1	0	3	0	1
---	---	---	---	---	---	---	---	---	---	---	---	---	---	---

 R= 0 T= (A) M 2= (W) *

Data reliab. 3= (C) U *Report. agency 4= U S G7 S0 *1 Dist. 6= 2 8 *7 5 8 6 *

County 8= 099 * Lat/Long. 9= 32 3 6 5 8 *10= 090 0 1 0 3 *

Well No. 12= N044 * Loc 13= NW NW S 20 T 0 9 N R 0 3 E *

Alt. 16= 240 * Hyd. Unit (OWDC) 20= * *

Date 21= 06/30/1976 * Well use 23= W * Water use 24= P *

Hole depth 27= 1102 * Well depth 28= 892 *

WL 30= 93 * Date 31= 07/30/1976 * Source 33= (D) *

OWNER

R = 158 * T= (A) M * Date 159# 07/30/1976 * Owner No. #6

Owner 161= CANTON *

FIELD QW

R = 192 * T= A M * Date 193# 19 * Additional cards same R thru 193 for each parameter.

Temp. 196# 0 0 0 1 0 * °C 197= * *

Cond. 196# 0 0 0 9 5 * uMhos. 197= * SPRT

pH 196# 0 0 4 0 0 * Value 197= * MU

CONSTR.

R = 58 * T= (A) M * 59# 1 * Date 60= 07/30/1976 *

Drlr 63= 064 * Name: Layne * Method 65= H *

Finish 66= S * Remarks

CASING

R = 76 * T= (A) M * 59# 1 *

Top csng 77# - * Bot. csng 78= 812 * Diam. 79# 18 *

R = 76 * T= (A) M * 59# 1 *

Top csng 77# 735 * Bot. csng 78= 812 * Diam. 79# 10 *

OPENINGS

R = <u>82</u> * T= <u>(A) M</u> * 59# <u>1</u> *	R = <u>82</u> * T= <u>A M</u> * 59# * *
Top 83# <u>812</u> *	83# * *
Bot. 84= <u>892</u> *	84= * *
Type 85= <u>S</u> *	85= * *
Diam. 87= <u>10</u> *	87= * *
Size 88= * *	88= * *

YIELD

R = 134 (146) * T= (A) M * 147# 1 * Q 150= 1100 * Q/s 272= * *

LIFT

R= 42 * T= A M * Lift type 43# T * Intake 44= * Power type 45= E *
Date 38= 07/30/1976 * H.P. 46= 100. * *

LOGS

R= 198 * T= A M * Log 199# D * Top 200= 0. * Bot. 201= 1103. *
R= 198 * T= A M * Log 199# E * Top 200= 55. * Bot. 201= 1072. *
R= 189 * T= A * 190# 239 * 191= M I S S I S T I S T * *

ANAL.

R= 114 * T= A M * Year 115# . . . * Type 120= * *

AQUIFERS

R= 90 * T= A M * 256# 1 * Top 91= 815. * Bot. 92= 900. *
Unit ID 93= 124SPRT * Name of unit
R= 90 * T= A M * 256# * Top 91= * Bot. 92= *
Unit ID 93= * Name of unit

HYDRAULICS

R= 98 * T= A M * 99# 1 Unit tested 100= *
R= 105 * T= A M * 99# 1 Test No. 106# *
Transmissivity 107= * T(gal/d)/ft
Hydraul. conduct. 108= * P(gal/d)/ft²
Storage coeff. 110= * Boundaries

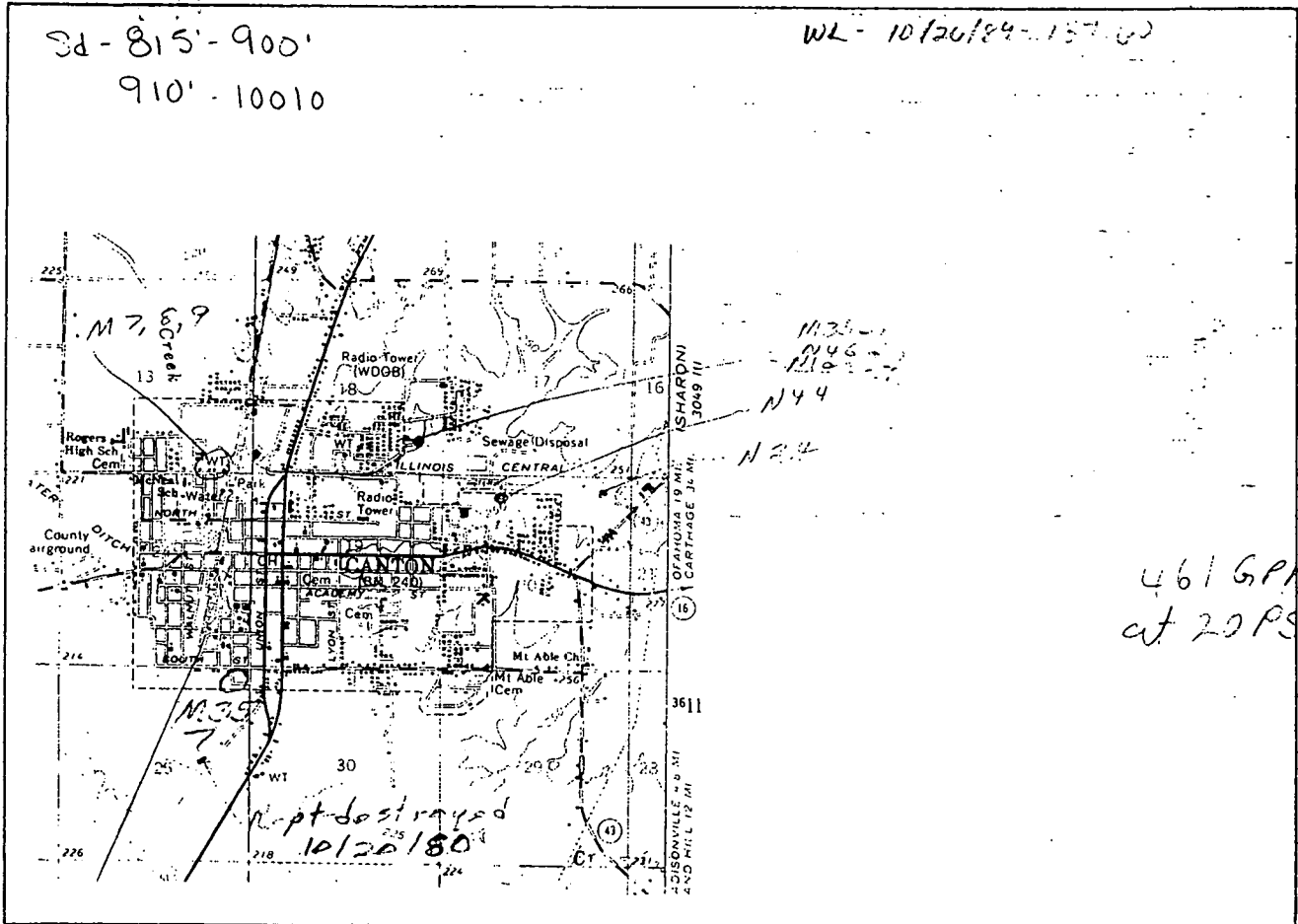

MADISON
N44
7-30-76
Log # 239

MISSISSIPPI
BOARD OF WATER COMMISSIONERS
416 North State Street
Jackson, Mississippi 39201

WATER WELL DRILLERS LOG

CODED

7-30 1976 date well completed
Lacque Central Company firm name
Madison county well located

LANDOWNER:	description of formations encountered	from	to
City of Canton Canton, Miss. (mailing address)			
WELL LOCATION: sec. 20 T 9 N R. 3 E (distance) miles (direction) of (nearest town)	Blue clay	32	80
	Sand & Clay	80	90
	Lignite Sand & Clay	90	110
	Drum Clay	110	190
	Sand - Clay	190	225
	Clay	225	240
	Sand Lignite, Clay, of shale	240	435
	Shale	435	455
	Shale and Sand streaks	455	565
	Sand	565	580
	Shale	580	635
	Rock	635	637
Shale & Sand streaks	637	815	
Sand	815	902	
Shale & Sand streaks	902	920	
Sand & Shale streaks	920	1020	
Shale & Sand streaks	1020	1103	
WELL PURPOSE: Municipal (home, irrigation, municipal, industrial)			
WELL COMPLETION DATA:			
(1) diameter (inches) 18"			
(2) total depth (feet) 903'			
(3) static water level (feet) 93' below top of ground.			
(4) casing Steel 812' (material) (depth)			
18" if telescope see back. (also) + 77' 9 10"			
(5) screen 80' (length) 812' (depth to top)			
10" W.W. (size) (material)			
(6) pump 100 (HP) 1100 (yield gpm)			
Electric (type power)			
(7) electric log yes (yes or no)			
Miss Geo Survey (organization running log)			
(8) how well bottom plugged Valve			
DRILLERS REMARKS:			

CODED

RECEIVED
AUG 9 - 1976
MISS. Bd. OF WATER COMM.

(X)

If well telescopes please sketch and show depths.

GROUND LEVEL

SECTION

Please indicate well location X.

ADDITIONAL INFORMATION

If more than one screen, show locations of each on sketch.

DEPARTMENT OF ENVIRONMENTAL QUALITY - OLWR

PUBLIC SUPPLY WELLS PROJECT

GPS LOG

PP/SPJ
1/20/98
USER NAME(S): Ann Robinson + Cheryl Ward DATE: 2/12/94
UNIT DEQ #: 84090 FILE #: B012020A
HEALTH DEPT. #: 450006-03 ELEV. 246
USGS #: N44 OLWR #: GW14112
OWNER: Canton Municipal Util QUAD: Canton
LOCATION: NW of the NE S 20 T 9 N R 3 E COUNTY: Madison
LOCATION DESCRIPTION: next to Plant aeration
treatment Plant (tip H. Allen
written on tank)
CASING DIA: 18 in. PUMP TYPE & SIZE: Turham
GPS FIELD LOCATION: LAT. 32° 36' 58.2" LONG. 90° 01' 01.9"
GPS CORRECTED LOCATION: LAT. 32.616307 LONG. 90.017141
REMARKS: corner of Hargon St and Carrington

7.5 MINUTE SERIES (TOPOGRAPHIC)

SE/4 CANTON 15' QUADRANGLE

3048 11.1 (SHARON)

777

2' 30" R2 E R3 E

WINONA 67 MI. SHARPSBURG 10 MI.

780

600000 FEET

781

90° 00' 32° 37' 30"

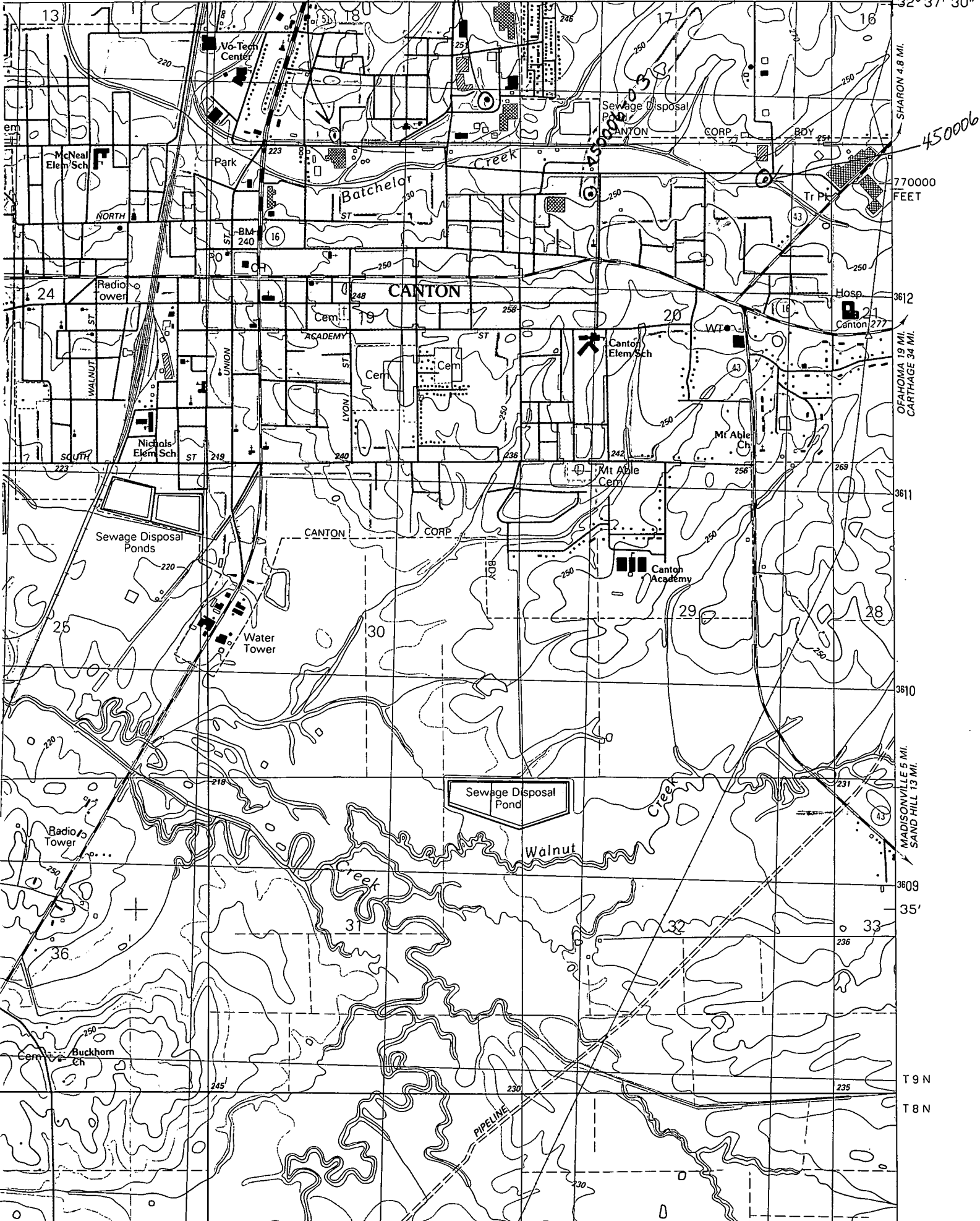

450006

770000 FEET

SHARON 4.8 MI. OFAHOMA 19 MI. CARTHAGE 34 MI.

MADISONVILLE 5 MI. SAND HILL 13 MI.

T9 N T8 N