

Observation Well **PUNCHED** **PUNCHED**  
Well No. Q120 OCT 16 1975

FORM 9-1642  
(1-68)

Well No.

WELL SCHEDULE

E-109 61 JUL 02 1975

U. S. DEPT. OF THE INTERIOR

GEOLOGICAL SURVEY

WATER RESOURCES DIVISION

MASTER CARD

USCE

1:62,500

Record by GJD Source of data E-109 Date 4-4-75 Map Columbus Quad.

State 28 County (or town) Lowndes 44

Latitude: 33 19 15 N Longitude: 08 82 02 0 Sequential number: 7

Lat-long accuracy: 3 20 17 NE SW

Local well number: Q0124C1720S17W Other number: TTM 1A

Local use: 061 Owner or name: J.A. Hanson, owner of land

Owner or name: USCE TTM 1A Address: Mobile, Alabama

Ownership: County, Fed Gov't, City, Corp or Co, Private, State Agency, Water Dist F

Use of Air cond, Bottling, Comm, Dewater, Power, Fire, Dom, Irr, Med, Ind, P S, Rec, water: U

Stock, Instit, Unused, Repressure, Recharge, Desal-P S, Desal-other, Other U

Use of well: Anode, Drain, Seismic, Heat Res, Obs, Oil-gas, Recharge, Test, Unused, Withdraw, Waste, Destroyed. Φ

DATA AVAILABLE: Well data  Freq. W/L meas.:  Field aquifer char.

Hyd. lab. data:

Qual. water data; type: USGS 6/75 C

Freq. sampling: Φ Pumpage inventory: no. period:

Aperture cards:  yes

Log data: E-log 7-160' E

WELL-DESCRIPTION CARD

SAME AS ON MASTER CARD Depth well: 141 Meas. 0

Depth cased; (first perf.) 131 Casing type: PVC ; Diam. 4

Finish: porous concrete, gravel w. (perf.), gravel w. (screen), horiz. gallery, end, open perf., screen, sd. pt., shored, open hole, other S

Method Drilled: air rot, bored, cable, dug, hyd, jetted, air rot., percusson, rotary, reverse trenching, driven, drive wash, other H

Date Drilled: 4-4-75 975 Pump intake setting: 5.0 ft 30

Driller: USCE Mobile, Ala.

Lift (type): air, bucket, cent, jet, multiple, multiple, (cent.) (turb.) none, piston, rot, submerg, turb, other N Deep  Shallow

Power (type): diesel, elec, gas, gasoline, hand, gas, wind; H.P.  Trans. or meter no.

Descrip. MP Top of 4" PVC casing, 5.0 ft above below LSD, Alt. MP 10' contour

Alt. LSD: 150 Accuracy: 10' contour 4

Water Level 15.48 ft above below MP; Ft below LSD 70 Accuracy: 4

Date meas: 5-8-75 575 Yield: 575 gpm 61 Method determined

Drawdown: 575 ft 62 Accuracy: 63 Pumping period 64 hrs 65

QUALITY OF WATER DATA: Iron 69 Sulfate 70 Chloride 71 Hard. 72

Sp. Conduct 310 K x 10<sup>6</sup> 2 Temp. 18.0 Date sampled 6-5-75 675

Taste, color, etc. pH = 7.4

Left 3  
Open  
Water Level  
Date  
11/15/82  
wh = 6-47

Well No.

Q12

Well No. \_\_\_\_\_

Latitude-longitude \_\_\_\_\_ N  
S  
d m s d m s

**HYDROGEOLOGIC CARD**

**SAME AS ON MASTER CARD** Physiographic Province: 03 Section: \_\_\_\_\_

D Drainage Basin: 132 Subbasin: \_\_\_\_\_

Topo of well site: (D) depression, stream channel, dunes, flat, hilltop, sink, swamp, (E) (F) (G) (H) (I) (J) (K) (L) (M) (N) (O) (P) (Q) (R) (S) (T) (U) (V) offshore, pediment, hillside, terrace, undulating, valley flat \_\_\_\_\_

MAJOR AQUIFER: system \_\_\_\_\_ series H3 aquifer, formation, group E3

Lithology: US Origin: 6 Aquifer Thickness: \_\_\_\_\_ ft

25 Length of well open to: \_\_\_\_\_ ft 10 Depth to top of: \_\_\_\_\_ ft 120

MINOR AQUIFER: system \_\_\_\_\_ series \_\_\_\_\_ aquifer, formation, group \_\_\_\_\_

Lithology: \_\_\_\_\_ Origin: \_\_\_\_\_ Aquifer Thickness: \_\_\_\_\_ ft

   Length of well open to: \_\_\_\_\_ ft    Depth to top of: \_\_\_\_\_ ft   

Intervals Screened: 13-1-14-1 = 10' of 4" PVC with .020" openings

Depth to consolidated rock: \_\_\_\_\_ ft \_\_\_\_\_ Source of data: \_\_\_\_\_

Depth to basement: \_\_\_\_\_ ft \_\_\_\_\_ Source of data: \_\_\_\_\_

Surficial material: \_\_\_\_\_ Infiltration characteristics: \_\_\_\_\_

Coefficient Trans: \_\_\_\_\_ gpd/ft<sup>2</sup> \_\_\_\_\_ Coefficient Storage: \_\_\_\_\_

Coefficient Perm: \_\_\_\_\_ gpd/ft<sup>2</sup>; Spec cap: \_\_\_\_\_ gpm/ft; Number of geologic cards: \_\_\_\_\_

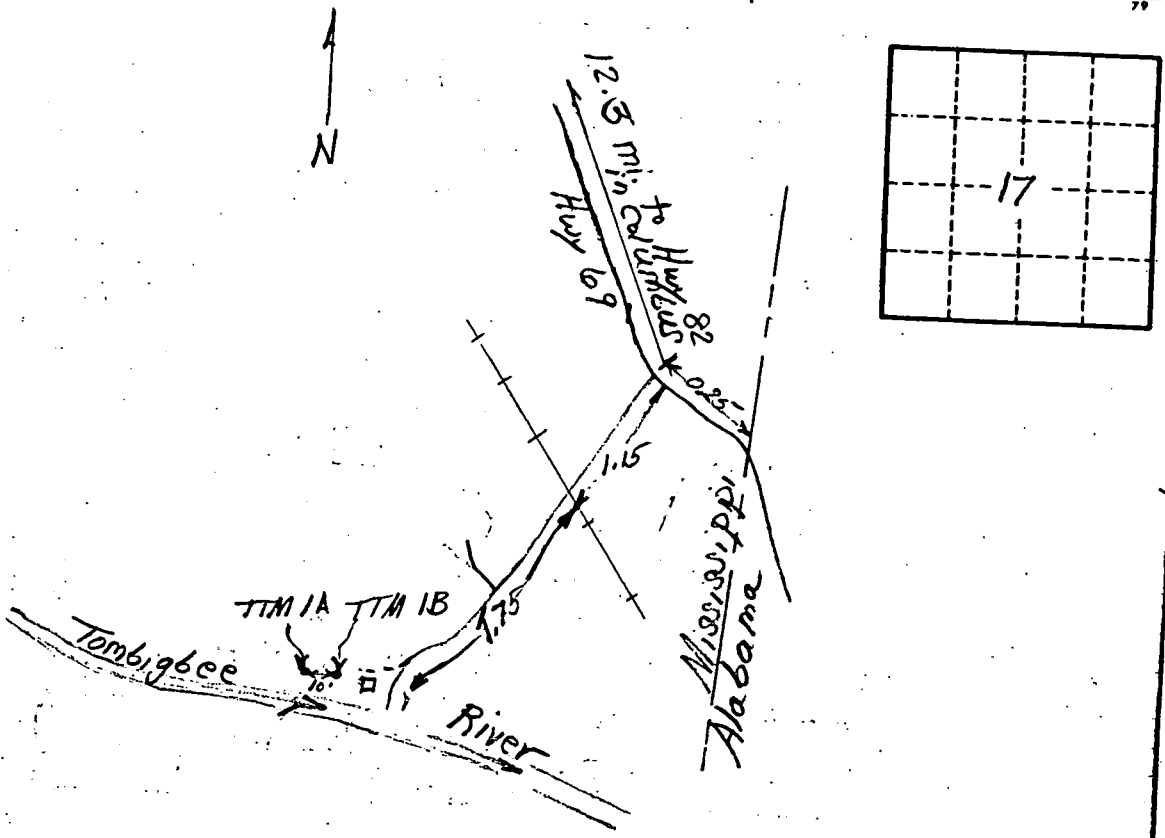

Well No. Q12