

Coded By Q 7/10/97 U.S. GEOLOGICAL SURVEY
 Checked By 04/04/98 WATER RESOURCES DIVISION
 Entered By 2/2/98 MISSISSIPPI DISTRICT
 Date 2/2/98

E-Log No. 131
 County LOWNDES
 Agency LOWNDES

Well No. 047

WELL RECORD

Agency Code U1S1G1S1 Site Id 133204410882930011 Project No. 54

Station Name 12 0047 S LOWNDES W. IA Latitude 9 332044 Longitude 10 0882930 **GPS**

Loc./Long Ac. 11 S O T M Disc 6=23 State 7=29 County 8=0871 Land Net 13 NWNW 1/4 T17N R117E

Location Map 14 TRINITY Altitude 16 243 Mec/Meas 17 A (C) Accuracy 18 15 Hydrologic Unit 20 1031610106

Agency Use 603 A (C) Date Inventoried 711 Station Type 4 Data Type 804

Instru. 905 Remarks 306 Relia. 3 (C) M U 24 X

Date of Construction 21 07/19/1997 Well Use 23 W Water Use 24 P Primary Aquifer 714 211610 RD Hole Depth 27 1108

Well Depth 29 109 Water Level 30 98 Water Level Date 31 12/19/1997 Method 34 Status 37 Source 33 D

CONSTRUCTION DATA

Construction Date 60 12/19/1997 Contractor 63 0211 Name Herndon Method 65 H Finish 66 B

CONSTRUCTION CASING DATA

| R | T | Top/Casing | Bot/Casing | Diameter |
|------|-----|------------|------------|---------------|
| R=76 | T=A | 725#1 59#L | 77 101 | 78 104 79 110 |
| R=76 | T=A | 725#2 59#L | 77 107 | 78 150 79 16 |

CONSTRUCTION OPENINGS DATA

| R | T | Top/Depth | Bot/Depth | Diameter | Type | Length | Width |
|------|-----|------------|-----------|----------|-------|--------|----------|
| R=32 | T=A | 726#1 59#L | 83 850 | 84 890 | 87 16 | 85 S | 88 10210 |
| R=32 | T=A | 726#2 59#L | 83 | 84 | 87 | 85 | 88 |

CONSTRUCTION LIFT DATA

R=42 T=A 254#1 Lift Type 43 S Date 38 12/19/1997 Intake 44 1189

Power 45 A H.P. 46 25 Serial No. 49

MISCELLANEOUS OWNER DATA

Date of Ownership 159 12/19/1997 Owner Name 161 S LOWNDES W IA

MISCELLANEOUS OTHER ID DATA

R=199 T=A 736#L E-Log No. 190 1311 Assigner 191 M I S S I O I S T

Well # 2

MISCELLANEOUS CW DATA

| | | | | | | |
|-------|-----|-------|---|-------------------------|----------------------|---------------|
| R=192 | T=A | 738#1 | Date of Measurement 1934 / / | Aquifer Sampled 1954 | Temp 196400010 | Value 1974 |
| R=192 | T=A | 738#2 | Date of Measurement 1934 / / | Aquifer Sampled 1954 | So Cond 196400095 | Value 1974 |
| R=192 | T=A | 738#3 | Date of Measurement 1934 / / | Aquifer Sampled 1954 | pH 196400200 | Value 1974 |

MISCELLANEOUS LOGS DATA

| | | | | | |
|-------|-----|-------|---------------------|--------------------------|--------------------------|
| R=195 | T=A | 739#1 | Log Top 1994 E | Sec. Depth 2004 140 | End Depth 2014 9010 |
| R=198 | T=A | 739#1 | Log Top 1994 D | Sec. Depth 2004 110 | End Depth 2014 9108 |

MISCELLANEOUS NETWORK DATA - 706 = QW WL WD *

| | | | | | | |
|-------|-----|-------|---------------------------|--------------------------|------------------------|---------------|
| R=114 | T=A | 730#1 | Sec. Year 1154 1 9 | End Year 1164 1 9 | Agency Source 120=A | Freq. 117# |
| R=121 | T=A | 730#2 | Sec. Year 1154 1 9 | End Year 1164 1 9 | Agency Source 117# | Freq. 118# |

MISCELLANEOUS REMARKS DATA

| | | | | |
|-------|-----|-------|-------------------------------------|-----------------|
| R=183 | T=A | 311#1 | Date of Remarks 1844 / / | Remarks 1854 |
|-------|-----|-------|-------------------------------------|-----------------|

DISCHARGE DATA

| | | | | | | |
|-------|-----|--------------------|--|-----------------|-------------------------|--------------------------------------|
| R=146 | T=A | Pump/Flow 147#1 | Date 1484 12 11 11 11 11 11 | Flow 703 P | Discharge 1504 230 | So. Capacity 2724 1 1 1 1 |
|-------|-----|--------------------|--|-----------------|-------------------------|--------------------------------------|

GEOHYDROLOGIC DATA

| | | | | | | |
|------|-----|-------|-------------------------|--------------------------|------------------------------------|-------|
| R=90 | T=A | 721#1 | Depth Top 914 2145 | Depth Bot. 924 9105 | Unit Id 934 2116 10 R D | 304 = |
|------|-----|-------|-------------------------|--------------------------|------------------------------------|-------|

HYDRAULIC DATA

| | | | | |
|------|-----|-------|---------------------|------|
| R=98 | T=A | 790#1 | Unit Tested 1004 | 1034 |
|------|-----|-------|---------------------|------|

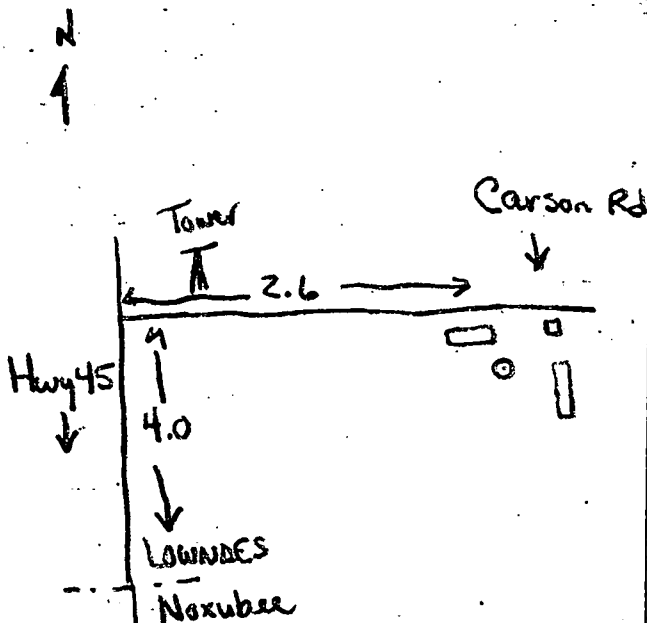

| DESCRIPTION OF FORMATIONS ENCOUNTERED | FROM | TO | FORMATIONS (Continued) | FROM | TO |
|---------------------------------------|------|-----|------------------------|------|-----|
| Brown Clay | 0 | 8 | Rock | | 480 |
| Limerock | 8 | 23 | Blue Clay, Strkd Sand, | | |
| Blue Clay | 23 | 255 | Shale Rocks | 480 | 503 |
| Rock | | 255 | Hard Blue Clay | 503 | 520 |
| Blue Clay | 255 | 390 | Blue Clay, Strkd Sand | 520 | 614 |
| Blue Clay, Strk Sand | 390 | 416 | Rock | | 614 |
| Rock | | 416 | Blue Clay | 614 | 660 |
| Blue Clay, Strk Sand, | | | Rock | | 660 |
| Shale Rocks | 416 | 480 | Pink Clay | 660 | 747 |
| | | | Strkd Sand & Clay | 747 | 760 |

IF MORE SPACE IS NEEDED, USE BACK