

0310009

Latitude-longitude N
S
d m s d m s

HYDROGEOLOGIC CARD

SAME AS ON MASTER CARD

Physiographic Province: _____

03
20 21

Section: _____

STEEL 0 HAM

D

Drainage Basin: _____

134
23 23

Subbasin: _____

Top of well site: (D) depression, stream channel, dunes, flat, hilltop, sink, swamp, (C) (E) (F) (H) (K) (L) (O) (P) (S) (T) (U) (V) offshore, pediment, hillside, terrace, undulating, valley flat

MAJOR AQUIFER: _____ system _____ series K3 _____ aquifer, formation, group EZ

Lithology: _____ Origin: U.S. Aquifer Thickness: _____ ft

Length of well open to: _____ ft _____ Depth to top of: _____ ft _____

MINOR AQUIFER: _____ system _____ series _____ aquifer, formation, group _____

Lithology: _____ Origin: _____ Aquifer Thickness: _____ ft

Length of well open to: _____ ft _____ Depth to top of: _____ ft _____

Intervals Screened: _____

Depth to consolidated rock: _____ ft _____ Source of data: _____

Depth to basement: _____ ft _____ Source of data: _____

Surficial material: _____ Infiltration characteristics: _____

Coefficient Trans: _____ gpd/ft _____ Coefficient Storage: _____

Coefficient Perm: _____ gpd/ft²; Spec cap: _____ gpm/ft; Number of geologic cards: _____

well stopped flowing in 1953.

8/11/87

Searched for well, Area too overgrown & description too vague to locate

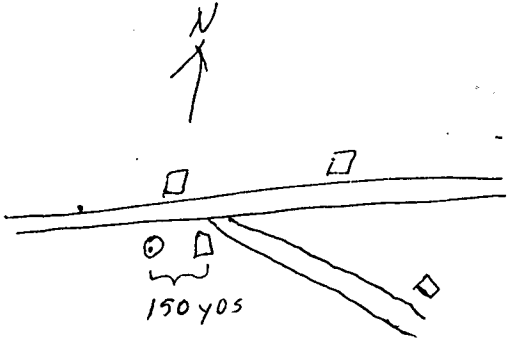

150 yds

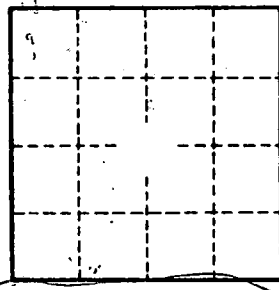

OLD CATCH BASIN



2.

Park at cemetery and walk down tree line to well

12/16/87

AP WE 20.9' from the 4 or 5th post

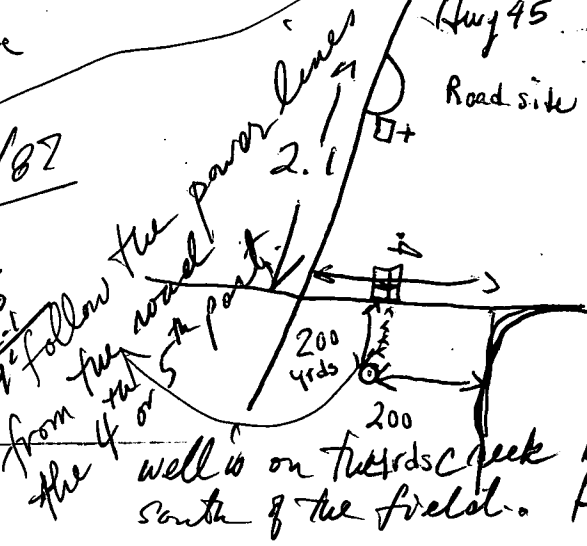

Hwy 45

Road side PK

200 yds

200

GPO 937-142

well is on the road creek bank south of the field. Had pump on it power lines go just to the post by the well