

AD# 440004-01

155 - GW02825

TRANSMITTED FOR ADP

6

1/81 WFO

Recorded by ND  
Date 4-5-84

U.S. GEOLOGICAL SURVEY  
WATER RESOURCES DIVISION  
MISSISSIPPI DISTRICT  
WELL RECORD

9/84

Well No. N41  
E-Log No. 96  
County Lowndes

Crawford East  
~~155-0~~  
155-0

Site ID 33.1.8.0.8.0.8.3.7.0.8.0.1 R=0\* T=A\* 2=W\*  
5 19

GEN. SITE DATA

Data reliab. 3=C\*<sup>C</sup> Report. agency 4=USGS\* Dist. 6=28\* 7=28\* Co. 8=0.8.7.\*  
Lat. Long. 9=33.1.8.0.8.\* 10=0.8.8.3.7.0.8.\* Well No. 12=N.0.4.1.\*  
Location SE 13=SESE S 28 T 17 N R 16 E\* Alt. 16=30.85.\*  
Hyd. Unit (OWDC) 20= Date 21=0.3.1.2.0.1.1.9.8.4.\*  
Well use 23=W\* Water Use 24=P\* Hole depth 27=1.2.7.0.\* Well depth 28=1.2.6.1.\*  
WL 30=1.6.1.8.\* Date 31=0.7.1.0.1.1.9.8.4.\* Source 33=D.\*  
Status 273= Project No. 5=

OWNER

R=158\* T=A\* Date 159# 0.7.1.0.1.1.9.8.4.\* Owner No.  
Owner 161# CRAWFORD

FIELD QW

R=192\* T=A\* Date 193# Temp. 196#00010\* 197=.\*  
R=192\* T=A\* Date 193# Cond. 196#00095\* 197=.\*  
R=192\* T=A\* Date 193# pH 196#00400\* 197=.\*

CONSTR.

R=58\* T=A\* 59# 1\* Date 60=0.7.1.0.1.1.9.8.4.\* Remarks  
Drlg. 63=0.2.1.\* Name Herndon Method 65=H\* Finish 66=S\*

CASING

R=76\* T=A\* 59# 1\*  
Top csng. 77# 0.\* Bot. csng. 78=1.2.2.5.\* Diam. 79# 8.\*  
R=76\* T=A\* 59# 1\*  
Top csng. 77# 1.1.5.7.\* Bot. csng. 78=1.2.2.0.\* Diam. 79# 4.\*

OPENINGS

R=82\* T=A\* 59# 1\* Top 83# 1.2.2.0.\* Bottom 84=1.2.6.1.\*  
Type 85=S\* Diam. 87=4.\* Size 88=.\*  
R=82\* T=A\* 59# 1\* Top 83# Bottom 84=.\*  
Type 85= Diam. 87= Size 88=.\*

YIELD

R=146\* T=A\* 147# 1\* Q 150=1.9.7.\* Q/S 272=.\*  
134 flows 146 pumped

LIFT

R=42\* T= A \* Lift type 43# T \* Intake 44= \* Power type 45= E \*

Date 38= 07/01/1984 \* H.P. 46= 25. \*

LOGS

R=198\* T= A \* Log 199# E \* Top 200= 1.0. \* Bot 201= 1.269. \*

R=198\* T= A \* Log 199# D \* Top 200= 0. \* Bot 201= 1.270. \*

R=189\* T= A \* E Log No. 190# 096. \* 191= M I S S D I S T \*

ANAL.

R=114\* T= A \* Year 115# \* 117# \* 120# \*

AQUIFERS

R=90\* T= A \* 256# 1 \* Top 91= 1.225. \* Bot 92= 1.255. \*

Unit ID 93= Z I L G O R D \* Name of Unit

R=90\* T= A \* 256# 1 \* Top 91= \* Bot 92= \*

Unit ID 93= \* Name of Unit

HYDRAULICS

R=98\* T= A \* 99# 1 \* Unit tested 100= \* 103= \*

R=105\* T= A \* 99# 1 \* Test No. 106# \*

107= \* Transmissivity (gal/d)/ft

108= \* Hydraul. cond. (gal/d)/ft<sup>2</sup>

110= \* Storage coeff. Boundaries

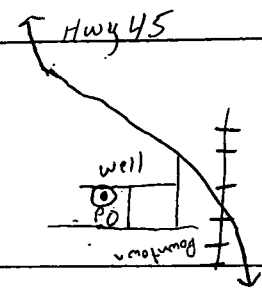

R=121\* T= \* Yr Begin 122# \* Network 258 # \*

Water Level Data Collection (1)

9-19-91  
HOB 195  
Cut 38  
MP 2.4  
NL 154.4

See Quad

pink Gumbo	1266	1270
Sand	1260	1266
clay	1255	1260
Sand	1225	1255
Sand & Clay	1196	1225
Sand	1170	1196
Clay	1140	1170
Sand	1110	1140
Clay	1085	1110
Sandy Clay	1080	1085
pink Gumbo	1045	1080
Sand	1020	1045
pink Gumbo	980	1020
Blue Clay	955	980
Sand	940	950
pink Gumbo	950	955
Blue Clay	910	940
Blue Clay	900	910
pink Gumbo	851	900
Rock	850	851
Blue Clay	833	850
Shale Rock	830	833
Blue Clay	751	830
Rock	750	751
Blue Clay	675	750
Shale Rock	670	675
Clay	660	670
Sand	618	660
Blue Clay	580	618
Sandy Blue Clay	556	580
Shale Rock	550	556
Blue Clay	8	550
Brown Clay	0	8

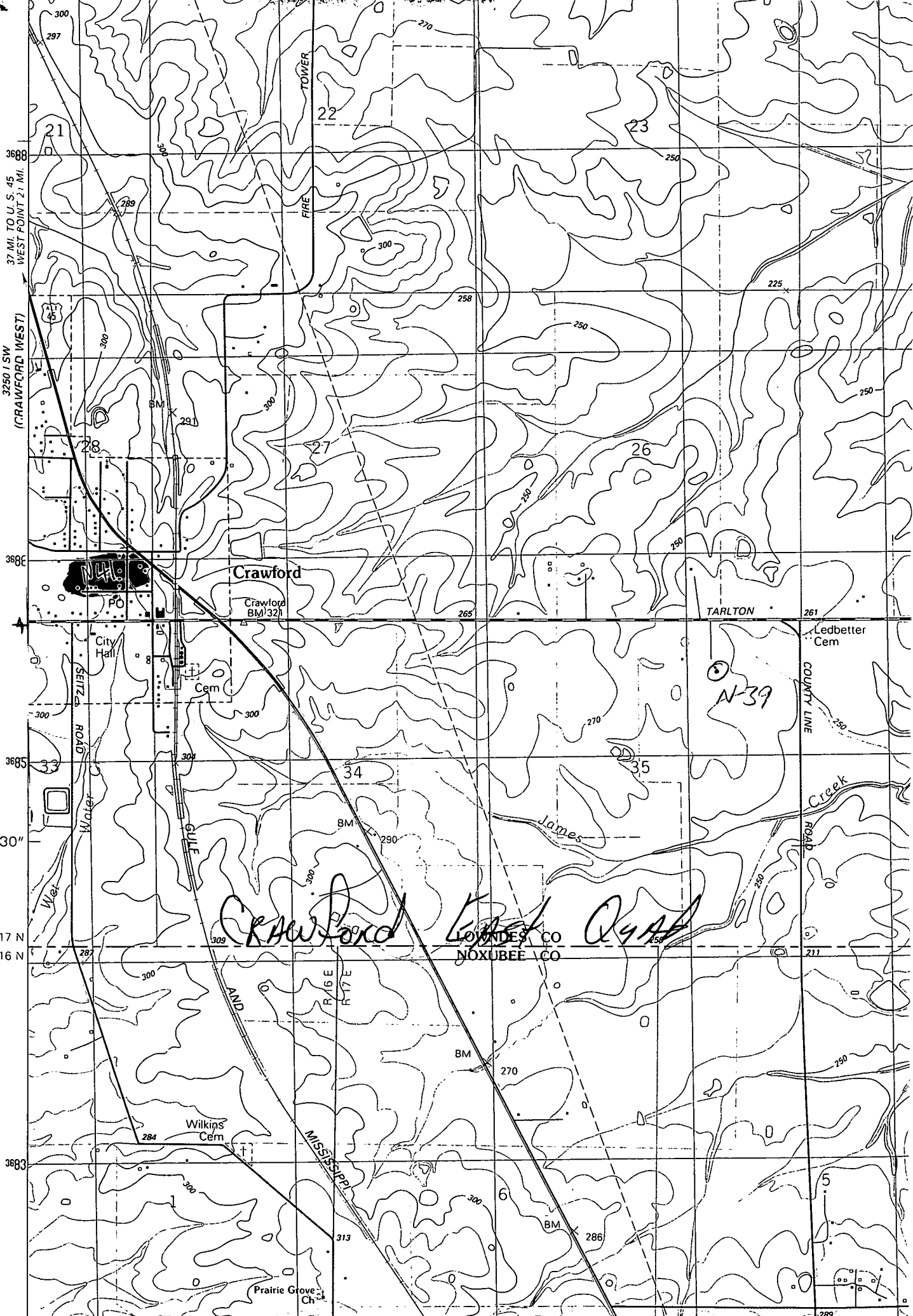

37 MI. TO U.S. 45  
WEST POINT 21 MI.

3250 I SW  
(CRAWFORD WEST)

3688

3686

3685

T 17 N

T 16 N

3683

17' 30"

*Crawford LA 04 AD*

*N-39*

LOUISIANA CO  
NOXUBEE CO

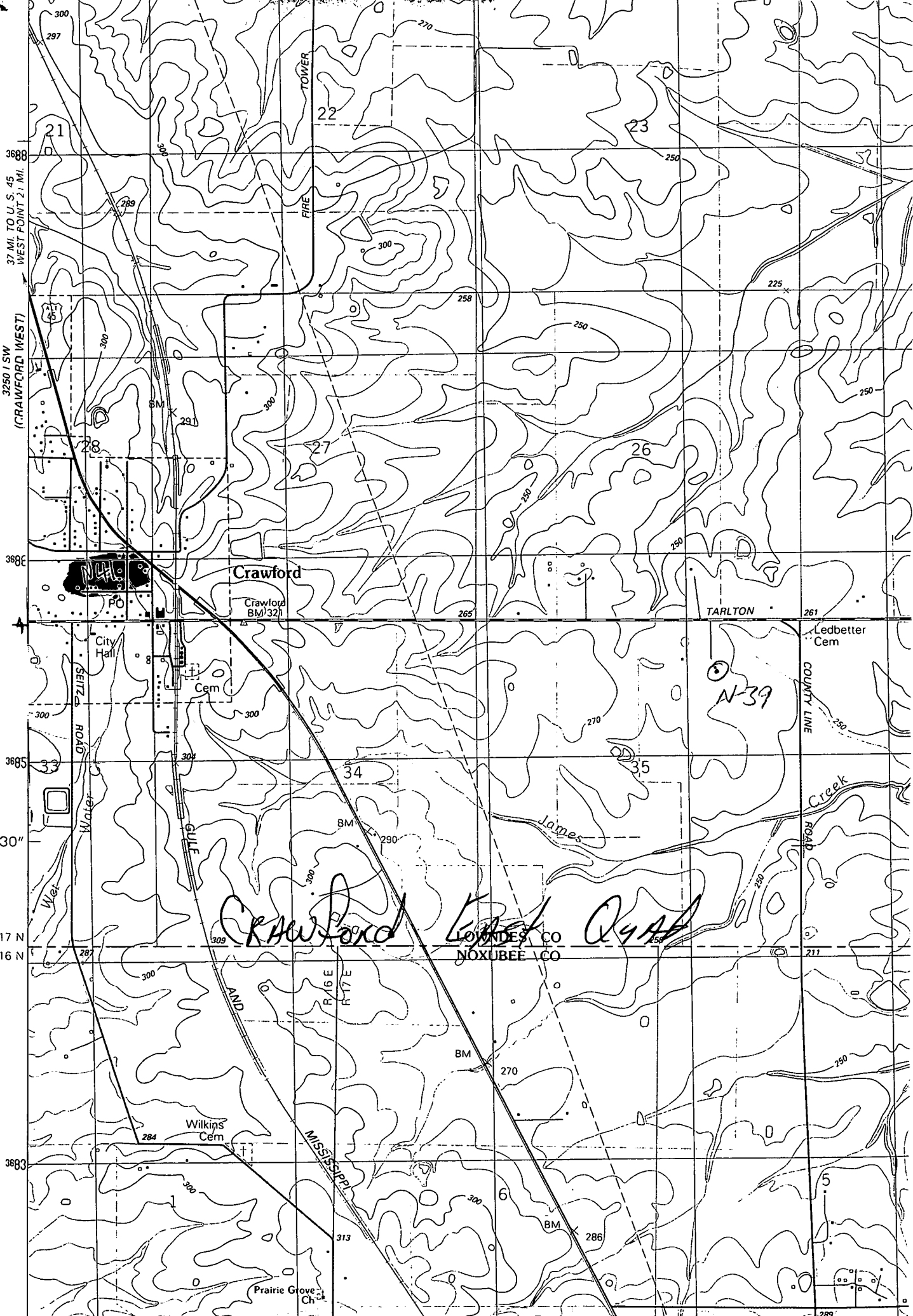

37 MI. TO U.S. 45  
WEST POINT 21 MI.

3250 I SW  
(CRAWFORD WEST)

3688

3686

3685

T 17 N

T 16 N

3683

17' 30"

*Crawford LA 04 AD*

*N-39*

LOUISIANA CO  
NOXUBEE CO