

UNITED STATES
DEPARTMENT OF THE INTERIOR
GEOLOGICAL SURVEY
WATER RESOURCES DIVISION

WELL SCHEDULE

Date MAY 27, 19 60 Field No. _____
Record by R. E. ELLISON Office No. 425
Source of data PLANT ENGINEER

1. Location: State MISS. County Lowndes

Map NW 1/4 SE 1/4 sec. 10 T 19 N R 18 E W

2. Owner: Hooker Chemical Co. Address Columbus, Miss.

Tenant _____ Address _____
Driller _____ Address _____

3. Topography bottom

4. Elevation 180 ft. ^{above} top _{below}

5. Type: Dug drilled driven, bored, jetted _____ 19 _____

6. Depth: Rept. 350 ft. Meas. _____ ft.

7. Casing: Diam. 4 in., to _____ in., Type _____

Depth _____ ft., Finish _____

8. Chief Aquifer Ke From _____ ft. to _____ ft.

Others _____

9. Water level _____ ft. rept. _____ 19 _____ ^{above} _{below}

_____ which is _____ ft. ^{above} _{below} surface

10. Pump: Type None Capacity _____ G. M.

Power: Kind _____ Horsepower _____

11. Yield: Flow _____ G. M., Pump _____ G. M., Meas., Rept. Est. _____

Drawdown _____ ft. after _____ hours pumping _____ G. M.

12. Use: Dom., Stock, PS., RR., Ind., Irr., Obs. None

Adequacy, permanence _____

13. Quality _____ Temp _____ °F.

Taste, odor, color _____ Sample ^{Yes} _{No}

Unfit for _____

14. Remarks: (Log, Analyses, etc.) _____

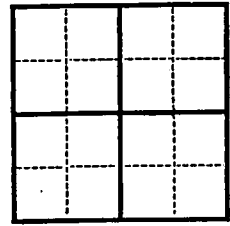

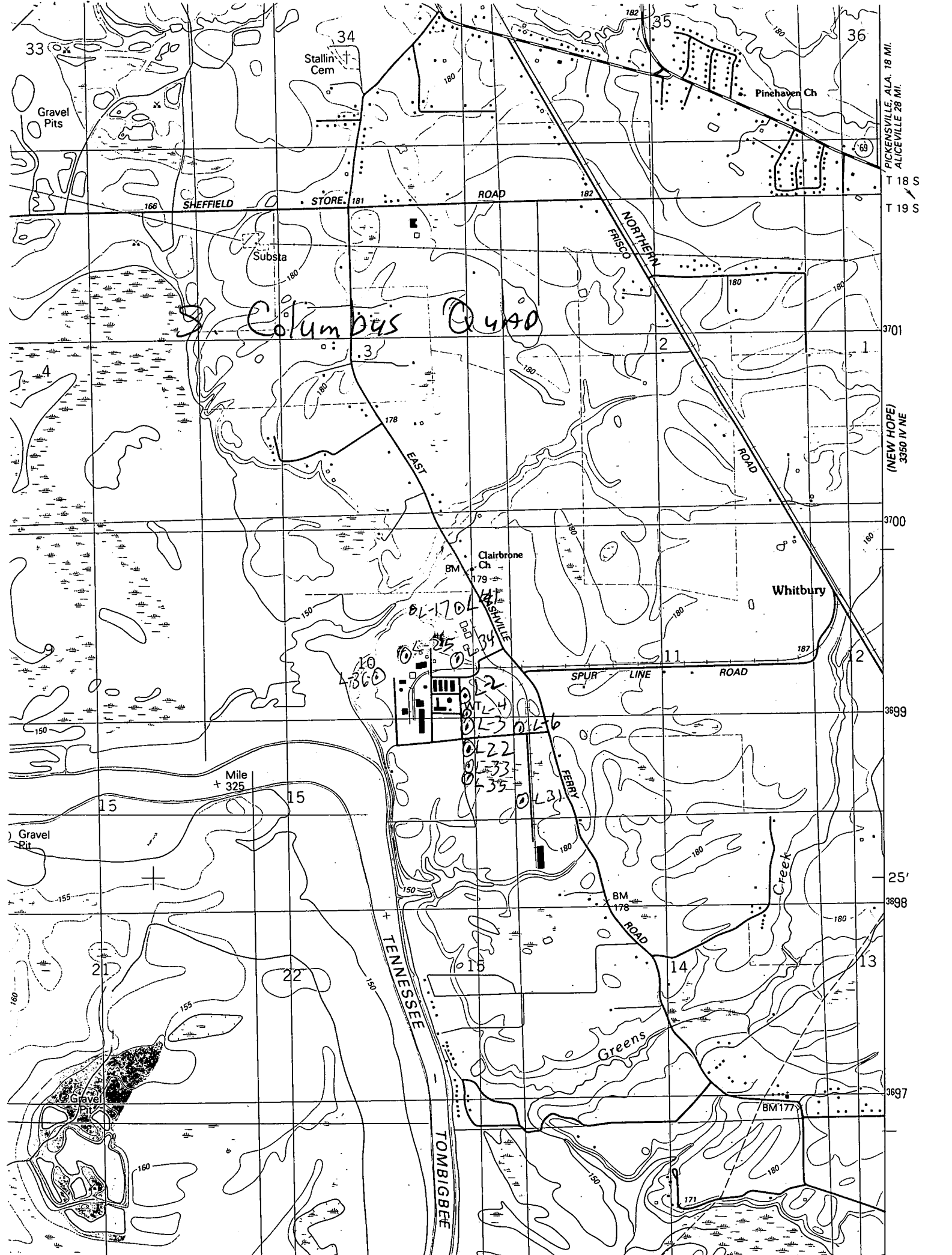

PICKENSVILLE ALA. 18 MI.
ALICEVILLE 28 MI.

T 18 S
T 19 S

3701

(NEW HOPE)
3350 IV NE

3700

3699

25'

3698

3697