

9-185
(October 1950)

UNITED STATES **L36**
DEPARTMENT OF THE INTERIOR
GEOLOGICAL SURVEY
WATER RESOURCES DIVISION

owner #4.

WELL SCHEDULE

Date Dec 28, 1955 Field No. _____
Record by J.W.H. Office No. 4-8
Source of data Layne Central Jackson Office

1. Location: State Miss County Lauderdale
Map _____

SE 1/4 SE 1/4 sec. 10 T 19 N R 18 E

2. Owner: Oldbury Electro-Chemical Co. Address Columbus, Miss.

Tenant Hooker Chem. Corp. Address _____

Driller Layne Central Co. Address _____

3. Topography _____

4. Elevation _____ ft. above _____ below

5. Type: Dug, drilled driven, bored, jetted 1954

6. Depth: Rept 598 ft. Meas. _____ ft.

7. Casing: Diam. 12 in., to _____ in., Type steel

* Depth _____ ft., Finish 60' 8" screen

8. Chief Aquifer Tuscaloosa sand From _____ ft. to _____ ft.
Others _____

9. Water level 11 or 12 ft. rept meas. 1954 above _____ below l.s.
_____ which is _____ ft. above surface below

10. Pump: Type Turbine Capacity 500-600 G. M. rept.
Power: Kind Electric Horsepower _____

11. Yield: Flow _____ G. M., Pump _____ G. M., Meas., Rept. Est.
Drawdown _____ ft. after _____ hours pumping _____ G. M.

12. Use: Dom., Stock, PS., RR., Ind., Irr., Obs. _____
Adequacy, permanence _____

13. Quality _____ Temp _____ °F.
Taste, odor, color _____ Sample Yes _____ No _____

Unfit for _____

14. Remarks: (Log, Analyses, etc.) _____

* Gravel-wall construction.

9-185
(October 1950)

UNITED STATES
DEPARTMENT OF THE INTERIOR
GEOLOGICAL SURVEY
WATER RESOURCES DIVISION

WELL SCHEDULE

Date March 22, 1956 Field No. 05C 6
Record by Ed Boswell Office No. 4-6
Source of data Mr Mattox (James Mattox)

1. Location: State Miss County Lauderdale
Map _____

SE 1/4 SE 1/4 sec. 10 T 19 N R 18 E

2. Owner: Oldbury Electro-Chemical Address Columbus Miss

Tenant _____ Address _____

Driller Layne Central Co Address Memphis Tenn

3. Topography Terrace

4. Elevation 180 ft. above _____ below msl (CE)

5. Type: Dug, drilled driven, bored, jetted 1955

6. Depth: Rept. 600 ± ft. Meas. _____ ft.

7. Casing: Diam. 12 in., to 8 in., Type _____

Depth _____ ft., Finish 50' x 8" shutter

8. Chief Aquifer Tuscaloosa From _____ ft. to _____ ft.
Others _____

9. Water level _____ ft. rept. _____ meas. 19 _____ above _____ below
_____ which is _____ ft. above surface below

10. Pump: Type 4 Stage Turbine Capacity _____ G. M.
Power: Kind Elec Horsepower _____

11. Yield: Flow _____ G. M., Pump _____ G. M., Meas., Rept. Est.
Drawdown _____ ft. after _____ hours pumping _____ G. M.

12. Use: Dom., Stock, PS., RR., Ind., Irr., Obs. Cooling + Proc.
Adequacy, permanence _____

13. Quality Iron Temp 66 °F.
Taste, odor, color _____ Sample Yes Yes No _____

Unfit for _____

14. Remarks: (Log, Analyses, etc.) None Avail.

#5 + #6 pump bowls set 20' below others

14 Name: (Last, first, middle initial)
N. L. H. 90

15 Name of company
General

16 Address
1000

17 City, State, and Zip
St. Paul, Minn. 55108

18 Name of contact person
C. M. Householder

19 Title of contact person
Secretary

20 Office
16

21 Name of contact person
C. M. Householder

22 Title of contact person
Secretary

23 Name of contact person
C. M. Householder

24 Title of contact person
Secretary

25 Name of contact person
C. M. Householder

26 Title of contact person
Secretary

27 Name of contact person
C. M. Householder

28 Title of contact person
Secretary

29 Name of contact person
C. M. Householder

30 Title of contact person
Secretary

WATER RESOURCES DIVISION
GEOLOGICAL SURVEY
DEPARTMENT OF THE INTERIOR
UNITED STATES

(October 1959)
9-112

WATER SCHEDULE

Date: 10/15/59

Record by: [Signature]

Place of birth: [Signature]

Country: State

Office No. 1076

Field No. 503

14 Name: (Last, first, middle initial)
N. L. H. 90

15 Name of company
General

16 Address
1000

17 City, State, and Zip
St. Paul, Minn. 55108

18 Name of contact person
C. M. Householder

19 Title of contact person
Secretary

20 Office
16

21 Name of contact person
C. M. Householder

22 Title of contact person
Secretary

23 Name of contact person
C. M. Householder

24 Title of contact person
Secretary

25 Name of contact person
C. M. Householder

26 Title of contact person
Secretary

27 Name of contact person
C. M. Householder

28 Title of contact person
Secretary

29 Name of contact person
C. M. Householder

30 Title of contact person
Secretary

WATER RESOURCES DIVISION
GEOLOGICAL SURVEY
DEPARTMENT OF THE INTERIOR
UNITED STATES

(October 1959)
9-112

WATER SCHEDULE

Date: 10/15/59

Record by: [Signature]

Place of birth: [Signature]

Country: State

Office No. 1076

Field No. 503

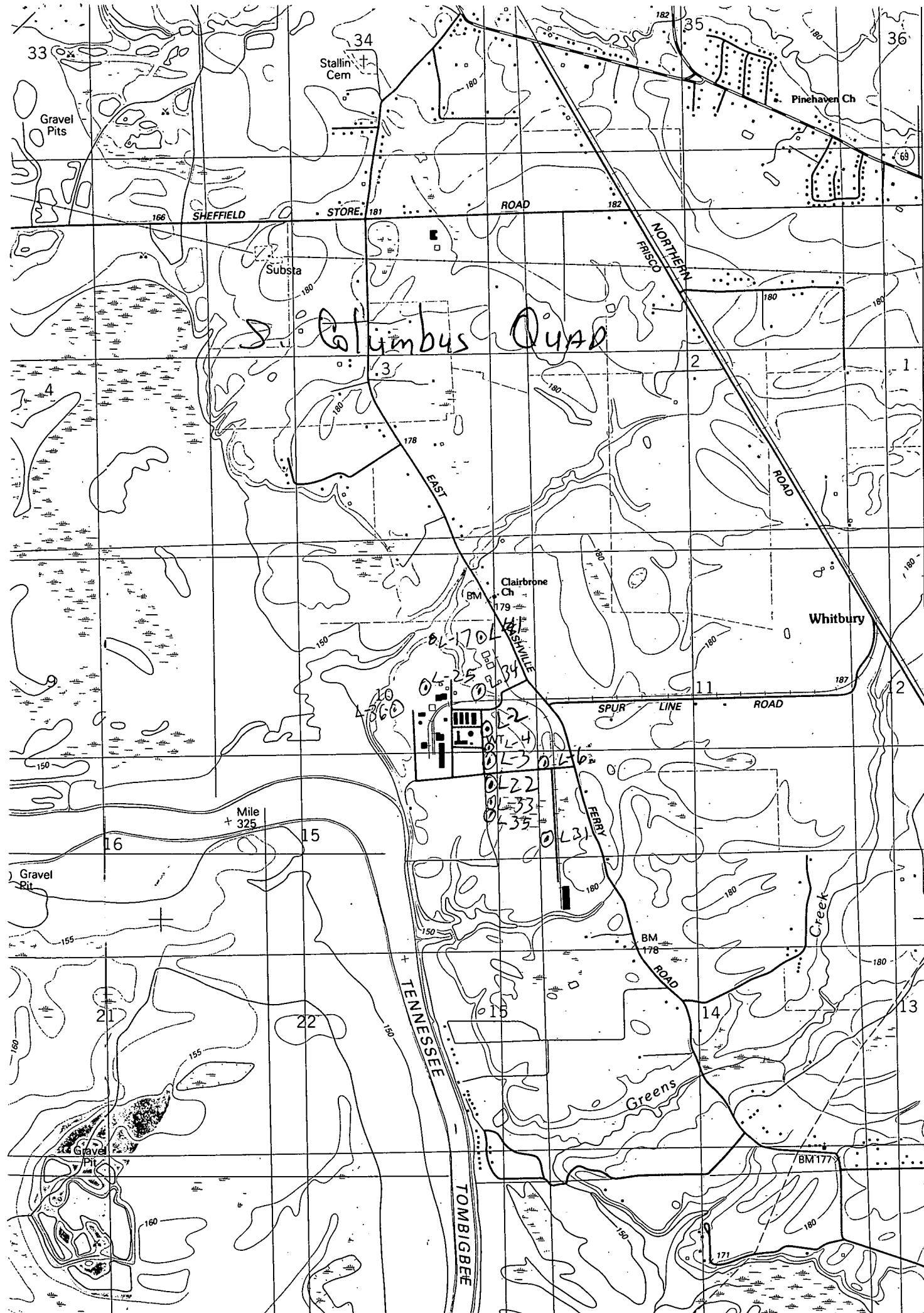

S. Columbus Quad

PICKENSVILLE ALA. 18 MI.
ALICEVILLE 28 MI.

T 18 S
T 19 S

3701

(NEW HOPE)
3350 IV NE

3700

3699

25'

3698

3697