

Recorded by WJC
Date 7/23/80

U.S. GEOLOGICAL SURVEY
WATER RESOURCES DIVISION
MISSISSIPPI DISTRICT
WELL RECORD

781
Artesia

Well No. K-37
E-Log No. #90
County LINCOLN

GEN. SITE DATA

Site ID 33, 26, 56, 0, 8, 8, 3, 3, 5, 8, 0, 1 R=0* T=A* 2=W*

Data reliab. 3=C Report. agency 4=USGS* Dist. 6=28* 7=28* Co. 8=0, 8, 7, *

Lat. Long. 9=3, 3, 2, 6, 5, 6, * 10=0, 8, 8, 3, 3, 5, 8, * Well No. 12=K, 0, 3, 7, *

Location 13=S, W, S, W, 8, 0, 6, T, 1, 8, N, R, 1, 7, E, * Alt. 16=2, 4, 0, *

Hyd. Unit (OWDC) 20= Date 21=0, 6, 1, 2, 5, 1, 1, 9, 8, 0, *

Well use 23=W * Water Use 24=N * Hole depth 27=1, 3, 8, 3, * Well depth 28=1, 3, 1, 2, *

WL 30=8, 5, * Date 31=0, 6, 1, 1, 9, 1, 1, 9, 8, 1, * Source 33=D *

Status 273= Project No. 5=0, 0, 2, 0, 0, *

OWNER

R=156* T=A* Date 159# 0, 6, 1, 1, 9, 1, 1, 9, 8, 1, * Owner No. Well #2

Owner 161# G, O, L, D, E, N, T, R, I, A, N, G, L, E, I, N, D, *

FIELD QW

R=192* T=A* Date 193# / / Temp. 196# 00010* 197=

R=192* T=A* Date 193# / / Cond. 196# 00095* 197=

R=192* T=A* Date 193# / / pH 196# 00400* 197=

CONSTR.

R=58* T=A* 59# 1* Date 60=0, 6, 1, 1, 9, 1, 1, 9, 8, 1, * Remarks

Drlg. 63=3, 3, 0, * Name HERNDON Method 65=H * Finish 66=5 *

CASING

R=76* T=A* 59# 1*

Top csgn. 77# 0, * Bot. csgn. 78=1, 2, 2, 0, * Diam. 79# 1, 2, *

R=76* T=A* 59# 1*

Top csgn. 77# 1, 1, 4, 0, * Bot. csgn. 78=1, 2, 2, 2, * Diam. 79# 8, *

R=76* T=A* 59# 1* 77# 1272.* 78=1282.* 79# 8.*

OPENINGS

R=82* T=A* 59# 1* Top 83# 1, 2, 2, 2, * Bottom 84=1, 2, 7, 2, *

Type 85=S * Diam. 87=8, * Size 88=

R=82* T=A* 59# 1* Top 83# 1, 2, 8, 2, * Bottom 84=1, 3, 1, 2, *

Type 85=S * Diam. 87=8, * Size 88=

YIELD

R=146 * T=A* 147# 1 * Q 150=1, 0, 8, 4, * Q/S 272=

134 flows 146 pumped

R=42* T=A* Lift type 43# T* Intake 44# Power type 45# E*

DATE 38-06/19/1981* H.P. 46-100.0*

R=198* T=A* Log 199# E* Top 200-1.7* Bot 201-13.83*

R=198* T=A* Log 199# D* Top 200-0* Bot 201-13.83*

R=189* T=A* E Log No. 190# 0.90* 191- M I S S D I S T *

R=114* T=A* Year 115# Type 120#

R=90* T=A* 256# 1* Top 91-1770* Bot 92-

Unit ID 93- ZLICOKR* Name of Unit

R=90* T=A* 256# 1* Top 91- Bot 92-

Unit ID 93- Name of Unit

R=98* T=A* 99# 1* Unit tested 100- 103-

R=105* T=A* 99# 1* Test No. 106#

107- Transmissivity (gal/d)/ft

108- Hydraul. cond. (gal/d)/ft²

110- Storage coeff. Boundaries

R=121* T=A* Begin 122# 9.8* Network 258-

Water Level Data Collection (1)

WL = 74.50 12/2/82

WL = 81.35 - 08/20/87

description of formations encountered	from	to
Surface Casing	0	18
Blue Clay	18	30
Gumbo	30	270
Sand	270	300
Gumbo	300	660
Streaked Sand & Gumbo	660	690
Pink & Gray Gumbo	690	720
Gumbo	720	930
Streaked Gumbo & Sand	930	960
Gumbo	960	1110
Streaked Sand & Gumbo	1110	1230
Sand	1230	1310
Streaked Sand & Gumbo	1310	1383

FILE COPY

LOWNDES
K37
6-19-81
Elog #90

MISSISSIPPI
 BOARD OF WATER COMMISSIONERS
 416 North State Street
 Jackson, Mississippi 39201

COPIED

WATER WELL DRILLERS LOG

19 June 1981 Herndon Well & Supply, Inc. Lowndes
 date well completed firm name county well located

LANDOWNER: Golden Triangle	description of formations encountered	from	to
Industrial Park Well #2			
Lowndes County, MS	Blue Clay	18	30
(mailing address)	Gumbo	30	270
WELL LOCATION:	Sand	270	300
sec. <u>6</u> T <u>18</u> N R <u>17</u> E	Gumbo	300	660
<u>6</u> miles West of <u>Columbus</u>	Streaked Sand & Gumbo	660	690
(distance) (direction) (nearest town)	Pink & Gray Gumbo	690	720
WELL PURPOSE: <u>Industrial</u>	Gumbo	720	930
(home, irrigation, municipal, industrial)	Streaked Gumbo & Sand	930	960
WELL COMPLETION DATA:	Gumbo	960	1110
(1) diameter (inches) <u>12"</u>	Streaked Sand & Gumbo	1110	1230
(2) total depth (feet) <u>1312'</u>	Sand	1230	1310
(3) static water level (feet) <u>85</u> below top of ground.	Streaked Sand & Gumbo	1310	1383
(4) casing <u>Steel</u> <u>1220</u>			
(material) (depth)			
12 x 8" (size) if telescope see back.			
(5) screen <u>80'</u> <u>1220</u>			
(length) (depth to top)			
<u>8"</u> <u>SS Ribbed</u>			
(size) (material)			
(6) pump <u>100</u> <u>1084</u>			
(HP) (yield gpm)			
<u>Elec.</u>			
(type power)			
(7) electric log <u>yes</u>			
(yes or no)			
<u>MS Geo. Survey</u>			
(organization running log)			
(8) how well bottom plugged <u>BW Valve</u>			
DRILLERS REMARKS:			

17 18 19 20 21 22 23 24 25 26
 JUN 1981
 RECEIVED

(7)

If well telescopes please sketch and show depths.

GROUND LEVEL

1220' of 12" Casings

Top of LAP
1140'

Top of Screen
1222'

50' of 8" Screen

10' of 8" Blank

30' of 8" Screen

B.W. Valve
1312'

If more than one screen, show locations of each on sketch.

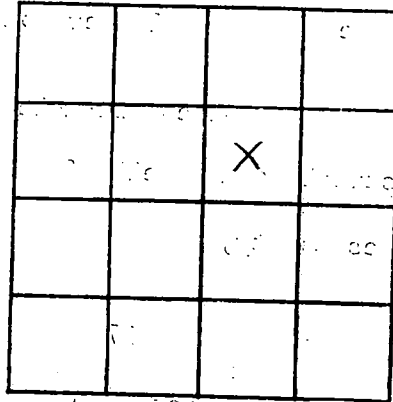

SECTION 6

Please indicate well location X.

ADDITIONAL INFORMATION

1220
50
130
1312

1312

BENT OAK QUAD

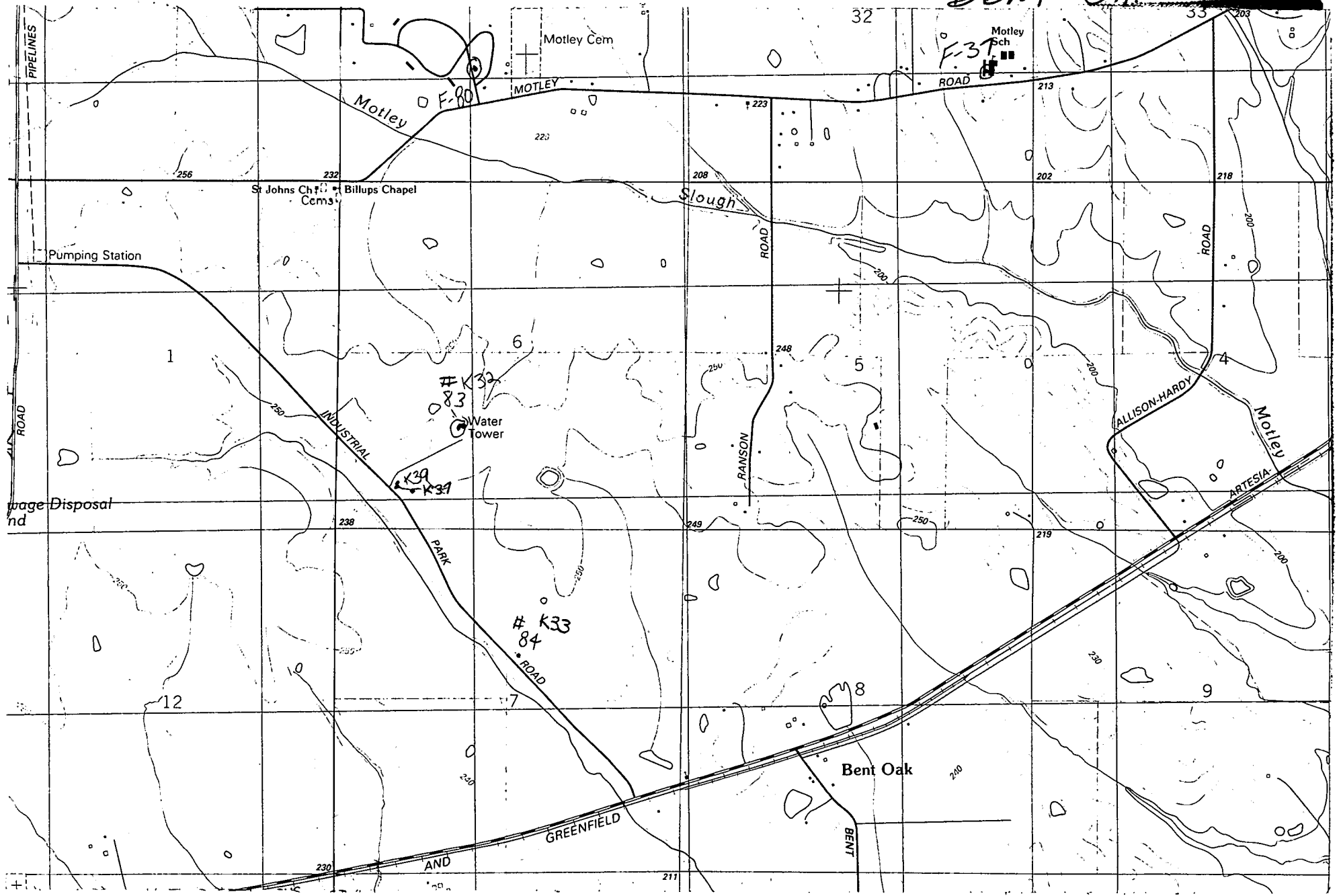

Observation Well

County LOWNDES

Well No. K37

Owner's Name Golden TRI IND PARK

Location _____
(town)

(miles and direction from center of town)

Other description _____

SW 1/4 SW 1/4 Sec. 6 19N 17E

Depth 1312' Diameter 12" x 8" Date drilled 1981

Formation Coker

Elev. of lsd 240' Recorder _____
Type _____ No. _____

M.P. _____ at _____ ft ^{above} below lsd. Date _____

M.P. _____ at _____ ft ^{above} below lsd. Date _____

M.P. _____ at _____ ft ^{above} below lsd. Date _____

Special _____

Water Level _____ 75' (1982)

Sketch of location _____ Sketch of well head _____