

U.S. GEOLOGICAL SURVEY
WATER RESOURCES DIVISION
MISSISSIPPI DISTRICT

TRANSMITTED

2/77

Columbus Sp.
~~BENT BAR~~

WELL RECORD

Record by WTO

Date 5-5-76

County Lauderdale

Well No. K29

GEN. SITE DATA

Site ID

332724088295701

E-log No. 66

Data reliab. 3=

U

Report. agency 4=

U S G S

R= 0

T=

A

M

W

County 8=

087

Lat/Long. 9=

332728

Dist. 6=

2

8

7

2

8

Well No. 12=

K029

Loc. 16=

SENE S 03

10=

088

2957

Alt. 16=

240

Hyd. Unit (OWDC) 20=

T 18 N R 17 E

Date 21=

05/05

Hole depth 27=

905

Well use 23=

W

Water use 24=

N

WL 30=

84

Date 31=

06/02/1976

Source 33=

D

OWNER

R = 158

T =

A

M

Date 159#

06/02/1976

Owner No.

Owner 161=

CARREN

CRANE SERVICE INC.

FIELD QW

R = 192

T =

A

M

Date 193#

07/01/1976

Additional cards same R thru

193 for each parameter.

Temp. 196#

00010

°C 197=

19.5

Cond. 196#

00095

uMhos 197=

190

pH 196#

00400

Value 197=

8.5

CONSR.

R = 58

T =

A

M

59# 1

Date 60=

06/02/1976

Drlr 63=

064

Name: Layne

Finish 66=

S

Remarks

Method

65=

H

R = 76

T =

A

M

59# 1

Top csng 77#

- 0

Bot. csng 78=

547

Diam. 79#

12

R = 76

T =

A

M

59# 1

Top csng 77#

527

Bot. csng 78=

577

Diam. 79#

8

R = 82

T =

A

M

59# 1

Top 83#

577

Bot. 84=

628

Type 85=

S

Diam. 87=

8

Size 88=

R=82

T=

A

M

59#

83#

84=

85=

87=

88=

R = 134

146

T =

A

M

147# 1

Q 150=

500

*Q/s 272=

8.6

LIFT

R= 42 * T= (A) M * Lift type 43# T * Intake 44= 250 * Power type 45= E *
 Date 38= 06/21/976 * H.P. 46= 60 . *

LOGS

R= 198 * T= (A) M * Log 199# D * Top 200= 0 . * Bot. 201= 965 . *
 R= 198 * T= (A) M * Log 199# E * Top 200= 4 . * Bot. 201= 818 . *
 R= 189 * T= (A) * 190# 066 * 191= M I S S D I S T *

ANAL.

R= 114 * T= (A) M * Year 115# 1976 * Type 120= B *

AQUIFERS

R= 90 * T= (A) M * 256# 1 * Top 91= 580 . * Bot. 92= 628 . *
 Unit ID 93= 21160 RDX * Name of unit _____
 R= 90 * T= A M * 256# * Top 91= . * Bot. 92= . *
 Unit ID 93= _____ * Name of unit _____

HYDRAULICS

R= 98 * T= A M * 99# 1 * Unit tested 100= _____ *
 R= 105 * T= A M * 99# 1 * Test No. 106# _____ *
 Transmissivity 107= _____ * T(gal/d)/ft _____
 Hydraul. conduct. 108= _____ * P(gal/d)/ft² _____
 Storage coeff. 110= . _____ * Boundaries _____

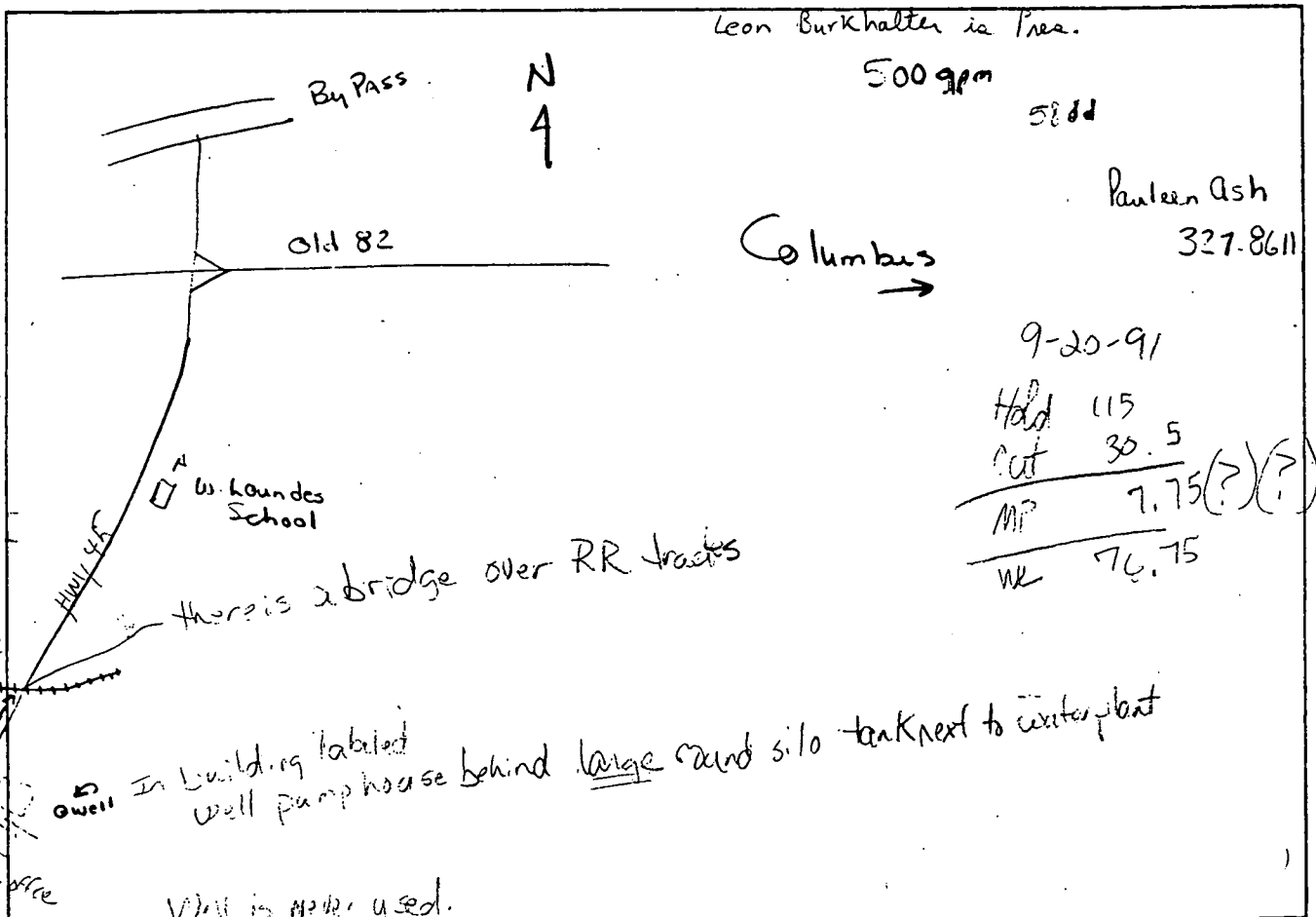

Lowndes
K29
6-2-76
Flag #66

MISSISSIPPI
BOARD OF WATER COMMISSIONERS
416 North State Street
Jackson, Mississippi 39201

CODED

WATER WELL DRILLERS LOG

6-2 1976 Louis Central Company Lowndes
date well completed firm name county well located

LANDOWNER:
Car-Pen
Columbus, Miss
(mailing address)
WELL LOCATION:
sec. 3 T 19 N R. 17 E
miles _____ of _____
(distance) (direction) (nearest town)
WELL PURPOSE: Industrial
(home, irrigation, municipal, industrial)

WELL COMPLETION DATA:
(1) diameter (inches) 12"
(2) total depth (feet) 634'
(3) static water level (feet) 84' below above top of ground.
(4) casing Steel 577'
(material) (depth)
12" if telescope see back.
(size) 30' 9 8"
(5) screen 50' 577'
(length) (depth to top)
8" S.S.
(size) (material)
(6) pump 60 500
(HP) (yield gpm)
Electric
(type power)
(7) electric log yes
(yes or no)
Miss. Res. Survey
(organization running log)
(8) how well bottom plugged Valve

description of formations encountered	from to	
<u>Fill Clay</u>	<u>0</u>	<u>4</u>
<u>Lime</u>	<u>4</u>	<u>28</u>
<u>Hard Clay</u>	<u>28</u>	<u>159</u>
<u>Clay and Sand streaks</u>	<u>159</u>	<u>200</u>
<u>Hard Clay</u>	<u>200</u>	<u>350</u>
<u>Sandy Sables</u>	<u>350</u>	<u>404</u>
<u>Hard Clay and Rock streaks</u>	<u>404</u>	<u>482</u>
<u>Sand</u>	<u>482</u>	<u>497</u>
<u>Clay</u>	<u>497</u>	<u>530</u>
<u>Sandy Shale</u>	<u>530</u>	<u>579</u>
<u>Sand</u>	<u>579</u>	<u>630</u>
<u>Hard Clay</u>	<u>630</u>	<u>704</u>
<u>Sand</u>	<u>704</u>	<u>723</u>
<u>Clay</u>	<u>723</u>	<u>732</u>
<u>Sand & streaks of clay</u>	<u>732</u>	<u>774</u>
<u>Hard Clay</u>	<u>774</u>	<u>823</u>
<u>Sand</u>	<u>823</u>	<u>826</u>
<u>Hard Clay</u>	<u>826</u>	<u>866</u>
<u>Sand</u>	<u>866</u>	<u>875</u>
<u>Clay</u>	<u>875</u>	<u>905</u>

3 heavy 1/2" g's also
1 thin 1/2" in May
74
RECEIVED

JUL - 7 1976

MISS. BD. OF WATER

DRILLERS REMARKS:

