

GW12813

TRANSMITTED FOR ADP

1/81 WTO

Recorded by

WTO

Date

9/3/81

U.S. GEOLOGICAL SURVEY  
WATER RESOURCES DIVISION  
MISSISSIPPI DISTRICT  
WELL RECORD

Artesia  
8/81

Well No.

E-Log No.

County

Lauderdale

BENT OAK  
155-B

Site ID 3 3 2 8 1 0 0 8 8 3 3 2 0 0 1 R=0\* T=A\* 2=W\*

GEN. SITE DATA

Data reliab. 3=U\* Report. agency 4=USGS\* Dist. 6=28\* 7=28\* Co. 8=0.87\*

Lat. Long. 9=3.32810\* 10=0.883320\* Well No. 12=F080\*

Location 13=NESEWS 31T 19N R 17E\* Alt. 16=225\*

Hyd. Unit (OWDC) 20= Date 21=09/01/1977\*

Well use 23=W\* Water Use 24=H\* Hole depth 27=320\* Well depth 28=305\*

WL 30=60\* Date 31=09/01/1977\* Source 33=D\*

Status 273= Project No. 5=

OWNER

R=158\* T=A\* Date 159#09/01/1977\* Owner No.

Owner 161#MS SHERIFFS RANCH\*

FIELD QW

R=192\* T=A\* Date 193# Temp. 196#00010\* 197=

R=192\* T=A\* Date 193# Cond. 196#00095\* 197=

R=192\* T=A\* Date 193#06/23/1981\* pH 196#00400\* 197=8.3\*

CONSTR.

R=58\* T=A\* 59#1\* Date 60=09/01/1977\* Remarks

Drig. 63=3.30\* Name Herndon Method 65=H\* Finish 66=S\*

CASING

R=76\* T=A\* 59#1\*

Top csng. 77# 0.0\* Bot. csng. 78= Diam. 79# 6.0\*

R=76\* T=A\* 59#1\*

Top csng 77# Bot. csng. 78= Diam. 79#

OPENINGS

R=82\* T=A\* 59#1\* Top 83# 263.0\* Bottom 84= 305.0\*

Type 85=S\* Diam. 87= 3.0\* Size 88=

R=82\* T=A\* 59#1\* Top 83# Bottom 84=

Type 85= Diam. 87= Size 88=

YIELD

R=146\* T=A\* 147# 1\* Q 150= 30.0\* Q/S 272=

134 flows 146 pumped

LIFT

R=42\* T= A \* Lift type 43# S\* Intake 44= \* Power type 45= E\*

Date 38= 09/01/1977\* H.P. 46= 3.\*

LOGS

R=198\* T= A \* Log 199# D\* Top 200= 0.\* Bot 201= 320.\*

R=198\* T= A \* Log 199# \* Top 200= \* Bot 201= \*

R=189\* T= A \* E Log No. 190# \* 191= M I S S I S T \*

ANAL.

R=114\* T= A \* Year 115# \* 117= \* 120= \*

AQUIFERS

R=90\* T= A \* 256# 1 \* Top 91= 279.\* Bot 92= 320.\*

Unit ID 93= 2.11 MCSN \* Name of Unit E2

R=90\* T= A \* 256# 1 \* Top 91= \* Bot 92= \*

Unit ID 93= \* Name of Unit

HYDRAULICS

R=98\* T= A \* 99# 1 \* Unit tested 100= \* 103= \*

R=105\* T= A \* 99# 1 \* Test No. 106# \*

107= \* Transmissivity (gal/d)/ft

108= \* Hydraul. cond. (gal/d)/ft<sup>2</sup>

110= \* Storage coeff. Boundaries

Water Level  
10-3-91  
Held 135  
Cut 17.19  
ZLP 1.7  
WZL 116.11

Health Top 44 0079-01

R=121\* T= \* Yr Begin 122# \* Network 258# \*

Water Level Data Collection (1)

T AK = 178  
CL = 179  
CO2 = 0  
Fe = 0.1  
T hard = 22

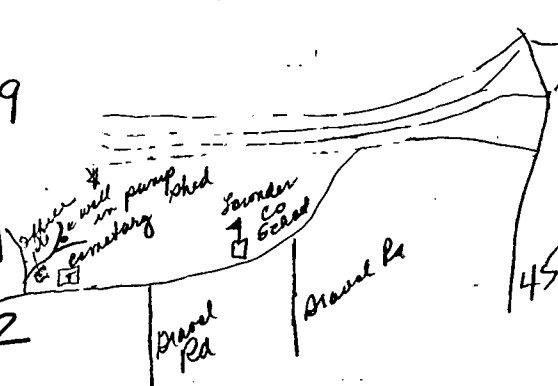

description of formations encountered	from	to
Brown Clay	0	18
Rock	18	19
Blue Rock	19	230
Sand	230	255
Blue Rock	255	258
Sand	258	260
Shale Rock	260	265
Sand	265	275
Shale Rock	275	278
Rock	278	279
Sand	279	320

# Bent Oak Quad

