

HD# 44008001

Well near road

C117 MAY - 1 1975

FORM 9-1642 (1-68)

GWO1864

Well No.

WELL SCHEDULE

E log # 59 PUNCHED

U. S. DEPT. OF THE INTERIOR

GEOLOGICAL SURVEY

WATER RESOURCES DIVISION

Columbus North

MASTER CARD

Bowc

8/74

Hamilton

QUAD. 136C

Water Level Date

12/2/82 WL = 169.75

Record by Q Source of data Obs. driller Date 6-7-74 Map

State 3 Miss 28 County (or town) Lowndes 4 44

Latitude: 33 32 42 N Longitude: 088 24 18 W Sequential number: 1

Lat-long accuracy: 2 17 18 Sec 34 NE SE NW SE

Local well number: C117BD3417518W Other number: B & M

Local use: 064059 Owner or name: E Lowndes WA

Ownership: County, Fed Gov't, City, Corp or Co, Private, State Agency, Water Dist N

Use of water: (A) Air cond, Bottling, Comm, Dewater, Power, Fire, Doon, Irr, Med, Ind, P S, Rec, (S) Stock, Instit, Unused, Reppure, Recharge, Desal-P S, Desal-other, Other P

Use of well: (A) Anode, Drain, Seismic, Heat Res, Obs, Oil-gas, Recharge, Test, Unused, Withdraw, Waste, Destroyed, (W) W

DATA AVAILABLE: Well data Freq. W/L meas.: Field aquifer char.

Hyd. lab. data: Qual. water data; type: Freq. sampling: Pumpage inventory: yes no, period: yes

Log data: E log 18' - 620' D/E

WELL-DESCRIPTION CARD

SAME AS ON MASTER CARD Depth well: 617 ft Meas. rept accuracy 3

Depth cased: 557 ft Casing type: 12 in 1:2

Finish: porous gravel w. gravel w. horiz. open perf., screen, sd. pt., shored, open hole, other G

Method Drilled: air bored, cable, dug, hyd jetted, air reverse, percuss, rotary, driven, drive wash, other H

Date Drilled: 6-7-74 974 Pump intake setting: 280 ft

Driller: Singer Layne Cleveland Miss.

Lift (type): (A) air, bucket, cent, jet, (B) multiple, (C) multiple, (D) multiple, (E) none, piston, rot, submerg, turb, other T Deep Shallow 40

Power (type): diesel, elec, gas, gasoline, hand, gas, wind; H.P. 60 V Trans. or meter no.

Descrip. MP 310 ft above below LSD, Alt. MP

Alt. LSD: 300 Accuracy: (source) topo 4

Water Level: 145 ft above below MP; Ft below LSD Accuracy: D

Date meas: 674 Yield: 700 gpm Method determined

Drawdown: Accuracy: Pumping period hrs

QUALITY OF WATER DATA: Iron Sulfate Chloride Hard.

Sp. Conduct K x 10 Temp. Date sampled

Taste, color, etc.

10-22-91  
Held 189.0  
Cut .95  
W/L 2.9  
W/L 176.15

10477P  
W/L = 178.40

Well No.

Well No. C-117

Latitude-longitude \_\_\_\_\_  
N  
S  
d m s d m s

**HYDROGEOLOGIC CARD**

SAME AS ON MASTER CARD 03 Physiographic Province: \_\_\_\_\_ Section: \_\_\_\_\_

D Drainage Basin: 13L Subbasin: \_\_\_\_\_

Topo of well site: (D) depression, stream channel, dunes, flat, hilltop, sink, swamp, (P) offshore, pediment, hillside, terrace, undulating, valley flat  
(S) (T) (U) (V)

MAJOR AQUIFER: \_\_\_\_\_ system \_\_\_\_\_ series K3 \_\_\_\_\_ aquifer, formation, group Sφ

Lithology: \_\_\_\_\_ S Origin: \_\_\_\_\_ 2 Aquifer Thickness: 60+ ft

Length of well open to: \_\_\_\_\_ ft 60 Depth to top of: \_\_\_\_\_ ft 560

MINOR AQUIFER: \_\_\_\_\_ system \_\_\_\_\_ series \_\_\_\_\_ aquifer, formation, group \_\_\_\_\_

Lithology: \_\_\_\_\_ Origin: \_\_\_\_\_ Aquifer Thickness: \_\_\_\_\_ ft

Length of well open to: \_\_\_\_\_ ft \_\_\_\_\_ Depth to top of: \_\_\_\_\_ ft \_\_\_\_\_

Intervals Screened: \_\_\_\_\_

Depth to consolidated rock: \_\_\_\_\_ ft \_\_\_\_\_ Source of data: \_\_\_\_\_

Depth to basement: \_\_\_\_\_ ft \_\_\_\_\_ Source of data: \_\_\_\_\_

Surficial material: \_\_\_\_\_ Infiltration characteristics: \_\_\_\_\_

Coefficient Trans: \_\_\_\_\_ gpd/ft \_\_\_\_\_ Coefficient Storage: \_\_\_\_\_

Coefficient Perm: \_\_\_\_\_ gpd/ft<sup>2</sup>; Spec cap: \_\_\_\_\_ gpm/ft; Number of geologic cards: \_\_\_\_\_

Drainage 76' 760 gpm  
S.W.L 150'

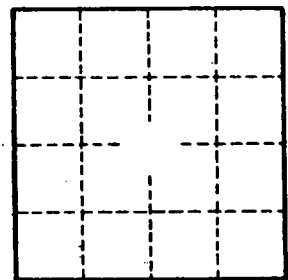
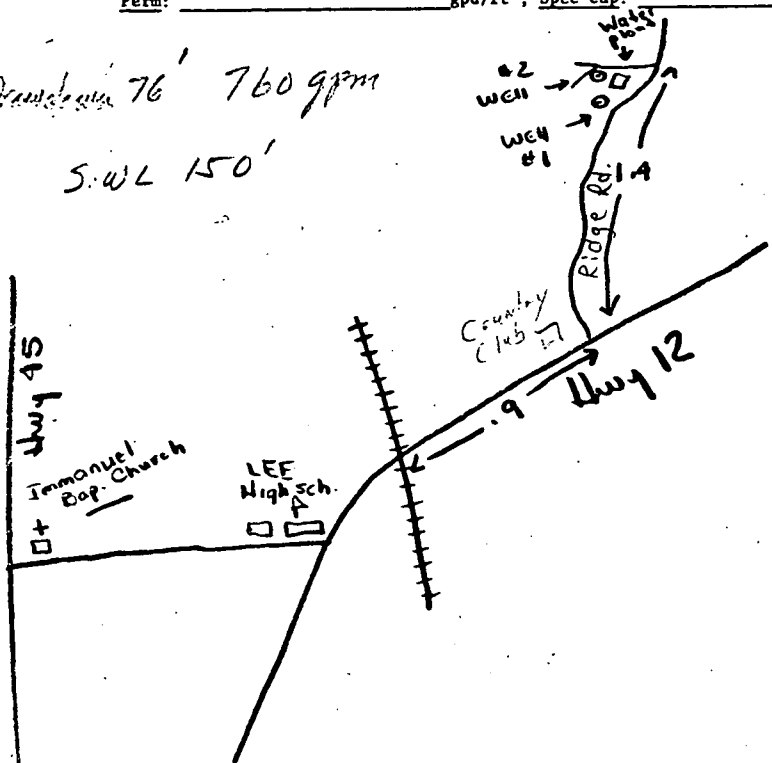

Well No.

UP-DATED 12/4/76

Columbus