

South well

Well No. C 116

PUNCHED MAY 1 1975

WELL SCHEDULE

E-log # 58

U. S. DEPT. OF THE INTERIOR

GEOLOGICAL SURVEY

WATER RESOURCES DIVISION

FILE COPY

MASTER CARD

Record by GJD Source of data Dr. E-log Bowc 8174 Date 5-24-74 Map Caledonia Quadrangle

State 3 31 28 County (or town) Louder 44

Latitude: 33 32 0 N Longitude: 08 24 20 W Sequential number: 1

Lat-long accuracy: 2' T. 17 R. 18 Sec 34 SE & NW & SE &

Local well number: C 116 B D 3 4 1 7 S 1 8 W Other number: south well

Local use: 0:640:58 Owner or name: East Louder Water Assoc.

Owner or name: E LOUDER WA Address: Columbus

Ownership: County, Fed Gov't, City, Corp or Co, Private, State Agency, Water Dist N

Use of Air cond, Bottling, Comm, Dewater, Power, Fire, Dom, Irr, Med, Ind, P S, Rec, water: P

Use of well: Anode, Drain, Seismic, Heat Res, Obs, Oil-gas, Recharge, Test, Unused, Withdraw, Waste, Destroyed. W

DATA AVAILABLE: Well data Freq. W/L meas: Field aquifer char.

Hyd. lab. data: Qual. water data; type: Freq. sampling: Pumpage inventory: Aperture cards: Log data: E-log 6-6521

WELL-DESCRIPTION CARD SAME AS ON MASTER CARD Depth well: 597 Meas. rept 3

Depth cased: 537 Casing type: 12 x 8 in Diam. 12

Finish: porous concrete, gravel w. (perf.), (screen), gravel w. horiz. gallery, end, Method: air bored, cable, dug, hyd jetted, air rot, percussion, rotary, Date: 5-24-74 Pump intake setting: 220

Drilled: Singer Lays Central Cleveland

Lift (type): air, bucket, cent, jet, (cent.) (turb.) Deep Shallow T

Power (type): diesel, elec, gas, gasoline, hand, gas, wind; H.P. 60 Trans. or meter no. Y

Descrip. MP 380 ft above below LSD, Alt. MP

Alt. LSD: 290 Accuracy: 2' cont. interval 5

Water Level: 131 Accuracy: 57 D

Date meas: 674 Yield: 700 Method determined

Drawdown: Accuracy: Pumping period

QUALITY OF WATER DATA: Iron Sulfate Chloride Hard.

Sp. Conduct 120 K x 10^6 Temp. 18.6 Date sampled 6/2/77 677

Taste, color, etc. 5.9

Plant south well #2  
12/2/82 #2  
158. L.67  
156.33  
1.75  
154.68

10/2/78  
NL=153.95

#1 north well

170.  
- 2.75 m  
167.25  
#2

8/11/87

185.00  
10.81  
154.19  
1.75  
152.44

Well No.

Well No. \_\_\_\_\_

Latitude-longitude \_\_\_\_\_ N  
\_\_\_\_\_ S  
\_\_\_\_\_ d \_\_\_\_\_ m \_\_\_\_\_ s

**HYDROGEOLOGIC CARD**

NAME AS ON MASTER CARD

Physiographic Province: \_\_\_\_\_

Section: 03

Drainage Basin: D

Subbasin: 132

Character of site: (D) depression, stream channel, dunes, flat, hilltop, sink, swamp, (E) offshore, pediment, hillside, terrace, undulating, valley flat, (F) (G) (H) (I) (J) (K) (L) (M) (N) (O) (P) (Q) (R) (S) (T) (U) (V)

Major Aquifer: system \_\_\_\_\_ series K3 aquifer, formation, group \_\_\_\_\_ aquifer Thickness: 65 ft

Lithology: \_\_\_\_\_ Origin: S Depth to top of: \_\_\_\_\_ ft 535

Length of well open to: \_\_\_\_\_ ft 60

Minor Aquifer: system \_\_\_\_\_ series \_\_\_\_\_ aquifer, formation, group \_\_\_\_\_ aquifer Thickness: \_\_\_\_\_ ft

Lithology: \_\_\_\_\_ Origin: \_\_\_\_\_ Depth to top of: \_\_\_\_\_ ft \_\_\_\_\_

Length of well open to: \_\_\_\_\_ ft \_\_\_\_\_

Intervals Screened: \_\_\_\_\_ Source of data: \_\_\_\_\_

Depth to consolidated rock: \_\_\_\_\_ ft \_\_\_\_\_ Source of data: \_\_\_\_\_

Depth to basement: \_\_\_\_\_ ft \_\_\_\_\_ Source of data: \_\_\_\_\_

Surficial material: \_\_\_\_\_ Infiltration characteristics: \_\_\_\_\_

Coefficient of Transmissibility: \_\_\_\_\_ gpd/ft \_\_\_\_\_ Coefficient of Storage: \_\_\_\_\_

Coefficient of Permeability: \_\_\_\_\_ gpd/ft<sup>2</sup>; Spec cap: \_\_\_\_\_ gpm/ft; Number of geologic cards: \_\_\_\_\_

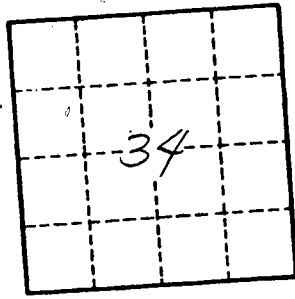
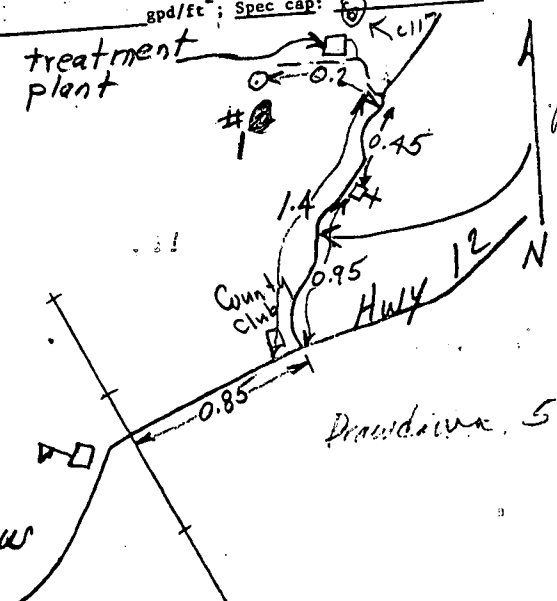

Drawdown 52' at 720 gpm

UP-DATED \_\_\_\_\_

C17314  
Well #1

**LOWNDES**  
**C116**  
**6-4-74**  
**E log # 58**

MISSISSIPPI  
BOARD OF WATER COMMISSIONERS  
416 North State Street  
Jackson, Mississippi 39201

**CODED**

**WATER WELL DRILLERS LOG**

June 4, 1974 Singer-Layne Central Div. Lowndes  
date well completed firm name county well located

LANDOWNER:	description of formations encountered	from	to
East Lowndes Water Association	Sandy Clay	0	14
Columbus, Mississippi	Sand & Clay Strks.	14	103
(mailing address)	Hard Shale	103	109
<b>WELL LOCATION:</b>	Blue Clay	109	139
sec. 34 T. 17 N. R. 18 E. S. 5 W.	Sand & Clay Strks.	139	151
miles _____ of Columbus	Clay	151	196
(distance) (direction) (nearest town)	Sandy Clay	196	212
<b>WELL PURPOSE:</b> Municipal	Shale	212	263
(home, irrigation, municipal, industrial)	Sand	263	292
<b>WELL COMPLETION DATA:</b>	Shale	292	317
(1) diameter (inches) 12"	Sand	317	340
(2) total depth (feet) 604' 4"	Sand & Shale Strks.	340	348
(3) static water level (feet) 131' below top of ground.	Sand (Med.) Coarse	348	373
Inner (4) casing Steel 535'	Limestone	373	425
Casing: Size-8" (material) Length-67' 4" (depth)	Sand	425	465
12" (size) if telescope see back.	Sand & Clay Strks.	465	475
2' 4"-Blank (5) screen 60' 597' 4" (length) (depth to top)	Sand	475	495
8" Stainless Steel (size) (material) bottom	Clay	495	543
(6) pump 60 (HP) 700 (yield gpm)	Sand	543	599
Electric (type power)	Hard Shale	599	656
(7) electric log Yes (yes or no)			
U. S. Geological Survey (organization running log)			
(8) how well bottom plugged 7' Backpressure Valve (6")			
<b>DRILLERS REMARKS:</b>			

**CODED**

MISSISSIPPI BOARD OF WATER COMMISSIONERS  
JUN 23 1974

MISS. BOARD OF WATER COMMISSIONERS



