

# FILE COPY WELL SCHEDULE

Well No. C22

U. S. DEPT. OF THE INTERIOR

GEOLOGICAL SURVEY

WATER RESOURCES DIVISION

**PUNCHED**

### MASTER CARD

Record by Wat-TNS Source of data Owner Date 8-14-56 Map \_\_\_\_\_

State 28 County (or town) 44

Latitude: 33° 37' 04" N Longitude: 088° 24' 47" W Sequential number: 1

Lat-long accuracy: 2' T. SE S. SE R. NW W. Sec \_\_\_\_\_

Local well number: C022DB0317318W Other number: \_\_\_\_\_

Local use: \_\_\_\_\_ Owner or name: \_\_\_\_\_

Owner or name: T S HODGES Address: \_\_\_\_\_

MAR 6 1973

Ownership: County, Fed Gov't, City, Corp or Co, Private, State Agency, Water Dist. B

Use of Air cond, Bottling, Comm, Dewater, Power, Fire, Dom, Irr, Med, Ind, P S, Rec, water: \_\_\_\_\_ H

Use of well: (A) Anode, (D) Drain, (G) Seismic, (H) Heat Res, (O) Obs, (P) Oil-gas, (R) Recharge, (T) Test, (U) Unused, (W) Withdraw, (X) Waste, (Z) Destroyed. W

DATA AVAILABLE: Well data  Freq. W/L meas.:  Field aquifer char.

Hyd. lab. data: \_\_\_\_\_

Qual. water data; type: \_\_\_\_\_

Freq. sampling: \_\_\_\_\_ Pumpage inventory:  no; period: \_\_\_\_\_

Aperture cards: \_\_\_\_\_ yes

Log data: \_\_\_\_\_

### WELL-DESCRIPTION CARD

SAME AS ON MASTER CARD Depth well: 360 Meas. 6

Depth cased: \_\_\_\_\_ Casing type: \_\_\_\_\_; Diam: 4 in

Finish: porous concrete, gravel w. (perf.), (screen), gallery, end, horiz. open perf., sd. pt., shored, open hole, other X

Method Drilled: air bored, cable, dug, hyd jetted, rot., air reverse percussion, rotary, trenching, driven, drive wash, other H

Date Drilled: 9-4-59 Pump intake setting: \_\_\_\_\_ ft

Driller: Clardy Bros address \_\_\_\_\_

Lift (type): air, bucket, cent, jet, multiple, multiple, none, piston, rot, submerg, turb, other P Deep  Shallow

Power (type): diesel, elec, gas, gasoline, hand, gas, wind; H.P. 1/2 Trans. or meter no. 5

Descrip. MP \_\_\_\_\_ ft above LSD, Alt. MP \_\_\_\_\_

Alt. LSD: 210 Accuracy: \_\_\_\_\_

Water Level: \_\_\_\_\_ ft above MP; \_\_\_\_\_ ft below LSD 110 Accuracy: \_\_\_\_\_

Date meas: 5-6 Yield: \_\_\_\_\_ gpm Method determined \_\_\_\_\_

Drawdown: \_\_\_\_\_ ft Accuracy: \_\_\_\_\_ Pumping period \_\_\_\_\_ hrs

QUALITY OF WATER DATA: Iron \_\_\_\_\_ ppm Sulfate \_\_\_\_\_ ppm Chloride \_\_\_\_\_ ppm Hard. \_\_\_\_\_ ppm

Sp. Conduct \_\_\_\_\_ K x 10<sup>6</sup> Temp. \_\_\_\_\_ °F Date sampled \_\_\_\_\_

Taste, color, etc. \_\_\_\_\_

4/29/82  
45.  
27.35  
17.65  
50.  
17.15

10/3/78  
32.33  
22.74  
9.59

Well No.

Latitude-longitude \_\_\_\_\_ N  
d m s d m s

**GEOLOGIC CARD**

SAME AS ON MASTER CARD

Physiographic Province: \_\_\_\_\_

Section: 03

Drainage Basin: D

Subbasin: 134

*Ever a map*

Top of well site: (C) (E) (P) (H) (K) (L)  
Depression, stream channel, dunes, flat, hilltop, sink, swamp,

(O) (P) (S) (T) (U) (V)  
offshore, pediment, hillside, terrace, undulating, valley flat

MAJOR AQUIFER: \_\_\_\_\_ system \_\_\_\_\_ series K3 \_\_\_\_\_ aquifer, formation, group G1

Lithology: \_\_\_\_\_ Origin: \_\_\_\_\_ Aquifer Thickness: \_\_\_\_\_ ft

Length of well open to: \_\_\_\_\_ ft \_\_\_\_\_ Depth to top of: \_\_\_\_\_ ft \_\_\_\_\_

MINOR AQUIFER: \_\_\_\_\_ system \_\_\_\_\_ series \_\_\_\_\_ aquifer, formation, group \_\_\_\_\_

Lithology: \_\_\_\_\_ Origin: \_\_\_\_\_ Aquifer Thickness: \_\_\_\_\_ ft

Length of well open to: \_\_\_\_\_ ft \_\_\_\_\_ Depth to top of: \_\_\_\_\_ ft \_\_\_\_\_

Intervals Screened:

Depth to consolidated rock: \_\_\_\_\_ ft \_\_\_\_\_ Source of data: \_\_\_\_\_

Depth to basement: \_\_\_\_\_ ft \_\_\_\_\_ Source of data: \_\_\_\_\_

Surficial material: \_\_\_\_\_ Infiltration characteristics: \_\_\_\_\_

Coefficient Trans: \_\_\_\_\_ gpd/ft \_\_\_\_\_ Coefficient Storage: \_\_\_\_\_

Coefficient Perm: \_\_\_\_\_ gpd/ft<sup>2</sup>; Spec cap: \_\_\_\_\_ gpm/ft; Number of geologic cards: \_\_\_\_\_

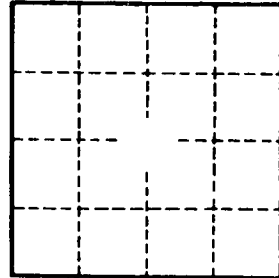
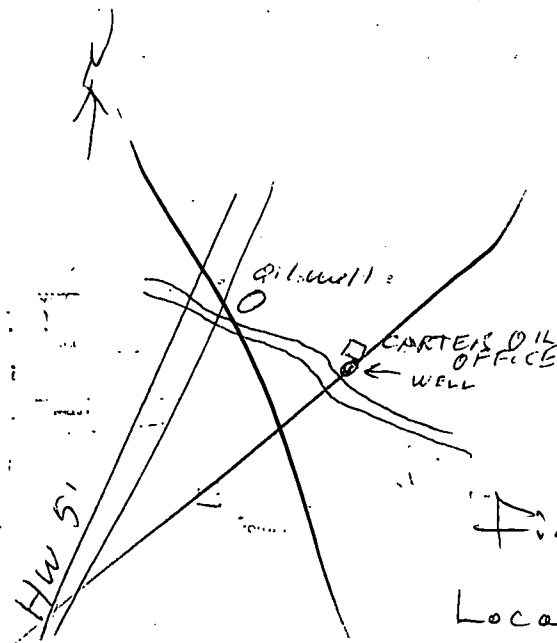

Well No. \_\_\_\_\_

8/10/87  
Could not

find well.  
Located in  
wooded area  
heavily overgrown.

Check in  
winter

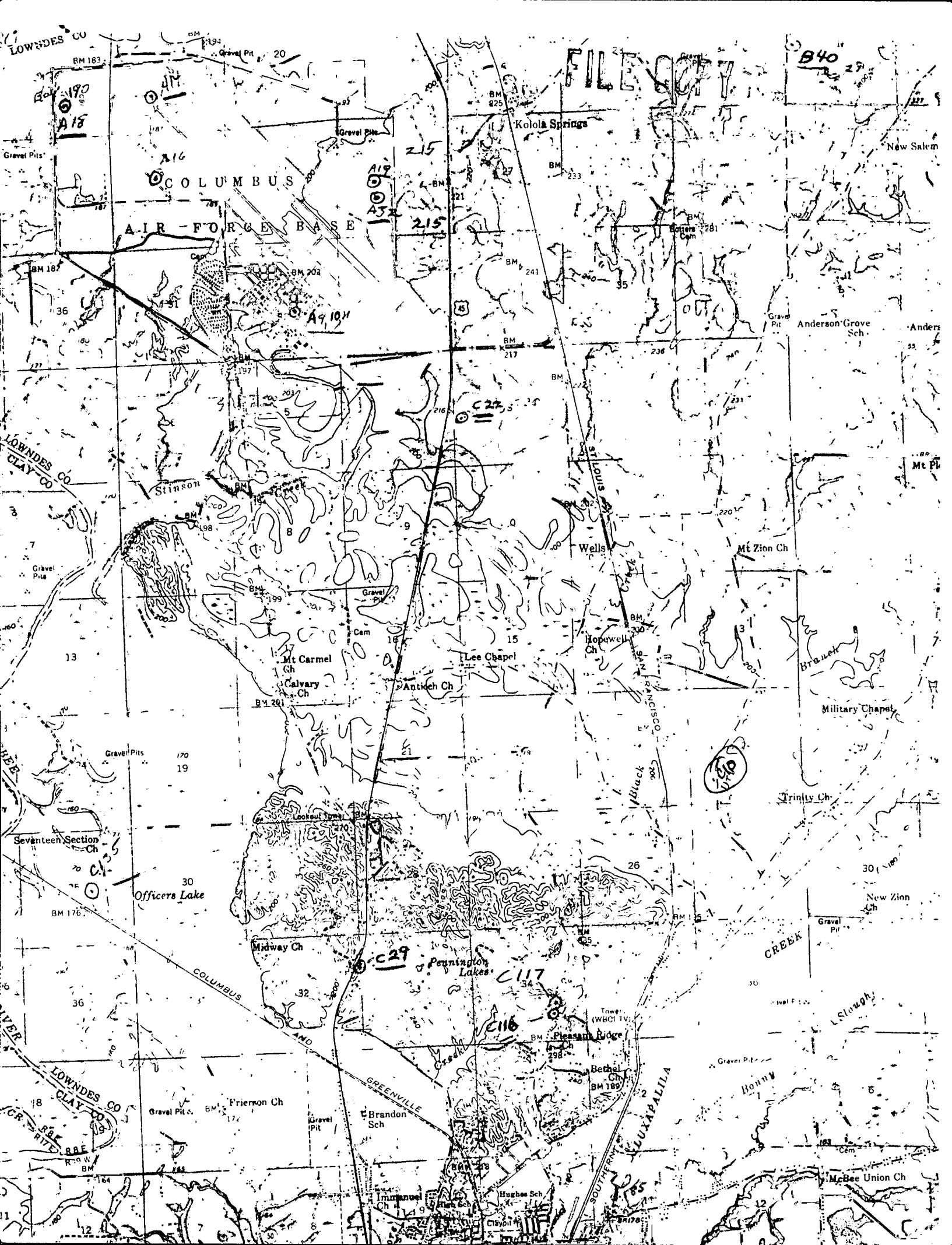

*Louder County*  
*- 211 Gaid*

FORM NO. 9-1904-E  
 Revised September 1980

U.S. DEPT. OF INTERIOR  
 GEOLOGICAL SURVEY  
 WATER RESOURCES DIVISION  
 WATER-LEVEL DATA

WELL NO. C22  
 MP HEIGHT \_\_\_\_\_

*owner: J S Hodges*

Site Ident. No. 333704088244701  
5 19

R = 234 \* T = A \*

DATE	WATER LEVEL (BELOW LSD)	STATUS	METHOD	HOLD	CUT	DEPTH BELOW MP	REMARKS	DATE PUNCHED	DATE ENTERED
235 # 11/29/1982 *	237 = 17.15 *	238 = *	239 = *						
235 # 10/28/1987 *	237 = 22.74 *	238 = *	239 = *						
235 # / / / *	237 = . . . *	238 = *	239 = *						
235 # / / / *	237 = . . . *	238 = *	239 = *						
235 # / / / *	237 = . . . *	238 = *	239 = *						
235 # / / / *	237 = . . . *	238 = *	239 = *						
235 # / / / *	237 = . . . *	238 = *	239 = *						
235 # / / / *	237 = . . . *	238 = *	239 = *						
235 # / / / *	237 = . . . *	238 = *	239 = *						
235 # / / / *	237 = . . . *	238 = *	239 = *						
235 # / / / *	237 = . . . *	238 = *	239 = *						
235 # / / / *	237 = . . . *	238 = *	239 = *						
235 # / / / *	237 = . . . *	238 = *	239 = *						
235 # / / / *	237 = . . . *	238 = *	239 = *						
235 # / / / *	237 = . . . *	238 = *	239 = *						
235 # / / / *	237 = . . . *	238 = *	239 = *						
235 # / / / *	237 = . . . *	238 = *	239 = *						
235 # / / / *	237 = . . . *	238 = *	239 = *						
235 # / / / *	237 = . . . *	238 = *	239 = *						
235 # / / / *	237 = . . . *	238 = *	239 = *						
235 # / / / *	237 = . . . *	238 = *	239 = *						
235 # / / / *	237 = . . . *	238 = *	239 = *						
235 # / / / *	237 = . . . *	238 = *	239 = *						
235 # / / / *	237 = . . . *	238 = *	239 = *						
235 # / / / *	237 = . . . *	238 = *	239 = *						
235 # / / / *	237 = . . . *	238 = *	239 = *						
235 # / / / *	237 = . . . *	238 = *	239 = *						
235 # / / / *	237 = . . . *	238 = *	239 = *						
235 # / / / *	237 = . . . *	238 = *	239 = *						
235 # / / / *	237 = . . . *	238 = *	239 = *						
235 # / / / *	237 = . . . *	238 = *	239 = *						

MEASURING POINT  
 R = 320 \* T = A D M \*  
add, delete, modify

Method of Measurement  
 239 = A B C E G H L M N R S T V Z  
airline, analog, calibrated, estimated, pressure, calibrated, geophysical, manometer, non-reported, steel, electric, calibrated, other  
 airline gage pressure logs recording gage, tape tape electric tape

M.P. Begin Date 321 # / / / / / \*  
 M.P. End Date 322 = / / / / / \*  
 M.P. Height 323 = . . . \*  
 M.P. Remark 324 = \_\_\_\_\_ \*

Site Status  
 238 = D E F G H I J N Ø P R S T V W X Z  
dry, recently, flowing, nearby, flowing, nearby, injector, injector, discon- obstruction, pumping, recently, nearby, nearby, foreign, well, affected by, other  
 flowing flowing recently flowing monitor measuring, pumped pumping recently matter destroyed surface water site