

JUN 10 1975

FORM 9-1642 (1-68)

Well No. 3

PUNCHED

WELL SCHEDULE

U. S. DEPT. OF THE INTERIOR GEOLOGICAL SURVEY WATER RESOURCES DIVISION

MASTER CARD

Record by E H L Source of data REA Date 12/14/53 Map Schleicher 15' 1961

State Illiss County (or town) Lafone

Latitude: 33° 41' 35" N Longitude: 090° 26' 24" W Sequential number: 1

Lat-long accuracy: 2 T 2 S, R 2 E Sec 18, NW, NE

Local well number: C 0 0 3 8 A 1 B 2 1 N 0 2 U Other number: B & M

Local use: Owner or name: E. H. FULBRIGHT Address: ROSEDALE

Ownership: County, Fed Gov t, City, Corp or Co, Private, State Agency, Water Dist

Use of water: (A) Air cond, Bottling, Comm, Dewater, Power, Fire, Dom, Ind, Med, Ind, P S, Rec, (S) Stock, Instit, Unused, Repressure, Recharge, Desal-P S, Desal-other, Other

Use of well: (A) Anode, Drain, Seismic, Heat Res, Obs, Oil gas, Recharge, Test, Unused, Withdraw, Waste, Destroyed

DATA AVAILABLE: Well data Freq. W/L meas.: Field aquifer char.

Hyd. lab. data:

Qual. water data; type:

Freq. sampling: Pumpage inventory: period:

Aperture cards:

Log data:

WELL-DESCRIPTION CARD

SAME AS ON MASTER CARD Depth well: 95 ft Meas. accuracy

Depth cased; (first perf.) ft Casing type: ; Diam. 16 in

Finish: (C) porous concrete, (F) gravel w. (perf.), (G) gravel w. (screen), (H) horiz. gallery, (O) open end, (P) perf., (S) screen, (T) sd. pt., (W) shored, (X) open hole, (Z) other

Method Drilled: (A) rot, (B) bored, (C) cable dug, (D) hyd. rot., (H) hyd., (J) jected, (P) air percussion, (R) reverse, (T) trenching, (V) driven, (W) drive wash, (Z) other

Date Drilled: Mar 1953 9 5 3 Pump intake setting: ft

Driller: Geo. J. ... name address Wilmington, Ark

Lift (type): (A) air, (B) bucket, (C) cent., (J) jet, (L) multiple, (M) multiple, (N) none, (P) piston, (R) rot, (S) submerg, (T) turb., (Z) other Deep Shallow

Power (type): diesel, elec, gas, nat gas, gasoline, hand, gas, wind; H.P. 60 Trans. or meter no. 77A92 1173

Descrip. MP Water in P. Base at above below LSD, Alt. MP

Alt. LSD: 125 ft Accuracy: (source) topo 5' 1'

Water Level: 15.29 ft above below MP; Ft below LSD Accuracy:

Date meas: 12/2/53 Yield: 2500 gpm Method determined

Drawdown: ft Accuracy: Pumping period hrs

QUALITY OF WATER DATA: Iron ppm Sulfate ppm Chloride ppm Hard. ppm

Sp. Conduct K x 10⁶ Temp. °F Date sampled

Taste, color, etc.

Well No. _____

Latitude-longitude _____
N
S
d m s d m s

HYDROGEOLOGIC CARD

SAME AS ON MASTER CARD 19 Physiographic Province: 03 Section: _____

E Drainage Basin: 154 Subbasin: _____

Topo of well site: (D) depression, stream channel, dunes, flat, hilltop, sink, swamp, (P) offshore, pediment, hillside, terrace, undulating, valley flat (V)

MAJOR AQUIFER: system _____ series Q.G aquifer, formation, group M.A

Lithology: 4.5 Origin: 2 Aquifer Thickness: _____ ft

Length of well open to: 8.5 ft 4.0 Depth to top of: 1.0 ft

MINOR AQUIFER: system _____ series _____ aquifer, formation, group _____

Lithology: _____ Origin: _____ Aquifer Thickness: _____ ft

Length of well open to: _____ ft _____ Depth to top of: _____ ft

Intervals Screened: _____

Depth to consolidated rock: _____ ft _____ Source of data: _____

Depth to basement: _____ ft _____ Source of data: _____

Surficial material: _____ Infiltration characteristics: _____

Coefficient Trans: _____ gpd/ft _____ Coefficient Storage: _____

Coefficient Perm: _____ gpd/ft²; Spec cap: _____ gpm/ft; Number of geologic cards: _____

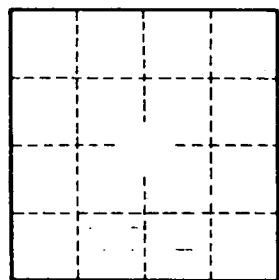
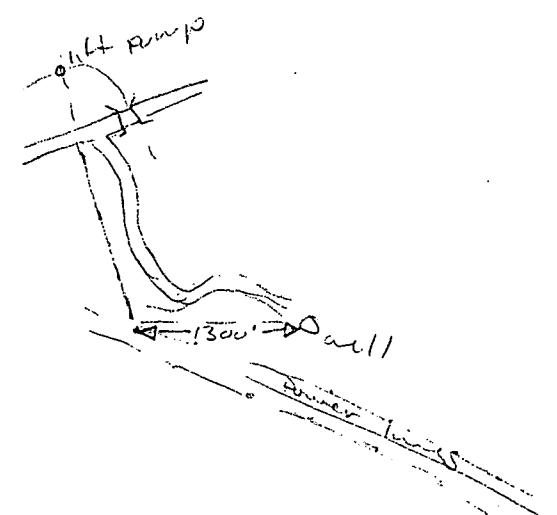

Well No. _____