

OIL & GAS WELL SCHEDULE

County: 81

Well No.: 0601

Company: moon-Hines-Tigrett; Pruet; Baria

Well: #1 Wygul 25-3

Location: 1660' FWL + 990' FNL S 25 T 11 S R 6 E

Elevation:

G.L.: 238'

D.F.: _____

K.B.: 251'

SHANNON QUAD

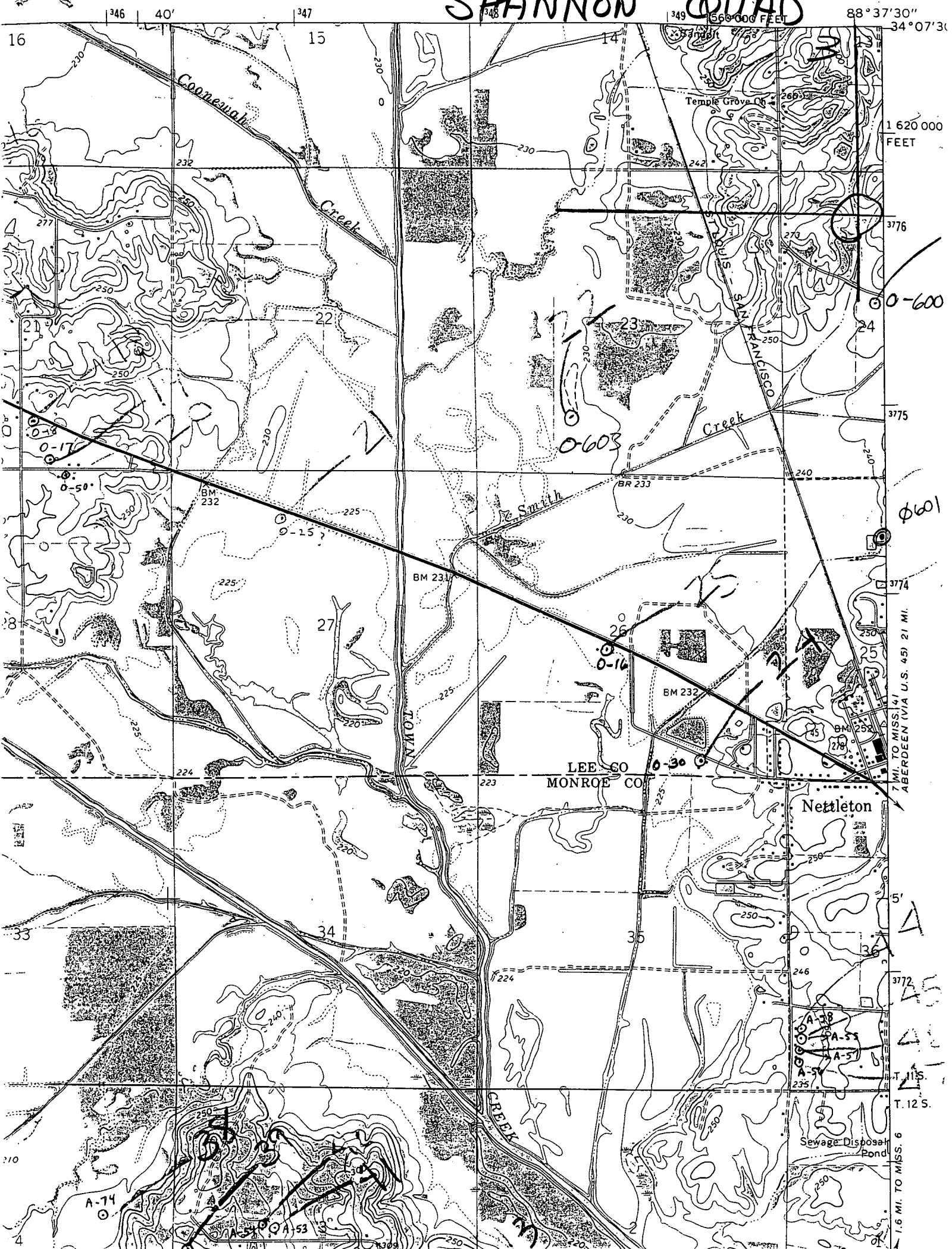

660,000 FEET

88° 37' 30" 34° 07' 30"

1 620 000 FEET

7 MI. TO MISSISSIPPI ABERDEEN (VIA U.S. 45) 21 MI.

T. 11 S. T. 12 S. 1.6 MI. TO MISS. 6