

OIL & GAS WELL SCHEDULE

County: 81Well No.: Ø600Company: Moon-Hines-Tigrett; Pruett; Baria-MasonWell: Dabbs 24-6 #1
NW/SW/SE/NWLocation: 2250' FNL & 1650' FWL S24 T11S R6E

Elevation:

G.L.: 255'D.F.: 267'K.B.: 268'

SHANNON QUAD

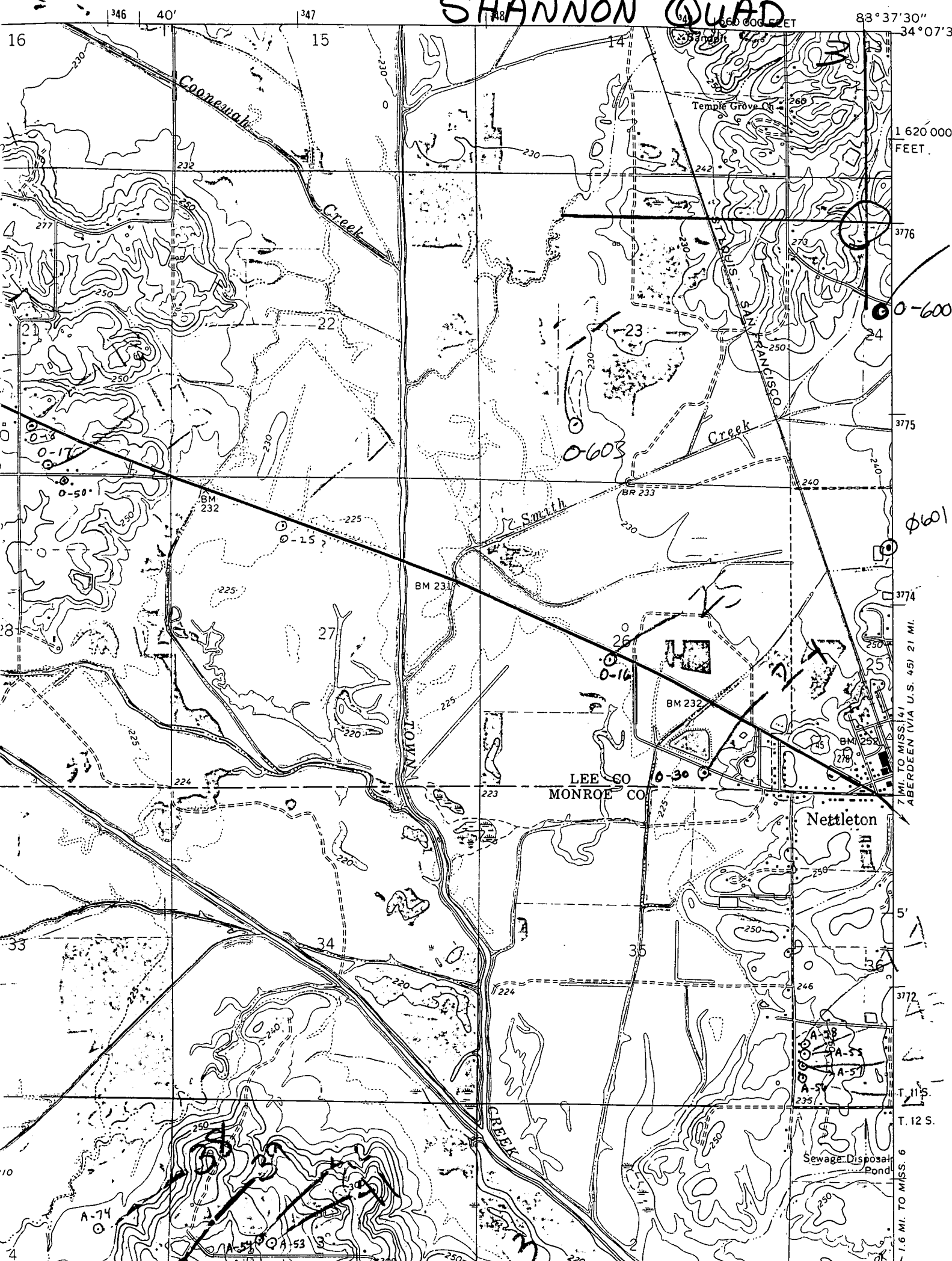

83° 37' 30" 34° 07' 30"

1 620 000 FEET

7 MI. TO MISS. 141 ABERDEEN (VIA U.S. 45) 21 MI.

T. 11 S. T. 12 S. 1.6 MI. TO MISS. 6