

5/78 WTO

6W 949

TRANSMITTED FOR ADP

Netleton

Recorded by WTO
Date 9/30/78
DOH 480019-01

U.S. GEOLOGICAL SURVEY
WATER RESOURCES DIVISION
MISSISSIPPI DISTRICT
WELL RECORD

3/79

Well No. 0115
E-Log No. 100
County LEE

Site ID 340624088364901 R=0* T=A* 2=W*

Data reliab. 3-C* Report. agency 4-USCS* Dist. 6-28* 7-28* Co. 8-081*

Lat. Long. 9-34.06.24* 10-08.8.36.49* Well No. 12-0115*

SE/NE Location 13-SENE S 24 T 11 S R 06 E* Alt. 16-290* 280

Hyd. Unit (OWDC) 20- Date 21-09/30/1978*

Well use 23-W* Water Use 24-P* Hole depth 27-308* Well depth 28-300*

WL 30-89* Date 31-10/16/1978* Source 33-S*

Status 273- Project No. 5-

MP- 1" pipe Vent S side at 20' above LSD

R=158* T=A* Date 159#01/05/1979* Owner No. TN*7 (Well#1)

Owner 161-CASPHN W A

R=192* T=A* Date 193#05/15/1979* Temp. 196#00010* 197-22*

R=192* T=A* Date 193#05/15/1979* Cond. 196#00095* 197-280*

R=192* T=A* Date 193#05/15/1979* pH 196#00400* 197-7.7*

R=58* T=A* 59#1* Date 60-01/05/1979* Remarks

Drig. 63-330* Name Herdon Method 65-H* Finish 66-G*

R=76* T=A* 59#1* Top csgn. 77#0* Bot. csgn. 78-252* Diam. 79#10*

R=76* T=A* 59#1* Top csgn. 77#206* Bot. csgn. 78-250* Diam. 79#6*

204

R=82* T=A* 59#1* Top 83#250* Bottom 84-300*

Type 85-S* Diam. 87-6* Size 88-.025*

R=82* T=A* 59#1* Top 83# Bottom 84-

Type 85- Diam. 87- Size 88-

YIELD R-146* T=A* 147# 1* Q 150-163* Q/S 272-

134 flows 146 pumped

R=42* T= A * Lift type 43# T* Intake 44# * Power type 45# E*

LIFT Date 38= 01/05/1979* H.P. 46= 25.*

LOGS
 R=198* T= A * Log 199# E* Top 200= 84.* Bot 201= 308.*
 R=198* T= A * Log 199# D* Top 200= 0.* Bot 201= 300.*
 R=189* T= A * E Log No. 190# 100* 191= M I S S D I S T *

ANAL. R=114* T= A * Year 115# 1979* Type 120# B*

R=90* T= A * 256# 1* Top 91= * Bot 92= *
 Unit ID 93= 211 MCSN * Name of Unit Eutu.

R=90* T= A * 256# 1* Top 91= * Bot 92= *
 Unit ID 93= * Name of Unit

HYDRAULICS
 R=98* T= A * 99# 1* Unit tested 100= * 103= *

R=105* T= A * 99# 1* Test No. 106# *

107= * Transmissivity (gal/d)/ft

108= * Hydraul. cond. (gal/d)/ft²

110= * Storage coeff. Boundaries

R=121* T= A * Yr Begin 122# * Network 258= *

Water Level Data Collection (1)

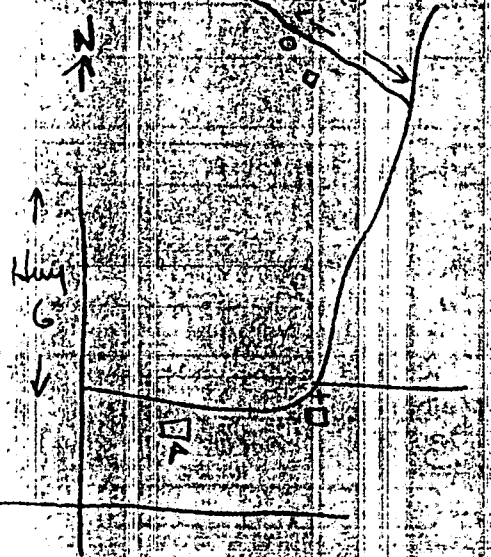

(58' ddc 2009pm)

description of formations encountered	from	to
Red Clay	0	5
Brown Clay	5	15
Blue Clay	15	80
Sandy Blue Clay	80	90
Sand	90	130
Sandy Blue Clay	130	150
Sand & Sandy Blue Clay	150	300

11/17/82

WL = 98.5

1987

WL = 102

5/21/1991

110.0

1.2

108.8

2.0

106.8

Nettleton

LEE
 0115
 JAN. 79
 E log # 100

MISSISSIPPI
 BOARD OF WATER COMMISSIONERS
 416 North State Street
 Jackson, Mississippi 39201

CODED

WATER WELL DRILLERS LOG

January 19 79 Herndon Well & Supply, Inc. LEE
 date well completed firm name county well located

LANDOWNER, Cason Water District Inc., Extention #2, Well #1, Nettleton, MS 38858 (mailing address)	Description of formations encountered	from to		
WELL LOCATION: sec. 19 T11 N R 07 E S W 3 miles East of Nettleton (distance) (direction) (nearest town) WELL PURPOSE: Municipal (home, irrigation, municipal, industrial) WELL COMPLETION DATA: (1) diameter (inches) 10 x 6 (2) total depth (feet) 300' (3) static water level (feet) 92' 6" below top of ground. (4) casing Steel, 252' (material) (depth) 10" If telescope see back. (size) (5) screen 52', 250' (length) (depth to top) 6", Stainless Steel (size) (material) (6) pump 25 163.47 (HP) (yield gpm) Electric (type power) (7) electric log yes (yes or no) U. S. Geological Survey (organization running log) (8) how well bottom plugged 6" BWV	Red Clay	0	5	
	Brown Clay	5	15	
	Blue Clay	15	80	
	Sandy Blue Clay	80	90	
	Sand	90	130	
	Sandy Blue Clay	130	150	
	Sand & Sandy Blue Clay	150	300	
CODED				
RECEIVED FEB -1 1978				
MISS. BD. OF WATER COMM				
DRILLERS REMARKS:				

Observation Well

County Lee

Well No. 15

Owner's Name Town of Nettleton

Location Nettleton
(town)

0.1 mile E on Main St. at water works
(miles and direction from center of town)

Other description Producing small amount of water
water tank

Depth 282 Diameter 8" Date drilled 1956

Formation Eutaw

Elev. of lsd 266 Recorder _____ Type _____ No. _____

M.P. air vent on W side at 2.0 ^{above} ft below lsd. Date 4/8/76

M.P. _____ at _____ ^{above} ft below lsd. Date _____

M.P. _____ at _____ ^{above} ft below lsd. Date _____

Special flow

Water Level -70 1976 85 (1980)

Sketch of location _____ Sketch of well head _____

* pump usually running. If water eupt. around apt. him to turn pump off for about 15 min.

V. difficult to get w.c.

Well located under elevated tank downtown.

see City Hall on Short Street (Lee Albert can turn off well)

unscrew pipe & pump (as close to pump as you can)

* UNSCREW WATER FAUCET & USE AS M.P. STILL = TO 2.00 FT.

✓
2115 Jager WA



UNITED STATES
DEPARTMENT OF THE INTERIOR
GEOLOGICAL SURVEY No. 3 Well



88°37'30" TUPELO 11 MI. UNION 2.7 MI. 351000m.E. 352 353 35'

34°07'30"

3770000m.N.

6 0116 2
2 0115 2

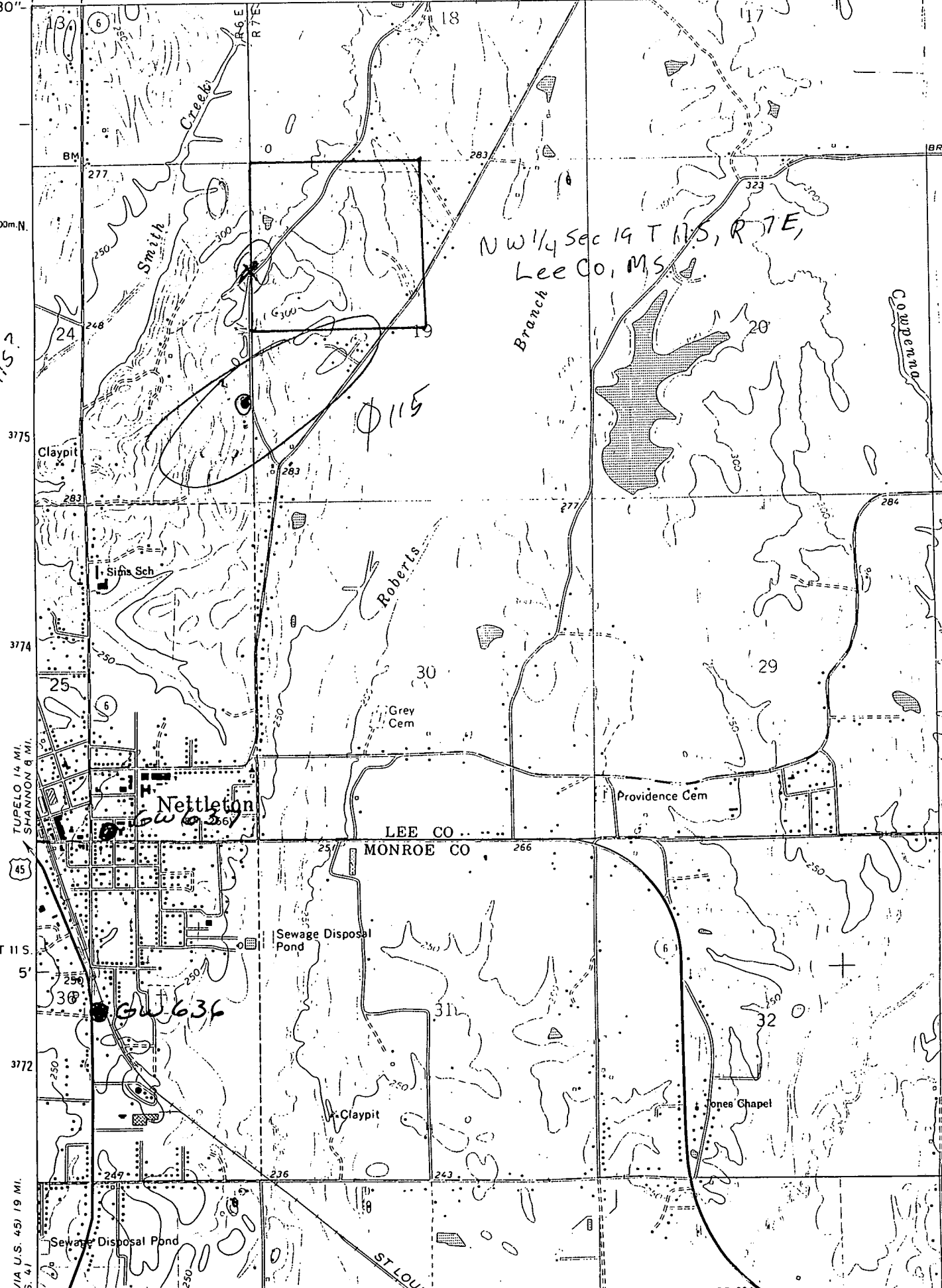

NW 1/4 Sec 19 T 15 S, R 7 E,
Lee Co, MS

TUPELO 14 MI.
SHANNON 8 MI.

T 11 S

3772

VIA U.S. 45, 19 MI.
S. 41

Sewage Disposal Pond

LEE CO... MONROE CO

Sewage Disposal Pond

Claypit

Jones Chapel

ST LOUIS

32 1/2 MI
27000

DEPARTMENT OF THE INTERIOR
GEOLOGICAL SURVEY

NETTLETON QUAD

