

WELL SCHEDULE

U. S. DEPT. OF THE INTERIOR

GEOLOGICAL SURVEY

WATER RESOURCES DIVISION

TRANSMITTED FOR ADP

MASTER CARD

Record by THOMSON Source of data DRILLER Date 4/26/67 Map _____

State 28 County (or town) LEE 41

Latitude: 34⁰⁸ 09⁷ 31⁹ N Longitude: 088¹⁷ 37¹³ 44¹⁸ Sequential number: 1

Lat-long accuracy: 1²⁰ T. 11³⁰ S. R. 6³⁰ W. Sec. 1³⁰ SE 1³⁰ NW 1³⁰ NW

Local well number: 005588011506E Other number: 398 B & M

Local use: _____ Owner or name: _____

Owner or name: M. M. PETTIGREW Address: _____

Ownership: County, Fed Gov't, City, Corp or Co, Private, State Agency, Water Dist P

Use of water: (A) Air cond, (B) Bottling, (C) Comm, (D) Dewater, (E) Power, (F) Fire, (G) Dom, (H) Irr, (I) Med, (J) P S, (K) Rec, (L) Stock, (M) Instit, (N) Unused, (O) Repressure, (P) Recharge, (Q) Desal-P S, (R) Desal-other, (S) Other H

Use of well: (A) Anode, (B) Drain, (C) Seismic, (D) Heat Res, (E) Obs, (F) Oil-gas, (G) Recharge, (H) Test, (I) Unused, (J) Withdraw, (K) Waste, (L) Destroyed W

DATA AVAILABLE: Well data Freq. W/L meas.: Field aquifer char.

Hyd. lab. data: _____

Qual. water data; type: _____

Freq. sampling: _____ Pumpage inventory: period: _____

Aperture cards: _____ yes

Log data: DRILLERS D

WELL-DESCRIPTION CARD

SAME AS ON MASTER CARD Depth well: _____ ft 218 Meas. rept accuracy 3

Depth cased: (first perf.) _____ ft 21 Casing type: _____; Diam. _____ in 4

Finish: (A) porous concrete, (B) gravel w. (perf.), (C) gravel w. (screen), (D) horiz. gallery, (E) open end, (F) perf., (G) screen, (H) sd. pt., (I) shored, (J) other hole, (K) other X

Method: (A) air rot, (B) bored, (C) cable, (D) dug, (E) hyd jetted, (F) air rot., (G) percussion, (H) rotary, (I) reverse, (J) trenching, (K) driven, (L) wash, (M) other H

Date Drilled: 9-6-66 Pump intake setting: _____ ft _____

Driller: EWING GAS CO. TUPELO

Lift (type): (A) air, (B) bucket, (C) cent, (D) jet, (E) multiple, (F) multiple, (G) none, (H) piston, (I) rot, (J) submerg, (K) turb, (L) other Deep Shallow

Power (type): (A) diesel, (B) elec, (C) gas, (D) gasoline, (E) hand, (F) gas, (G) wind, (H) H.P. Trans. or meter no. _____

Descrip. MP _____ above ft below LSD, Alt. MP _____

Alt. LSD: _____ Accuracy: (source) 4

Water Level: _____ ft above MP; _____ ft below LSD Accuracy: 50

Date meas: 9-20-66 966 Yield: _____ gpm Method determined _____

Drawdown: _____ ft Accuracy: _____ Pumping period _____ hrs _____

QUALITY OF WATER DATA: Iron _____ ppm Sulfate _____ ppm Chloride _____ ppm Hard. _____ ppm

Sp. Conduct _____ K x 10⁶ Temp. _____ °F Date sampled _____

Taste, color, etc. _____

Well No.

055

Well No. Ø 55

Latitude-longitude _____
d m s N
S d m s

HYDROGEOLOGIC CARD

SAME AS ON MASTER CARD Physiographic Province: 03 Section: _____

D Drainage Basin: 13C Subbasin: _____

Topo of well site: (D) depression, stream channel, dunes, flat, hilltop, sink, swamp, (E) (F) (H) (K) (L) (P) (S) (T) (U) (V) offshore, pediment, hillside, terrace, undulating, valley flat S

MAJOR AQUIFER: _____ system _____ series K3 TOMBIGBEE MEMBER TM aquifer, formation, group

Lithology: MS Origin: G Aquifer Thickness: _____ ft

Length of well open to: _____ ft 105 Depth to top of: _____ ft 113

MINOR AQUIFER: _____ system _____ series _____ aquifer, formation, group

Lithology: _____ Origin: _____ Aquifer Thickness: _____ ft

Length of well open to: _____ ft _____ Depth to top of: _____ ft _____

Intervals Screened: _____

Depth to consolidated rock: _____ ft _____ Source of data: _____

Depth to basement: _____ ft _____ Source of data: _____

Surficial material: _____ Infiltration characteristics: _____

Coefficient Trans: _____ gpd/ft _____ Coefficient Storage: _____

Coefficient Perm: _____ gpd/ft²; Spec cap: _____ gpm/ft; Number of geologic cards: _____

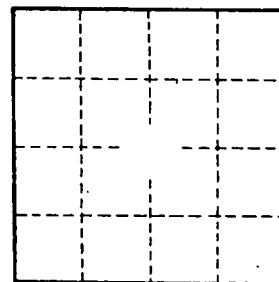
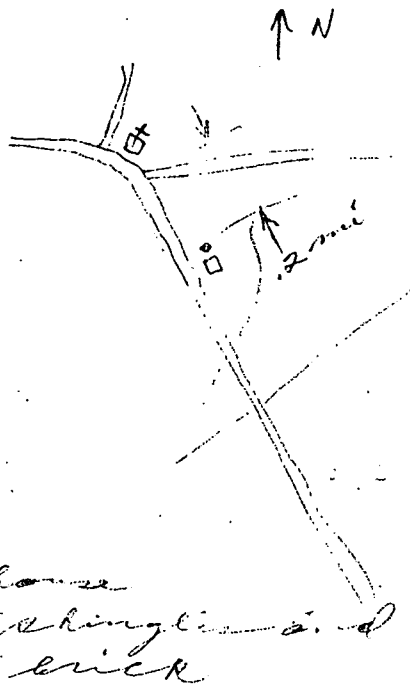

Well No. Ø 55

Φ55

MISSISSIPPI BOARD OF WATER COMMISSIONERS

WATER WELL DRILLERS LOG

Date: 9/20, 1966, Driller: Guying Basco, County: Le

		Description & Color of Materials Sand, Clay, Red Clay, Shell, etc.	Thick- ness Feet	Depth Feet
(1) Owner of Land: <u>M.M. Pettigrew</u> (Name) <u>Nettleton Rd</u> (Address)		<u>yellow clay</u>	<u>15</u>	<u>15</u>
		<u>blue</u>	<u>90</u>	<u>105</u>
		<u>sand</u>	<u>113</u>	<u>218</u>
(2) Location: <u>1/4, 1/4, Sec. 1, T11R6</u> <u>5</u> miles <u>NE</u> of <u>Nettleton</u> (distance) (direction) (Nearest Town)				
(3) Topography: <u>Hilly</u> (Hilly) (Flat) (Level)				
(4) Purpose of Well: <u>Domestic</u> (Domestic Irrigation Municipal, Industrial, Other)				
Information upon completion of well:				
(1) Diameter <u>4</u> inches.				
(2) Total Depth <u>218</u> feet.				
(3) Water Level <u>50</u> feet below top of ground.				
(4) Cased to <u>21 ft.</u> , Size <u>4 in.</u>				
(5) Screen: Size _____, Length _____				
(6) Were any formations sealed against pollution? _____ yes, _____ no.				
If YES depth of formation _____				
Why _____				
Drillers Remarks: <u>new house</u> <u>shingles - part brick</u>				
<u>348 NEW 62</u>				

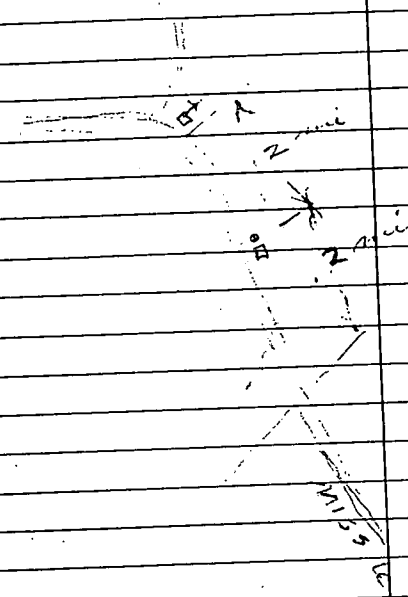

(Use Back Side)

Well No.

Mail this copy to Board of Water Commissioners 429 Miss. St. Jackson, Miss.

