

WRD Exp. (GW)
April 1966

Well No. Ø 51

WELL SCHEDULE

U. S. DEPT. OF THE INTERIOR

GEOLOGICAL SURVEY

WATER RESOURCES DIVISION

TRANSMITTED FOR ADP

MASTER CARD

Record by THOMSON Source of data BOWC Date 4/17/67 Map _____

State 28 County (or town) 41

Latitude: 34° 06' 47" N Longitude: 088° 41' 21" W Sequential number: 1

Lat-long accuracy: 1 T. 11 R. 6 W. Sec 20 NE 15 SW 16 E. 19

Local well number: Ø 051 CA 2011506 E Other number: 297

Local use: _____ Owner or name: T T GRUBBS Address: _____

Ownership: County, Fed Gov't, City, Corp or Co, Private, State Agency, Water Dist P

Use of water: (A) Air cond, Bottling, Comm, Dewater, Power, Fire, Dom, Irr, Med, Ind, P S, Rec, (S) Stock, Inatit, Unused, Repressure, Recharge, Desal-P S, Desal-other, Other H

Use of well: (A) Anode, Drain, Seismic, Heat Res, Obs, Oil-gas, Recharge, Test, Unused, Withdraw, Waste, Destroyed W

DATA AVAILABLE: Well data Freq. W/L meas.: Ø Field aquifer char.

Hyd. lab. data: _____

Qual. water data; type: _____

Freq. sampling: _____ Pumpage inventory: no period: _____

Aperture cards: _____

Log data: DRILLERS

WELL-DESCRIPTION CARD

SAME AS ON MASTER CARD Depth well: 320 ft Meas. 3 accuracy 5

Depth cased: (first perf.) 22 ft Casing type: _____; Diam. _____ in

Finish: porous concrete, gravel w. (perf.), gravel w. (screen), horz. open end, gallery, other X

Method: (A) air rot, (B) bored, (C) cable, (D) dug, (H) hyd, (J) jetted, (P) air percussion, (R) reverse, (T) trenching, (V) driven, (W) drive wash, other H

Date Drilled: 964 Pump intake setting: _____ ft

Driller: HERNDON name _____ address _____

Lift (type): (A) air, (B) bucket, (C) cent, (J) jet, (L) multiple, (M) multiple, (N) none, (P) piston, (R) rot, (S) submerg, (T) turb, other _____ Deep Shallow

Power (type): diesel, elec, gas, gasoline, hand, gas, wind; H.P. _____ Trans. or meter no. _____

Descrip. MP _____ ft above LSD, Alt. MP _____

Alt. LSD: 270 Accuracy: TOPO 4

Water Level: _____ ft above MP; _____ ft below LSD Accuracy: _____ D

Date meas: 3-23-64 364 Yield: _____ gpm Method determined _____

Drawdown: _____ ft Accuracy: _____ Pumping period _____ hrs

QUALITY OF WATER DATA: Iron _____ ppm Sulfate _____ ppm Chloride _____ ppm Hard. _____ ppm

Sp. Conduct _____ K x 10⁶ Temp. _____ °F Date sampled _____

Taste, color, etc. _____

Well No. Ø 51

Well No. 051

Latitude-longitude _____
N S
d m s d m s

HYDROGEOLOGIC CARD

SAME AS ON MASTER CARD Physiographic Province: 03 Section: _____
Drainage Basin: D 13C Subbasin: _____

Topo of well site: (D) (C) (E) (P) (H) (K) (L) (S) (P) (S) (T) (U) (V) _____
depression, stream channel, dunes, flat, hilltop, sink, swamp, offshore, pediment, hillside, terrace, undulating, valley flat H

MAJOR AQUIFER: _____ system _____ series K3 _____ aquifer, formation, group E2
EUTAW

Lithology: _____ Origin: 6 Aquifer Thickness: _____ ft
Length of well open to: _____ ft 140 Depth to top of: _____ ft 180

MINOR AQUIFER: _____ system _____ series _____ aquifer, formation, group _____
aquifer, formation, group _____

Lithology: _____ Origin: _____ Aquifer Thickness: _____ ft
Length of well open to: _____ ft _____ Depth to top of: _____ ft _____

Intervals Screened: _____

Depth to consolidated rock: _____ ft _____ Source of data: _____

Depth to basement: _____ ft _____ Source of data: _____

Surficial material: _____ Infiltration characteristics: _____

Coefficient Trans: _____ gpd/ft _____ Coefficient Storage: _____

Coefficient Perm: _____ gpd/ft²; Spec cap: _____ gpm/ft; Number of geologic cards: _____

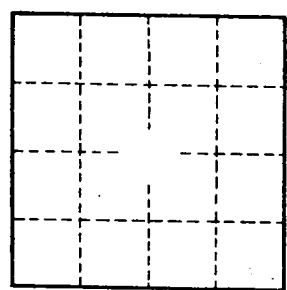

Well No. 051

LEE MISSISSIPPI BOARD OF WATER COMMISSIONERS

051⁶⁴
9-23-63

WATER WELL DRILLERS LOG

Date: 9/23, 1964, Driller: HENDON WELL & SUPPLY CO County Lee

P. O. BOX 42
SHANNON, MISSISSIPPI

(1) Owner of Land:	Description & Color of Materials Sand, Clay, Red Clay, Shell, etc.	Thick- ness Foot	Depth Feet
(Name) T. T. Grubbs (Address) Rt 2 Shannon, Miss	surface sand & clay		0
(2) Location: 1/4, 1/4, Sec 21 T 115 R 4E 1 miles E of Shannon (distance) (direction) (Nearest Town)	Blue sand to Gravel		20 190
(3) Topography: Flat (Hilly) (Flat) (Level)	to		
(4) Purpose of Well: Domestic (Domestic Irrigation Municipal, Industrial, Other)	Bottom		320

Information upon completion of well:

- (1) Diameter 5 inches.
- (2) Total Depth 320 feet.
- (3) Water Level 60 feet below top of ground.
- (4) Cased to 22 1/2" Size 5"
- (5) Screen: Size —, Length —
- (6) Were any formations sealed against pollution?
 yes, no.

If YES depth of formation 20'

Why surface & sand

Drillers Remarks:

297 ELE 270

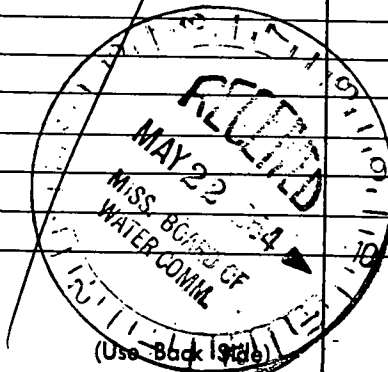

Well No.

Mail this copy to Board of Water Commissioners 429 Miss. St. Jackson, Miss.

SHANNON QUAD

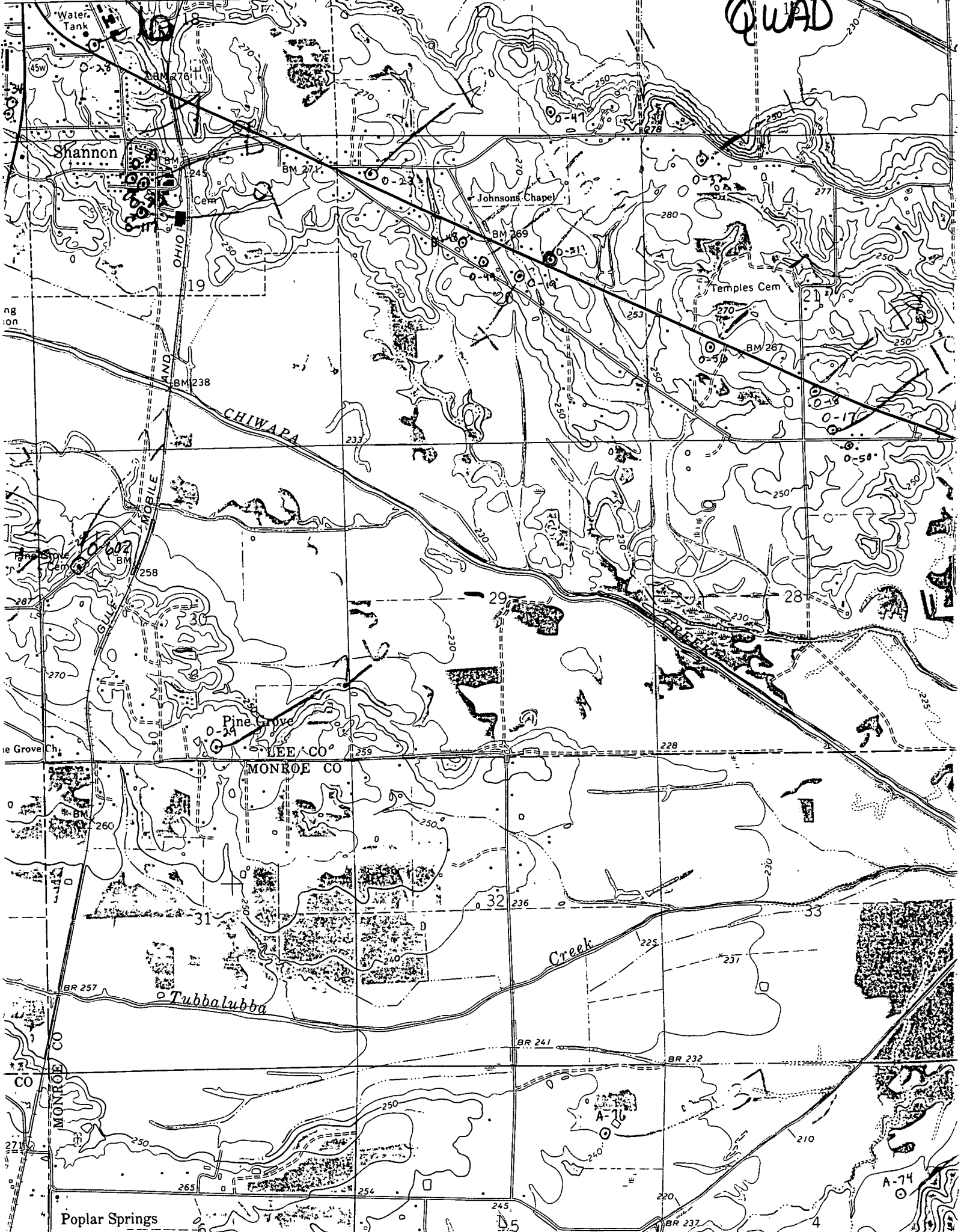

Poplar Springs

A-74