

WRD Exp. (GW)  
April 1966

Well No. 0 49

WELL SCHEDULE

U. S. DEPT. OF THE INTERIOR

GEOLOGICAL SURVEY

WATER RESOURCES DIVISION

TRANSMITTED FOR ADP

MASTER CARD

Record by THOMSON Source of data BOWC Date 9/17/67 Map \_\_\_\_\_

State 28 County (or town) LEE 41

Latitude: 34° 06' 45" N Longitude: 088° 41' 35" W Sequential number: 1

Lat-long accuracy: 11 T. 0 R. 6 W. Sec 20 NE 1 SE 6 NW 4

Local well number: 00490B20115064 Other number: 282

Local use: \_\_\_\_\_ Owner or name: \_\_\_\_\_

Owner or name: GARNER GARRETT Address: \_\_\_\_\_

Ownership: County (C), Fed Gov't (F), City, Corp or Co (M), Private (N), State Agency (P), Water Dist (S) P

Use of water: Air cond, Bottling, Comm, Dewater, Power, Fire, Dom, Irr, Med, Ind, P S, Rec, Stock, Instit, Unused, Repressure, Recharge, Desal-P S, Desal-other H

Use of well: Anode, Drain, Seismic, Heat Res, Obs, Oil-gas, Recharge, Test, Unused, Withdraw, Waste, Destroyed W

DATA AVAILABLE: Well data  Freq. W/L meas.:  Field aquifer char.

Hyd. lab. data: \_\_\_\_\_

Qual. water data; type: \_\_\_\_\_

Freq. sampling: \_\_\_\_\_ Pumpage inventory:  period: \_\_\_\_\_

Aperture cards: \_\_\_\_\_

Log data: DRILLERS

WELL-DESCRIPTION CARD

SAME AS ON MASTER CARD Depth well: \_\_\_\_\_ ft 320 Meas. 3

Depth cased: (first perf.) \_\_\_\_\_ ft 18 Casing type: \_\_\_\_\_; Diam. \_\_\_\_\_ in 4

Finish: porous concrete, gravel w. (perf.), gravel w. (screen), horiz. gallery, open end, other X

Method: (A) bored, (B) cable, (C) dug, (D) hyd jetted, (E) air rot., (F) percussion, (G) rotary, (H) reverse trenching, (I) driven, (J) wash, (K) other H

Date Drilled: 9-6-62 Pump intake setting: \_\_\_\_\_ ft \_\_\_\_\_

Driller: HERNDON address SHANNON

Lift (type): (A) air, (B) bucket, (C) cent, jet, (D) multiple, (E) multiple, (F) none, (G) piston, (H) rot, (I) submerg, (J) turb, (K) other  Deep  Shallow 40

Power (type): diesel, elec, gas, gasoline, hand, gas, wind; H.P.  Trans. or meter no. \_\_\_\_\_

Descrip. MP \_\_\_\_\_ ft above \_\_\_\_\_ below LSD, Alt. MP \_\_\_\_\_

Alt. LSD: 262 Accuracy: (source) 4

Water Level: \_\_\_\_\_ ft above MP; \_\_\_\_\_ ft below LSD 50 Accuracy: \_\_\_\_\_

Date meas: 3-19-62 362 Yield: \_\_\_\_\_ gpm \_\_\_\_\_ Method determined \_\_\_\_\_

Drawdown: \_\_\_\_\_ ft \_\_\_\_\_ Accuracy: \_\_\_\_\_ Pumping period \_\_\_\_\_ hrs \_\_\_\_\_

QUALITY OF WATER DATA: Iron \_\_\_\_\_ ppm \_\_\_\_\_ Sulfate \_\_\_\_\_ ppm \_\_\_\_\_ Chloride \_\_\_\_\_ ppm \_\_\_\_\_ Hard. \_\_\_\_\_ ppm \_\_\_\_\_

Sp. Conduct \_\_\_\_\_ K x 10 6 Temp. \_\_\_\_\_ °F \_\_\_\_\_ Date sampled \_\_\_\_\_

Taste, color, etc. \_\_\_\_\_

Well No.

0 49

Well No. 049

Latitude-longitude N  
S  
d m s d m s

HYDROGEOLOGIC CARD

SAME AS ON MASTER CARD Physiographic Province: 03 Section: \_\_\_\_\_

D Drainage Basin: 13C Subbasin: \_\_\_\_\_

Topo of well site: (D) (C) (E) (F) (H) (K) (L) (S) (P) (T) (U) (V) \_\_\_\_\_  
depression, stream channel, dunes, flat, hilltop, sink, swamp, offshore, pediment, hillside, terrae, undulating, valley flat H

MAJOR AQUIFER: \_\_\_\_\_ system \_\_\_\_\_ series K3 \_\_\_\_\_ aquifer, formation, group EUTAW EZ

Lithology: \_\_\_\_\_ Origin: U5 \_\_\_\_\_ G Aquifer Thickness: \_\_\_\_\_ ft

Length of well open to: \_\_\_\_\_ ft 120 Depth to top of: \_\_\_\_\_ ft 200

MINOR AQUIFER: \_\_\_\_\_ system \_\_\_\_\_ series \_\_\_\_\_ aquifer, formation, group \_\_\_\_\_

Lithology: \_\_\_\_\_ Origin: \_\_\_\_\_ Aquifer Thickness: \_\_\_\_\_ ft

Length of well open to: \_\_\_\_\_ ft \_\_\_\_\_ Depth to top of: \_\_\_\_\_ ft \_\_\_\_\_

Intervals Screened:

Depth to consolidated rock: \_\_\_\_\_ ft \_\_\_\_\_ Source of data: \_\_\_\_\_

Depth to basement: \_\_\_\_\_ ft \_\_\_\_\_ Source of data: \_\_\_\_\_

Surficial material: \_\_\_\_\_ Infiltration characteristics: \_\_\_\_\_

Coefficient Trans: \_\_\_\_\_ gpd/ft \_\_\_\_\_ Coefficient Storage: \_\_\_\_\_

Coefficient Perm: \_\_\_\_\_ gpd/ft<sup>2</sup>; Spec cap: \_\_\_\_\_ gpm/ft; Number of geologic cards: \_\_\_\_\_

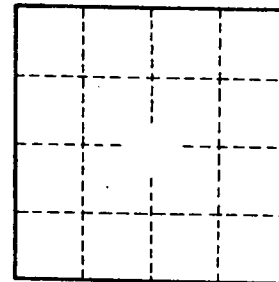

SEE SKETCH ON 048

Well No.

049

LEE

MISSISSIPPI BOARD OF WATER COMMISSIONERS

① 49  
3-19-62

WATER WELL DRILLERS LOG

Date: March 15, 1962, Driller: HERNDON WELL & SUPPLY CO County: Lee

P. O. BOX 42  
SHANNON, MISSISSIPPI

(1) Owner of Land	Description & Color of Materials Sand, Clay, Red Clay, Shell, etc.	Thick- ness Feet	Depth Feet
<u>Garver Garver</u> (Name) <u>Shannon, Miss.</u> (Address)	<u>surface sand</u> <u>&amp; clay</u>		<u>0</u>
(2) Location: <u>20</u> $\frac{1}{4}$ , <u>11<sup>S</sup></u> $\frac{1}{4}$ , Sec <u>R6E</u> <u>1/2</u> miles <u>E</u> , of <u>Shannon</u> (distance) (direction) (Nearest Town)	<u>Blue rock</u> <u>to</u> <u>gravel</u>		<u>15'</u>  <u>200</u>
(3) Topography: <u>Flat</u> (Hilly) (Flat) (Level)			
(4) Purpose of Well: <u>Domestic</u> (Domestic Irrigation Municipal, Industrial, Other)	<u>Blue rock</u>		<u>320</u>

Information upon completion of well:

- (1) Diameter 4 inches.
- (2) Total Depth 320 feet.
- (3) Water Level 50 feet below top of ground.
- (4) Cased to 18' 3" Size 4
- (5) Screen: Size \_\_\_\_\_, Length \_\_\_\_\_.
- (6) Were any formations sealed against pollution?  
 yes, \_\_\_\_\_ no.

If YES depth of formation Surface gravel <sup>15'</sup>

Why \_\_\_\_\_

Drillers Remarks: \_\_\_\_\_

282 FILED 262

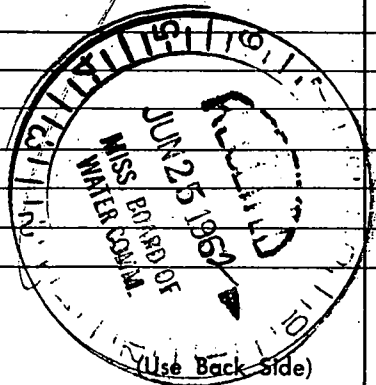

Well No. \_\_\_\_\_

Mail this copy to Board of Water Commissioners 429 Miss. St. Jackson, Miss.

# SHANNON QUAD

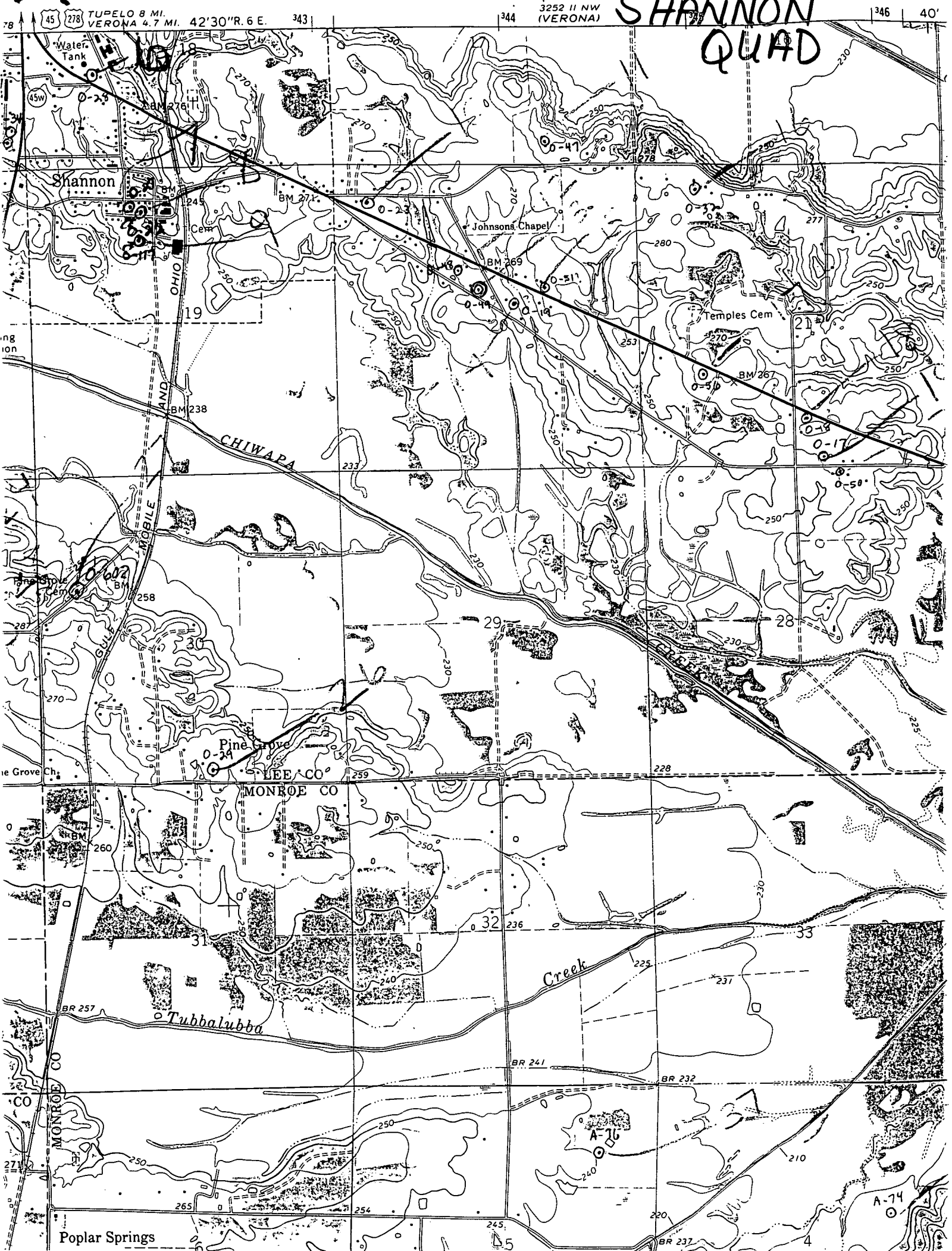

TUPELO 8 MI. VERONA 4.7 MI. 42°30'R. 6 E.

3252 11 NW (VERONA)

78

346 40'

ng ion

ie Grove Ch

271

Poplar Springs

45

4