

WELL SCHEDULE

U. S. DEPT. OF THE INTERIOR

GEOLOGICAL SURVEY

WATER RESOURCES DIVISION

TRANSMITTED FOR ADP

MASTER CARD

Record by THOMSON Source of data BOWC Date 4/17/67 Map \_\_\_\_\_

State 28 County LEE (or town) LEE 41

Latitude: 34 06 49 N Longitude: 08 89 14 0 Sequential number: 1

Lat-long accuracy: 1 T. 11 R. 6 W. Sec 20 S. 11 E. 5 E. 1 NW 1

Local well number: 0048DB2011506E Other number: 275 B & M

Local use: \_\_\_\_\_ Owner or name: CLYDE HAMPTON Address: \_\_\_\_\_

Ownership: County, Fed Gov't, City, Corp or Co, Private, State Agency, Water Dist. P

Use of water: (A) Air cond, Bottling, Comm, Dewater, Power, Fire, Dom, Irr, Med, Ind, P S, Rec, (S) Stock, Instit, Unused, Repressure, Recharge, Desal-P S, Desal-other, Other H

Use of well: (A) Anode, Drain, Seismic, Heat Res, Obs, Oil-gas, Recharge, Test, Unused, Withdraw, Waste, Destroyed W

DATA AVAILABLE: Well data  Freq. W/L meas.: 0 Field aquifer char.

Hyd. lab. data:

Qual. water data; type:

Freq. sampling:  Pumpage inventory:  yes  no period:

Aperture cards:  yes

Log data: DRILLERS

WELL-DESCRIPTION CARD

SAME AS ON MASTER CARD Depth well: 320 ft Meas. 3 accuracy 3

Depth cased: (first perf.) 22 ft Casing type: \_\_\_\_\_; Diam. 4 in

Finish: porous concrete, gravel w. (perf.), gravel w. (screen), horiz. gallery, open end, (H) (P) (S) (T) (W) (X) (Z) X

Method Drilled: (A) air rot., (B) bored, (C) cable, (D) dug, (H) hyd rot., (J) jetted, (P) air percussion, (R) reverse, (T) trenching, (V) driven, (W) drive wash, (Z) other H

Date Drilled: 961 Pump intake setting: \_\_\_\_\_ ft

Driller: HERNON

Lift (type): (A) air, (B) bucket, (C) cent., (J) jet, (L) multiple, (M) multiple, (N) none, (P) piston, (R) rot., (S) submerg, (T) turb., (Z) other  Deep  Shallow 40

Power (type): diesel, elec, gas, gasoline, hand, gas, wind; H.P. \_\_\_\_\_ Trans. or meter no. \_\_\_\_\_

Descrip. MP \_\_\_\_\_ ft above LSD, Alt. MP \_\_\_\_\_

Alt. LSD: 265 Accuracy: 4 (source) TOPO

Water Level \_\_\_\_\_ ft above MP; \_\_\_\_\_ ft above LSD 65 Accuracy: 0

Date meas: 6-17-61 Yield: 661 gpm Method determined 61

Drawdown: \_\_\_\_\_ ft Accuracy: \_\_\_\_\_ Pumping period \_\_\_\_\_ hrs

QUALITY OF WATER DATA: Iron \_\_\_\_\_ ppm Sulfate \_\_\_\_\_ ppm Chloride \_\_\_\_\_ ppm Hard. \_\_\_\_\_ ppm

Sp. Conduct \_\_\_\_\_ K x 10 6 Temp. \_\_\_\_\_ °F Date sampled \_\_\_\_\_

Taste, color, etc. \_\_\_\_\_

Well No.

48

Well No. 048

Latitude-longitude \_\_\_\_\_  
N  
S  
d m s d m s

**HYDROGEOLOGIC CARD**

SAME AS ON MASTER CARD Physiographic Province: 03 Section: \_\_\_\_\_

D Drainage Basin: 13C Subbasin: \_\_\_\_\_

Topo of well site: (D) depression, stream channel, dunes, flat, hilltop, sink, swamp, (P) offshore, pediment, hillside, terrace, undulating, valley flat 17

MAJOR AQUIFER: system \_\_\_\_\_ series K3 aquifer, formation, group EUTAW E2

Lithology: US Origin: C Aquifer Thickness: \_\_\_\_\_ ft

Length of well open to: \_\_\_\_\_ ft 120 Depth to top of: \_\_\_\_\_ ft 200

MINOR AQUIFER: system \_\_\_\_\_ series \_\_\_\_\_ aquifer, formation, group \_\_\_\_\_

Lithology: \_\_\_\_\_ Origin: \_\_\_\_\_ Aquifer Thickness: \_\_\_\_\_ ft

Length of well open to: \_\_\_\_\_ ft \_\_\_\_\_ Depth to top of: \_\_\_\_\_ ft \_\_\_\_\_

Intervals Screened:

Depth to consolidated rock: \_\_\_\_\_ ft \_\_\_\_\_ Source of data: \_\_\_\_\_

Depth to basement: \_\_\_\_\_ ft \_\_\_\_\_ Source of data: \_\_\_\_\_

Surficial material: \_\_\_\_\_ Infiltration characteristics: \_\_\_\_\_

Coefficient Trans: \_\_\_\_\_ gpd/ft \_\_\_\_\_ Coefficient Storage: \_\_\_\_\_

Coefficient Perm: \_\_\_\_\_ gpd/ft<sup>2</sup>; Spec cap: \_\_\_\_\_ gpm/ft; Number of geologic cards: \_\_\_\_\_

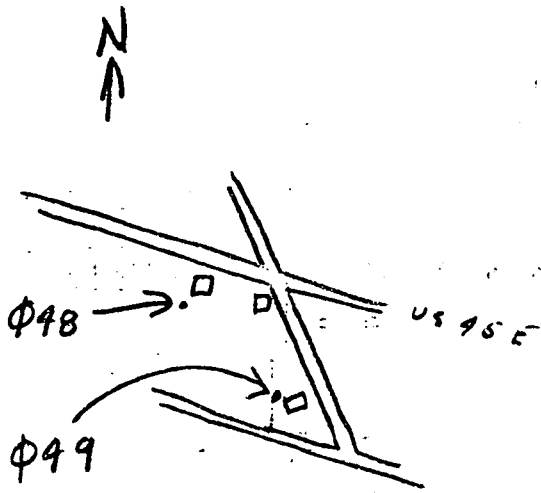
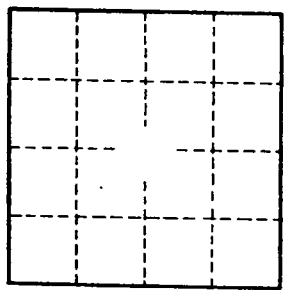

Well No.

048

LEE

MISSISSIPPI BOARD OF WATER COMMISSIONERS

048  
6-17-61

WATER WELL DRILLERS LOG

0309

Date: Jan 17, 1961, Driller: HERNDON WELL & SUPPLY CO.  
P. O. BOX 42 County Worcester

SHANNON, MISSISSIPPI

(1) Owner of Land (Name)	Description & Color of Materials Sand, Clay, Red Clay, Shell, etc.	Thick- ness Feet	Depth Feet
<u>Clyde Hampton</u> (Name) <u>RT 2 Shannon, Miss</u> (Address)	<u>Surface SAND</u> <u>&amp; CLAY</u>		<u>0</u>
(2) Location: <u>1/4, 1/4, Sec 20 T 115 R 6E</u>	<u>Blue rock</u>		<u>18</u>
(3) Topography: <u>3/4 miles East of Shannon</u> (distance) (direction) (Nearest Town)	<u>Sand</u>		<u>200</u>
(3) Topography: <u>Flat</u> (Hilly) (Flat) (Level)	<u>Bottom</u>		<u>320</u>
(4) Purpose of Well: <u>Domestic</u> (Domestic Irrigation Municipal, Industrial, Other)			

Information upon completion of well:

- (1) Diameter 4 inches.
- (2) Total Depth 320 feet.
- (3) Water Level 65 feet below top of ground.
- (4) Cased to 22', Size 4"
- (5) Screen: Size         , Length
- (6) Were any formations sealed against pollution?  
 yes,  no.

If YES depth of formation 18'

Why Surface & Sand

Drillers Remarks:         

275 ELE 265

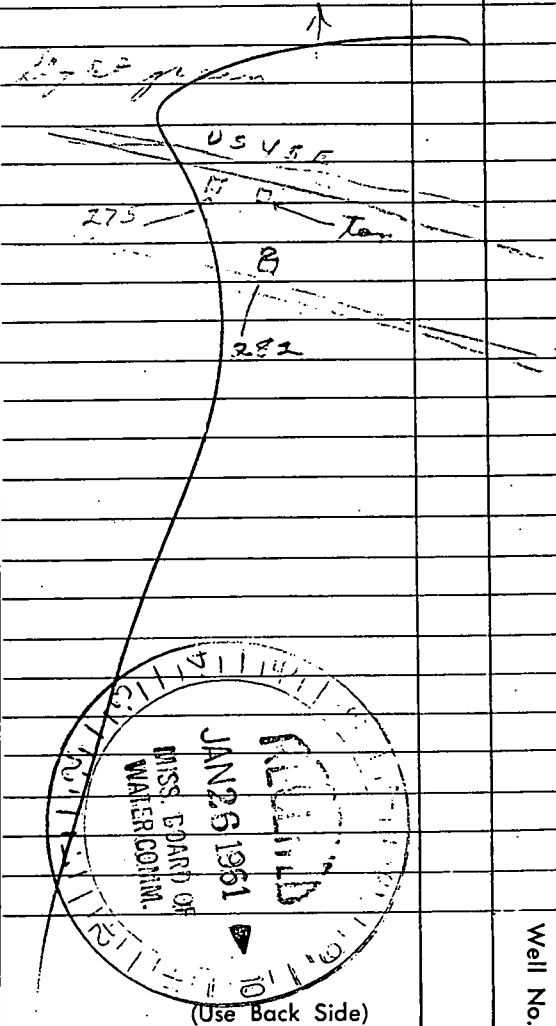

Well No.

Mail this copy to Board of Water Commissioners 429 Miss. St. Jackson. Mis

Red sand 0-8  
Blue rock 8-28  
Shale 28-150  
Sand

Hard rock 270

Sand at 518 cut 518

# SHANNON QUAD

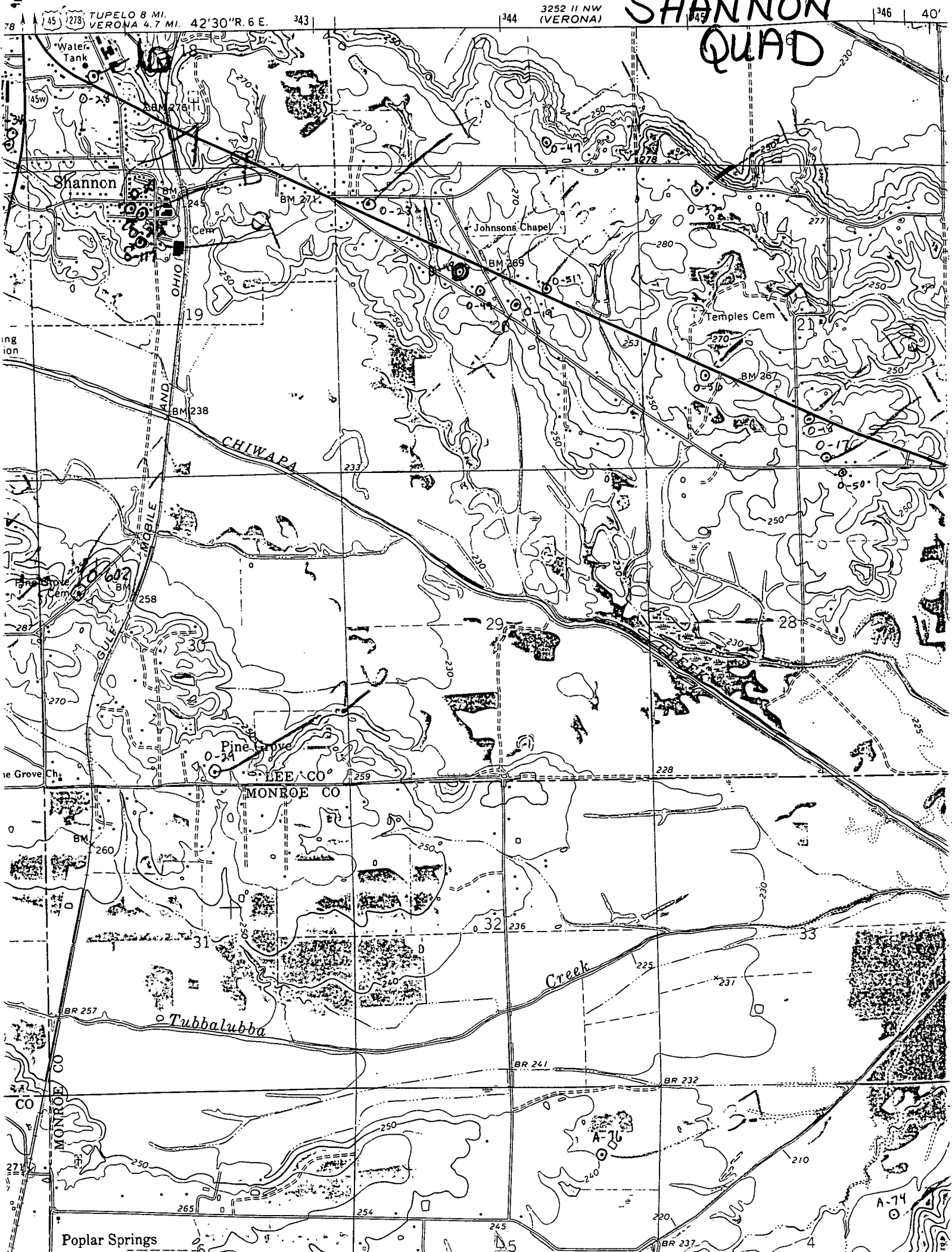

TUPELO 8 MI.  
VERONA 4.7 MI. 42°30'R. 6 E.

3252 II NW  
(VERONA)

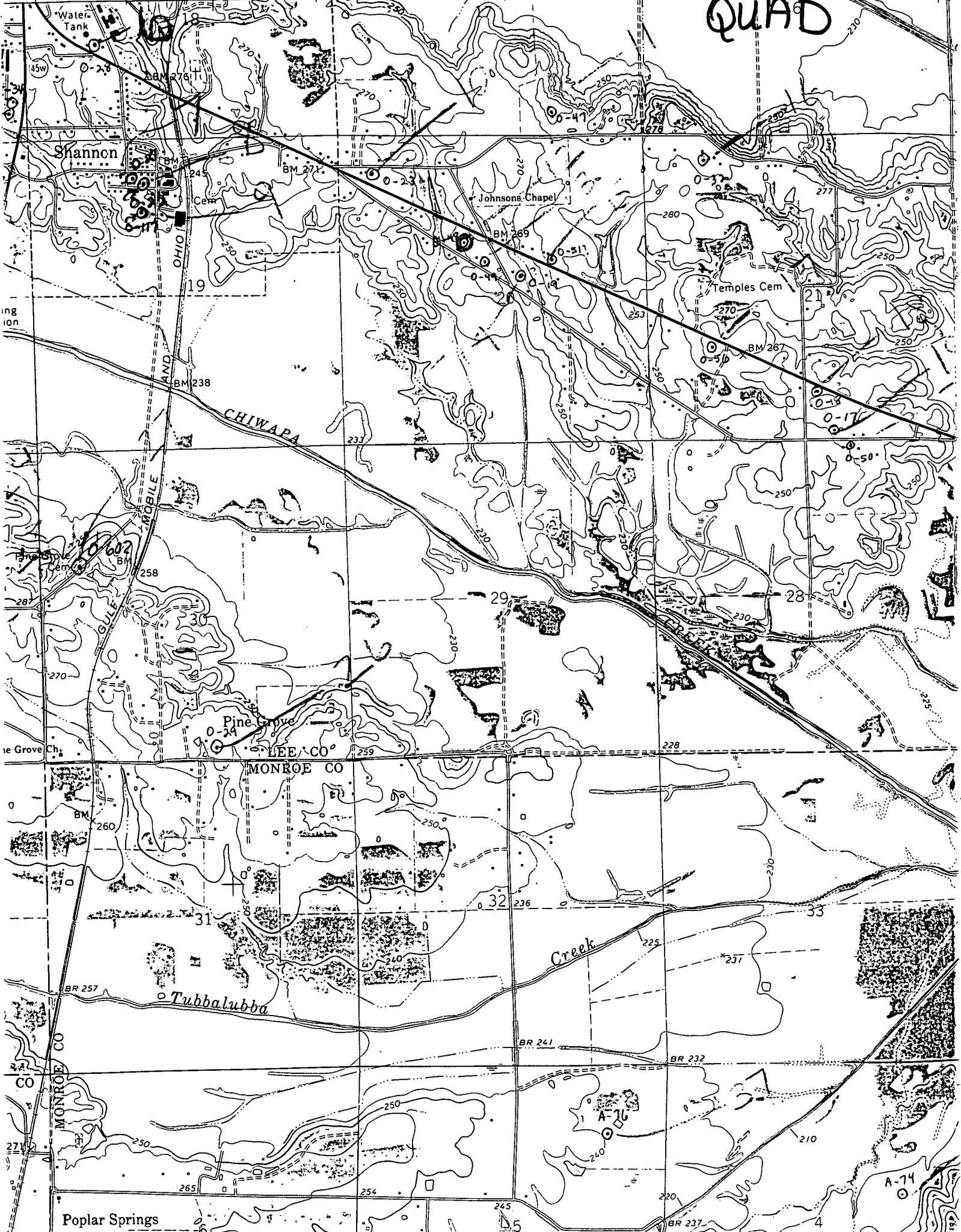

Poplar Springs

A-74