

WELL SCHEDULE

U. S. DEPT. OF THE INTERIOR

GEOLOGICAL SURVEY

WATER RESOURCES DIVISION

TRANSMITTED FOR ADP

MASTER CARD

Record by THOMSON Source of data BOWC Date 7/13/67 Map _____

State 28 County (or town) LEE 41

Latitude: 340805N Longitude: 0884101 Sequential number: 1

Lat-long accuracy: 10 T. 11 N. R. 6 W. Sec. 9SW degrees 15 min 18 sec

Local well number: 004660911506E Other number: _____ B & M

Local use: _____ Owner or name: _____

Owner or name: COWDEN GRUBBS Address: _____

Ownership: County, Fed Gov't, City, Corp or Co, Private, State Agency, Water Dist P

Use of water: (A) Air cond, Bottling, Comm, Dewater, Power, Fire, Dom, Irr, Med, Ind, P S, Rec, (S) Stock, Instir, Unused, Repressure, Recharge, Desal-P S, Desal-other, Other H

Use of well: (A) Anode, Drain, Seismic, Heat Res, Obs, Oil-gas, Recharge, Test, Unused, Withdraw, Waste, Destroyed W

DATA AVAILABLE: Well data Freq. W/L meas.: Field aquifer char.

Hyd. lab. data: _____

Qual. water data; type: _____

Freq. sampling: _____ Pumpage inventory: yes no, period: _____

Aperture cards: _____ yes

Log data: DRILLERS D

WELL-DESCRIPTION CARD

SAME AS ON MASTER CARD Depth well: 300 ft Meas. 3

Depth cased: (first perf.) _____ ft 21 Casing type: _____; Diam. in 4

Finish: (C) porous concrete, (F) gravel w. (perf.), (G) gravel w. (screen), (H) horz. open gallery, end, (I) open perf., (J) screen, (K) sd. pt., (L) shored, (M) open hole, (N) other, (O) _____ X

Method Drilled: (A) air rot, (B) bored, (C) cable, (D) dug, (E) hyd rot., (F) jetted, (G) air percussion, (H) reverse, (I) trenching, (J) driven, (K) drive wash, (L) other, (M) _____ H

Date Drilled: 9.6.3 Pump intake setting: _____ ft _____

Driller: HERNDON SHANNOX

Lift (type): (A) air, (B) bucket, (C) cent, (D) jet, (E) multiple, (F) multiple, (G) none, (H) piston, (I) rot, (J) submerg, (K) turb, (L) other, (M) _____ Deep Shallow

Power (type): (A) diesel, (B) elec, (C) gas, (D) gasoline, (E) hand, (F) gas, (G) wind, (H) H.P., (I) _____ Trans. or meter no. _____

Descrip. MP _____ ft above _____ below LSD, Alt. MP _____

Alt. LSD: 295 Accuracy: (source) _____ 4

Water Level _____ ft above _____ below MP; Ft below LSD 33 Accuracy: _____ D

Date meas: 3-26-63 3.6.3 Yield: _____ gpm Method determined _____

Drawdown: _____ ft Accuracy: _____ Pumping period _____ hrs _____

QUALITY OF WATER DATA: Iron _____ ppm Sulfate _____ ppm Chloride _____ ppm Hard. _____ ppm

Sp. Conduct _____ K x 10⁶ Temp. _____ °F Date sampled _____

Taste, color, etc. _____

Well No.

46

Well No. 046

Latitude-longitude N
S
d m s d m s

HYDROGEOLOGIC CARD

SAME AS ON MASTER CARD Physiographic Province: 03 Section: _____

D Drainage Basin: 13C Subbasin: _____

Topo of well site: (D) depression, stream channel, dunes, flat, hilltop, sink, swamp, (P) offshore, pediment, hillside, terrace, undulating, valley flat 7

MAJOR AQUIFER: system _____ series K3 aquifer, formation, group EUTAW E2

Lithology: US Origin: G Aquifer Thickness: _____ ft

Length of well open to: _____ ft Depth to top of: 180 ft

MINOR AQUIFER: system _____ series _____ aquifer, formation, group _____

Lithology: _____ Origin: _____ Aquifer Thickness: _____ ft

Length of well open to: _____ ft Depth to top of: _____ ft

Intervals Screened: _____

Depth to consolidated rock: _____ ft Source of data: _____

Depth to basement: _____ ft Source of data: _____

Surficial material: _____ Infiltration characteristics: _____

Coefficient Trans: _____ gpd/ft _____ Coefficient Storage: _____

Coefficient Perm: _____ gpd/ft²; Spec cap: _____ gpm/ft; Number of geologic cards: _____

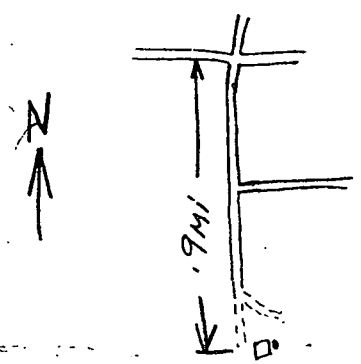
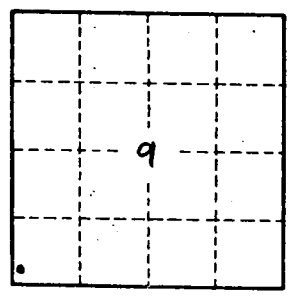

Well No.

046

LEE

MISSISSIPPI BOARD OF WATER COMMISSIONERS

046

3-26-63

WATER WELL DRILLERS LOG

Date: March 26, 1963, Driller: HERNDON WELL & SUPPLY CO County Lee
P.O. BOX 22
SHANNON, MISSISSIPPI

(1) Owner of Land:	Description & Color of Materials	Thick-ness Feet	Depth Feet
<u>Condon Muller</u> (Name) <u>Rt 2 Shannon, Miss</u> (Address)	<u>surface sand & clay</u>		<u>0</u>
(2) Location: <u>1/4, 1/4, Sec. 9</u> <u>3 miles N.E. of Shannon</u> (distance) (direction) (Nearest Town)	<u>blue rock</u>		<u>18</u>
(3) Topography: <u>flat</u> (Hilly) (Flat) (Level)	<u>sand</u>		<u>180</u>
(4) Purpose of Well: <u>Domestic</u> (Domestic: Irrigation Municipal, Industrial, Other)	<u>Bottom</u>		<u>300</u>

Information upon completion of well:

- (1) Diameter 4 inches.
- (2) Total Depth 300 feet.
- (3) Water Level 33 feet below top of ground.
- (4) Cased to 21', Size 4"
- (5) Screen: Size —, Length —
- (6) Were any formations sealed against pollution?
yes, no.
- If YES depth of formation 18 ft.
- Why surface & sand
- Drillers Remarks: —

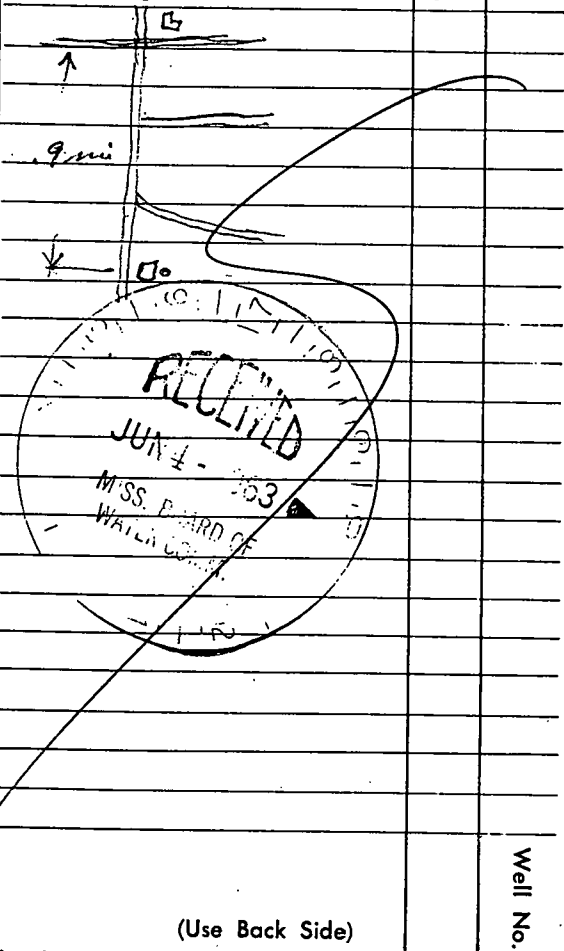

299 ELEV 245

(Use Back Side)

Well No.

Mail this copy to Board of Water Commissioners 429 Miss. St. Jackson, Miss

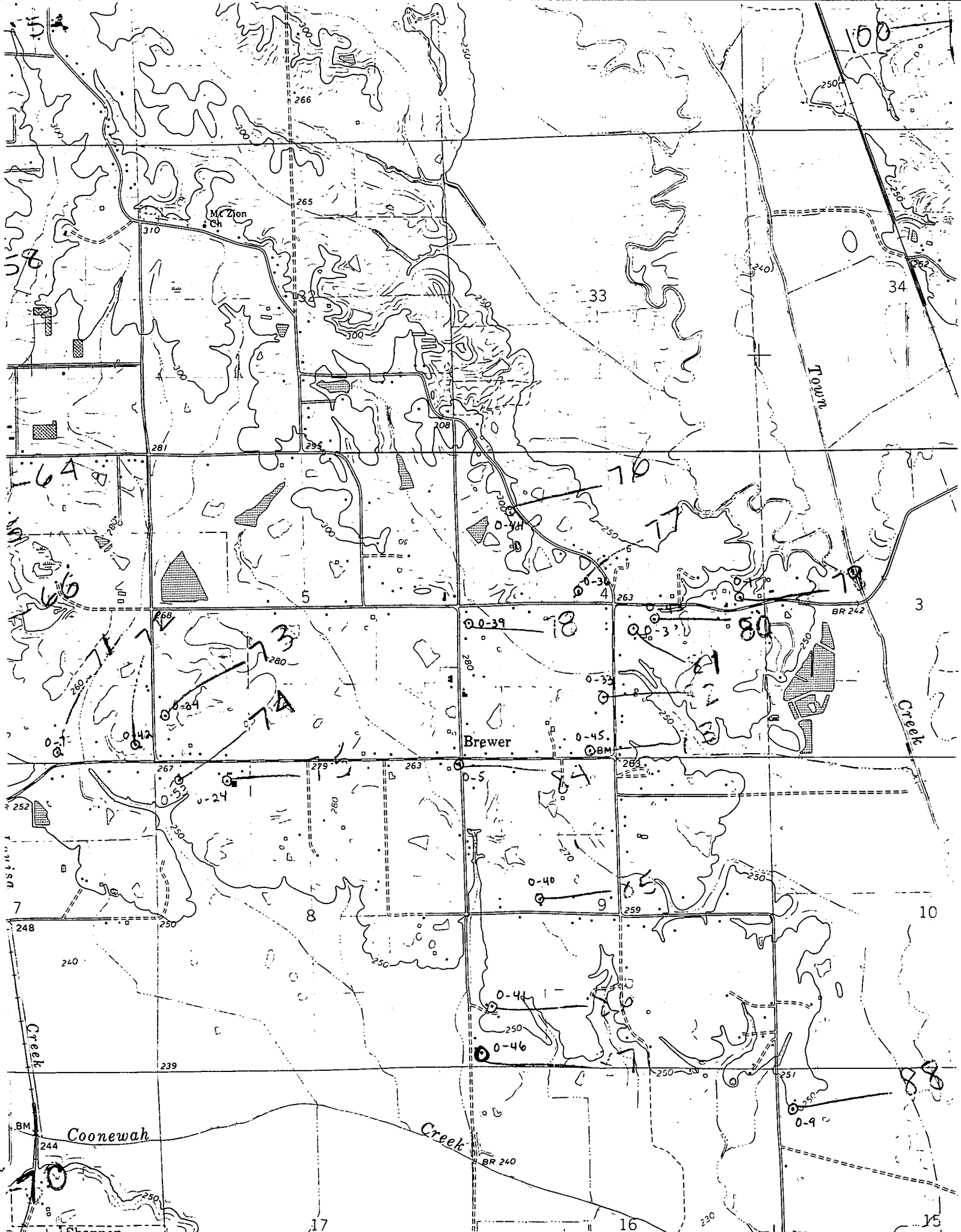

MI. 42°30" R. 6 E. 344 (SHANNON) 345
 S. 45°27' M. 3252 II SW
VERONA QUAD