

Verona

WRD Exp. (GW)
April 1966

Well No. Φ 44

WELL SCHEDULE

U. S. DEPT. OF THE INTERIOR GEOLOGICAL SURVEY WATER RESOURCES DIVISION

MASTER CARD

Record by THOMSON Source of data Bowc Date 4/3/67 Map _____

State 28 County (or town) LEE 41

Latitude: 34° 09' 33" N Longitude: 082° 40' 53" W Sequential number: 1

Lat-long accuracy: 1 T. 11 R. 6 S. Sec. 4 SE NW NW

Local well number: Φ 044 B B 04 11 506 E Other number: 305

Local use: _____ Owner or name: _____

Owner or name: MRS BONNIE TATE Address: _____

Ownership: County, Fed Gov't, City, Corp or Co, Private, State Agency, Water Dist P

Use of water: (A) Air cond, (B) Bottling, (C) Comm, (D) Dewater, (E) Power, (F) Fire, (G) Dom, (H) Irr, (I) Med, (J) P S, (K) Rec, (L) Stock, (M) Inatit, (N) Unused, (O) Reppure, (P) Recharge, (Q) Desal-P S, (R) Desal-other, (S) Other H

Use of well: (A) Anode, (B) Drain, (C) Seismic, (D) Heat Res, (E) Obs, (F) Oil-gas, (G) Recharge, (H) Test, (I) Unused, (J) Withdraw, (K) Waste, (L) Destroyed W

DATA AVAILABLE: Well data Freq. W/L meas.: Field aquifer char.

Hyd. lab. data: _____

Qual. water data; type: _____

Freq. sampling: _____ Pumpage inventory: no period: _____

Aperture cards: _____ yes

Log data: DRILLERS D

WELL-DESCRIPTION CARD

SAME AS ON MASTER CARD Depth well: _____ ft 340 Meas. 3

Depth cased: (first perf.) _____ ft 25 Casing type: _____; Diam. _____ in 4

Finish: (C) porous concrete, (F) gravel w. (perf.), (G) gravel w. (screen), (H) horiz. gallery, (I) open end, (J) open perf., (K) screen, sd. pt., (L) shored, (M) open hole, (N) other X

Method Drilled: (A) air rot, (B) bored, (C) cable, (D) dug, (E) hyd rot., (F) jetted, (G) air rot., (H) percussion, (I) rotary, (J) reverse, (K) trenching, (L) driven, (M) drive wash, (N) other H

Date Drilled: 9-6-65 Pump intake setting: _____ ft _____

Driller: HERNDON - HUMAN SHANNON

Lift (type): (A) air, (B) bucket, (C) cent, (D) jet, (E) multiple, (F) multiple, (G) none, (H) piston, (I) rot, (J) submerg, (K) turb, (L) other Deep Shallow

Power (type): (A) diesel, (B) elec, (C) gas, (D) gasoline, (E) hand, (F) gas, (G) wind; (H) P. Trans. or meter no. _____

Descrip. MP _____ above ft below LSD, Alt. MP _____

Alt. LSD: 302 Accuracy: (source) Topo 4

Water Level: _____ ft above MP; _____ ft below LSD 80 Accuracy: _____ D

Date meas: 10-23-65 Yield: _____ gpm Method determined _____

Drawdown: _____ ft Accuracy: _____ Pumping period _____ hrs _____

QUALITY OF WATER DATA: Iron _____ ppm Sulfate _____ ppm Chloride _____ ppm Hard. _____ ppm

Sp. Conduct _____ K x 10⁶ Temp. _____ °F Date sampled _____

Taste, color, etc. _____

TRANSMITTED FOR ADP.

Well No.

Φ 44

Well No. ① 44

Latitude-longitude
d m s d m s
N S

HYDROGEOLOGIC CARD

SAME AS ON MASTER CARD

Physiographic Province: 03 Section:

Drainage Basin: D 13C Subbasin:

(D) (C) (E) (P) (H) (K) (L)
Topo of depression, stream channel, dunes, flat, hilltop, sink, swamp, well site: (O) (P) (S) (T) (U) (V)
offshore, pediment, hillside, terrace, undulating, valley flat H

MAJOR AQUIFER: system series K3 aquifer, formation, group E2

Lithology: VS Origin: 6 Aquifer Thickness: ft

Length of well open to: ft 120 Depth to top of: ft 220

MINOR AQUIFER: system series aquifer, formation, group

Lithology: Origin: Aquifer Thickness: ft

Length of well open to: ft Depth to top of: ft

Intervals Screened:

Depth to consolidated rock: ft Source of data:

Depth to basement: ft Source of data:

Surficial material: Infiltration characteristics:

Coefficient Trans: gpd/ft Coefficient Storage:

Coefficient Perm: gpd/ft²; Spec cap: gpm/ft; Number of geologic cards:

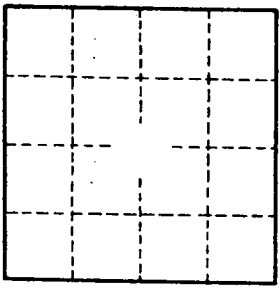

Well No. ① 44

LEE MISSISSIPPI BOARD OF WATER COMMISSIONERS

044
10-23-68

WATER WELL DRILLERS LOG

Hernon-Holt Water Supply, Inc.

Date Oct. 23, 1968, Driller: SHANNON P. O. Box 42 County Lee
(Name) MISSISSIPPI 38868

(1) Owner of Land (Name)	Description & Color of Materials Sand, Clay, Red Clay, Shell, etc.	Thick- ness Feet	Depth Feet
<u>Mrs. Bonnie Tate</u> (Address) <u>At 2 Shannon, Miss</u>	<u>uniform sand & clay</u>	<u>0 - 20</u>	<u>20</u>
	<u>blue clay</u>	<u>20 - 220</u>	<u>220</u>
(2) Location: <u>1/4, 1/4, Sec. 4 T. 11 S. R. 6 E</u>	<u>sand</u>	<u>220 - 340</u>	<u>340</u>
<u>3</u> miles <u>NE</u> , of <u>Shannon</u> (distance) (direction) (Nearest Town)	<u>Bottom</u>		
(3) Topography: <u>Hilly</u> (Hilly) (Flat) (Level)			
(4) Purpose of Well: <u>Domestic</u> (Domestic Irrigation Municipal, Industrial, Other)			

Information upon completion of well:

- (1) Diameter 4 inches.
- (2) Total Depth 340 feet.
- (3) Water Level 80 feet below top of ground.
- (4) Cased to 25', Size 4"
- (5) Screen: Size , Length
- (6) Were any formations sealed against pollution?
 yes, no.

If YES depth of formation 20'

Why uniform & sand

Drillers Remarks:

305 ELEV 302

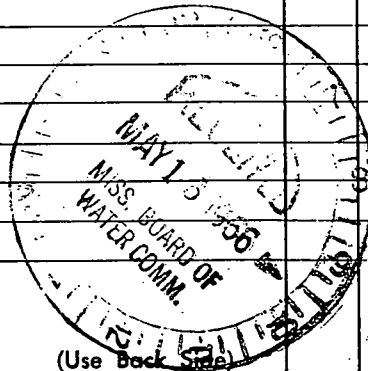

Well No.

(Use Back Side)

Mail this copy to Board of Water Commissioners 429 Miss. St. Jackson, Mis.

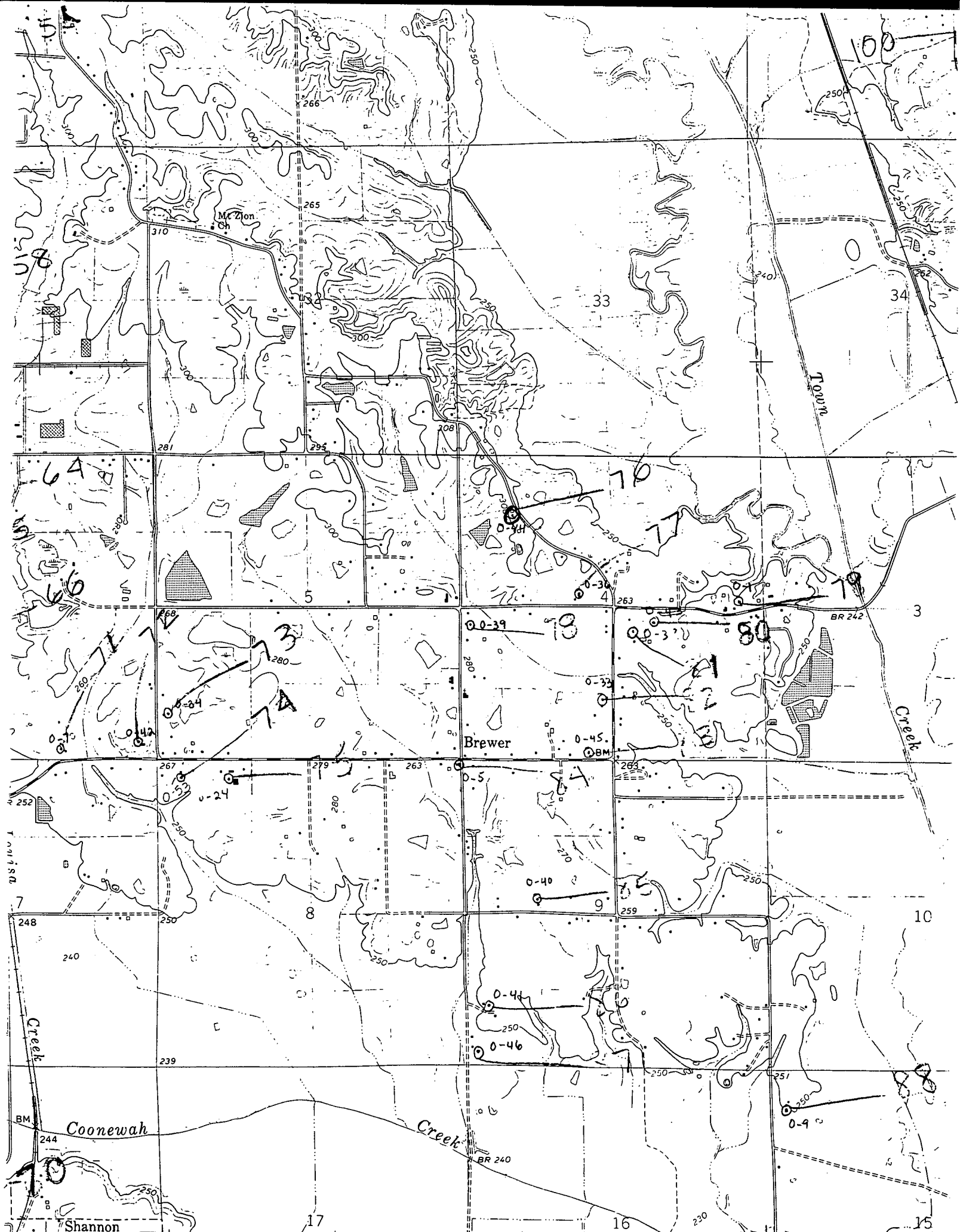

VERONA QUAD

MI 42'30" R. 6 E. 344 (SHANNON) 3252 II SW 345 3 40 347

4 L. S. 451 27 MI.