

Verona

WRD Exp. (GW)
April 1966

Well No. 040

WELL SCHEDULE

U. S. DEPT. OF THE INTERIOR

GEOLOGICAL SURVEY

WATER RESOURCES DIVISION

MASTER CARD

Record by THOMSON Source of data BOWC Date _____ Map _____

State 28 County (or town) LEE 41

Latitude: 340828N Longitude: 0884047 Sequential number: 1

Lat-long accuracy: 10 T. 11 R. 6 Sec 9 SE SW NW

Local well number: 0040CB0911506E Other number: 290

Local use: _____ Owner or name: M E KELLY Address: RT 2 SHANNON

Ownership: County (C) Fed Gov't (F) City, Corp or Co, Private (M) State Agency (N) Water Dist (P) _____

Use of water: (A) Air cond, (B) Bottling, (C) Comm, (D) Dewater, (E) Power, (F) Fire, (G) Dom, (H) Irr, (I) Med, (J) P S, (K) Rec, (L) Stock, (M) Instat, (N) Unused, (O) Repressure, (P) Recharge, (Q) Desal-P S, (R) Desal-other, (S) Other _____

Use of well: (A) Anode, (B) Drain, (C) Seismic, (D) Heat Res, (E) Obs, (F) Oil-gas, (G) Recharge, (H) Test, (I) Unused, (J) Withdraw, (K) Waste, (L) Destroyed _____

DATA AVAILABLE: Well data Freq. W/L meas.: Field aquifer char.

Hyd. lab. data: _____

Qual. water data; type: _____

Freq. sampling: _____ Pumpage inventory: period: _____

Aperture cards: _____

Log data: DRLG

WELL-DESCRIPTION CARD

SAME AS ON MASTER CARD Depth well: 300 ft Meas. DRL 3

Depth cased: (first perf.) _____ ft Casing type: _____; Diam. _____ in

Finish: (C) porous concrete, (F) gravel w. (G) gravel w. (H) horiz. open (I) perf., (J) screen, (K) sd. pt., (L) shored, (M) other _____

Method: (A) drilled, (B) air rot, (C) bored, (D) cable, (E) hyd rot, (F) jetted, (G) air percussion, (H) reverse, (I) trenching, (J) driven, (K) drive wash, (L) other _____

Date Drilled: 9-6-62 Pump intake setting: _____ ft

Driller: HEARDON SHANNON

Lift (type): (A) air, (B) bucket, (C) cent, (D) jet, (E) multiple, (F) multiple, (G) none, (H) piston, (I) rot, (J) submerg, (K) turb, (L) other _____ Deep _____ Shallow _____

Power (type): (A) diesel, (B) elec, (C) gas, (D) gasoline, (E) hand, (F) gas, (G) wind, (H) H.P. _____ Trans. or meter no. _____

Descrip. MP _____ ft above _____ below LSD. Alt. MP _____

Alt. LSD: 272 Accuracy: TOPD

Water Level: _____ ft above _____ below MP; Ft below LSD 60 Accuracy: DRL

Date meas: 9-10-62 9-6-62 Yield: _____ gpm Method determined _____

Drawdown: _____ ft Accuracy: _____ Pumping period _____ hrs

QUALITY OF WATER DATA: Iron _____ ppm Sulfate _____ ppm Chloride _____ ppm Hard. _____ ppm

Sp. Conduct _____ K x 10⁶ Temp. _____ °F Date sampled _____

Taste, color, etc. _____

TRANSMITTED FOR ADP

Well No.

40

Well No. Ø 40

Latitude-longitude N
S

HYDROGEOLOGIC CARD

Physiographic Province: SAME AS ON MASTER CARD **Section:** 03

Drainage Basin: D **Subbasin:** 13C

Topo of well site: (D) depression, (C) stream channel, (B) dunes, (P) flat, (H) hilltop, (K) sink, (L) swamp, (S) offshore, (T) pediment, (U) hillside, (V) terrace, (W) undulating, (X) valley flat H

MAJOR AQUIFER: system _____ series K3 aquifer, formation, group EUTAW E2

Lithology: US **Origin:** G **Aquifer Thickness:** _____ ft

Length of well open to: _____ ft **Depth to top of:** 120 ft 180 ft

MINOR AQUIFER: system _____ series _____ aquifer, formation, group _____ _____

Lithology: _____ **Origin:** _____ **Aquifer Thickness:** _____ ft

Length of well open to: _____ ft **Depth to top of:** _____ ft _____ ft

Intervals Screened: _____

Depth to consolidated rock: _____ ft **Source of data:** _____

Depth to basement: _____ ft **Source of data:** _____

Surficial material: _____ **Infiltration characteristics:** _____

Coefficient Trans: _____ **Coefficient Storage:** _____

Perm: _____ **Spec cap:** _____ **gpm/ft; Number of geologic cards:** _____

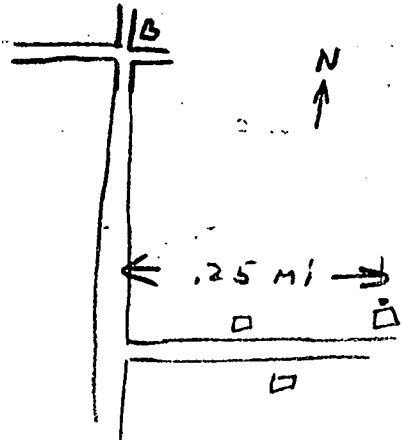
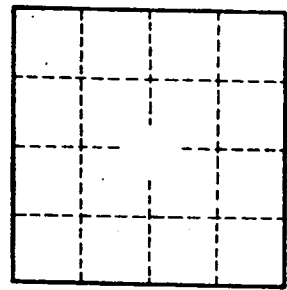

Well No.

Ø 40

LEE
 ①40
 9-10-62

MISSISSIPPI BOARD OF WATER COMMISSIONERS

WATER WELL DRILLERS LOG

Date: Sept 10, 1962, Driller: HERNDON WELL & SUPPLY CO County Lee

M.E. KELLUM P. (Name) BOX 42
SHANNON, MISSISSIPPI

(1) Owner of Land:	Description & Color of Materials Sand, Clay, Red Clay, Shell, etc.	Thick- ness Feet	Depth Feet
<u>Maria Kellum</u> (Name)			
<u>Rt 2 Shannon, Miss.</u> (Address)	<u>surface soil</u> <u>& clay</u>		<u>0</u>
(2) Location: <u>1/4, 1/4, Sec. 9 N.E.</u>			<u>25</u>
<u>3</u> miles <u>N.E.</u> of <u>Shannon</u> (distance) (direction) (Nearest Town)	<u>Blue rock</u> <u>to</u>		
(3) Topography: <u>Flat</u> (Hilly) (Flat) (Level)	<u>Spk</u> <u>to</u>		<u>180</u>
(4) Purpose of Well: <u>Domestic</u> (Domestic Irrigation Municipal, Industrial, Other)	<u>Bottom</u>		<u>300</u>

Information upon completion of well:

- (1) Diameter 4 inches.
- (2) Total Depth 300 feet.
- (3) Water Level 60 feet below top of ground.
- (4) Cased to 30 ft, Size 4"
- (5) Screen: Size , Length
- (6) Were any formations sealed against pollution?
 yes, no.

If YES depth of formation 28 ft.

Why Surface & Sand

Drillers Remarks:

290 ELEV 272

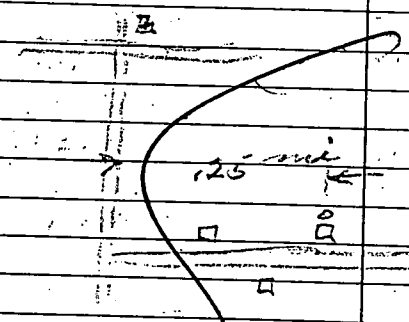

Drill bottom

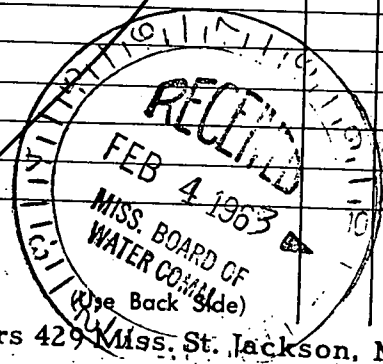

Well No.

Mail this copy to Board of Water Commissioners 429 Miss. St. Jackson, Miss.

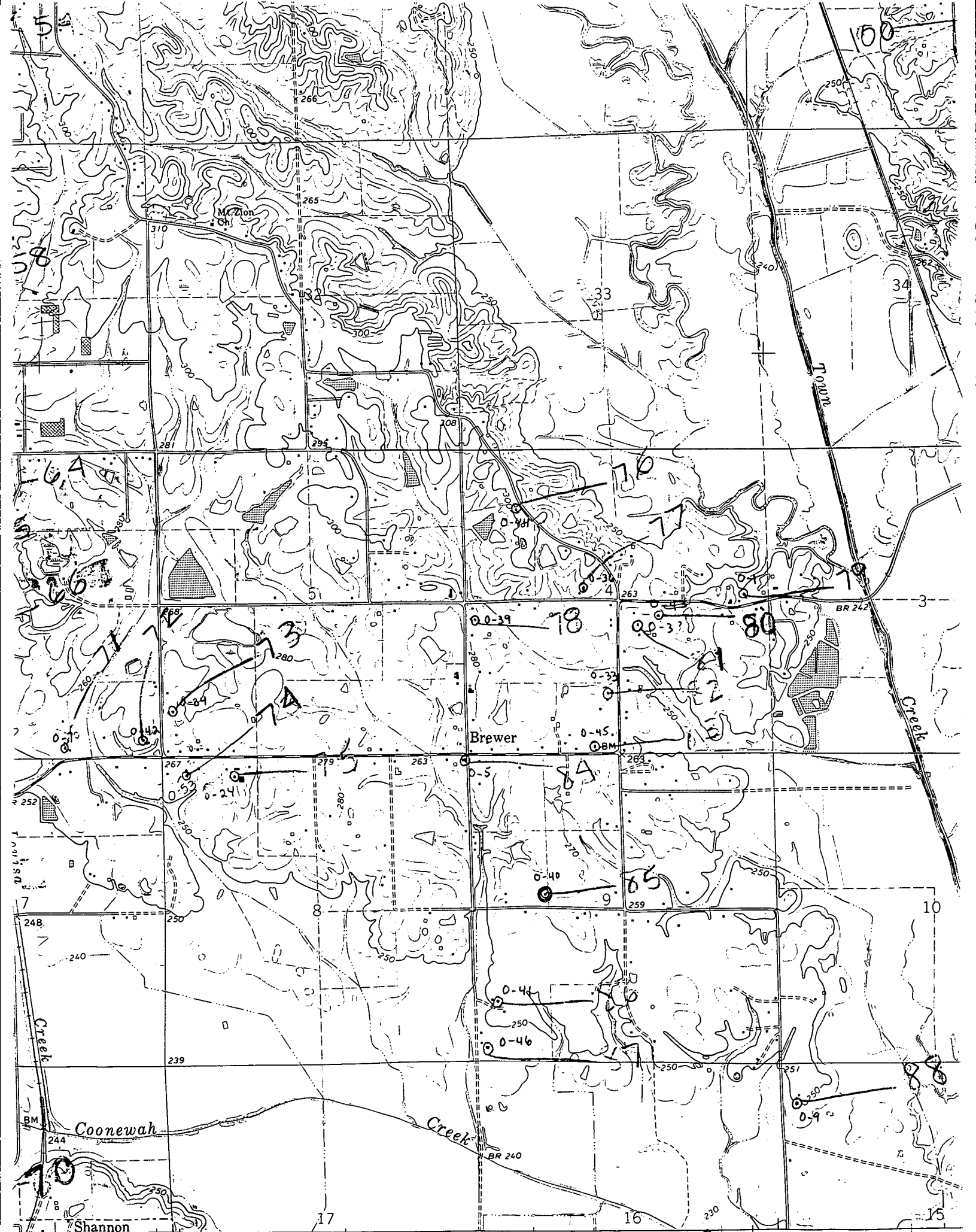

MI. 42'30" U.S. 45) 27 MI.

R. 6 E.

344 (SHANNON) 3252 II SW

VERONA QUAD

347