

WELL SCHEDULE

U. S. DEPT. OF THE INTERIOR

GEOLOGICAL SURVEY

WATER RESOURCES DIVISION

MASTER CARD

Record by THOMSON Source of data Bow C Date \_\_\_\_\_ Map \_\_\_\_\_

State 28 County (or town) LEE 41

Latitude: 34 09 21 N Longitude: 08 84 03 8 Sequential number: 1

Lat-long accuracy: 1 T. 11 S. R. 6 W. Sec. 4 SW, SE, SE, NW

Local well number: 0036080411506E Other number: 269

Local use: \_\_\_\_\_ Owner or name: \_\_\_\_\_

Owner or name: GENE KELLY Address: RT 2 SHANNON

Ownership: County, Fed Gov't, City, Corp or Co, Private, State Agency, Water Dist P

Use of water: (A) Air cond, Bottling, Comm, Dewater, Power, Fire, (H) Dom, Irr, Med, Ind, P S, Rec, (S) Stock, (T) Instir, (U) Unused, (V) Reppure, (W) Recharge, (X) Desal-P S, (Y) Desal-other, (Z) Other H

Use of well: (A) Anode, (D) Drain, (G) Seismic, (H) Heat Res, (I) Obs, (J) Oil-gas, (K) Recharge, (L) Test, (M) Unused, (N) Withdraw, (O) Waste, (P) Destroyed W

DATA AVAILABLE: Well data  Freq. W/L meas.:  Field aquifer char.

Hyd. lab. data: \_\_\_\_\_

Qual. water data; type: \_\_\_\_\_

Freq. sampling: \_\_\_\_\_ Pumpage inventory:  period: \_\_\_\_\_

Aperture cards: \_\_\_\_\_

Log data: DRILLERS

WELL-DESCRIPTION CARD

SAME AS ON MASTER CARD Depth well: 320 Meas. DRIG

Depth cased: 29 Casing type: \_\_\_\_\_; Diam. 4

Finish: porous concrete, gravel w. screen, gravel w. gallery, horiz. open perf., (H) jetted, (I) air reverse, (J) percussion, (K) rotary, (L) shored, (M) open hole, (N) other

Method Drilled: (A) air rot, (B) bored, (C) cable, (D) dug, (E) hyd, (F) jetted, (G) air, (H) reverse, (I) trenching, (J) driven, (K) drive wash, (L) other

Date Drilled: 1961 9 6 1 Pump intake setting: \_\_\_\_\_ ft

Driller: HERNDON SHANNON

Lift (type): (A) air, (B) bucket, (C) cent, (D) jet, (E) multiple, (F) multiple, (G) none, (H) piston, (I) rot, (J) submerg, (K) turb, (L) other Deep

Power (type): (A) diesel, (B) elec, (C) gas, (D) gasoline, (E) hand, (F) gas, (G) wind, (H) H.P., (I) Trans. or meter no.

Descrip. MP \_\_\_\_\_ ft above below LSD. Alt. MP \_\_\_\_\_

Alt. LSD: 278 Accuracy: Topo

Water Level: \_\_\_\_\_ ft above below MP; \_\_\_\_\_ ft above below LSD 55 Accuracy: DRIG

Date meas: FEB '61 2 6 1 Yield: \_\_\_\_\_ gpm Method determined: \_\_\_\_\_

Drawdown: \_\_\_\_\_ ft Accuracy: \_\_\_\_\_ Pumping period: \_\_\_\_\_ hrs

QUALITY OF WATER DATA: Iron \_\_\_\_\_ ppm Sulfate \_\_\_\_\_ ppm Chloride \_\_\_\_\_ ppm Hard. \_\_\_\_\_ ppm

Sp. Conduct \_\_\_\_\_ K x 10<sup>6</sup> Temp. \_\_\_\_\_ °F Date sampled: \_\_\_\_\_

Taste, color, etc. \_\_\_\_\_

TRANSMITTED FOR ADP

Well No.

036

Well No. 036

Latitude-longitude N  
S  
d m s d m s

**HYDROGEOLOGIC CARD**

**SAME AS ON MASTER CARD** Physiographic  
Province: 03 Section: \_\_\_\_\_  
D Drainage 13C Subbasin: \_\_\_\_\_  
Basin: \_\_\_\_\_

(D) (C) (B) (P) (H) (K) (L)  
Topo of depression, stream channel, dunes, flat, hilltop, sink, swamp,  
well site: (O) (P) (S) (T) (U) (V) \_\_\_\_\_ S  
offshore, pediment, hillside, terrace, undulating, valley flat

**MAJOR**  
**AQUIFER:** \_\_\_\_\_ system \_\_\_\_\_ series K3 EUTAW (UNRS) E2  
aquifer, formation, group

Lithology: \_\_\_\_\_ US Origin: \_\_\_\_\_ 6 Aquifer Thickness: \_\_\_\_\_ ft  
Length of well open to: \_\_\_\_\_ ft 125 Depth to top of: \_\_\_\_\_ ft 195

**MINOR**  
**AQUIFER:** \_\_\_\_\_ system \_\_\_\_\_ series \_\_\_\_\_ aquifer, formation, group \_\_\_\_\_

Lithology: \_\_\_\_\_ Origin: \_\_\_\_\_ Aquifer Thickness: \_\_\_\_\_ ft  
Length of well open to: \_\_\_\_\_ ft \_\_\_\_\_ Depth to top of: \_\_\_\_\_ ft \_\_\_\_\_

Intervals Screened: \_\_\_\_\_

Depth to consolidated rock: \_\_\_\_\_ ft \_\_\_\_\_ Source of data: \_\_\_\_\_

Depth to basement: \_\_\_\_\_ ft \_\_\_\_\_ Source of data: \_\_\_\_\_

Surficial material: \_\_\_\_\_ Infiltration characteristics: \_\_\_\_\_

Coefficient Trans: \_\_\_\_\_ gpd/ft \_\_\_\_\_ Coefficient Storage: \_\_\_\_\_

Coefficient Perm: \_\_\_\_\_ gpd/ft<sup>2</sup>; Spec cap: \_\_\_\_\_ gpm/ft; Number of geologic cards: \_\_\_\_\_

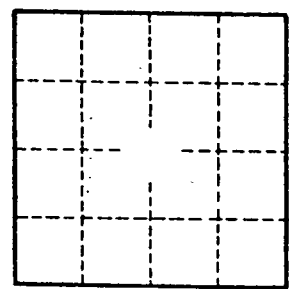

Well No. 036

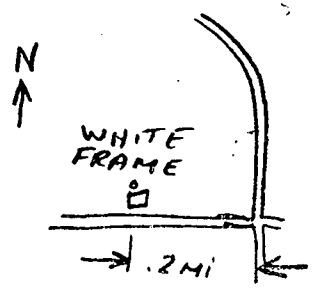

LEE  
D36

WELL

LOG

Herndon Well & Supply Co.

Date 2/15/61, 1961, Driller: GENE KELLY (1967)

SHANNON, MISS. County Lee

(Name)

| (1) Owner of Land: <u>Hugh A. Tate</u><br>(Name)  | Description & Color of Materials<br>Sand, Clay, Red Clay, Shell, etc. | Thick-<br>ness<br>Feet | Depth<br>Feet |
|---|---|------------------------|---------------|
| <u>Rt 2 SHANNON, MISS.</u><br>(Address)   | <u>clay</u>   |                        |               |
| (2) Location: <u>1/4, 1/4, Sec. 4 T11 S16 R6 E</u>  | <u>Blk - Rock</u>   | <u>26</u>              |               |
| <u>3</u> miles <u>NE</u> , of <u>SHANNON</u><br>(distance) (direction) (Nearest Town)         | <u>Rock</u>   | <u>76</u>              |               |
| (3) Topography: <u>Flat</u><br>(Hilly) (Flat) (Level)   | <u>Blue Rock</u>  | <u>86</u>              |               |
| (4) Purpose of Well: <u>Home Use</u><br>(Domestic Irrigation<br>Municipal, Industrial, Other) | <u>SAND</u>   | <u>195</u>             |               |
|   | <u>Bottom</u>   | <u>320</u>             |               |

Information upon completion of well:

- (1) Diameter 4 inches.
- (2) Total Depth 320 feet.
- (3) Water Level 55 feet below top of ground.
- (4) Cased to 29', Size 4"
- (5) Screen: Size \_\_\_\_\_, Length \_\_\_\_\_
- (6) Were any formations sealed against pollution?  
 yes, \_\_\_\_\_ no.

If YES depth of formation 25 ft.

Why Surface & Sand

Drillers Remarks: \_\_\_\_\_

269 272

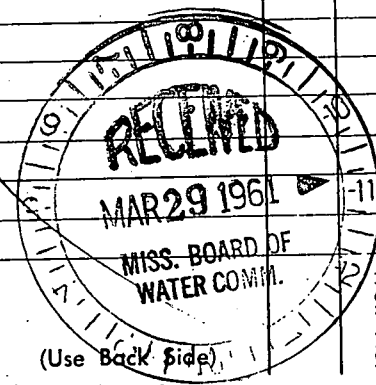
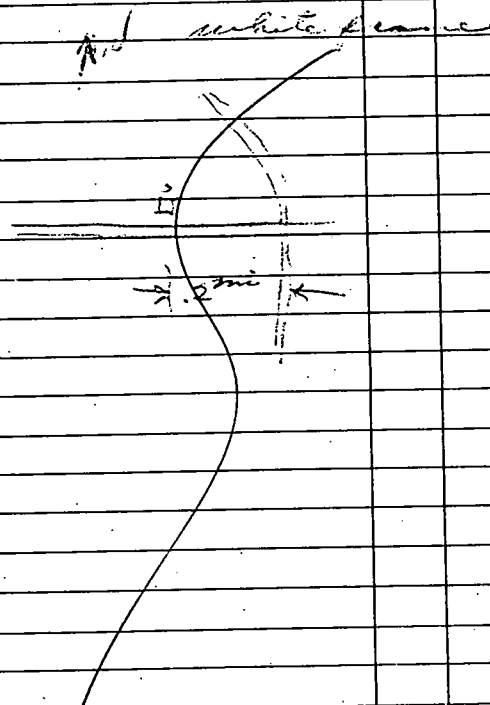

Well No.

Mail this copy to Board of Water Commissioners 429 Miss. St. Jackson, Miss

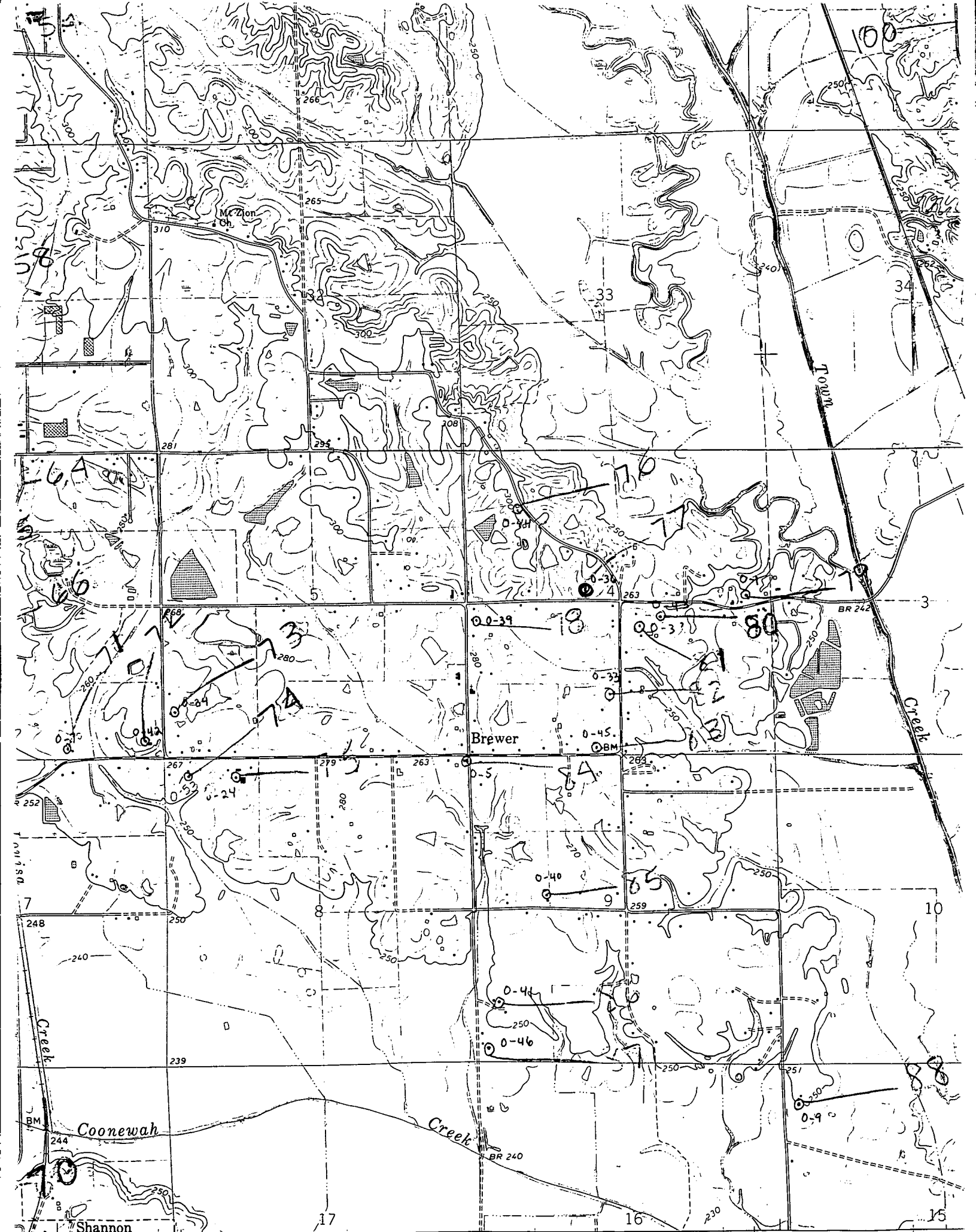

MI. 42' 30" R. 6 E.

U.S. 451 27 MI.

344 (SHANNON) 3252 II SW

345 346 347

# VERONA QUAD