

WELL SCHEDULE

U. S. DEPT. OF THE INTERIOR

GEOLOGICAL SURVEY

WATER RESOURCES DIVISION

MASTER CARD

Record by THOMSON Source of data Bow C Date 3/28/67 Map _____

State 2E County (or town) LEE 41

Latitude: 340522 N Longitude: 0883808 Sequential number: 1

Lat-long accuracy: 1 T. 11 R. 6 Sec 26 SE 15 SW SE

Local well number: Φ 030302611506E Other number: 292

Local use: _____ Owner or name: EDD MCDUFFE Address: _____

Ownership: County, Fed Gov't, City, Corp or Co, Private, State Agency, Water Dist P

Use of water: (A) Air cond, Bottling, Comm, Dewater, Power, Fire, Dom, Irr, Med, Ind, P S, Rec, (S) Stock, Instit, Unused, Repressure, Recharge, Desal-P S, Desal-other, Other H

Use of well: (A) Anode, Drain, Seismic, Heat Res, Obs, Oil-gas, Recharge, Test, Unused, Withdraw, Waste, Destroyed W

DATA AVAILABLE: Well data Freq. W/L meas.: I Field aquifer char.

Hyd. lab. data: _____

Qual. water data; type: _____

Freq. sampling: _____ Pumpage inventory: no period: _____

Aperture cards: _____

Log data: DRILLERS

WELL-DESCRIPTION CARD

SAME AS ON MASTER CARD Depth well: 160 Meas. 3

Depth cased: (first perf.) _____ ft 20 Casing type: _____; Diam. _____ in 4

Finish: porous concrete, gravel w. (perf.), (screen), gallery, end, horz. open perf., screen, sd. pt., shored, open hole, other X

Method Drilled: (A) air bored, (B) cable, (C) dug, (D) hyd jetted, (E) rot., (F) air reverse, (G) percuss, (H) rot., (I) air reverse, (J) driven, (K) wash, (L) other H

Date Drilled: 962 Pump intake setting: _____ ft _____

Driller: HERNDON name address _____

Lift (type): (A) air, (B) bucket, (C) cent, (D) jet, (E) multiple, (F) multiple, (G) none, (H) piston, (I) rot, (J) submerg, (K) turb, (L) other P Deep Shallow

Power (type): diesel, elec, gas, gasoline, hand, gas, wind; H₂P. 1 Trans. or meter no. _____

Descrip. MP _____ ft above below LSD. Alt. MP _____

Alt. LSD: 222 Accuracy: _____ (source) 4

Water Level _____ ft above below MP; Ft above below LSD 40 Accuracy: _____

Date meas: 10-6-62 062 Yield: _____ gpm _____ Method determined _____

Drawdown: _____ ft _____ Accuracy: _____ Pumping period _____ hrs _____

QUALITY OF WATER DATA: Iron _____ ppm Sulfate _____ ppm Chloride _____ ppm Hard. _____ ppm

Sp. Conduct _____ K x 10⁶ _____ Temp. _____ °F _____ Date sampled _____

Taste, color, etc. _____

TRANSMITTED FOR ADP

Well No.

Φ 30

Well No. Ø 30

Latitude-longitude _____
d m s N S

HYDROGEOLOGIC CARD

SAME AS ON MASTER CARD Physiographic Province: 03 Section: _____

D Drainage Basin: 13C Subbasin: _____

Topo of well site: (D) depression, (C) stream channel, (E) dunes, (F) flat, (H) hilltop, (K) sink, (L) swamp, (Ø) offshore, (P) pediment, (S) hillside, (T) terrace, (U) undulating, (V) valley flat V

MAJOR AQUIFER: system _____ series K3 aquifer, formation, group EUTAW E3

Lithology: US Origin: 6 Aquifer Thickness: _____ ft

Length of well open to: _____ ft 100 Depth to top of: _____ ft 60

MINOR AQUIFER: system _____ series _____ aquifer, formation, group _____

Lithology: _____ Origin: _____ Aquifer Thickness: _____ ft

Length of well open to: _____ ft _____ Depth to top of: _____ ft _____

Intervals Screened:

Depth to consolidated rock: _____ ft _____ Source of data: _____

Depth to basement: _____ ft _____ Source of data: _____

Surficial material: _____ Infiltration characteristics: _____

Coefficient Trans: _____ gpd/ft _____ Coefficient Storage: _____

Coefficient Perm: _____ gpd/ft²; Spec cap: _____ gpm/ft; Number of geologic cards: _____

WL 13.0 3/21/67

↑ N

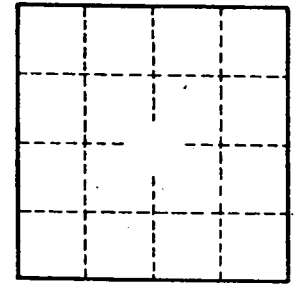
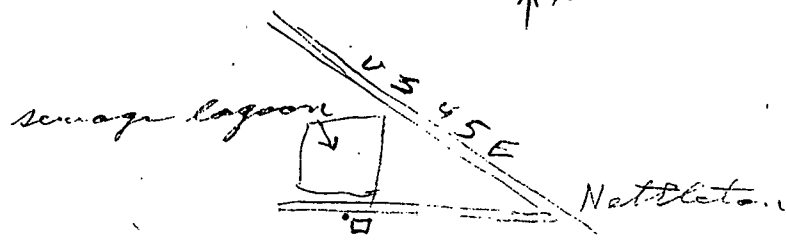

Well No.

Ø 30

LEE MISSISSIPPI BOARD OF WATER COMMISSIONERS

30
10-6-62

WATER WELL DRILLERS LOG

Date: Oct 6, 1962, Driller: HERNDON WELL & SUPPLY CO.
P.O. BOX 42 County Lee
EDD McDUFFE SHANNON, MISSISSIPPI

(1) Owner of Land	Description & Color of Materials	Thick-ness Feet	Depth Feet
<i>Land of Nettleton</i> (Name) <i>Nettleton, Miss.</i> (Address)	<i>sand & clay</i>		0
(2) Location: $\frac{1}{4}$, $\frac{1}{4}$, Sec. <i>26 118</i> T. <i>66</i> R. <i>66</i>	<i>Blue sand</i>		15
$\frac{1}{2}$ miles <i>W</i> , of <i>Nettleton</i> (distance) (direction) (Nearest Town)	<i>sand</i>		60
(3) Topography: <i>Flat</i> (Hilly) (Flat) (Level)	<i>Bottom</i>		160
(4) Purpose of Well: <i>Domestic</i> (Domestic Irrigation Municipal, Industrial, Other)			

Information upon completion of well:

- (1) Diameter *4* inches.
- (2) Total Depth *160* feet.
- (3) Water Level *40* feet below top of ground. *13.0 3/2/67*
- (4) Cased to *20'*, Size *4"*
- (5) Screen: Size *—*, Length *—*
- (6) Were any formations sealed against pollution?
 yes, no.

If YES depth of formation *15'*

Why *super sand*

Drillers Remarks: *next to sewage lagoon - south side of lagoon*

292 ELEV 222

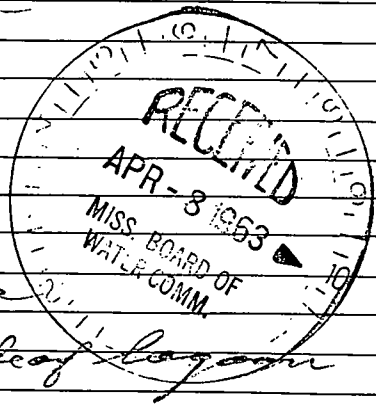

(Use Back Side)

Well No.

Mail this copy to Board of Water Commissioners 429 Miss. St. Jackson, Miss

SHANNON QUAD

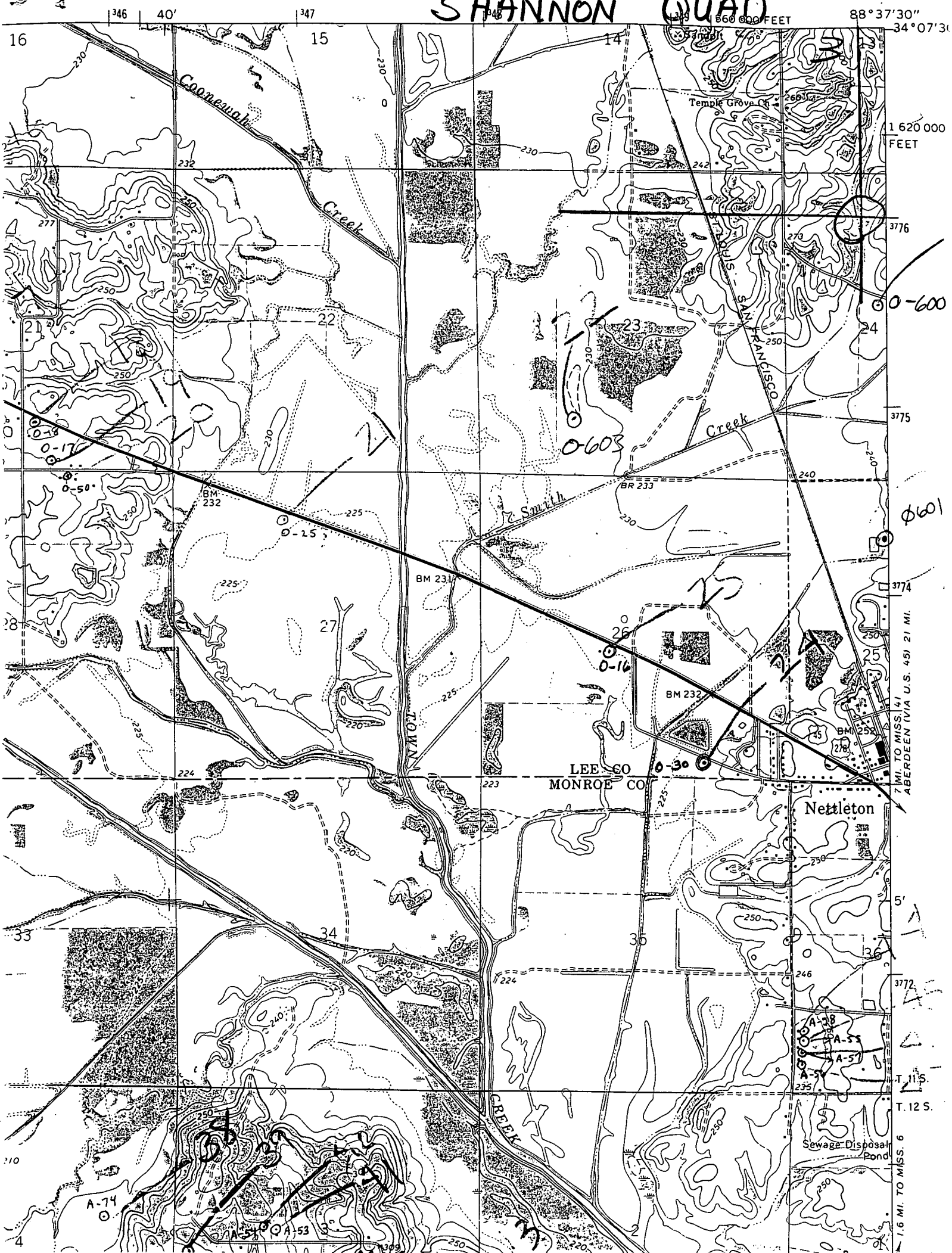

88° 37' 30" 34° 07' 30"

1 620 000 FEET

7 MI. TO MISS. 141 ABERDEEN (VIA U.S. 45) 21 MI.

T. 11 S. T. 12 S. 1.6 MI. TO MISS. 6