

DRILLERS LOG
ON BACK

9-185
(October 1950)

UNITED STATES
DEPARTMENT OF THE INTERIOR
GEOLOGICAL SURVEY
WATER RESOURCES DIVISION

Log #16

WELL SCHEDULE

Date 7/17, 1962 Field No. _____
Record by P.E. Grantham Office No. 0-26
Source of data Dr. & Observation

1. Location: State Miss County Lee Co.
Map _____

SW NE 1/4 NW 1/4 sec. 6 T. 11 N. R. 6 E
W

2. Owner: Air Capital Manufacturers Inc Address Verona
Tenant (Power Mowers) Address _____
Driller Carloss Drlg. Co. Address Memphis

3. Topography Rolling

4. Elevation 250 ft. above _____
below _____

5. Type: Dug (drilled), driven, bored, jetted 7/19/62

6. Depth: Rept. 502 ft. Meas. _____ ft.

7. Casing: Diam. 12" in., to _____ in., Type _____
Depth 416' ft., Finish Gravel Wall - 82' screen

8. Chief Aquifer Eutaw 8' screen From 360 ft. to 510 ft.
Others _____

9. Water level 67 ft. (rept) when drilled 19 above _____
meas. _____ below _____
which is _____ ft. above _____
below _____ surface

10. Pump: Type Turbine Capacity _____ G. M.

Power: Kind electricity Horsepower 60

11. Yield: Flow _____ G. M., Pump 500 G. M., Meas. (rept) Est. _____

Drawdown _____ ft. after _____ hours pumping _____ G. M.

12. Use: Dom., Stock, PS., RR., (Ind.), Irr., Obs. _____

Adequacy, permanence _____

13. Quality _____ Temp _____ °F.

Taste, odor, color _____ Sample Yes

Unfit for _____ No

14. Remarks: (Log, Analyses, etc.) mod Res 16 @ 92°F

to 524 ft.

Reported yield 8 gals/foot (drler)

air line 235'

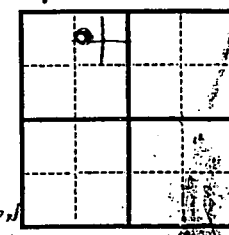

DEPARTMENT OF THE INTERIOR
 GEOLOGICAL SURVEY
 WASHINGTON, D. C.

26

- 0-12 Clay
- 12-15 sd yellow
- 15-91 Hard Soap Stone
- 91-122 Soapstone Hard spots
- 121-122 Rock 10"
- 122-136 Soapstone then Rock
- 136-224 " " Softer
- 224-242 sdy sh
- 242-249 sd stik clay
- 249-272 Black sdy sh
- 272-294 soft sdy sh
- 294-304 sh
- 304-316 sd with thin hard spots
- 316-344 sdy sh lignite
- 340-380 sdy sh
- 385-407 sand fine hard-stik sh
- 407-430 sd with thin stik sh sd
- 430-498 sd fine hard
- 498-499 Hard spot
- 499-472 sd
- 472-475 clay hrd
- 475-487 clay stiks sd
- 487-496 sd
- 496-515 sd small Gray
- 515-528 white clay

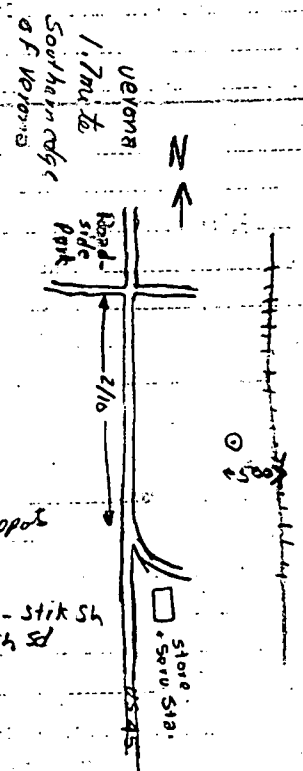

DEPARTMENT OF ENVIRONMENTAL QUALITY - OLWR
PUBLIC SUPPLY WELLS PROJECT

GPS LOG

USER NAME(S): Phillips/Jennings DATE: 10/27/98

UNIT DEQ #: _____ FILE #: B102716 B

HEALTH DEPT. #: 410028-02 ELEV. 275

USGS #: 026 OLWR #: CW05481

OWNER: Lee/Tupelo Ind. Park QUAD: Verona

LOCATION: NW/NE S 6 T 115 R 6 E COUNTY: Lee

LOCATION DESCRIPTION: West side of Elevated tank, behind
plant (^{GPS} 20' west of well)

CASING DIA: _____ PUMP TYPE & SIZE: _____

GPS FIELD LOCATION: LAT. 34° 09' 37.2" LONG. 88° 42' 58.7"

GPS CORRECTED LOCATION: LAT. 34.159984 LONG. 88.715732

REMARKS: (couldn't get in to check tag)

Behind Aircap MTD Plant

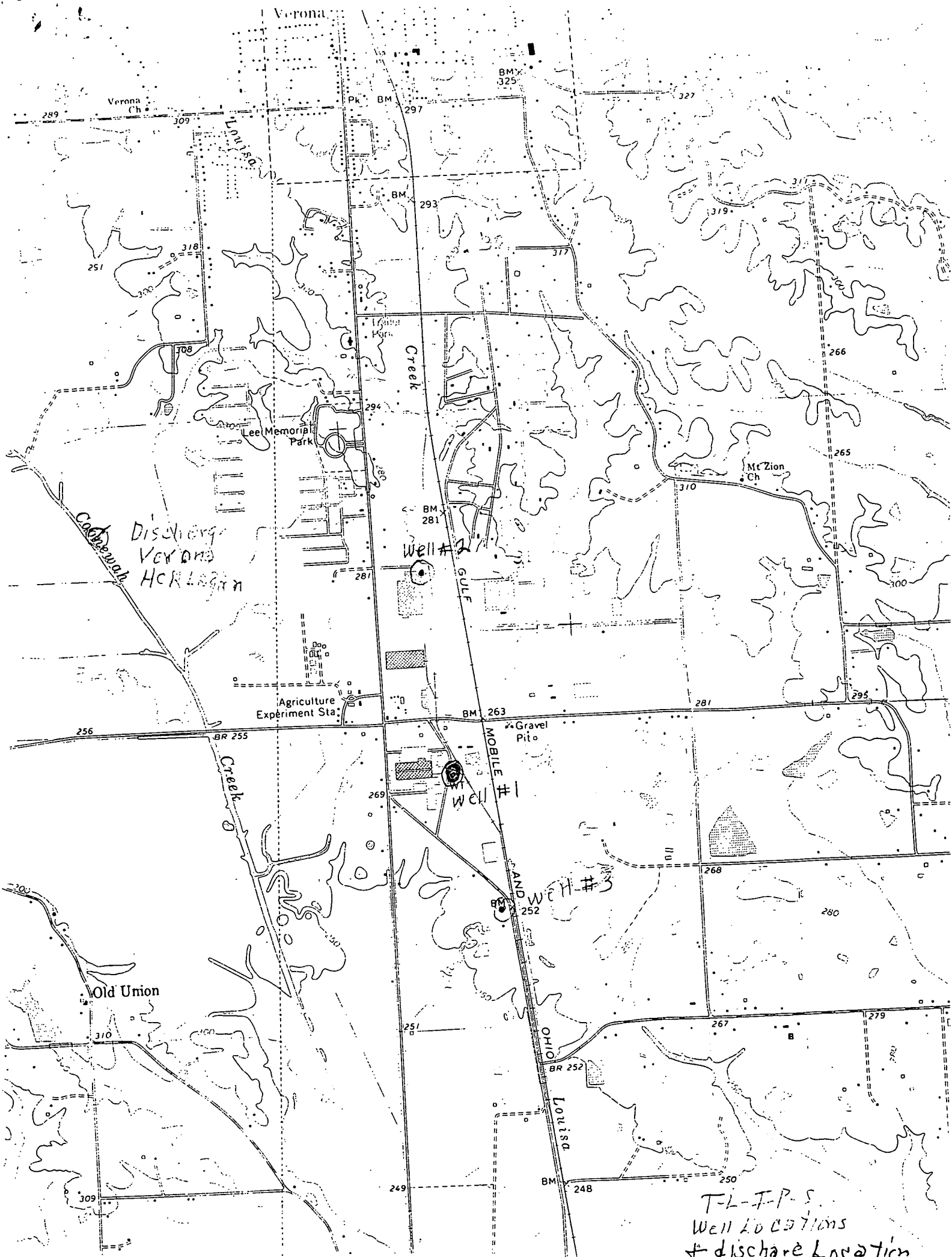

Discharge
VERONA
HCR LEGAN

Well #2

Well #1

Well #3

T-L-F-P-S
Well locations
& discharge location

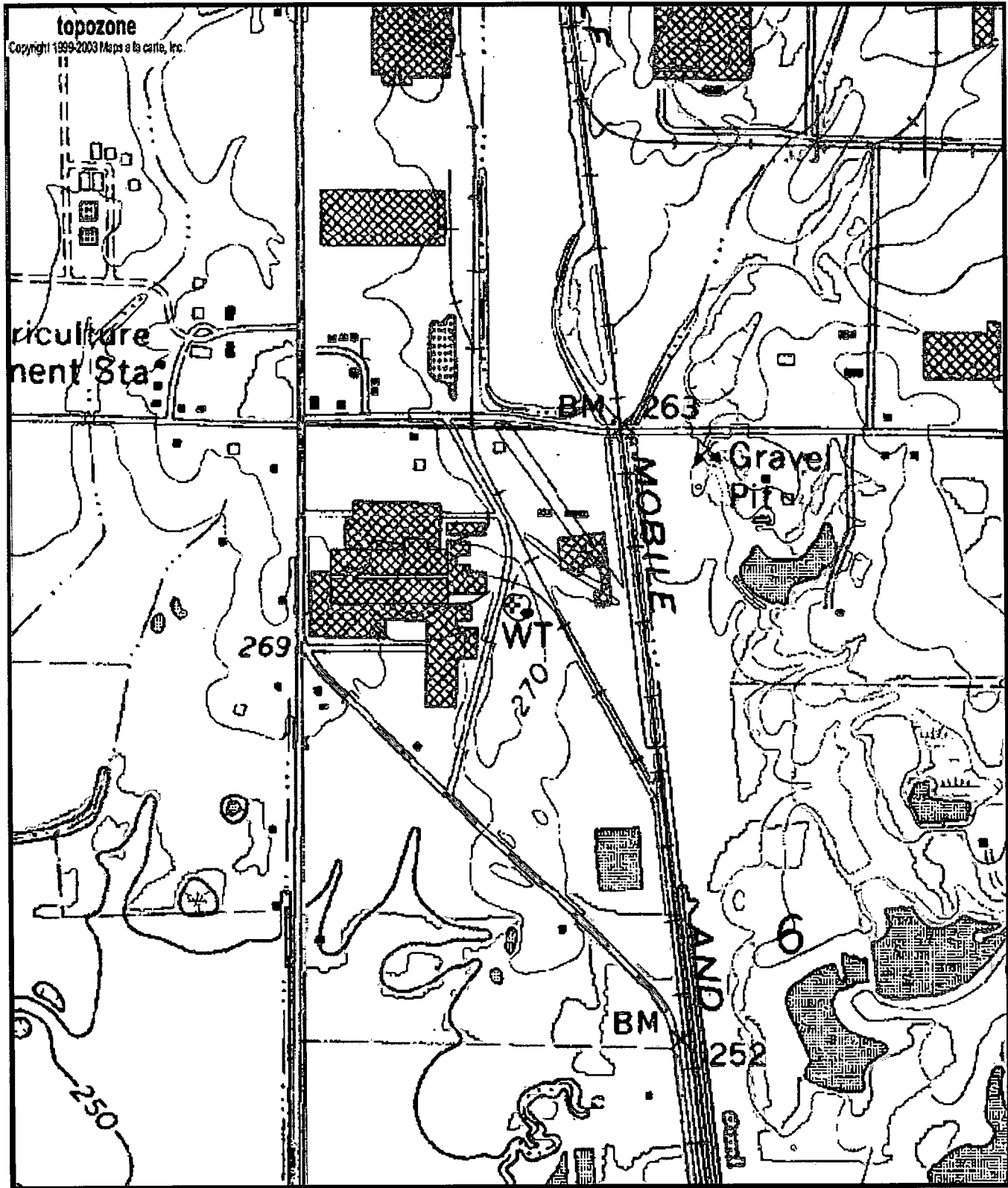

Ø26
 Gw05481
 0410028-02

0 0.1 0.2 0.3 0.4 0.5 km
 0 0.05 0.18 0.27 0.36 0.45 mi
 Map center is 34° 09' 36"N, 88° 42' 57"W (WGS84/NAD83)
Verona quadrangle
 Projection is UTM Zone 16 NAD83 Datum

M=-0.863
 G=-0.964