

9-185
(October 1950)

UNITED STATES
DEPARTMENT OF THE INTERIOR
GEOLOGICAL SURVEY
WATER RESOURCES DIVISION

WELL SCHEDULE

Date 9-11-56, 19 24 Field No. 24
Record by H. H. T. Office No. 05
Source of data Mr. Johnston

1. Location: State Miss County Lee

Map

NE - NE $\frac{1}{4}$ NE $\frac{1}{4}$ sec. 9 T 11 N 6 E W
S R

2. Owner: J. R. Johnston Address Shannon, MS

Tenant _____ Address _____

Driller Hannay Bros Address _____

3. Topography rolling

4. Elevation 280+ ft. above Topo.
below

5. Type: Dug, drilled, driven, bored, jetted 1920

6. Depth: Rept. 32.5 ft. Meas. _____ ft.

7. Casing: Diam. 4 in., to _____ in., Type _____

Depth 3.5 ft., Finish to solid rock

8. Chief Aquifer Ke From _____ ft. to _____ ft.

Others _____

9. Water level 45 ft. rept. 19.56 above
meas. below

_____ which is _____ ft. above
below surface

10. Pump: Type Cylinder Capacity _____ G. M.

Power: Kind elec Horsepower 3/4

11. Yield: Flow _____ G. M., Pump _____ G. M., Meas., Rept. Est. _____

Drawdown _____ ft. after _____ hours pumping _____ G. M.

12. Use: Dom., Stock, PS., RR., Ind., Irr., Obs. _____

Adequacy, permanence _____

13. Quality good Temp _____ °F.

Taste, odor, color clear Sample Yes
No

Unfit for _____

14. Remarks: (Log, Analyses, etc.) _____

Water level dropped about 20 feet
since drilled.

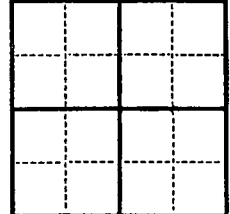

N

UNITED STATES GEOLOGICAL SURVEY
BUREAU OF GEOLOGICAL SURVEY
WASHINGTON, D. C. 20508

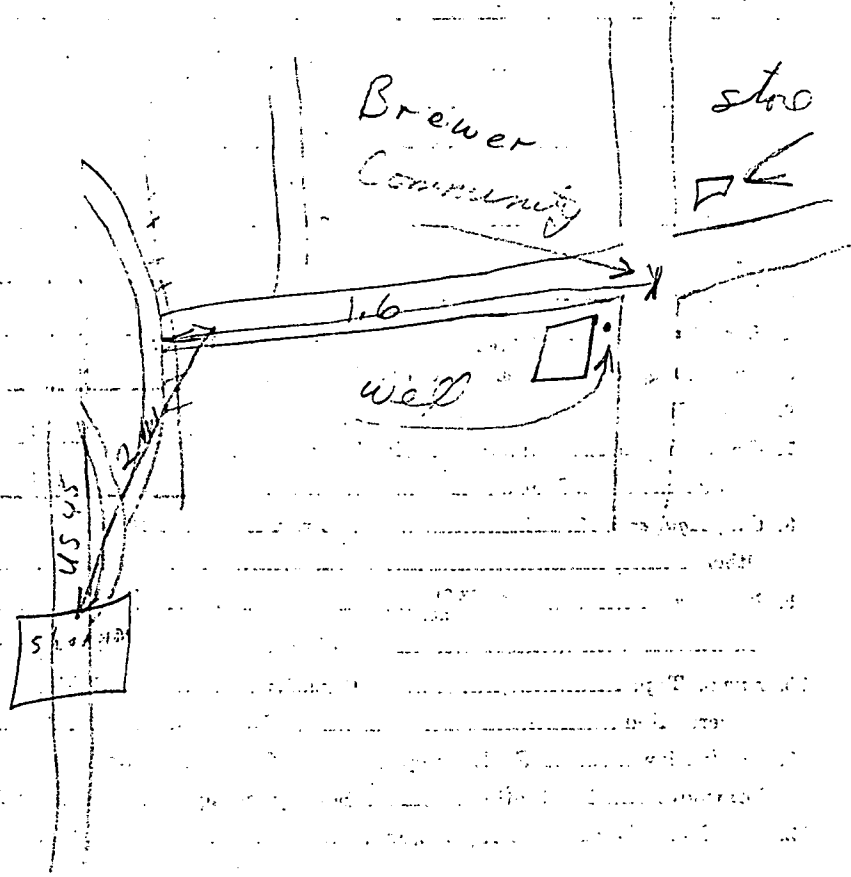

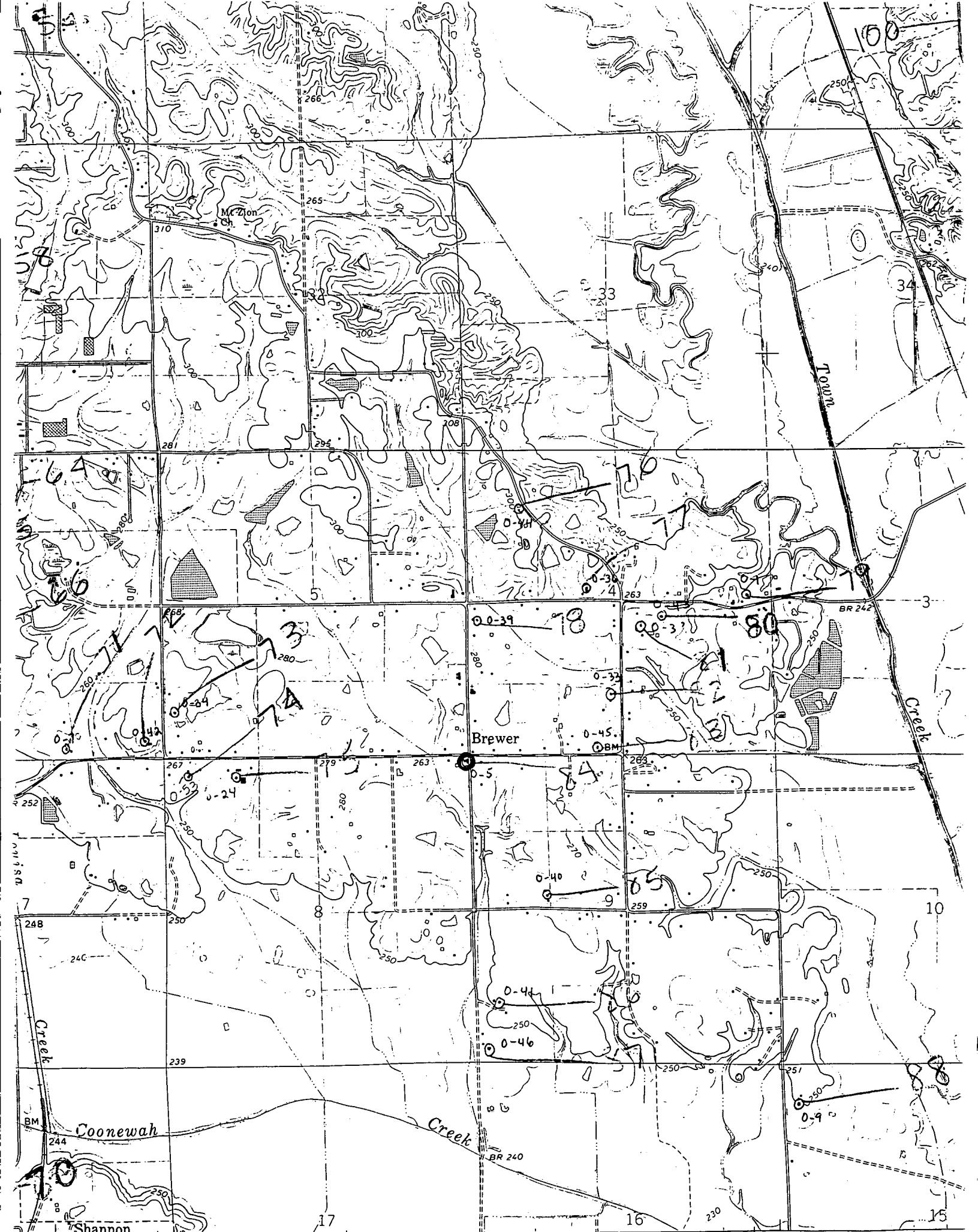

MI. 42' 30" R. 6 E.
U.S. 45) 27 MI.

344 (SHANNON)
3252 II SW

VERONA QUAD

347