

9-185
(October 1950)

UNITED STATES
DEPARTMENT OF THE INTERIOR
GEOLOGICAL SURVEY
WATER RESOURCES DIVISION

WELL SCHEDULE

Date 9-11-56, 19 56 Field No. 29
Record by Hitt Office No. 01
Source of data Neighbor - Gerson

1. Location: State Miss County Lee

Map

SE-SE 1/4 NE 1/4 sec. 4 T 11 N 6 R 6 E W

2. Owner: J.W. Ransom Address PS 2 Shreveport

Tenant _____ Address _____

Driller _____ Address _____

3. Topography flat

4. Elevation 300 ft. above TEPO. below

5. Type: Dug, drilled, driven, bored, jetted _____ 1920

6. Depth: Rept. 250 ft. Meas. _____ ft.

7. Casing: Diam. _____ in., to _____ in., Type _____

Depth _____ ft., Finish _____

8. Chief Aquifer KeT From _____ ft. to _____ ft.

Others _____

9. Water level .15 ft. rept. 19.54 above meas. below surface

_____ which is _____ ft. above surface

10. Pump: Type Clenden Capacity _____ G. M.

Power: Kind elec Horsepower 1/2

11. Yield: Flow _____ G. M., Pump _____ G. M., Meas., Rept. Est.

Drawdown _____ ft. after _____ hours pumping _____ G. M.

12. Use: Dom., Stock, PS, RR., Ind., Irr., Obs.

Adequacy, permanence _____

13. Quality 3 fam. liq. Temp _____ °F.

Taste, odor, color good clean "best" Sample Yes No

Unfit for _____

14. Remarks: (Log, Analyses, etc.) originally this

well was drilled - pipe installed

1937

4
N

ad B...

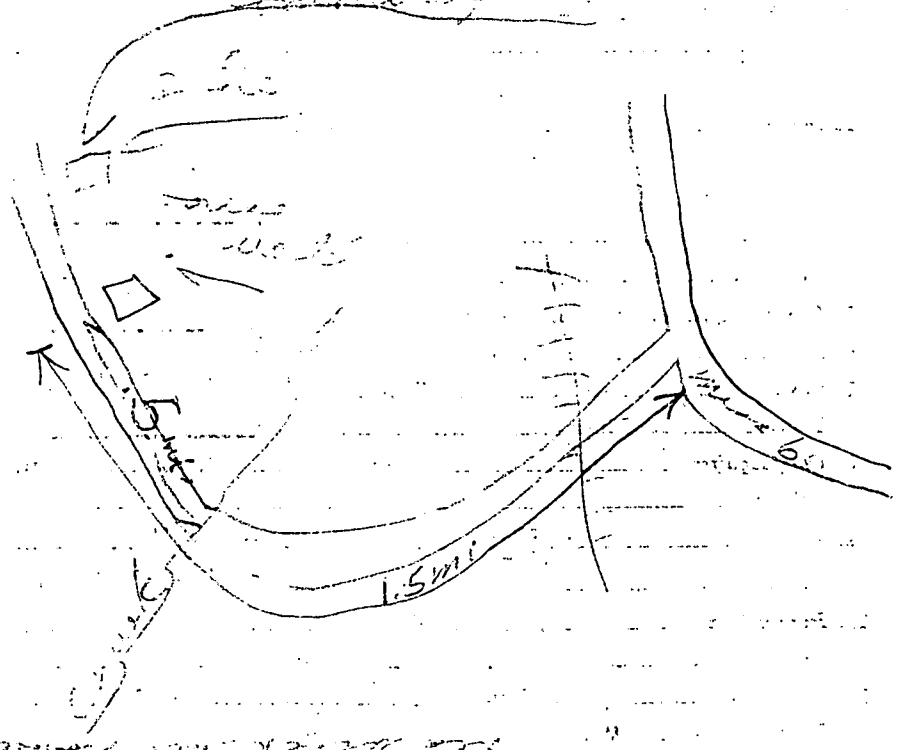

10
...

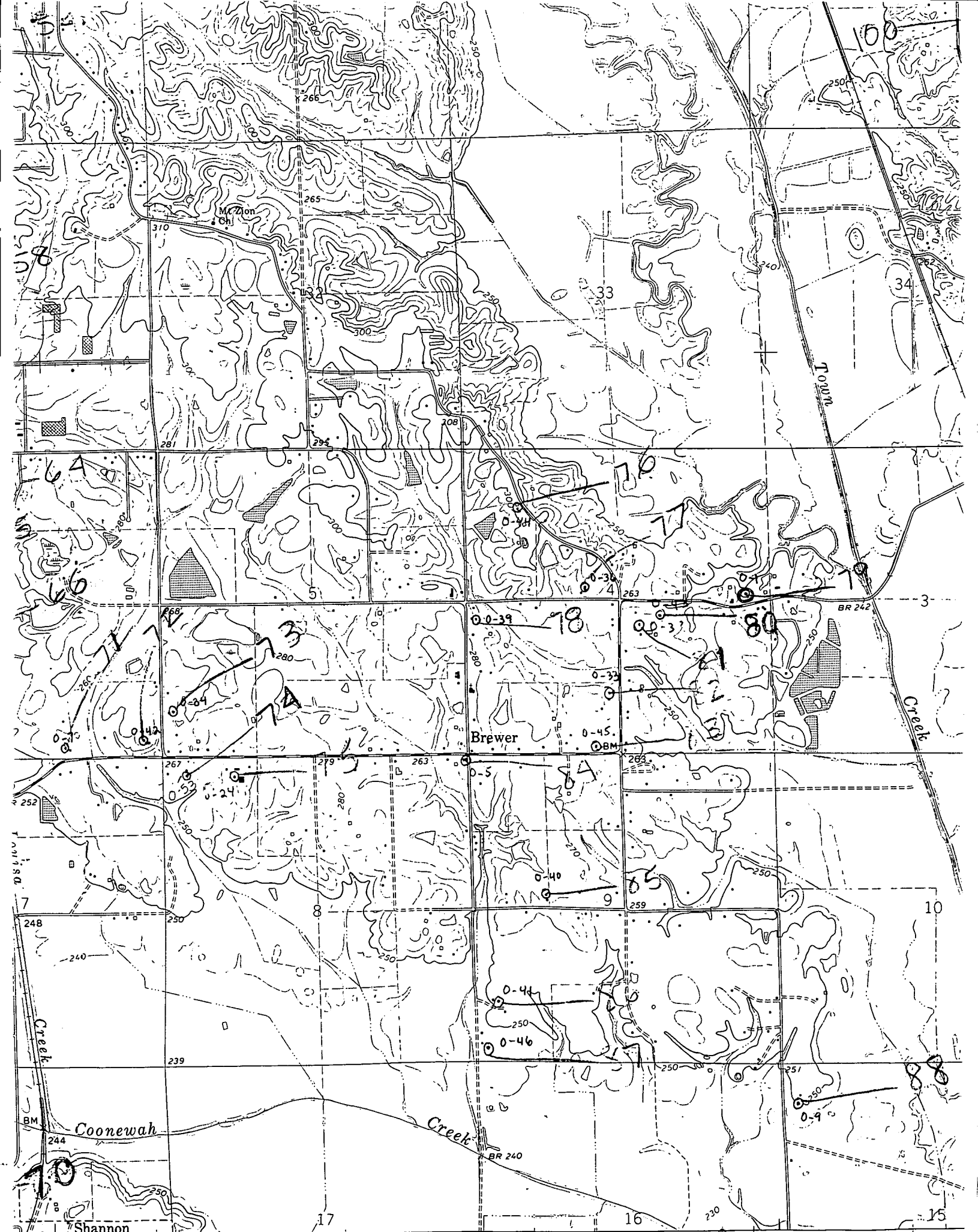

MI. 42' 30" R. 6 E.
4 U.S. 45) 27 MI.

344 (SHANNON)
3252 II SW

345 346 347
VERONA QUAD