

WRF Exp. (GW)
April 1966

Well No. N 34

WELL SCHEDULE

U. S. DEPT. OF THE INTERIOR GEOLOGICAL SURVEY WATER RESOURCES DIVISION

MASTER CARD

Record by HERNDEN Source of data Bore Date 4/12/67 Map _____

State DE County (or town) Lee 4/1

Latitude: 34^{deg} 07^{min} 13^{sec} N Longitude: 088^{degrees} 43^{min} 10^{sec} W Sequential number: 1

Lat-long accuracy: 1 T. 11 S; R. 6 E Sec. 13 SE 1/4, SE 1/4, SE 1/4

Local well number: 19034D131150GE Other number: 295 B & H

Local use: _____ Owner or name: _____ Address: _____

Owner or name: STRAW HARP

Ownership: County, Fed Gov't, City, Corp or Co, Private, State Agency, Water Dist _____ P

Use of Air cond, Bottling, Comm, Dewater, Power, Fire, Dom, Irr, Med, Ind, P S, Rec, _____

Water: (S) (T) (U) (V) (W) (X) (Y) (Z) _____ H

Use of well: (A) (D) (G) (H) (Q) (P) (R) (T) (U) (W) (X) (Z) _____ W

DATA AVAILABLE: Well data Freq. W/L meas.: Field aquifer char.

Hyd. lab. data: _____

Qual. water data; type: USGS PARTIAL

Freq. sampling: _____ Pumpage inventory: yes no period: _____

Aperture cards: _____ yes

Log data: DRILLING

WELL-DESCRIPTION CARD

SAME AS ON MASTER CARD Depth well: _____ ft 360 Meas. rept accuracy _____ 3

Depth cased; (first perf.): _____ ft 23 Casing type: _____; Diam. in 4

Finish: (C) porous concrete, (F) gravel w. (perf.), (G) gravel w. (screen), (H) horiz. gallery, (Q) open end, (P) perf., (S) screen, (T) sd. pt., (W) shored, (X) open hole, (Z) other _____ X

Method Drilled: (A) air rot., (B) bored, (C) cable, (D) dug, (H) rot., (J) jetted, (P) air percussion, (R) reverse, (T) rotary, (V) trenching, (W) driven wash, (Z) other _____ H

Date Drilled: 9-6-61 Pump intake setting: _____ ft _____

Driller: HERNDEN

Lift (type): (A) air, (B) bucket, (C) cent., (J) jet, (L) multiple, (M) multiple, (N) none, (P) piston, (R) rot., (S) submerg, (T) turb., (Z) other _____ Deep Shallow

Power (type): nat diesel, elec, gas, gasoline, hand, gas, wind; LP _____ Trans. or meter no. _____

Descrip. MP _____ ft above _____ below LSD, Alt. MP _____

Alt. LSD: _____ 260 Accuracy: (source) _____ 7

Water Level _____ ft above _____ below MP; _____ ft above _____ below LSD 60 Accuracy: _____ 11

Date meas: 8-16-61 567 Yield: _____ gpm _____ Method determined _____

Drawdown: _____ ft _____ Accuracy: _____ Pumping period _____ hrs _____

QUALITY OF WATER DATA: Iron _____ ppm Sulfate _____ ppm Chloride _____ ppm Hard. _____ ppm

Sp. Conduct 400 K x 10⁶ 3 Temp. _____ °F Date sampled 3-21-67 367

Taste, color, etc. _____

TRANSMITTED FOR ADP

Well No. 134

Well No. N 34

Latitude-longitude N
S
d m s d m s

HYDROGEOLOGIC CARD

SAME AS ON MASTER CARD Physiographic Province: 013 Section: _____

Drainage Basin: D Subbasin: 131C

Topo of well site: (D) (C) (E) (F) (H) (K) (L) 27 5
 depression, stream channel, dunes, flat, hilltop, sink, swamp,
 (Ø) (P) (S) (T) (U) (V)
 offshore, pediment, hillside, terrace, undulating, valley flat

MAJOR AQUIFER: _____ system, _____ series K3 EUTAW aquifer, formation, group E7

Lithology: US Origin: G Aquifer Thickness: _____ ft

Length of well open to: _____ ft 125 Depth to top of: _____ ft 240

MINOR AQUIFER: _____ system, _____ series _____ aquifer, formation, group _____

Lithology: _____ Origin: _____ Aquifer Thickness: _____ ft

Length of well open to: _____ ft _____ Depth to top of: _____ ft _____

Intervals Screened: _____

Depth to consolidated rock: _____ ft 60 Source of data: _____ 64

Depth to basement: _____ ft 65 Source of data: _____ 69

Surficial material: _____ Infiltration characteristics: _____ 72

Coefficient Trans: _____ gpd/ft 73 Coefficient Storage: _____ 78

Coefficient Perm: _____ gpd/ft²; Spec cap: _____ spm/ft; Number of geologic cards: _____ 79

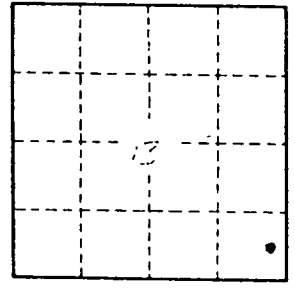

Well No. _____

LEE
N34
8-16-61

MISSISSIPPI BOARD OF WATER COMMISSIONERS

WATER WELL DRILLERS LOG

HERNDON WELL & SUPPLY CO.

Date: 16 Aug, 1961, Driller: P. O. BOX 42 County: Lee
SHANNON, MISSISSIPPI

207
#305

	Description & Color of Materials Sand, Clay, Red Clay, Shell, etc.	Thick- ness Feet	Depth Feet
(1) Owner of Land: <u>STAN HAYES</u> (Name) <u>Shannon, Miss</u> (Address)	surface sand & clay		0
(2) Location: $\frac{1}{4}$, $\frac{1}{4}$, Sec 13 T 11 S R 2 E _____ miles _____, of <u>Shannon</u> (distance) (direction) (Nearest Town)	shale sand	20 8	240
(3) Topography: <u>Flat</u> (Hilly) (Flat) (Level)	Bottom		360
(4) Purpose of Well: <u>Domestic</u> (Domestic Irrigation Municipal, Industrial, Other)	green water		

Information upon completion of well:

- (1) Diameter 4 inches.
 - (2) Total Depth 360 feet.
 - (3) Water Level 60 feet below top of ground.
 - (4) Cased to 22' 10", Size 4".
 - (5) Screen: Size _____, Length _____.
 - (6) Were any formations sealed against pollution?
 yes, no.
- If YES depth of formation 20 ft
- Why surface sand
- Drillers Remarks: _____

245 ELEV 260

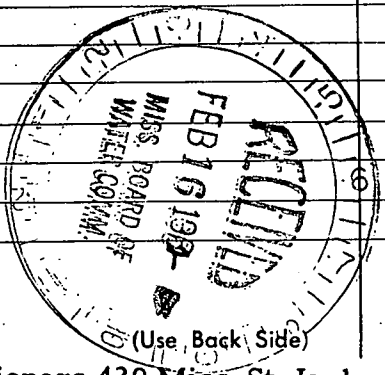

Well No.

Mail this copy to Board of Water Commissioners 429 Miss. St. Jackson, Miss

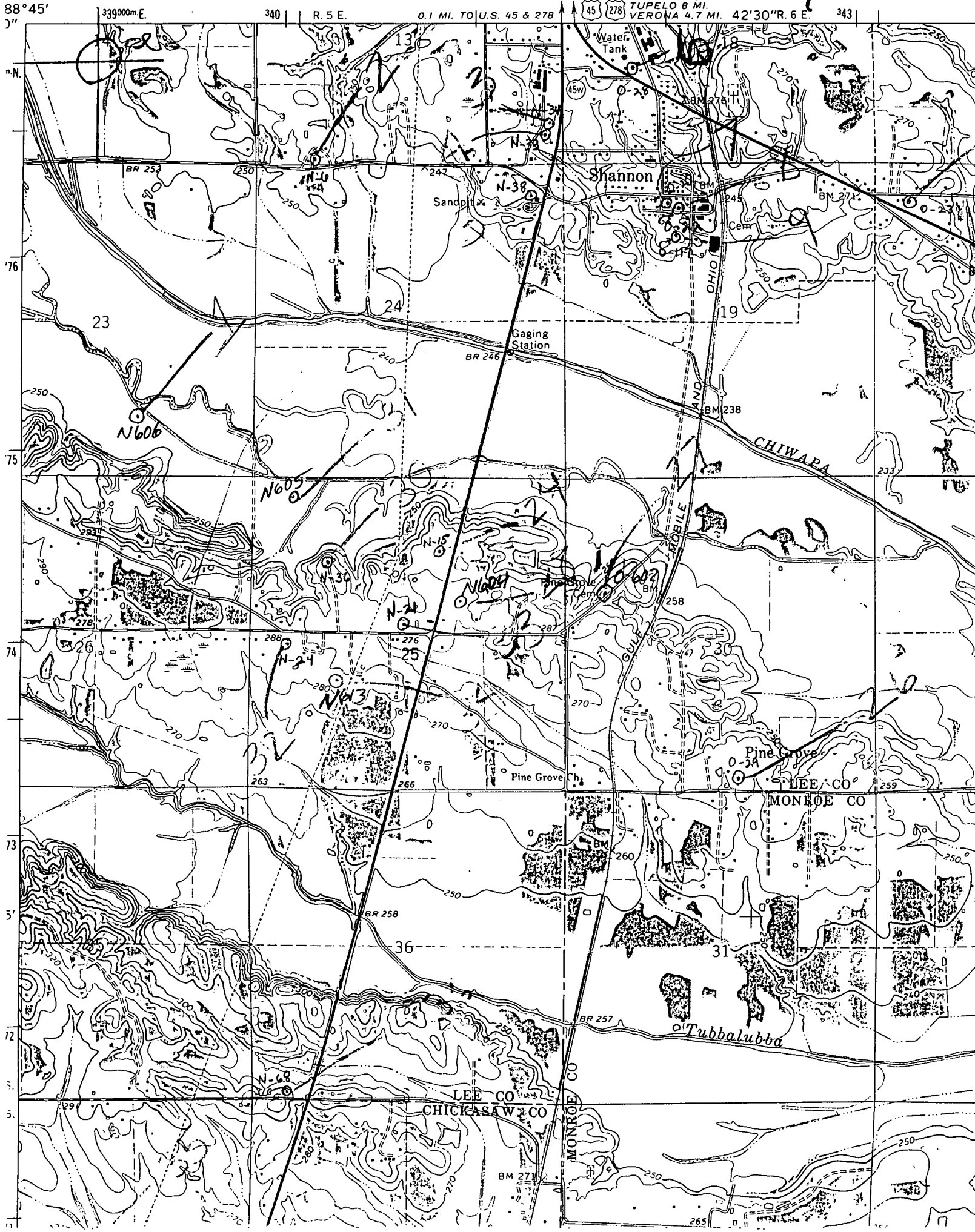

88° 45'
88° 5'
88° 0'

339000m.E.
340 | R. 5 E. | 0.1 MI. TO U.S. 45 & 278 | 45 | 278 | TUPELO 8 MI. | VERONA 4.7 MI. | 42° 30' R. 6 E. | 343

Water Tank
Shannon
Sandpit
Gaging Station
BR 252
BR 246
BR 258
BR 257
CHIWAPA
MOBILE
GULF
Pine Grove
Tubbalubba
LEE CO
MONROE CO
CHICKASAW CO

13
19
23
24
25
26
28
31
36

N-38
N-34
N-30
N-24
N-20
N-15
N-10
N-6
N-606
N-605
N-604
N-603
N-602
N-601
N-600
N-599
N-598
N-597
N-596
N-595
N-594
N-593
N-592
N-591
N-590
N-589
N-588
N-587
N-586
N-585
N-584
N-583
N-582
N-581
N-580
N-579
N-578
N-577
N-576
N-575
N-574
N-573
N-572
N-571
N-570
N-569
N-568
N-567
N-566
N-565
N-564
N-563
N-562
N-561
N-560
N-559
N-558
N-557
N-556
N-555
N-554
N-553
N-552
N-551
N-550
N-549
N-548
N-547
N-546
N-545
N-544
N-543
N-542
N-541
N-540
N-539
N-538
N-537
N-536
N-535
N-534
N-533
N-532
N-531
N-530
N-529
N-528
N-527
N-526
N-525
N-524
N-523
N-522
N-521
N-520
N-519
N-518
N-517
N-516
N-515
N-514
N-513
N-512
N-511
N-510
N-509
N-508
N-507
N-506
N-505
N-504
N-503
N-502
N-501
N-500
N-499
N-498
N-497
N-496
N-495
N-494
N-493
N-492
N-491
N-490
N-489
N-488
N-487
N-486
N-485
N-484
N-483
N-482
N-481
N-480
N-479
N-478
N-477
N-476
N-475
N-474
N-473
N-472
N-471
N-470
N-469
N-468
N-467
N-466
N-465
N-464
N-463
N-462
N-461
N-460
N-459
N-458
N-457
N-456
N-455
N-454
N-453
N-452
N-451
N-450
N-449
N-448
N-447
N-446
N-445
N-444
N-443
N-442
N-441
N-440
N-439
N-438
N-437
N-436
N-435
N-434
N-433
N-432
N-431
N-430
N-429
N-428
N-427
N-426
N-425
N-424
N-423
N-422
N-421
N-420
N-419
N-418
N-417
N-416
N-415
N-414
N-413
N-412
N-411
N-410
N-409
N-408
N-407
N-406
N-405
N-404
N-403
N-402
N-401
N-400
N-399
N-398
N-397
N-396
N-395
N-394
N-393
N-392
N-391
N-390
N-389
N-388
N-387
N-386
N-385
N-384
N-383
N-382
N-381
N-380
N-379
N-378
N-377
N-376
N-375
N-374
N-373
N-372
N-371
N-370
N-369
N-368
N-367
N-366
N-365
N-364
N-363
N-362
N-361
N-360
N-359
N-358
N-357
N-356
N-355
N-354
N-353
N-352
N-351
N-350
N-349
N-348
N-347
N-346
N-345
N-344
N-343
N-342
N-341
N-340
N-339
N-338
N-337
N-336
N-335
N-334
N-333
N-332
N-331
N-330
N-329
N-328
N-327
N-326
N-325
N-324
N-323
N-322
N-321
N-320
N-319
N-318
N-317
N-316
N-315
N-314
N-313
N-312
N-311
N-310
N-309
N-308
N-307
N-306
N-305
N-304
N-303
N-302
N-301
N-300
N-299
N-298
N-297
N-296
N-295
N-294
N-293
N-292
N-291
N-290
N-289
N-288
N-287
N-286
N-285
N-284
N-283
N-282
N-281
N-280
N-279
N-278
N-277
N-276
N-275
N-274
N-273
N-272
N-271
N-270
N-269
N-268
N-267
N-266
N-265
N-264
N-263
N-262
N-261
N-260
N-259
N-258
N-257
N-256
N-255
N-254
N-253
N-252
N-251
N-250
N-249
N-248
N-247
N-246
N-245
N-244
N-243
N-242
N-241
N-240
N-239
N-238
N-237
N-236
N-235
N-234
N-233
N-232
N-231
N-230
N-229
N-228
N-227
N-226
N-225
N-224
N-223
N-222
N-221
N-220
N-219
N-218
N-217
N-216
N-215
N-214
N-213
N-212
N-211
N-210
N-209
N-208
N-207
N-206
N-205
N-204
N-203
N-202
N-201
N-200
N-199
N-198
N-197
N-196
N-195
N-194
N-193
N-192
N-191
N-190
N-189
N-188
N-187
N-186
N-185
N-184
N-183
N-182
N-181
N-180
N-179
N-178
N-177
N-176
N-175
N-174
N-173
N-172
N-171
N-170
N-169
N-168
N-167
N-166
N-165
N-164
N-163
N-162
N-161
N-160
N-159
N-158
N-157
N-156
N-155
N-154
N-153
N-152
N-151
N-150
N-149
N-148
N-147
N-146
N-145
N-144
N-143
N-142
N-141
N-140
N-139
N-138
N-137
N-136
N-135
N-134
N-133
N-132
N-131
N-130
N-129
N-128
N-127
N-126
N-125
N-124
N-123
N-122
N-121
N-120
N-119
N-118
N-117
N-116
N-115
N-114
N-113
N-112
N-111
N-110
N-109
N-108
N-107
N-106
N-105
N-104
N-103
N-102
N-101
N-100
N-99
N-98
N-97
N-96
N-95
N-94
N-93
N-92
N-91
N-90
N-89
N-88
N-87
N-86
N-85
N-84
N-83
N-82
N-81
N-80
N-79
N-78
N-77
N-76
N-75
N-74
N-73
N-72
N-71
N-70
N-69
N-68
N-67
N-66
N-65
N-64
N-63
N-62
N-61
N-60
N-59
N-58
N-57
N-56
N-55
N-54
N-53
N-52
N-51
N-50
N-49
N-48
N-47
N-46
N-45
N-44
N-43
N-42
N-41
N-40
N-39
N-38
N-37
N-36
N-35
N-34
N-33
N-32
N-31
N-30
N-29
N-28
N-27
N-26
N-25
N-24
N-23
N-22
N-21
N-20
N-19
N-18
N-17
N-16
N-15
N-14
N-13
N-12
N-11
N-10
N-9
N-8
N-7
N-6
N-5
N-4
N-3
N-2
N-1