

WRD Exp. (GW)
April 1966

Well No. N 24

WELL SCHEDULE

U. S. DEPT. OF THE INTERIOR GEOLOGICAL SURVEY WATER RESOURCES DIVISION

MASTER CARD

Record by _____ Source of data _____ Date 2/27/67 Map _____

State _____ County _____ (or town) _____

Latitude: 34° 05' 48" N Longitude: 083° 44' 06" W Sequential number: 1

Lat-long accuracy: 1' T. 11 R. 5 Sec. 25 NE NW SW

Local well number: N 0 2 4 B C 2 5 1 1 5 0 5 E Other number: _____

Local use: _____ Owner or name: _____

Owner or name: ANNIE B. JONES Address: _____

Ownership: County, Fed Gov't, City, Corp or Co, Private, State Agency, Water Dist _____

Use of water: (A) Air cond, (B) Bottling, (C) Comm, (D) Dewater, (E) Power, (F) Fire, (G) Dom, (H) Irr, (I) Med, (J) P S, (K) Rec, (L) Stock, (M) Instit, (N) Unused, (O) Reppure, (P) Recharge, (Q) Desal-P S, (R) Desal-other, (S) Other _____

Use of well: (A) Anode, (B) Drain, (C) Seismic, (D) Heat Res, (E) Obs, (F) Oil-gas, (G) Recharge, (H) Test, (I) Unused, (J) Withdraw, (K) Waste, (L) Destroyed _____

DATA AVAILABLE: Well data Freq. W/L meas.: Field aquifer char.

Hvd. lab. data: _____

Qual. water data; type: _____

Freq. sampling: _____ Pumpage inventory: no, period: _____

Aperture cards: _____

Log data: _____

WELL-DESCRIPTION CARD

SAME AS ON MASTER CARD Depth well: _____ ft Meas. _____ accuracy _____

Depth cased: _____ ft Casing type: _____; Diam. _____ in

Finish: porous gravel w. gravel w. horiz. open perf., screen, sd. pt., shored, open concrete, (perf.), (screen), gallery, end, other _____

Method: (A) air bored, (B) cable, (C) dug, (D) hyd jetted, (E) air rot., (F) reverse, (G) trenching, (H) driven, (I) drive wash, (J) other _____

Date Drilled: 4-6-64 Pump intake setting: _____ ft

Driller: _____ name _____ address _____

Lift (type): (A) air, (B) bucket, (C) cent, (D) jet, (E) multiple, (F) multiple, (G) none, (H) piston, (I) rot, (J) submerg, (K) turb, (L) other _____ Deep _____ Shallow _____

Power (type): diesel, elec, gas, gasoline, hand, gas, wind; H.P. _____ Trans. or meter no. _____

Descrip. MP _____ ft above below LSD. Alt. MP _____

Alt. LSD: _____ Accuracy: _____

Water Level _____ ft above below MP; Ft below LSD _____ Accuracy: _____

Date meas: JUNE '64 Yield: _____ gpm Method determined _____

Drawdown: _____ ft Accuracy: _____ Pumping period _____ hrs

QUALITY OF WATER DATA: Iron _____ ppm Sulfate _____ ppm Chloride _____ ppm Hard. _____ ppm

Sp. Conduct _____ K x 10⁶ Temp. _____ °F Date sampled _____

i.e., color, etc.

TRANSMITTED FOR ADP

Well No.

24

Well No. N 24

Latitude-longitude N
S
d m s d m s

HYDROGEOLOGIC CARD

SAME AS ON MASTER CARD Physiographic Province: 2 2 Section: _____

1 Drainage Basin: 1 3 1 C Subbasin: _____

22 (D) (C) (E) (F) (H) (K) (L) depression, stream channel, dunes, flat, hilltop, sink, swamp, well site: (O) (P) (S) (T) (U) (V) offshore, pediment, hillside, terrace, undulating, valley flat 27 7

MAJOR AQUIFER: _____ system _____ series K 2 _____ aquifer, formation, group 28 29 _____ 30 31 **Aquifer Thickness:** _____ ft

Lithology: _____ 32 33 **Origin:** _____ 34 **Length of well open to:** _____ ft **Depth to top of:** _____ ft 35 36 37 38 39

MINOR AQUIFER: _____ system _____ series _____ aquifer, formation, group _____ 40 41 **Aquifer Thickness:** _____ ft

Lithology: _____ 42 43 **Origin:** _____ 44 **Length of well open to:** _____ ft **Depth to top of:** _____ ft 45 46 47 48 49 50 51 52 53

Intervals Screened: _____

Depth to consolidated rock: _____ ft 54 55 **Source of data:** _____ 56

Depth to basement: _____ ft 57 58 **Source of data:** _____ 59

Surficial material: _____ 60 61 **Infiltration characteristics:** _____ 62

Coefficient Trans: _____ gpd/ft 63 64 **Coefficient Storage:** _____ 65 66

Coefficient Perm: _____ gpd/ft²; Spec cap: _____ gpm/ft; Number of geologic cards: _____ 67 68 69 70 71 72 73 74 75 76 77 78 79

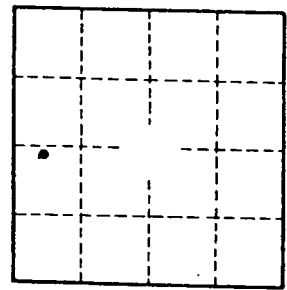
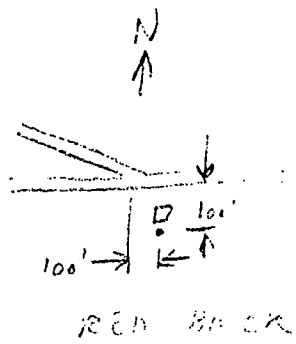

Well No.

11
24

LEE

MISSISSIPPI BOARD OF WATER COMMISSIONERS

N 24

6-1-64

WATER WELL DRILLERS LOG

HERNDON WELL & SUPPLY CO.

Date: 6-1, 1964, Driller: P. O. BOX 42, County Lee, SHANNON, MISSISSIPPI

	Description & Color of Materials Sand, Clay, Red Clay, Shell, etc.	Thick- ness Feet	Depth Feet
(1) Owner of Land: <u>Ann B. White</u> (Name) <u>At 1 Shannon, Miss.</u> (Address)	<u>surface sand</u> <u>and clay</u>		<u>0</u>
(2) Location: <u>25 1/2</u> Sec. <u>T 8 R 5 E</u> <u>2</u> miles <u>SW</u> of <u>Thomas</u> (distance) (direction) (Nearest Town)	<u>Blue rock</u>		<u>20</u>
(3) Topography: <u>Flat</u> (Hilly) (Flat) (Level)	<u>Good</u>		<u>250</u>
(4) Purpose of Well: <u>Domestic</u> (Domestic Irrigation Municipal, Industrial, Other)			

Information upon completion of well:

- (1) Diameter 4 inches.
- (2) Total Depth 400 feet.
- (3) Water Level 80 feet below top of ground.
- (4) Cased to 23', Size 4"
- (5) Screen: Size —, Length —
- (6) Were any formations sealed against pollution?
 yes, no.

If YES depth of formation 20'
Why Surface & sand
Drillers Remarks:

255 ELE 23'

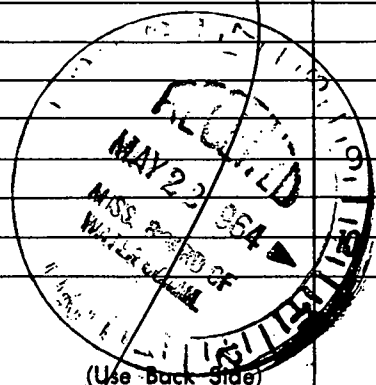

Well No.

Mail this copy to Board of Water Commissioners 429 Miss. St. Jackson, Miss.

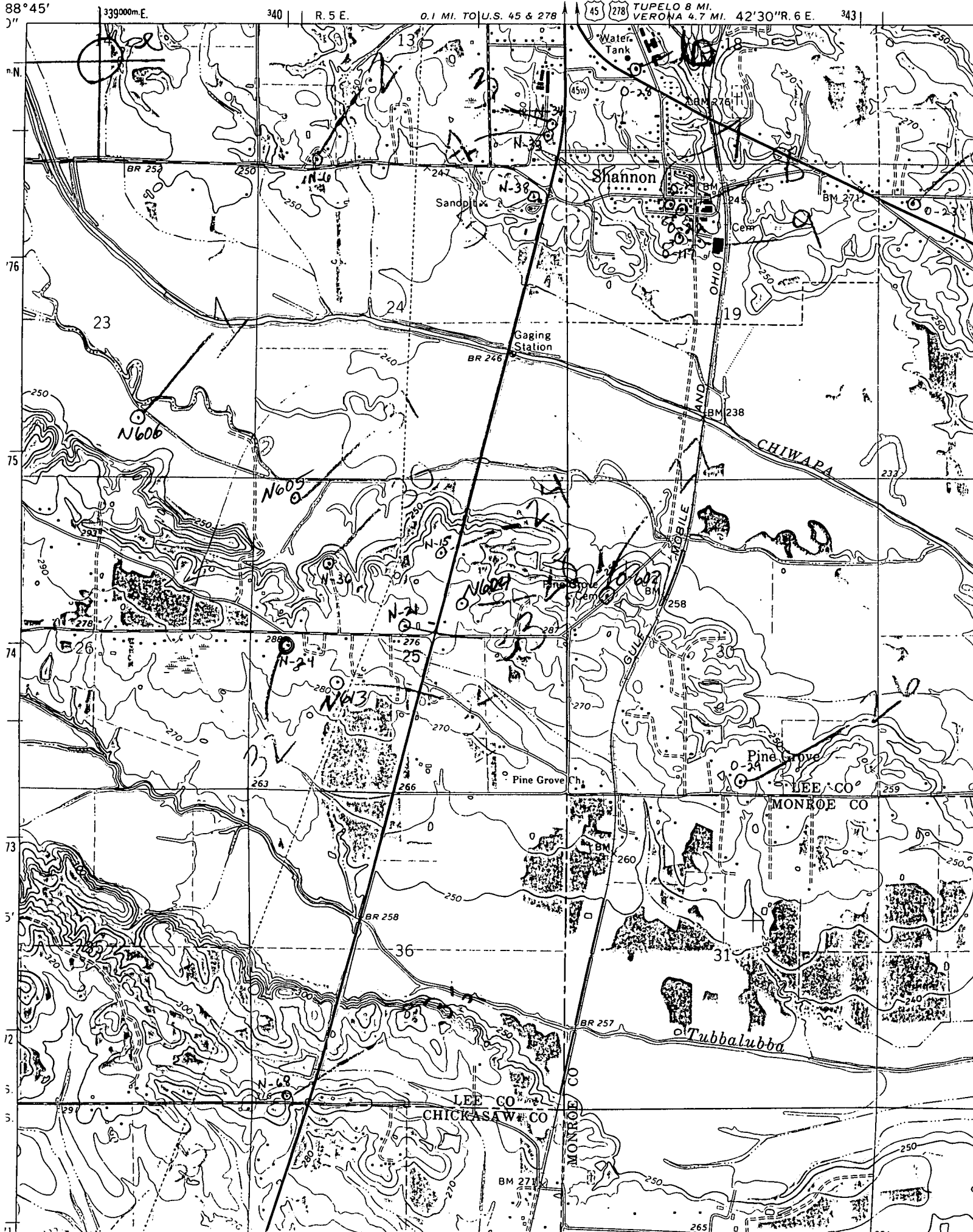

88° 45'
78° 45'
76
75
74
73
5'
12
5'
5'

339000m. E. 340 R. 5 E. 0.1 MI. TO U.S. 45 & 278 45 278 TUPELO 8 MI. VERONA 4.7 MI. 42° 30' R. 6 E. 343

Water Tank
Shannon
Sandpit
Gaging Station
CHIWAPA
Pine Grove
Tubbalubba

BR 252
BR 246
BR 258
BR 257

N-38
N-36
N-34
N-32
N-30
N-28
N-26
N-24
N-22
N-20
N-18
N-16
N-14
N-12
N-10
N-8
N-6
N-4
N-2

LEE CO
CHICKASAW CO
MONROE CO

BM 276
BM 277
BM 278
BM 279
BM 280
BM 281
BM 282
BM 283
BM 284
BM 285
BM 286
BM 287
BM 288
BM 289
BM 290
BM 291
BM 292
BM 293
BM 294
BM 295
BM 296
BM 297
BM 298
BM 299
BM 300