

WD-200 (Rev.)  
April 1-66

Well No. N15

WELL SCHEDULE

E Log 32

U. S. DEPT. OF THE INTERIOR GEOLOGICAL SURVEY WATER RESOURCES DIVISION

(BOG N2)

MASTER CARD

Record by B.E. Williams Source of data E-Log, L. McC. date 12/8/66 Map Nettleton SW

State Miss. County Lee (or town) Lee Sequential number: 1

Latitude: 34° 06' 07" N Longitude: 088° 43' 35" W

Lat-long accuracy: 1 T 11 S R 5 Sec 25 SE SW NE

Local well number: N0156A2511S05E Other number: B & M

Local use: \_\_\_\_\_ Owner or name: Jack Ivey

Owner or name: JACK IVEY Address: \_\_\_\_\_

Ownership: County, Fed Gov't, City, Corp or Co, Private, State Agency, Water Dist P

Use of water: (A) Air cond, Bottling, Comm, Dewater, Power, Fire, Dom, Irr, Med, Ind, P S, Rec, (S) (T) (U) (V) (W) (X) (Y) (Z) H

Use of well: (A) Anode, Drain, Seismic, Heat Res, Obs, Oil-gas, Recharge, Test, Unused, Withdraw, Waste, Destroyed. (S) (T) (U) (V) (W) (X) (Z) W

DATA AVAILABLE: Well data 70 Freq. W/L meas.: 71 Field aquifer char. 72

Hyd. lab. data: \_\_\_\_\_ 73

Qual. water data: type: \_\_\_\_\_ 74

Freq. sampling: \_\_\_\_\_ Pumpage inventory: 75 yes no period: \_\_\_\_\_ 76

Aperture cards: \_\_\_\_\_ yes 77

Log data: E-Log 84-244 78 79

WELL-DESCRIPTION CARD

SAME AS ON MASTER CARD Depth well: 414 ft 414 Meas. 24 1

Depth cased: 42 ft 42 Casing type: Steel ; Diam. 4 in 29 30

Finish: porous concrete, gravel w. (perfl.), gravel w. (screen), horz. open perfor., screen, sd. pt., shored, open hole, other 31

Method: (A) drilled, (B) air bored, (C) cable, (D) dug, (H) rot., (J) air rot., (P) percussive, (R) rotary, (T) air reverse, (V) trenching, (W) driven, (X) wash, other 32

Date Drilled: 12/8/66 9:6:6 Pump intake setting: \_\_\_\_\_ ft 36 38

Driller: Hendon-Homan Drilling Co Shannon

Lift (type): (A) air, (B) bucket, (C) cent, (J) jet, (L) multiple, (M) multiple, (N) none, (P) piston, (R) rot, (S) submerg, (T) turb, other 39 Deep 5 Shallow D 40

Power (type): diesel, elec, gas, gasoline, hand, gas, wind; H.P. \_\_\_\_\_ Trans. or meter no. \_\_\_\_\_

Descrip. MP TOP of casing - 1 ft 41 above 42 below LSD; Alt. MP 281

Alt. LSD: 280 280 Accuracy: to pm 10 47 4

Water Level: 85 ft above 85 below MP; Ft above 84 below LSD Accuracy: mean 52 17

Date meas: 12/8/66 D.6.6 Yield: \_\_\_\_\_ gpm 53 55 Method determined 61

Drawdown: \_\_\_\_\_ ft 62 Accuracy: \_\_\_\_\_ 63 Pumping period \_\_\_\_\_ hrs 64 68

QUALITY OF WATER DATA: Iron \_\_\_\_\_ ppm 69 Sulfate \_\_\_\_\_ ppm 70 Chloride \_\_\_\_\_ ppm 71 Hard. \_\_\_\_\_ ppm 72

Sp. Conduct 400 K x 10<sup>6</sup> \_\_\_\_\_ 73 Temp. \_\_\_\_\_ °F 74 78 Date sampled \_\_\_\_\_ 77 79

Taste, color, etc.

TRANSMITTED FOR ADP

Well No.

Water Level Data  
11/17/82  
WL = 139?  
1987  
WL = 144.26

5/20/1991  
Questionable  
cud - well  
not cased  
stem check  
Held 165.00  
Cud 13.23  
151.77  
M.D. 1.10  
150.47

10/1/98  
WL = 128.00

Well No. N 15

Latitude-longitude \_\_\_\_\_  
 d m s S d m s

**HYDROGEOLOGIC CARD**

**Physiographic Province:** 03 **Section:** \_\_\_\_\_

**Drainage Basin:** D **Subbasin:** 13C

**Topo of well site:** (D) depression, (C) stream channel, (E) dunes, (F) flat, (H) hilltop, (K) sink, (L) swamp, (S) offshore, (P) pediment, (S) hillside, (T) terrace, (U) undulating, (V) valley flat H

**MAJOR AQUIFER:** system \_\_\_\_\_ series K3 aquifer, formation, group EUV

**Lithology:** fine sand **Origin:** 6 **Aquifer Thickness:** \_\_\_\_\_ ft

**Length of well open to:** 173 ft **Depth to top of:** 2.40 ft

**MINOR AQUIFER:** system \_\_\_\_\_ series \_\_\_\_\_ aquifer, formation, group \_\_\_\_\_

**Lithology:** \_\_\_\_\_ **Origin:** \_\_\_\_\_ **Aquifer Thickness:** \_\_\_\_\_ ft

**Length of well open to:** \_\_\_\_\_ ft **Depth to top of:** \_\_\_\_\_ ft

**Intervals Screened:** OPEN Hole

**Depth to consolidated rock:** \_\_\_\_\_ ft **Source of data:** \_\_\_\_\_

**Depth to basement:** \_\_\_\_\_ ft **Source of data:** \_\_\_\_\_

**Surficial material:** \_\_\_\_\_ **Infiltration characteristics:** \_\_\_\_\_

**Coefficient Trans:** \_\_\_\_\_ gpd/ft **Coefficient Storage:** \_\_\_\_\_

**Coefficient Perm:** \_\_\_\_\_ gpd/ft; **Spec cap:** \_\_\_\_\_ **gpm/ft; Number of geologic cards:** \_\_\_\_\_

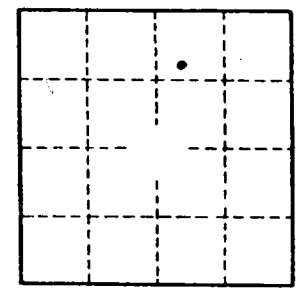
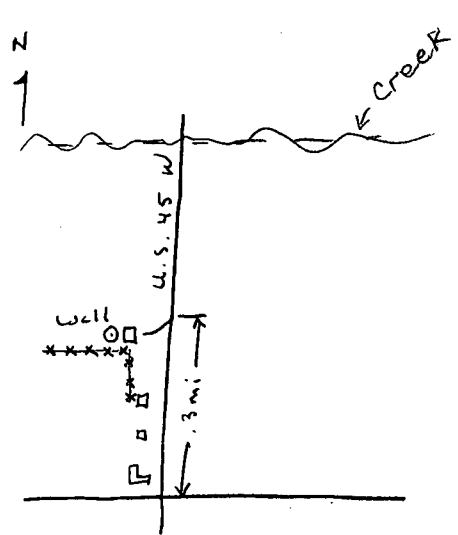

Well No. N 15

These holes to the south

FRICE

TOP of HILL →

2 mi

U.S. 45 W

Hand-drawn sketch of a well layout with arrows and labels.

