

9-185
(October 1950)

2

UNITED STATES
DEPARTMENT OF THE INTERIOR
GEOLOGICAL SURVEY
WATER RESOURCES DIVISION

WELL SCHEDULE

Date AUG. 31, 19 56 Field No. 85
Record by SHAW-SHIT Office No. W6
Source of data Mrs. L. L. HOOD

1. Location: State MISS County LEE
Map LEE CO. HIGHWAY

SE SW 1/4 SW 1/4 sec. 13 T 11 N 5 R 5 E

2. Owner: Mrs. L. L. HOOD Address SHANNON, MS

Tenant AN PLACE Address _____

Driller W. J. FEIKINGS Address SHANNON, MS

3. Topography MARK HILL SIDE

4. Elevation 250+ ft. above TOP. below _____

5. Type: Dug, drilled, driven, bored, jetted _____ 19 14

6. Depth: Rept. HOOD ft. Meas. _____ ft.

7. Casing: Diam. 4 in., to _____ in., Type _____

Depth _____ ft., Finish _____

8. Chief Aquifer Ke From _____ ft. to _____ ft.

Others _____

9. Water level 40 ft. rept. meas. 19 56 above below surface

which is _____ ft. above _____ ft. below surface

10. Pump: Type CLINDER Capacity _____ G. M.

Power: Kind ELEC. Horsepower 1

11. Yield: Flow _____ G. M., Pump _____ G. M., Meas., Rept. Est.

Drawdown _____ ft. after _____ hours pumping _____ G. M.

12. Use: Dom., Stock, PS., RR., Ind., Irr., Obs. _____

Adequacy, permanence _____

13. Quality _____ Temp _____ °F.

Taste, odor, color _____ Sample Yes No

Unfit for _____

14. Remarks: (Log, Analyses, etc.) Well in this area
at one time years ago were
over flow

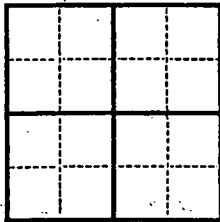

14. Name: (Last, first, middle initial) **A**

15. Address: **N**

16. City: **Washington**

17. State: **D.C.**

18. Zip: **20540**

19. Telephone: **202-541-5111**

20. Date of birth: **3.7**

21. Sex: **M**

22. Race: **White**

23. Education: **High School**

24. Occupation: **Student**

25. Date of entry: **18**

26. Date of departure: **5/1/68**

27. Name of ship: **USS ...**

28. Name of vessel: **USS ...**

29. Name of aircraft: **USS ...**

30. Name of motor vehicle: **USS ...**

31. Name of other conveyance: **USS ...**

32. Name of other conveyance: **USS ...**

33. Name of other conveyance: **USS ...**

34. Name of other conveyance: **USS ...**

35. Name of other conveyance: **USS ...**

36. Name of other conveyance: **USS ...**

37. Name of other conveyance: **USS ...**

38. Name of other conveyance: **USS ...**

39. Name of other conveyance: **USS ...**

40. Name of other conveyance: **USS ...**

41. Date of entry: **18**

42. Date of departure: **5/1/68**

43. Name of ship: **USS ...**

44. Name of vessel: **USS ...**

45. Name of aircraft: **USS ...**

46. Name of motor vehicle: **USS ...**

47. Name of other conveyance: **USS ...**

48. Name of other conveyance: **USS ...**

49. Name of other conveyance: **USS ...**

50. Name of other conveyance: **USS ...**

51. Name of other conveyance: **USS ...**

52. Name of other conveyance: **USS ...**

53. Name of other conveyance: **USS ...**

54. Name of other conveyance: **USS ...**

55. Name of other conveyance: **USS ...**

56. Name of other conveyance: **USS ...**

57. Name of other conveyance: **USS ...**

58. Name of other conveyance: **USS ...**

59. Name of other conveyance: **USS ...**

60. Name of other conveyance: **USS ...**

WATER RESOURCES DIVISION
 DEPARTMENT OF THE INTERIOR
 UNITED STATES

October 1967

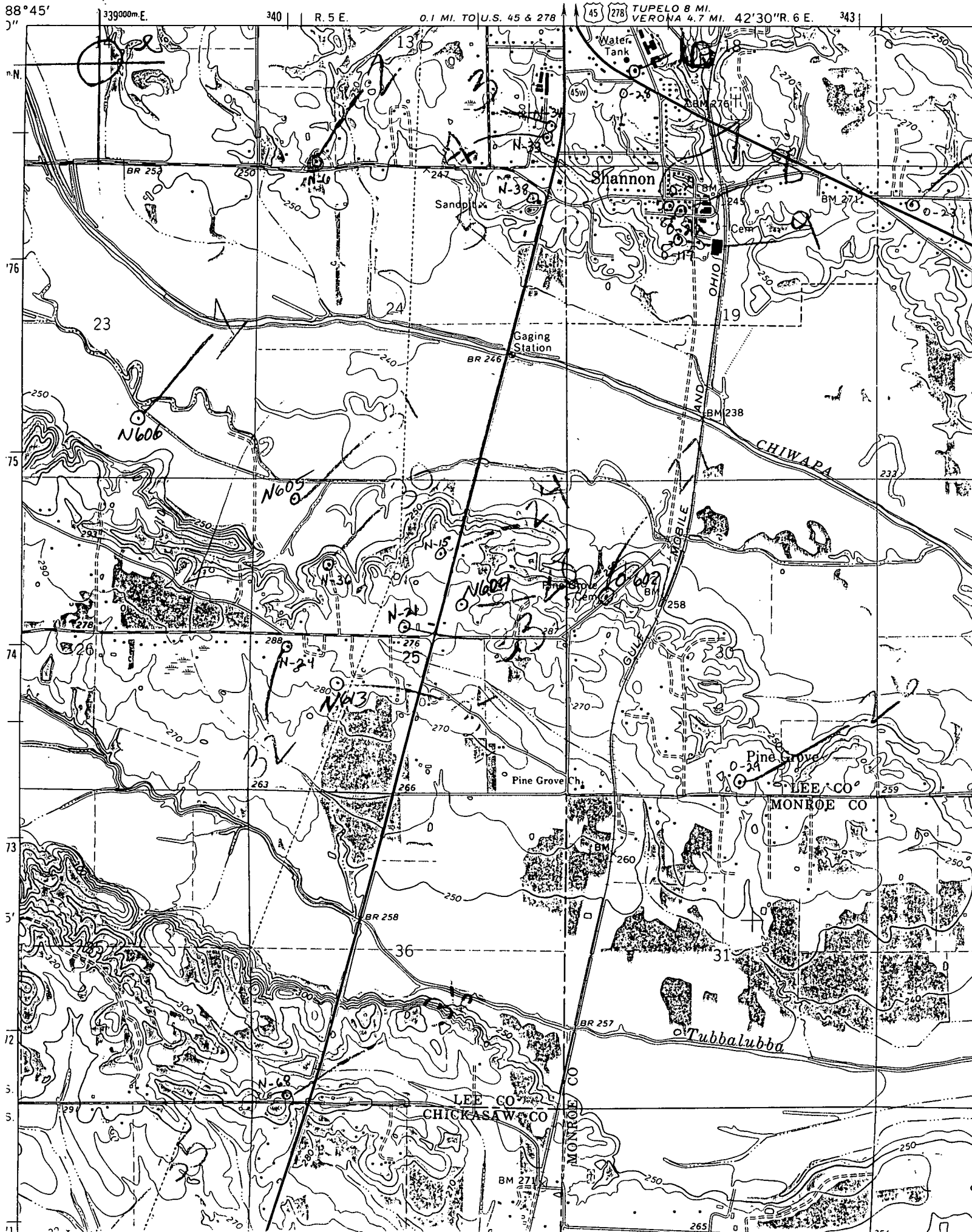

88° 45'
 78
 76
 75
 74
 73
 72
 5
 5
 11

339000m E. 340 R. 5 E. 0.1 MI. TO U.S. 45 & 278 45 278 TUPELO 8 MI. VERONA 4.7 MI. 42° 30' R. 6 E. 343

Water Tank
 Sandpit
 Gaging Station
 Pine Grove Ch.
 Tubbalubba

BR 253
 BR 246
 BR 258
 BR 257

N-36
 N-34
 N-30
 N-24
 N-21
 N-15
 N-11
 N-08
 N-06
 N-05
 N-04
 N-03
 N-02
 N-01
 N-68

23 24 25 26 28 31 36

250 270 280 300

LEE CO
 CHICKASAW CO
 MONROE CO

SHANNON
 Pine Grove
 Tubbalubba

OHIO
 MOBILE
 GULF
 CHIWAPA

BM 276
 BM 277
 BM 238
 BM 258
 BM 260
 BM 271

265