

GW64b  
0410011-02

Verona

FORM 9-1642  
(1-68)

Well No. L100

WELL SCHEDULE

E Log #67

U. S. DEPT. OF THE INTERIOR

GEOLOGICAL SURVEY

WATER RESOURCES DIVISION

MASTER CARD

Record by WTO Source of data Bowc Date 5/73 Map Verona  
 State MISS County LEE 28  
 Latitude: 341228 N Longitude: 0883951 Sequential number: 1  
 Lat-long accuracy: 2 T 10 S R 6 Sec 15 N SE t, SW t, SW t  
 Local well number: L1000C1510506E Other number: Well #2  
 Local use: 027067 Owner or name: PLANTERSVILLE Address: \_\_\_\_\_

Ownership: County; Fed Gov't, City, Corp or Co, Private, State Agency, Water Dist M  
 Use of water: (A) Air cond, Bottling, Comm, Dewater, Power, Fire, Dom, Irr, Med, Ind, P S, Rec, (S) Stock, Instit, Unused, Repressure, Recharge, Desal-P S, Desal-other, Other MU P  
 Use of well: (A) Anode, Drain, Seismic, Heat Res, Obs, Oil-gas, Recharge, Test, Unused, Withdraw, Waste, Destroyed. W

DATA AVAILABLE: Well data  Freq. W/L meas.:  Field aquifer char.   
 Hyd. lab. data:   
 Qual. water data; type:   
 Freq. sampling:  Pumpage inventory:  yes no period:   
 Aperture cards:  yes   
 Log data: E Log 10' - 416' EUTW DE

WELL-DESCRIPTION CARD

SAME AS ON MASTER CARD Depth well: 380 ft Meas. rept 3  
 Depth cased; (first perf.) 320 ft Casing type: \_\_\_\_\_; Diam. 10 X 6 in 10  
 Finish: (C) concrete, (F) porous gravel w. (perfor.), (G) gravel w. (screen), (H) horiz. gallery, end, (I) open perf., (J) screen, (K) ad. pt., (L) shored, (M) open hole, (N) other S  
 Method Drilled: (A) air rot., (B) bored, (C) cable, (D) dug, (E) hyd jetted, (F) air rot., (G) percussion, (H) rotary, (I) reverse, (J) trenching, (K) driven, (L) drive wash, (M) other H  
 Date Drilled: 1-16-73 973 Pump intake setting: \_\_\_\_\_ ft \_\_\_\_\_  
 Driller: WEBB BELDON  
 Lift (type): (A) air, (B) bucket, (C) cent., (D) jet, (E) multiple, (F) turb., (G) none, (H) piston, (I) rot., (J) submerg, (K) turb., (L) other T Deep  Shallow   
 Power (type): (A) diesel, (B) elec, (C) gas, (D) gasoline, (E) hand, (F) gas, (G) wind, (H) H.P. 25  Trans. or meter no. \_\_\_\_\_  
 Descrip. MP \_\_\_\_\_ ft above below LSD, Alt. MP \_\_\_\_\_  
 Alt. LSD: 275 Accuracy: (source) topo 2  
 Water Level \_\_\_\_\_ ft above below MP; \_\_\_\_\_ ft above below LSD Accuracy: \_\_\_\_\_ D  
 Date meas: 3/12/73 273 Yield: \_\_\_\_\_ gpm 160 Method determined \_\_\_\_\_  
 Drawdown: \_\_\_\_\_ ft 48 Accuracy: \_\_\_\_\_ Pumping period \_\_\_\_\_ hrs 24  
 QUALITY OF WATER DATA: Iron \_\_\_\_\_ ppm Sulfate \_\_\_\_\_ ppm Chloride \_\_\_\_\_ ppm Hard. \_\_\_\_\_ ppm  
 Sp. Conduct \_\_\_\_\_ K x 10<sup>6</sup> Temp. \_\_\_\_\_ °F Date sampled \_\_\_\_\_  
 Taste, color, etc. \_\_\_\_\_

Well No.

Well No. \_\_\_\_\_

Latitude-longitude \_\_\_\_\_  
d m s N S d m s

**HYDROGEOLOGIC CARD**

**SAME AS ON MASTER CARD** Physiographic Province: \_\_\_\_\_ Section: 03

D Drainage Basin: \_\_\_\_\_ Subbasin: \_\_\_\_\_

Topo of well site: (D) depression, stream channel, dunes, flat, hilltop, sink, swamp, (P) offshore, pediment, hillside, terrace, undulating, valley flat

MAJOR AQUIFER: system \_\_\_\_\_ series K3 aquifer, formation, group EZ MS

Lithology: Med. sd. Origin: 3 Aquifer Thickness: 50 ft

Length of well open to: \_\_\_\_\_ ft Depth to top of: 330 ft

MINOR AQUIFER: system \_\_\_\_\_ series \_\_\_\_\_ aquifer, formation, group \_\_\_\_\_

Lithology: \_\_\_\_\_ Origin: \_\_\_\_\_ Aquifer Thickness: \_\_\_\_\_ ft

Length of well open to: \_\_\_\_\_ ft Depth to top of: \_\_\_\_\_ ft

Intervals Screened: \_\_\_\_\_

Depth to consolidated rock: \_\_\_\_\_ ft Source of data: \_\_\_\_\_

Depth to basement: \_\_\_\_\_ ft Source of data: \_\_\_\_\_

Surficial material: \_\_\_\_\_ Infiltration characteristics: \_\_\_\_\_

Coefficient Trans: \_\_\_\_\_ gpd/ft Coefficient Storage: \_\_\_\_\_

Coefficient Perm: \_\_\_\_\_ gpd/ft; Spec cap: \_\_\_\_\_ gpm/ft; Number of geologic cards: \_\_\_\_\_

Tupelo Hwy 78

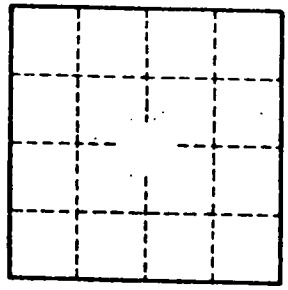
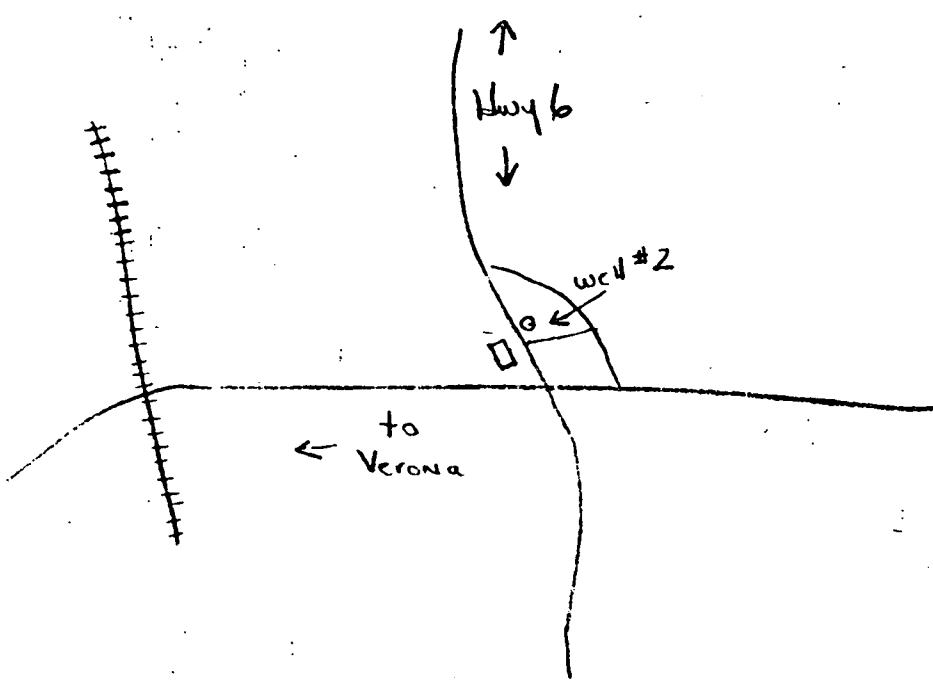

C.C.K.C.  
Eggs, Tupelo, Miss.

Well No. \_\_\_\_\_

LEE

L 100

3-12-73

E log # 67

CODED

MISSISSIPPI BOARD OF WATER COMMISSIONERS

WATER WELL DRILLERS LOG

Date: MAR 12, 1973, Driller: J. W. WEBB & SONS County LEE  
(When well drilled) (Name) (Where well is located)

		Description & Color of Materials Sand, Clay, Red Clay, Shell, etc.	Thick- ness Feet	Depth Feet
(1) Owner of Land: TOWN OF PLANTERSVILLE (Name)		CLAY & SAND	0	20
PLANTERSVILLE, MISS (Address)		BLUE MARL	20	165
		SAND & BLUE MARL	165	220
(2) Location: 1/4, 1/4, Sec. 15 T10R6E 15		SAND	220	285
miles of (distance) (direction) (Nearest Town)		SAND & BLUE MARL	285	330
		SAND	330	385
(3) Topography: (Hilly) (Flat) (Level)				
(4) Purpose of Well: MUNICIPAL (Domestic Irrigation Municipal, Industrial, Other)				

Information upon completion of well:

- (1) Diameter 10 inches.
- (2) Total Depth 385 feet.
- (3) Water Level 115 feet below top of ground.
- (4) Cased to 323', Size 10"
- (5) Screen: Size 6", Length 50'
- (6) Were any formations sealed against pollution?  
yes,  no

CODED

If YES depth of formation

Why

Drillers Remarks:

Yield in gpm: 150

Size pump: 25 H.P.

Type power: ELECTRIC

Electric  
11595 Jan 73

ADD 10

Mail this copy to Board of Water Commissioners 429 Miss. St. Jackson, Miss.

DEPARTMENT OF ENVIRONMENTAL QUALITY - OLWR  
PUBLIC SUPPLY WELLS PROJECT

GPS LOG

USER NAME(S): Phillips/Jennings DATE: 10/28/98  
UNIT DEQ #: \_\_\_\_\_ FILE #: B102821B  
HEALTH DEPT. #: 410011-02 ELEV. 275  
USGS #: 4100 OLWR #: GW00646  
OWNER: Plantersville QUAD: Verona  
LOCATION: SW/SWS 15 T 10S R 6E COUNTY: Lee  
LOCATION DESCRIPTION: At intersection of Hwy 6 and  
Payne St., across from City Hall  
CASING DIA: \_\_\_\_\_ PUMP TYPE & SIZE: Turbine  
GPS FIELD LOCATION: LAT. 34°12'27.4" LONG. 88°39'46.8  
GPS CORRECTED LOCATION: LAT. 34.207425 LONG. 88.662973  
REMARKS: Measured @ 8' from well, outside fence  
\_\_\_\_\_  
\_\_\_\_\_  
\_\_\_\_\_

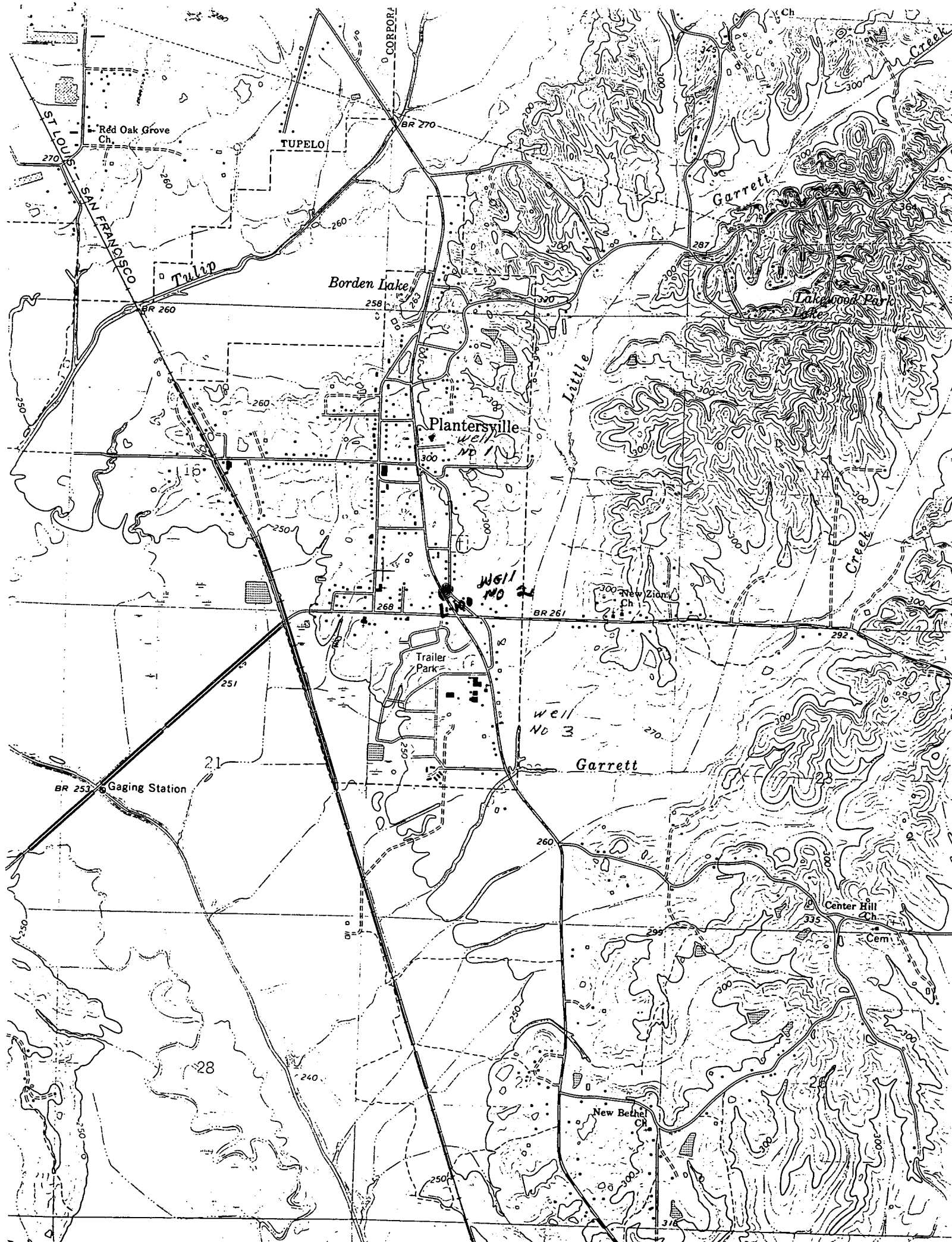

Red Oak Grove Ch.

TUPELO

CORPORAL

BR 270

Garrett

Tulip

Borden Lake

Lakewood Park

BR 260

Plantersville

Well No 1

Little

New Zion Ch.

Creek

Trailer Park

Well No 3

Garrett

BR 251 Gaging Station

Center Hill Ch.

Cem.

New Bethel Ch.

28

21

ST LOUIS

SAN FRANCISCO

250

260

270

335

376

270

260

260

300

287

260

250

268

251

292

230

240

250

300

300

300

300

Ch

31

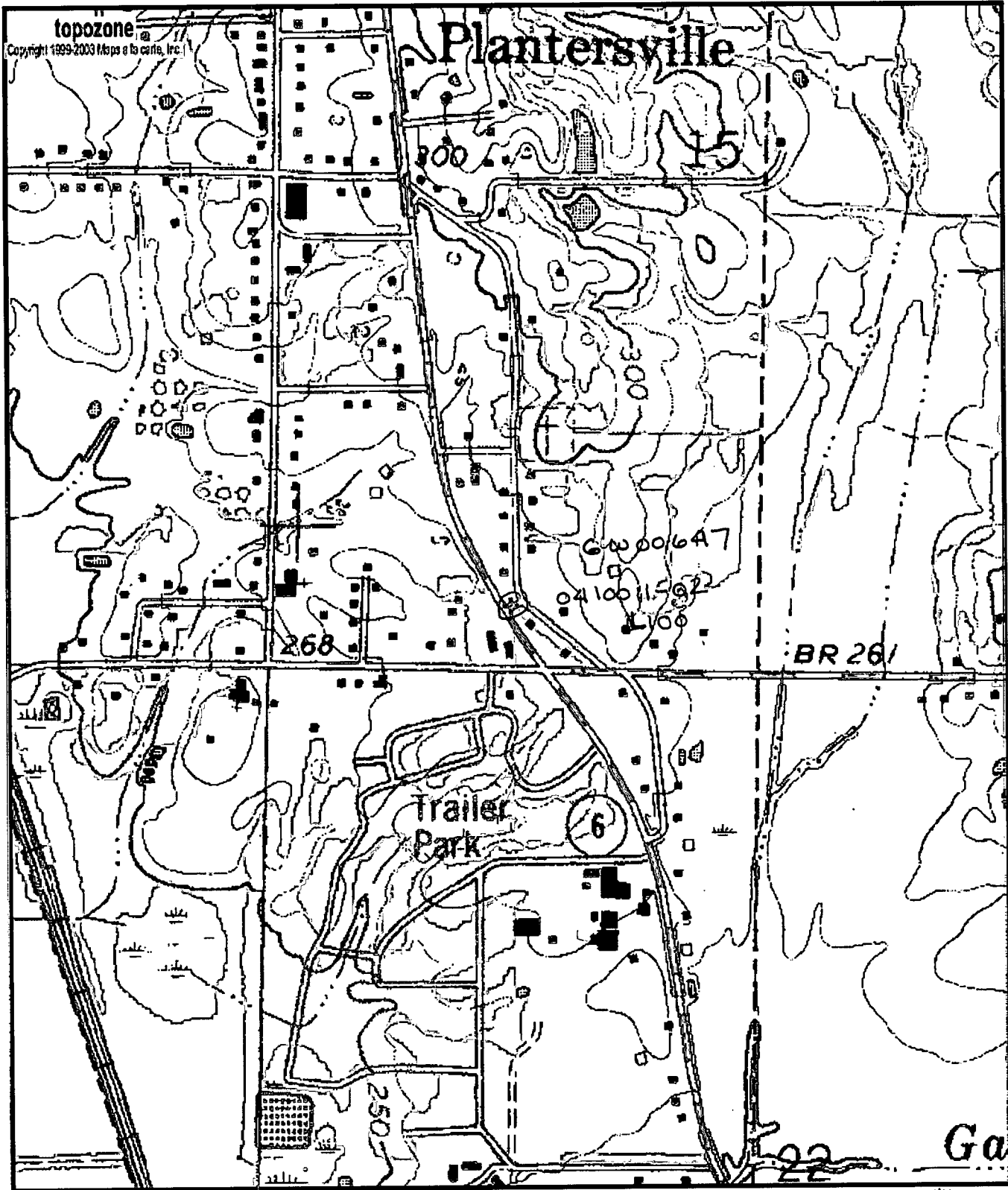

0 0.1 0.2 0.3 0.4 0.5 km

0 0.09 0.18 0.27 0.36 0.45 mi

Map center is 34° 12' 27"N, 88° 39' 47"W (WGS84/NAD83)

Verona quadrangle

Projection is UTM Zone 16 NAD83 Datum

M=-0.907

G=-0.935