

WELL SCHEDULE

U. S. DEPT. OF THE INTERIOR

GEOLOGICAL SURVEY

WATER RESOURCES DIVISION

MASTER CARD

Record by THOMSON Source of data BOWC Date 3-29-67 Map _____

State 28 County (or town) LEE 41

Latitude: 341226N Longitude: 0883857 Sequential number: 1

Lat-long accuracy: 1 T. 10 R. 6 Sec 19 SW 15 SW 15 SW 15

Local well number: L037CC1410S06E Other number: 228

Local use: _____ Owner or name: CLYDE FOSTER Address: _____

Ownership: County, Fed Gov't, City, Corp or Co, Private, State Agency, Water Dist P

Use of water: (A) Air cond, Bottling, Comm, Dewater, Power, Fire, Dom, Irr, Med, Ind, P S, Rec, (S) Stock, Instit, Unused, Repressure, Recharge, Desal-P S, Desal-other, Other H

Use of well: (A) Anode, Drain, Seismic, Heat Res, Obs, Oil-gas, Recharge, Test, Unused, Withdraw, Waste, Destroyed W

DATA AVAILABLE: Well data 0 Freq. W/L meas.: 0 Field aquifer char. 0

Hyd. lab. data: _____

Qual. water data; type: USGS PARTIAL

Freq. sampling: 0 Pumpage inventory: no period: _____

Aperture cards: _____

Log data: DRILLERS

WELL-DESCRIPTION CARD

SAME AS ON MASTER CARD Depth well: 320 Meas. 3

Depth cased: (first perf.) _____ ft 22 Casing type: _____; Diam. in 4

Finish: porous concrete, gravel v. (perf.), (screen), gravel v. (screen), gallery, end, horiz. open perf., screen, sd. pt., shored, open hole, other X

Method Drilled: (A) air rot, (B) bored, (C) cable, (D) dug, (H) hyd rot., (J) jetted, (P) air percussion, (R) reverse, (T) trenching, (V) driven, (W) drive wash, other H

Date Drilled: 965 Pump intake setting: _____ ft _____

Driller: HERNDON - HOMAN

Lift (type): (A) air, (B) bucket, (C) cent., (J) jet, multiple, multiple, none, (P) piston, (R) rot, (S) submerg, (T) turb, other 0 Deep 0 Shallow 40

Power (type): diesel, elec, gas, gasoline, hand, gas, wind; H.P. 0 Trans. or meter no. _____

Descrip. MP _____ ft above 41 below LSD. Alt. MP _____

Alt. LSD: 305 Accuracy: (source) TOPO 47 4

Water Level _____ ft above 42 below MP; Ft below 43 LSD 95 Accuracy: _____ 52 D

Date meas: 5-29-65 565 Yield: _____ gpm _____ Method determined _____ 61

Drawdown: _____ ft _____ Accuracy: _____ 65 Pumping period _____ hrs _____ 68

QUALITY OF WATER DATA: Iron _____ ppm 69 Sulfate _____ ppm 70 Chloride _____ ppm 71 Hard. _____ ppm 72

Sp. Conduct 500 K x 10 3 Temp. _____ °F 74 76 Date sampled 2-28-67 77 79 267

Taste, color, etc. _____

TRANSMITTED FOR ADP

Well No.

437

Well No. L 37

Latitude-longitude N
S
d m s d m s

HYDROGEOLOGIC CARD

1 SAME AS ON MASTER CARD 19 Physiographic Province: 03 Section: _____
22 Drainage Basin: D 23 13C 25 Subbasin: _____ 26

(D) (C) (E) (F) (R) (K) (L)
Topo of well site: (Q) (P) (S) (T) (U) (V)
offshore, pediment, hillside, terrace, undulating, valley flat _____ 27 H

MAJOR AQUIFER: _____ system _____ series K3 _____ aquifer, formation, group EUTAW E2

Lithology: _____ US Origin: 6 Aquifer Thickness: _____ ft
Length of well open to: _____ ft P 100 Depth to top of: _____ ft 200

MINOR AQUIFER: _____ system _____ series _____ aquifer, formation, group _____

Lithology: _____ Origin: _____ Aquifer Thickness: _____ ft
Length of well open to: _____ ft _____ Depth to top of: _____ ft _____

Intervals Screened: _____

Depth to consolidated rock: _____ ft _____ Source of data: _____

Depth to basement: _____ ft _____ Source of data: _____

Surficial material: _____ Infiltration characteristics: _____

Coefficient Trans: _____ gpd/ft _____ Coefficient Storage: _____

Coefficient Perm: _____ gpd/ft²; Spec cap: _____ gpm/ft; Number of geologic cards: _____

white sandstone on N. side of road in basin.

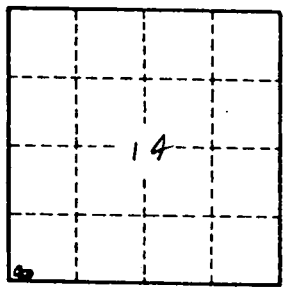

Well No.

L 37

LEE

L 37

5-29-65

MISSISSIPPI BOARD OF WATER COMMISSIONERS

WATER WELL DRILLERS LOG

Herndon-Homan Well & Supply, Inc.

Date: May 29, 1965, Driller: P. O. Box 42 SHANNON, MISSISSIPPI 38868 County Lee

		Description & Color of Materials Sand, Clay, Red Clay, Shell, etc.	Thick- ness Feet	Depth Feet
(1) Owner of Land:	<i>Clyde Foster</i> <small>(Name)</small>			
	<i>Rt 1 Plantersville, Miss.</i> <small>(Address)</small>	<i>sand + clay</i>	<i>0 - 20</i>	
		<i>Blue clay</i>	<i>20 - 200</i>	
(2) Location:	$\frac{1}{4}$, $\frac{1}{4}$, Sec. <i>14</i> , T. <i>09</i> , R. <i>24</i>	<i>Sand</i>	<i>200 - 320</i>	
	<i>1</i> miles <i>E</i> , of <i>Plantersville</i> <small>(distance) (direction) (Nearest Town)</small>	<i>Bottom</i>	<i>300</i>	
(3) Topography:	<i>Hilly</i> <small>(Hilly) (Flat) (Level)</small>			
(4) Purpose of Well:	<i>Domestic</i> <small>(Domestic Irrigation Municipal, Industrial, Other)</small>	<i>5th frame part arch</i>		
		<i>Water table good</i>		
Information upon completion of well:		<i>white sediment</i>		
(1) Diameter	<i>4</i> inches.			
(2) Total Depth	<i>320</i> feet.			
(3) Water Level	<i>95</i> feet below top of ground.			
(4) Cased to	<i>22' 4"</i> , Size <i>4"</i>			
(5) Screen: Size	_____, Length _____			
(6) Were any formations sealed against pollution?	<input checked="" type="checkbox"/> yes, _____ no.			
	If YES depth of formation <i>20'</i>			
Why	<i>surface + sand</i>			
Drillers Remarks:				
	<i>228 LEE 300</i>			

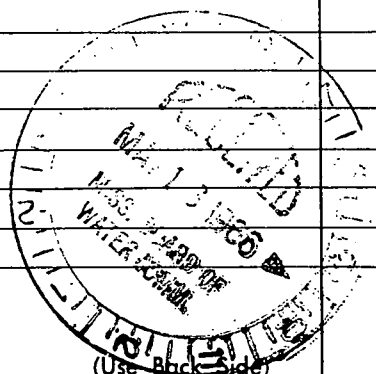

Well No.

Mail this copy to Board of Water Commissioners 429 Miss. St. Jackson, Miss

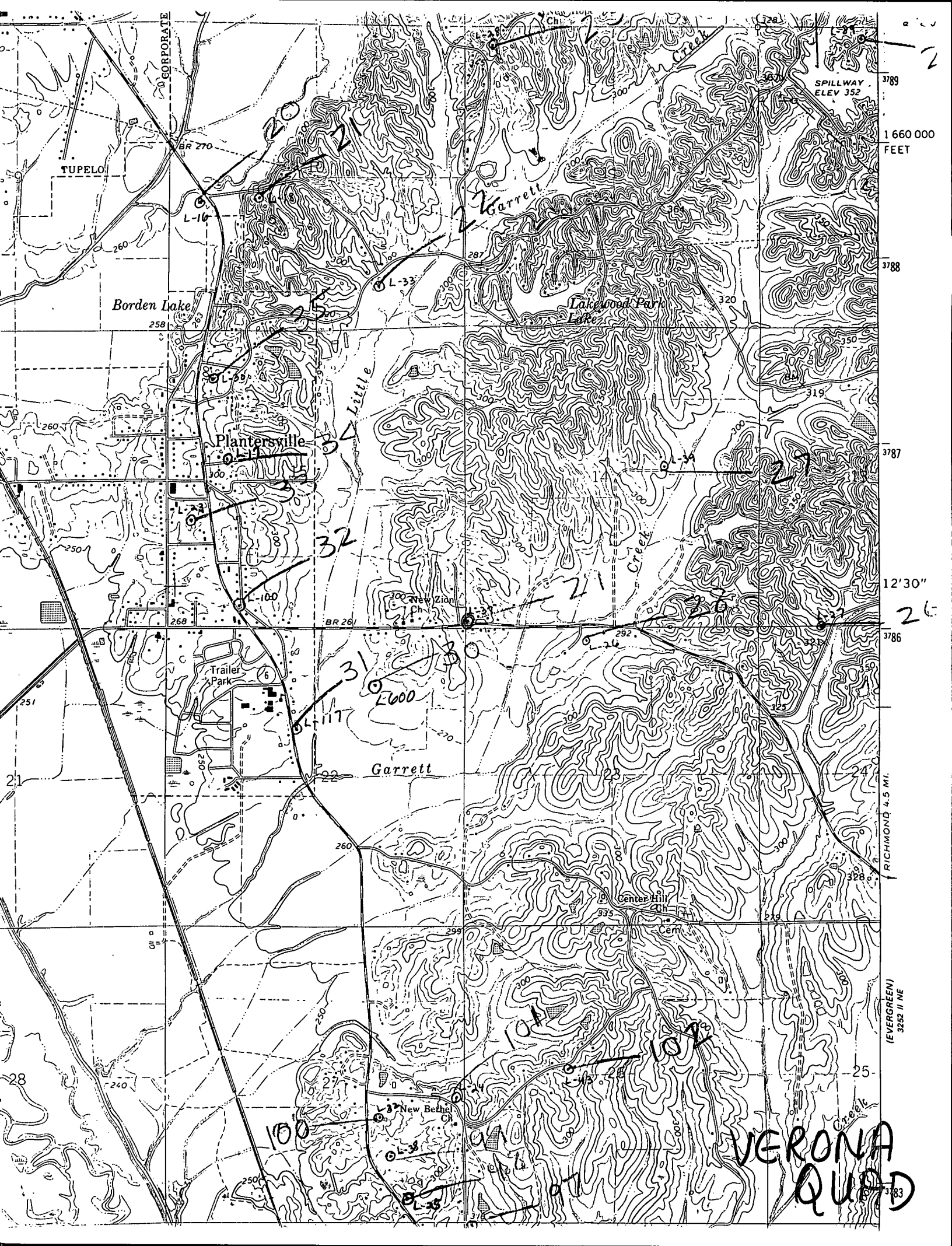

1660 000
FEET

3789
3788

3787

12'30"
26
3786

RICHMOND 4.5 MI.

(EVERGREEN)
3252 II NE

3783

VERONA
QUAD