



Well No. L 21

Latitude-longitude N  
S  
d m s d m s

HYDROGEOLOGIC CARD

**SAME AS ON MASTER CARD** Physiographic Province: 03 Section: \_\_\_\_\_

D Drainage Basin: 13C Subbasin: \_\_\_\_\_

Topo of well site: (D) depression, (C) stream channel, (E) dunes, (F) flat, (R) hilltop, (K) sink, (L) swamp, (O) offshore, (P) pediment, (S) hillside, (T) terrace, (U) undulating, (V) valley flat F

MAJOR AQUIFER: \_\_\_\_\_ system \_\_\_\_\_ series K3 aquifer, formation, group ESTANCARDO 90

Lithology: \_\_\_\_\_ Origin: US Aquifer Thickness: 2 ft

40 Length of well open to: UNKNOWN ft 60 Depth to top of: \_\_\_\_\_ ft

MINOR AQUIFER: \_\_\_\_\_ system \_\_\_\_\_ series \_\_\_\_\_ aquifer, formation, group \_\_\_\_\_

Lithology: \_\_\_\_\_ Origin: \_\_\_\_\_ Aquifer Thickness: \_\_\_\_\_ ft

500-560 Length of well open to: \_\_\_\_\_ ft 8" S.S. shuttles Depth to top of: \_\_\_\_\_ ft

Intervals Screened: 500-560 8" S.S. shuttles

Depth to consolidated rock: \_\_\_\_\_ ft \_\_\_\_\_ Source of data: \_\_\_\_\_

Depth to basement: \_\_\_\_\_ ft \_\_\_\_\_ Source of data: \_\_\_\_\_

Surficial material: \_\_\_\_\_ Infiltration characteristics: \_\_\_\_\_

Coefficient Trans: \_\_\_\_\_ gpd/ft 193 Coefficient Storage: 0.0003 306

Coefficient Perm: 480 gpd/ft<sup>2</sup>; Spec cap: 5.1 gpm/ft; Number of geologic cards: \_\_\_\_\_

W.L.

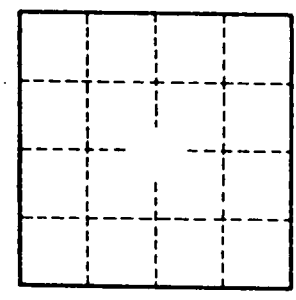
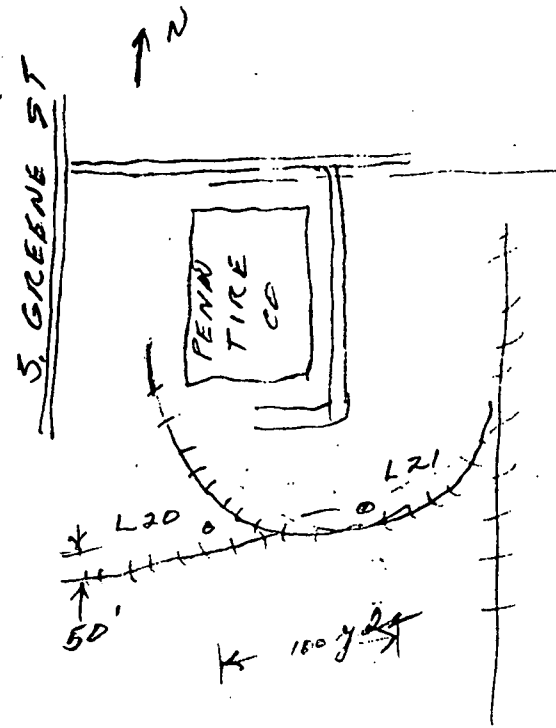

Well No.

L 21

UNITED STATES  
THE INTERIOR  
SURVEY



BOONEVILLE (VIA U.S. 45) 33 MI.

0.5 MI TO U.S. 78

325' SW (TUPELO)

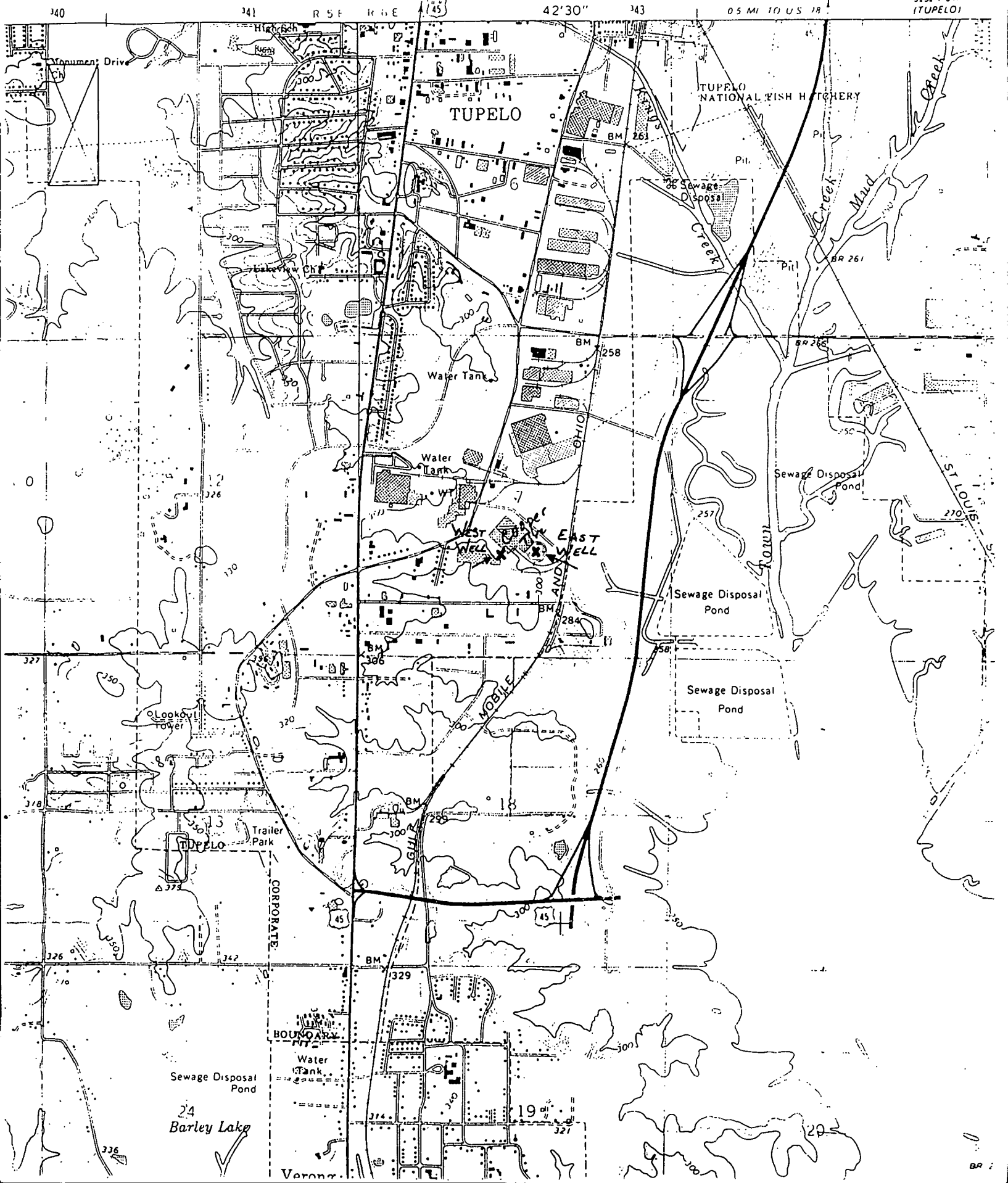

TUPELO

TUPELO NATIONAL FISH HATCHERY

Water Tank

Water Tank

WEST WELL  
EAST WELL

Sewage Disposal Pond

Sewage Disposal Pond

Sewage Disposal Pond

BOONEVILLE

Water Tank

Sewage Disposal Pond

24  
Barley Lake

19

29

CODED

coded

Lee  
L 21  
2-67

MISSISSIPPI  
BOARD OF WATER COMMISSIONERS  
416 North State Street  
Jackson, Mississippi 39201

WATER WELL DRILLERS LOG

Feb. 20, 19 67 Layne-Central Co. Lee  
date well completed firm name county well located

LANDOWNER:  
Pennsylvania Tire Company  
Tupelo, Mississippi  
(mailing address)

WELL LOCATION:  
sec. \_\_\_ T \_\_\_ N R \_\_\_ E  
In City limits<sup>S</sup> - S. Green St.<sup>W</sup>  
(distance) miles \_\_\_ of \_\_\_ (direction) (nearest town)

WELL PURPOSE: Industrial  
(home, irrigation, municipal, industrial)

WELL COMPLETION DATA:  
(1) diameter (inches) 12"  
(2) total depth (feet) 595'  
(3) static water level (feet) 161' below top of ground.  
(4) casing steel pipe 495' (material) (depth)  
- if telescope see back. (size)  
(5) screen 60' 500' (length) (depth to top)  
8" s.s. shutter (size) (material)  
(6) pump 40 500 (HP) (yield gpm)  
electricity (type power)  
(7) electric log no (yes or no)  
(organization running log)  
(8) how well bottom plugged

description of formations encountered	from	to
Gummy clay	22	22
sandy clay	6	28
hard clay	170	198
hard clay-rock stks	22	220
sandy clay	58	278
fine sand-clay stks	24	302
clay-sand stks	17	319
fine sand-clay	16	335
hard clay	2	337
sand-clay	8	345
sand-clay stks	23	368
sand-clay stks	23	391
sand-clay stks	5	396
clay-sandy stks	8	404
sand-clay stks	10	414
sand-clay stks	21	435
clay-sandy stks	26	461
sand-clay stks	18	479
hard clay	5	484
rock	1	485
hard clay	5	490
rock	1	491
hard clay	9	500
sand & gravel	15	515
gummy clay-rock stks	23	538
sandy clay	4	542
gummy clay-rock stks	7	549
pink chert	14	563
pink clay	7	570
fine sand-clay	28	598
fine sand-clay	23	621
fine sand-clay-rock stks	16	637
hard clay-rock stks	2	644

DRILLERS REMARKS:

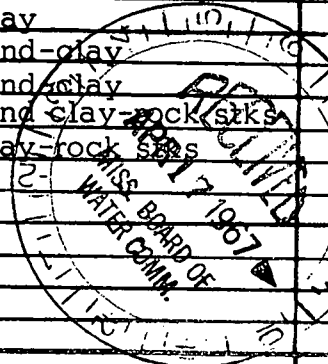

ERIOR



NE

MISS  
VERONA QUAD

BOONEVILLE (VIA U.S. 45) 33 MI.

0.5 MI. TO U.S. 78

3252 1 SW  
(TUPELO)

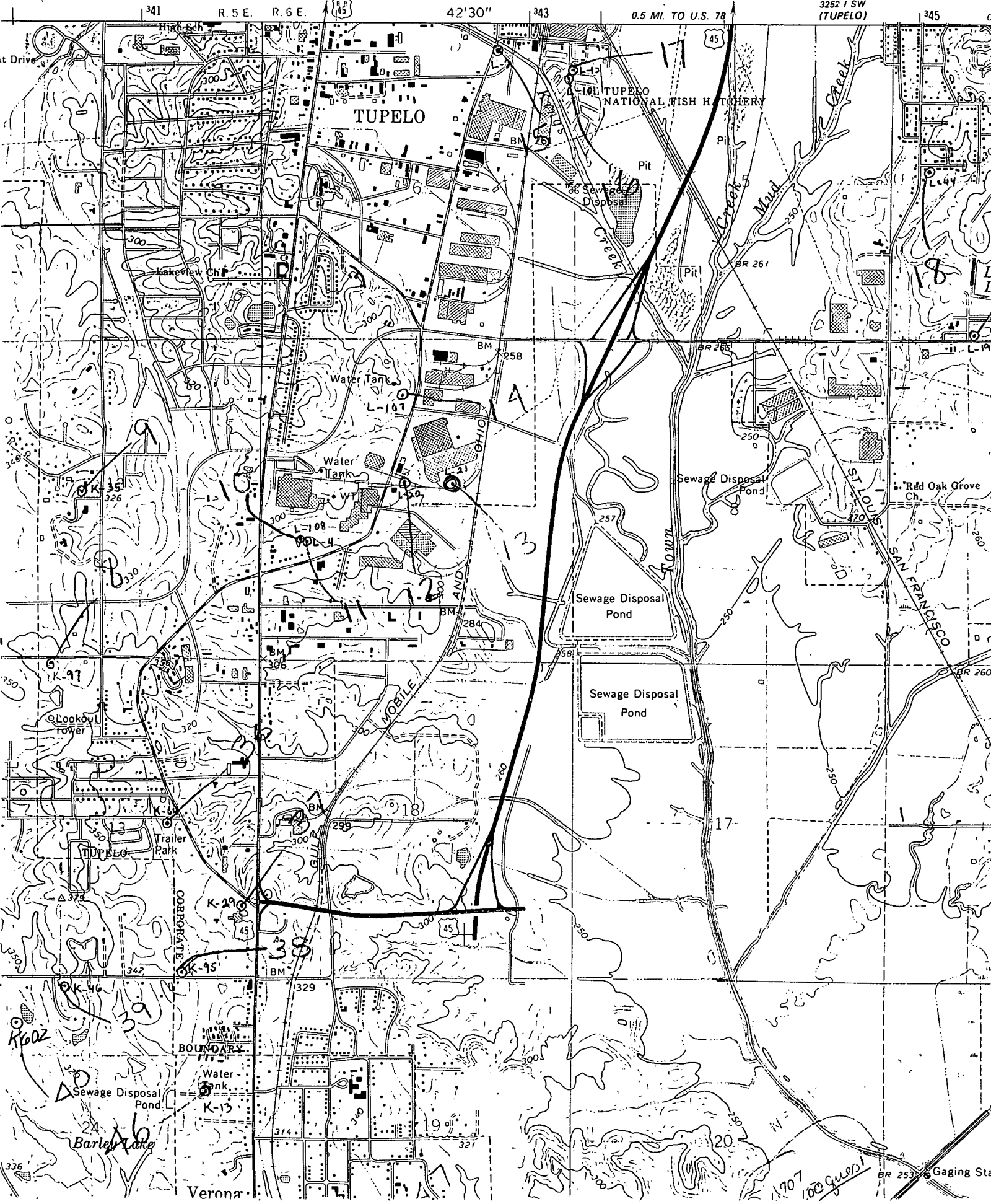

it Drive

K-35  
326

K-97  
Lookout tower

K-6  
Trailer Park

K-46  
K-95

K-24  
Sewage Disposal Pond  
Barley Lake

Lakeview Ch.

TUPELO

Water Tank

Water Tank

MOBILE

GUIN

BOUNDARY

Verona

TUPELO NATIONAL FISH HATCHERY

66 Sewage Disposal

Sewage Disposal Pond

Sewage Disposal Pond

Water Tank

K-13

Sewage Disposal Pond

Sewage Disposal Pond

Sewage Disposal Pond

Water Tank

K-13

Red Oak Grove Ch.

SAN FRANCISCO

Gaging Station

336

342

343

344

345

346

347

348

349

350

351

352

353

354

355

356

357

358

359

360

361

362

363

364

365

366

367

368

369

370

371

372

373

374

375

376

377

378

379

380

381

382

383

384

385

386

387

388

389

390

391

392

393

394

395

396

397

398

399

400

401

402

403

404

405

406

407

408

409

410

411

412

413

414

415

416

417

418

419

420

421

422

423

424

425

426

427

428

429

430

431

432

433

434

435

436

437

438

439

440

441

442

443

444

445

446

447

448

449

450

451

452

453

454

455

456

457

458

459

460

461

462

463

464

465

466

467

468

469

470

471

472

473

474

475

476

477

478

479

480

481

482

483

484

485

486

487

488

489

490

491

492

493

494

495

496

497

498

499

500

501

502

503

504

505

506

507

508

509

510

511

512

513

514

515

516

517

518

519

520

521

522

523

524

525

526

527

528

529

530

531

532

533

534

535

536

537

538

539

540

541

542

543

544

545

546

547

548

549

550

551

552

553

554

555

556

557

558

559

560

561

562

563

564

565

566

567

568

569

570

571

572

573

574

575

576

577

578

579

580

581

582

583

584

585

586

587

588

589

590

591

592

593

594

595

596

597

598

599

600

601

602

603

604

605

606

607

608

609

610

611

612

613

614

615

616

617

618

619

620

621

622

623

624

625

626

627

628

629

630

631

632

633