

WRD Exp. (GW)  
April 1966

Well No. L15

### WELL SCHEDULE

U. S. DEPT. OF THE INTERIOR

GEOLOGICAL SURVEY

WATER RESOURCES DIVISION

MASTER CARD BEWaman 1-8-68

Record by LW Stephenson source of data. Date 10-5-1919 Map

State Miss County 28 (or town) Jac Sequential number: 1

Latitude: 34° 11' 42" N Longitude: 088° 42' 58" W

Lat-long accuracy: 3 T. 10 S. R. 6 W. Sec 19, SW SW  
Local well number: L015CC1910506E Other number: B & M

Local use: \_\_\_\_\_ Owner or name: R.S. Gibson

Owner or name: R. S. GIBSON Address: \_\_\_\_\_

Ownership: County, Fed Gov't, City, Corp or Co, Private, State Agency, Water Dist P

Use of water: (A) Air cond, Bottling, Comm, Dewater, Power, Fire, Dom, Irr, Med, Ind, P S, Rec, (S) Stock, Inactit, Unused, Reppure, Recharge, Desal-P S, Desal-other, Other H

Use of well: (A) Anode, Drain, Seismic, Heat Res, Obs, Oil-gas, Recharge, Test, Unused, Withdraw, Waste, Destroyed W

DATA AVAILABLE: Well data  Freq. W/L meas.:  Field aquifer char.

Hyd. lab. data:

Qual. water data; type:

Freq. sampling:  Pumpage inventory:  yes no, period:

Aperture cards:  yes

Log data:

#### WELL-DESCRIPTION CARD

SAME AS ON MASTER CARD Depth well: 425 ft Meas. 6 accuracy

Depth cased; (first perf.): 30 ft Casing type: Steel; Diam. 4 in

Finish: porous concrete, gravel w. concrete, (perf.), gravel w. (screen), (H) horiz. gallery, (O) open end, (P) perf., (S) screen, (T) sd. pt., (W) shored, (X) open hole, (Z) other X

Method Drilled: (A) air bored, (B) cable, (C) dug, (H) hyd rot., (J) jetted, (P) air reverse, (R) reverse, (T) trenching, (V) driven, (W) drive wash, (Z) other H

Date Drilled: 9-10 Pump intake setting: \_\_\_\_\_ ft

Driller: \_\_\_\_\_ name (L) (M) (N) (P) (R) (S) (T) (Z) address N Deep  Shallow

Power (type): diesel, elec, gas, gasoline, hand, gas, wind; H.P.  Trans. or meter-no.

Descrip. MP \_\_\_\_\_ ft above below LSD. Alt. MP \_\_\_\_\_

Alt. LSD: 310 Accuracy: 7 (source)

Water Level 65 ft above below MP; Ft 65 above below LSD Accuracy: 6

Date meas: 1919 9-19 Yield: \_\_\_\_\_ gpm Method determined

Drawdown: \_\_\_\_\_ ft Accuracy: \_\_\_\_\_ Pumping period: \_\_\_\_\_ hrs

QUALITY OF WATER DATA: Iron \_\_\_\_\_ ppm Sulfate \_\_\_\_\_ ppm Chloride \_\_\_\_\_ ppm Hard. \_\_\_\_\_ ppm Sp. Conduct \_\_\_\_\_ K x 10 6 Temp. \_\_\_\_\_ °F Date sampled \_\_\_\_\_

Taste, color, etc. \_\_\_\_\_

TRANSMITTED FOR ADP

Well No. L15

Well No. L15

Latitude-longitude N  
S  
d m s d m s

HYDROGEOLOGIC CARD

SAME AS ON MASTER CARD Physiographic Province: 03 Section: \_\_\_\_\_

Drainage Basin: D 13C Subbasin: \_\_\_\_\_

Topo of well site: (D) depression, stream channel, dunes, flat, hilltop, sink, swamp, (C) (E) (F) (H) (K) (L) (O) (P) (S) (T) (U) (V) offshore, pediment, hillside, terrace, undulating, valley flat 27 S

MAJOR AQUIFER: \_\_\_\_\_ system, \_\_\_\_\_ series K3 Santa aquifer, formation, group EZ

Lithology: \_\_\_\_\_ US Origin: \_\_\_\_\_ G Aquifer Thickness: \_\_\_\_\_ ft

Length of well open to: \_\_\_\_\_ ft Depth to top of: \_\_\_\_\_ ft

MINOR AQUIFER: \_\_\_\_\_ system, \_\_\_\_\_ series \_\_\_\_\_ aquifer, formation, group \_\_\_\_\_

Lithology: \_\_\_\_\_ US Origin: \_\_\_\_\_ \_\_\_\_\_ Aquifer Thickness: \_\_\_\_\_ ft

Length of well open to: \_\_\_\_\_ ft Depth to top of: \_\_\_\_\_ ft

Intervals Screened: \_\_\_\_\_

Depth to consolidated rock: \_\_\_\_\_ ft Source of data: \_\_\_\_\_

Depth to basement: \_\_\_\_\_ ft Source of data: \_\_\_\_\_

Surficial material: \_\_\_\_\_ Infiltration characteristics: \_\_\_\_\_

Coefficient Trans: \_\_\_\_\_ gpd/ft Coefficient Storage: \_\_\_\_\_

Coefficient Perm: \_\_\_\_\_ gpd/ft<sup>2</sup>; Spec cap: \_\_\_\_\_ gpm/ft; Number of geologic cards: \_\_\_\_\_

1/10 mile N.E. of P.O.

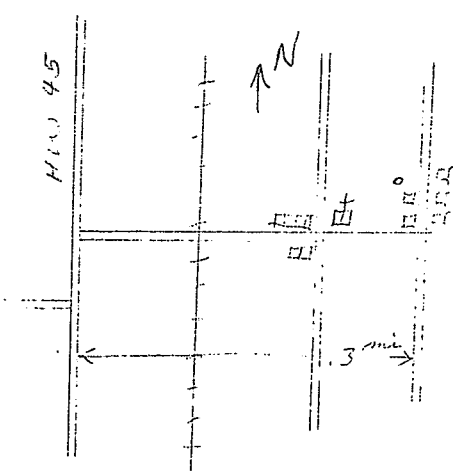

old house w/ yellow front, well in valley approx. 200' NW of house. Well destroyed before 1960

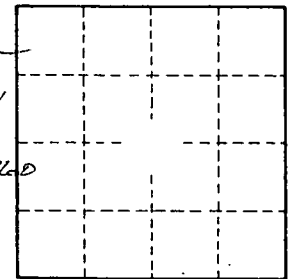

Well No.