

185
(October 1950)
NO. 100-109

UNITED STATES
DEPARTMENT OF THE INTERIOR
GEOLOGICAL SURVEY

WATER RESOURCES DIVISION

WELL SCHEDULE

Date Sept. 9 1955 Field No. L
Record by John Lang & ENB Office No. KTS
Source of data Various L13

1. Location: State Miss. County Lee

Map Lot 1, Block 13, Town of Verona
SW 1/4, SE 1/4, E 1/4, sec. 19, T. 10 N., R. 6 E. (S) (E)

2. Owner: Town of Verona Address Lee Co., Miss.

Tenant _____ Address _____

Driller H. P. Herndon Address Shannon, Miss.

3. Topography _____

4. Elevation 321.0 ft. above mean Gulf datum

5. Type: Dug, drilled driven, bored, jetted May 1949

6. Depth Rept. _____ ft. Meas. _____ ft.

7. Casing: Diam. 5" Size 6" Top: 1' 6" ft. above ground

Depth 470 ft. Finish 30' screen

8. Chief Aquifer Etowah KM From 446 ft. to 470 ft.

Others see log

9. Water level 90 ft. meas. 5-49 19 _____ above/below surface

10. Pump: Type Turbine Capacity 75 G.M.

Power: Kind elec Horsepower _____

11. Yield: Flow _____ G.M., Pump 75 G.M., Meas., Rept. Est. _____

Drawdown _____ ft. after _____ hours pumping _____ G.M.

12. Use: Dom., Stock, PS, RR., Ind., Irr., Obs. 207 Home

Adequacy, permanence _____

13. Quality _____ Temp 67 °F.

Taste, odor, color _____ Sample Yes/No _____

Unfit for _____

14. Remarks: (Log, Analyses, etc.) Log over

-600,000 gpd SAMPLES

FOUND ABANDONED '67

ESTATE CENTER
 Total Depth: INTER Stratum Thickness Formation

Total Depth	Stratum Thickness	Formation
10	10	clay
16	6	Selma Chalk
18	2	Hard Rock
19	1	Selma Chalk
93	74	Blue Rock
112	19	Shale
115	3	Hard Rock
156	41	Soapstone
157	1	Hard Rock
275	118	Soapstone
283	8	Shale
300	17	Fine Sand
377	77	Sand
407	30	Shale
438	31	Eutaw Sand
446	8	Shale
470	24	Eutaw Sand

Red brick store
 Groceries & Service STATION
 TO PLAINFIELD
 TO PLAINFIELD

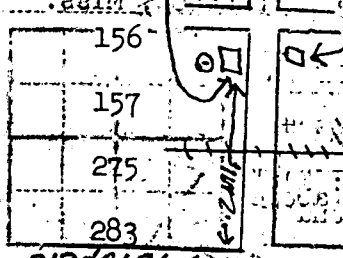

TO PLAINFIELD

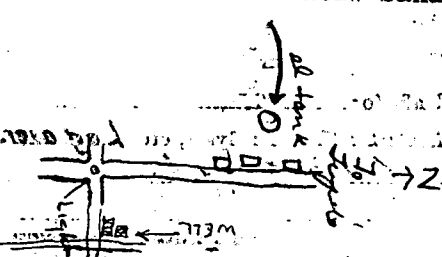

VERONA QUAD

