

9-185
(October 1950)

UNITED STATES
DEPARTMENT OF THE INTERIOR
GEOLOGICAL SURVEY
WATER RESOURCES DIVISION

WELL SCHEDULE

Date Mar. 1, 1960 Field No. _____
Record by B. E. Edison Office No. L4
Source of data Water Dept. Tupelo

1. Location: State Miss County Lee

Map NW 1/4 SW 1/4 sec. 7 T 10 N R 6 E W
#10 City of Tupelo Address Tupelo, Miss

Tenant _____ Address _____
Driller Layne Central Address Memphis, Tenn

3. Topography Creek bottom

4. Elevation 285 ft. ^{above} bed ^{below} nattleton 1/2

5. Type: Dug, drilled, driven, bored, jetted _____ 1960
6. Depth: Rept. 580 ft. Meas. 567 ft.

7. Casing: Diam. 12 in., to _____ in., Type _____
Depth _____ ft., Finish 8" 120' screen

8. Chief Aquifer Ke & Ktg From _____ ft. to _____ ft.

Others _____
9. Water level -90 ft. ^{rept} meas. 1960 ^{above} below air vent which is 2 ft. ^{above} below surface

10. Pump: Type Turbine Capacity _____ G. M.
Power: Kind Elec. Horsepower 75

11. Yield: Flow _____ G. M., Pump 700 G. M., Meas., Rept. Est. _____
Drawdown _____ ft. after _____ hours pumping _____ G. M.

12. Use: Dom., Stock, PS, RR., Ind., Irr., Obs.
Adequacy, permanence Plenty & good

13. Quality _____ Temp _____ °F.
Taste, odor, color _____ Sample Yes
Unfit for _____ No

14. Remarks: (Log, Analyses, etc.) SAMPLES

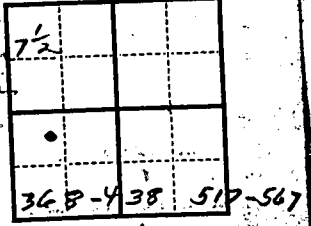

eb

С. У. Уленс' Искра Тар
Коробович

С. У. Уленс' Искра Тар
Коробович

Клону
Делу
Искра Тар

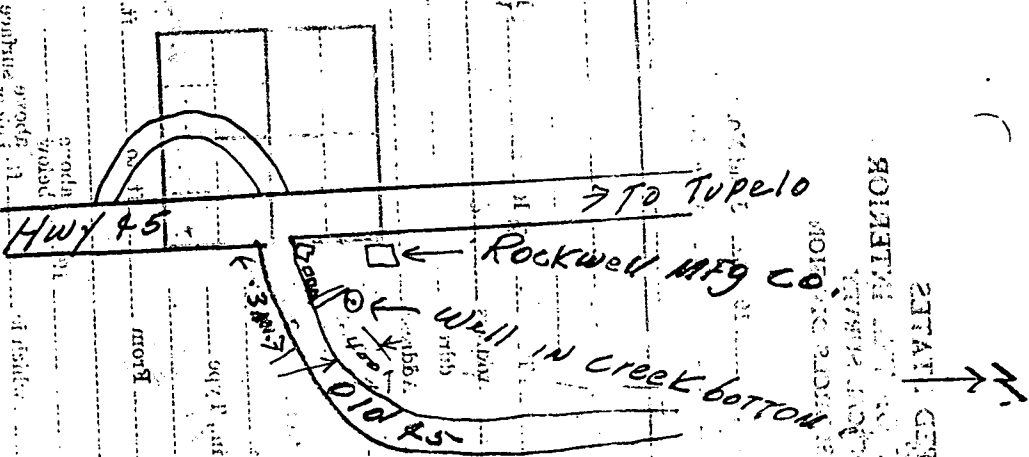

DEPARTMENT OF AGRICULTURE
BUREAU OF RECLAMATION
WATER RESOURCES DIVISION
WATER CONSERVATION DISTRICT NO. 1
MEXICO

(C-1006-1020)
1950

9-185
(October 1950)

U
DEPARTMENT
GEC
WATER

WELL SCHEDULE