

OIL & GAS WELL SCHEDULE

County: 81

Well No.: K600

Company: Gulf Refining Co.

Well: Verona #1 Core hole

Location: 1062' N + 484' E of SW/c of SE S23T10S R5E
NE, NW, SE, SW

Elevation:

G.L.: 275

D.F.: _____

K.B.: _____

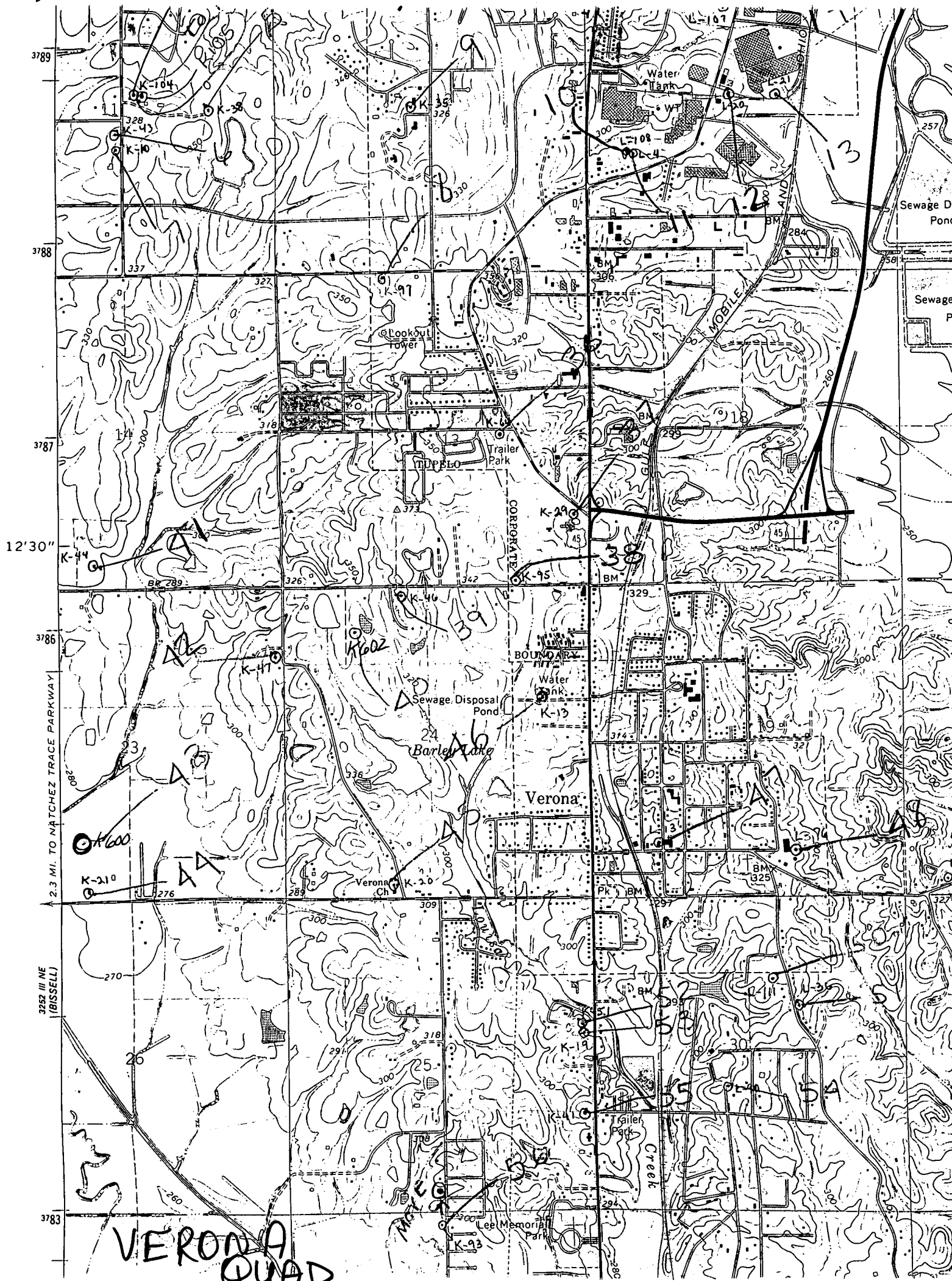

VERONA QUAD

CORPORATE

3789
3788
3787
12'30"
3786
3783

2.3 MI. TO NATCHEZ TRACE PARKWAY

3252 III NE (BISSELL)

Sewage Disposal Pond
Sewage Pond

Water Tank

Lookout Tower

Trailer Park

BOUNDARY

Water Tank

Barley Lake

Verona

Verona, Ch

Trailer Park

Leel Memorial Park

257

13

MOBILE

38

K-21

K-44

K-104

K-43

K-10

K-97

K-6

K-49

K-95

K-47

K-46

K-20

BM 329

K-13

BM 325

BM 325

BM 325

BM 325

BM 325

BR 289

BR 289

BR 289

BR 289

BR 289

BR 289

BR 289

BR 289

BR 289

BR 289

BR 289

BR 289

BR 289

BR 289

BR 289

BR 289

BR 289

BR 289