

Recorded by BR!
Date 5/11/83

U.S. GEOLOGICAL SURVEY
WATER RESOURCES DIVISION
MISSISSIPPI DISTRICT
WELL RECORD

Well No. K98
E-Log No. 113
County LEE

Site ID 34.1147.08848.03.01 R-0* T-A* 2-W*

Data reliab. 3-4* Report. agency 4-USGS* Dist. 6-28* 7-28* Cp. 8-08.1*

Lat. Long. 9-34.1147* 10-08.84803* Well No. 12-K.09.8.*

Loc. 13-E.6.4.20.3.1.0.5.0.5.E* Alt. 1033.0*

Hyd. Unit (OWDC) 20- Date 21-09.10.1.1983*

Well use 23-W* Water Use 24-T* Hole depth 27-64.0* Well depth 28-63.5*

WL 30-2.0.0* Date 31-09.10.1.1983* 33-D*

Status 273- Project No. 159#09.01.1.1983*

R-158* T-A* Date 159#09.01.1.1983*

Owner 161 FRED M. MURPHY

R-192* T-A* Date 193# Temp. 195#00010* 197-*

R-192* T-A* Date 193# Cond. 195#00095* 197-*

R-192* T-A* Date 193# pH 196#00400* 197-*

R-58* T-A* 59#1* Date 60-09.10.1.1983* Remarks

Drig. 63-0.2.7* Name J.W. WEBB'SONS Method 65-H* Finish 66-S*

R-76* T-A* 59#1*

Top csgn. 77# 0* Bot. csgn. 78-5.5.5.* Diam. 79# 18.*

R-76* T-A* 59#1*

Top csgn. 77# Bot. csgn. 78- Diam. 79#

R-82* T-A* 59#1* Top 83# 5.5.5.* Bottom 84-16.3.5.*

Type 85-S* Diam. 87-8.* Size 88-

R-82* T-A* 59#1* Top 83# Bottom 84-

Type 85- Diam. 87- Size 88-

134-flows 146 pumped

GEN. SITE DATA

OWNER

FIELD ON

CONSTR.

CASING

OPENINGS

WELL

FRED A. MURPHREE, D. D. S.

602 PEGRAM DR. - P. O. Box 1532

TUPELO, MISSISSIPPI 38801

TELEPHONE 842-7154

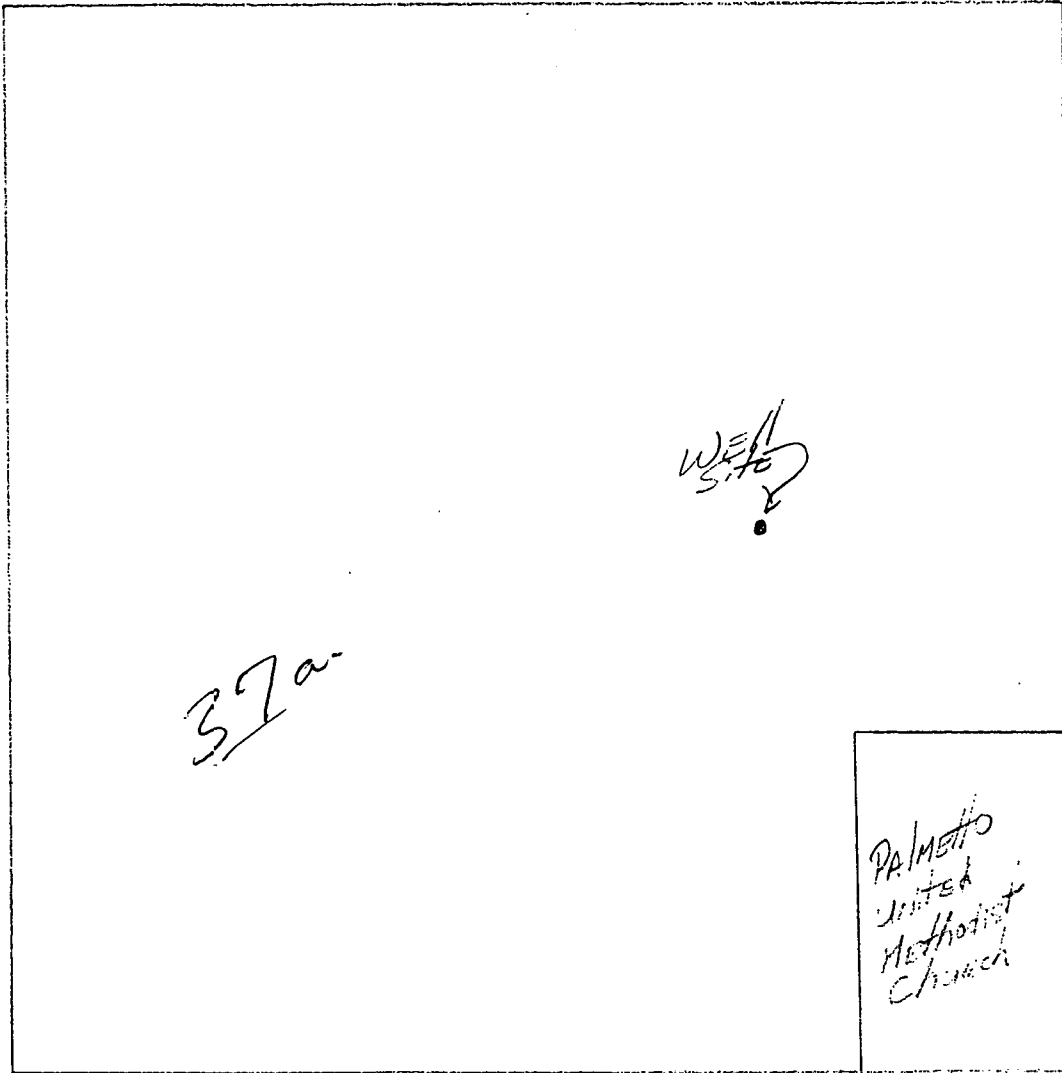

Well Site

37a-

Palmetto
United
Methodist
Church

SECTION LINE

LEE
K98
9/83
Elog #113

MISSISSIPPI
BOARD OF WATER COMMISSIONERS
416 North State Street
Jackson, Mississippi 39201
WATER WELL DRILLERS LOG

CODED

SEPT 19 83 J.W. WEBB & SONS LEE
date well completed firm name county well located

LANDOWNER:	description of formations encountered	from	to
FRED MURPHREE	RED CLAY	0	5'
VERONA, MISS (mailing address)	BLUE CLAY	5	410
	SAND & CLAY	410	545
	SAND	545	635
WELL LOCATION:			
sec 20 T 10 S R 5 E			
5 miles WEST of VERONA (distance) (direction) (nearest town)			
WELL PURPOSE: IRRIGATION (home, irrigation, municipal, industrial)			
WELL COMPLETION DATA:			
(1) diameter (inches) 8"			
(2) total depth (feet) 635'			
(3) static water level (feet) 200' below top of ground.			
(4) casing STEEL 510' (material) (depth)			
(size) If telescope see back.			
(5) screen 80' 555' (length) (depth to top)			
4" 5.5. (size) (material)			
(6) pump 20 200 (HP) (yield gpm)			
ELEC (type power)			
(7) electric log YES (yes or no)			
STATE (organization running log)			
(8) how well bottom plugged BACK WASH VALVE			
DRILLERS REMARKS:			

CODED

DEPT. OF NATURAL RESOURCES
BUREAU OF LAND & WATER RESOURCES

DEC 12 1983

RECEIVED

BISSELL QUAD

