

Verona

W&D Exp. (GW)
April 1966

Well No. K 59

WELL SCHEDULE

E log # 38

U. S. DEPT. OF THE INTERIOR

GEOLOGICAL SURVEY

WATER RESOURCES DIVISION

TRANSMITTED FOR ADP

MASTER CARD

Record by Wason Source of data driller Date 3-3-67 Map _____

State 28 County (or town) Lee 41

Latitude: 34^{deg} 14^{min} 13^{sec} N Longitude: 088^{degrees} 44^{min} 38^{sec} W Sequential number: 1

Lat-long accuracy: 1^{min} T. 10^{sec} R. 5^{sec} W. Sec 2 NW 1 SE, SW, SE

Local well number: K059CR0210505E Other number: _____

Local use: _____ Owner or name: BILL MCKINNEY Address: Impala

Ownership: County, Fed Gov't, City, Corp or Co, Private, State Agency, Water Dist. P

Use of water: (A) Air cond, Bottling, Comm, Dewater, Power, Fire, (B) Dom, Irr, Med, Ind, P S, Rec, (C) Stock, Instit, Unused, Repressure, Recharge, Desal-P S, Desal-other, Other W

Use of well: (A) Anode, Drain, Seismic, Heat Res, Obs, Oil-gas, Recharge, Test, Unused, (B) Withdrawn, Waste, Destroyed W

DATA AVAILABLE: Well data Freq. W/L meas.: N Field aquifer char.

Hyd. lab. data: _____

Qual. water data; type: _____

Freq. sampling: _____ Pumpage inventory: period: _____

Aperture cards: _____

Log data: E-log

WELL-DESCRIPTION CARD

SAME AS ON MASTER CARD Depth well: 516 ft 516 1 accuracy

Depth cased: (first perf.) ft 212 Casing type: steel ; Diam. 4 in 4

Finish: porous concrete, gravel w. (perf.), (C) gravel w. (screen), (H) horis. open gallery, end, (P) perf., (S) screen, sd. pt., (T) shored, (X) other X

Method: (A) air bored, cable, dug, (B) rot., (C) hyd, (D) jetted, (H) air percussion, rotary, (P) reverse trenching, driven, wash, (T) drive, (V) wash, (W) other H

Date Drilled: 3-3-67 9:67 Pump intake setting: _____ ft _____

Driller: J W Webb

Lift (type): (A) air, bucket, cent, jet, (B) multiple, (C) multiple, (L) none, (M) piston, (N) rot., (P) submers, (R) turb, (S) other S Deep 5 Shallow 0

Power (type): diesel, elec, gas, gasoline, hand, gas, wind; H.P. 1/2 LP S Trans. or motor no. _____

Descrip. MP _____ ft above _____ ft below LSD. Alt. MP _____

Alt. LSD: 340 340 Accuracy: (source) topo 10' 4

Water Level _____ ft above MP; _____ ft below LSD Accuracy: _____

Date meas: _____ Yield: _____ gpm _____ Method determined _____

Drawdown: _____ ft Accuracy: _____ Pumping period _____ hrs _____

QUALITY OF WATER DATA: Iron _____ ppm Sulfate _____ ppm Chloride _____ ppm Hard. _____ ppm

Sp. Conduct _____ K x 10 6 Temp. _____ °F _____ Date sampled _____

Taste, color, etc. _____

Well No. K 59

Well No. K59

Latitude-longitude N
S
d m s d m s

HYDROGEOLOGIC CARD

SAME AS ON MASTER CARD

Physiographic Province: 03 Section: _____

Drainage Basin: 13C Subbasin: _____

Topo of well site: (D) depression, stream channel; (C) dunes, flat, hilltop, sink, swamp; (E) offshore, pediment; (P) hillside, terrace, undulating, valley flat; (R) dunes, flat, hilltop, sink, swamp; (K) (L) (V) _____

MAJOR AQUIFER: system _____ series K3 aquifer, formation, group EZ

Lithology: _____ Origin: U5 Aquifer Thickness: 6 ft

Length of well open to: 140 ft Depth to top of: 380 ft

MINOR AQUIFER: system _____ series _____ aquifer, formation, group _____

Lithology: _____ Origin: _____ Aquifer Thickness: _____ ft

Length of well open to: _____ ft Depth to top of: _____ ft

Intervals Screened:

Depth to consolidated rock: _____ ft Source of data: _____

Depth to basement: _____ ft Source of data: _____

Surficial material: _____ Infiltration characteristics: _____

Coefficient Trans: _____ gpd/ft² Coefficient Storage: _____

Coefficient Perm: _____ gpd/ft²; Spec cap: _____ gpm/ft; Number of geologic cards: _____

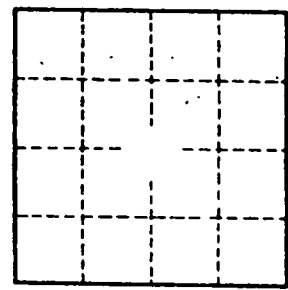
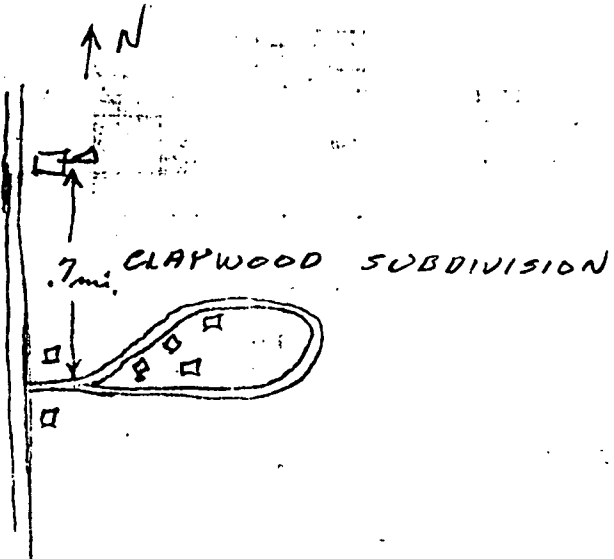

Well No. K59

VERONA QUAD

