

WRD Exp. (Rev)  
April 1966

6W00660  
0410016-01

WELL SCHEDULE  
GEOLOGICAL SURVEY

WATER RESOURCES DIVISION  
E 109 #11

U. S. DEPT. OF THE INTERIOR

GEOLOGICAL SURVEY

WATER RESOURCES DIVISION

L-13 well color Verona well

K 13

Verona

TRANSMITTED FOR ADP

MASTER CARD

Record by ELLISON Source of data DRL + OBS Date 3/1/60 Map Verona

State 28 County (or town) LEE 41

Latitude: 34 12 04 N Longitude: 08 43 22 W Sequential number: 1

Lat-long accuracy: 1 T. 10 S. R. 5 W. Sec 24 SE 1 NW 1 SE 1 NE 1

Local well number: 0130A2410505E Other number: B & M

Local use: 064011 Owner or name: Town of Verona

Owner or name: VERONA Address: Well # 81

Ownership: County, Fed Gov't, City, Corp or Co, Private, State Agency, Water Dist M

Use of water: (A) Air cond, Bottling, Comm, Dewater, Power, Fire, Dom, Irr, Med, Ind, P S, Rec, (S) Stock, Inact, Unused, Repressure, Recharge, Desal-P S, Desal-other, Other U

Use of well: (A) Anode, Drain, Seismic, Heat Res, Obs, Oil-gas, Recharge, Test, Unused, Withdraw, Waste, Destroyed, (D) (G) (H) (I) (M) (N) (P) (R) (T) (U) (W) (X) (Z) W

DATA AVAILABLE: Well data 70 Freq. W/L meas.: N Field aquifer char. 71

Hyd. lab. data: 73

Qual. water data; type: 74

Freq. sampling: 75 Pumpage inventory: no period: 76

Aperture cards: 77

Log data: E LOG #11 DRLG DE

WELL-DESCRIPTION CARD

SAME AS ON MASTER CARD Depth well: 522 ft Meas. DRL 3

Depth cased: (first perf.) 457 ft Casing type: 70 ; Diam. 10 in 10

Finish: (C) porous concrete, (F) gravel w. (perf.), (G) gravel w. (screen), (H) horiz. gallery, end, (I) open perf., (S) screen, (T) sd. pt., (W) shored, (X) open hole, (Z) other 31

Method Drilled: (A) air bored, (B) cable, (C) dug, (D) hyd jetted, (H) air rot., (J) percussion, (P) rotary, (R) reverse, (T) trenching, (V) driven, (W) drive wash, (Z) other H

Date Drilled: 960 Pump intake setting: 33 ft 38

Driller: LAUNE CENTRAL, MEMPHIS TENN

Lift (type): (A) air, (B) bucket, (C) cent, (J) jet, (L) multiple, (M) multiple, (N) none, (P) piston, (R) rot, (S) submerg, (T) turb, (Z) other T Deep 39 Shallow 40

Power (type): diesel, elec gas, gasoline, hand, gas, wind; H.P. 20 V Trans. or meter no. 41

Descrip. MP 345 probably ft above below LSD, Alt. MP 47

Alt. LSD: 352 Accuracy: (source) 47 4

Water Level: ft above below MP; Ft above below LSD 48 31 Accuracy: 52

Date meas: 53 35 Yield: 53 gpm 60 Method determined 61

Drawdown: ft 62 64 Accuracy: 65 Pumping period: 66 hrs 68

QUALITY OF WATER DATA: Iron ppm 69 Sulfate ppm 70 Chloride ppm 71 Hard. ppm 72

Sp. Conduct 73 K x 10 74 Temp. °F 76 Date sampled 77 79

Taste, color, etc. 78

WELL NO.

K 13

Well No. K 13

Latitude-longitude \_\_\_\_\_  
d m s d m s

HYDROGEOLOGIC CARD

SAME AS ON MASTER CARD Physiographic Province: 03 Section: \_\_\_\_\_  
19 20 21  
D Drainage Basin: 13C Subbasin: \_\_\_\_\_  
22 23 25 26

(D) (C) (E) (F) (H) (K) (L)  
Topo of well site: depression, stream channel, dunes, flat, hilltop, sink, swamp,  
(Φ) (P) (S) (T) (U) (V)  
offshore, pediment, hillside, terrace, undulating, valley flat \_\_\_\_\_ 27 H

MAJOR AQUIFER: \_\_\_\_\_ system \_\_\_\_\_ series K 3 \_\_\_\_\_ aquifer, formation, group M 5 28 29 30 31

Lithology: \_\_\_\_\_ U 5 Origin: \_\_\_\_\_ 6 Aquifer Thickness: \_\_\_\_\_ ft 32 33 34

Length of well open to: \_\_\_\_\_ ft 60 Depth to top of: \_\_\_\_\_ ft \_\_\_\_\_ 35 37 38 40 41 43

MINOR AQUIFER: \_\_\_\_\_ system \_\_\_\_\_ series \_\_\_\_\_ aquifer, formation, group \_\_\_\_\_ 44 45 46 47

Lithology: \_\_\_\_\_ \_\_\_\_\_ Origin: \_\_\_\_\_ \_\_\_\_\_ Aquifer Thickness: \_\_\_\_\_ ft 48 49 50

Length of well open to: \_\_\_\_\_ ft \_\_\_\_\_ Depth to top of: \_\_\_\_\_ ft \_\_\_\_\_ 51 53 54 56 57 59

Intervals Screened: 460 - 520

Depth to consolidated rock: \_\_\_\_\_ ft \_\_\_\_\_ Source of data: \_\_\_\_\_ 64

Depth to basement: \_\_\_\_\_ ft \_\_\_\_\_ Source of data: \_\_\_\_\_ 69

Surficial material: \_\_\_\_\_ Infiltration characteristics: \_\_\_\_\_ 70 71 72

Coefficient Trans: \_\_\_\_\_ gpd/ft \_\_\_\_\_ Coefficient Storage: \_\_\_\_\_ 73 75 76 78

Coefficient Perm: \_\_\_\_\_ gpd/ft<sup>2</sup>; Spec cap: \_\_\_\_\_ gpm/ft; Number of geologic cards: \_\_\_\_\_ 79

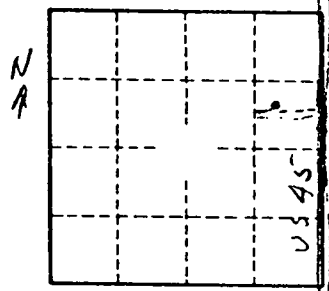

Entw

Well No.

K 13

DEPARTMENT OF ENVIRONMENTAL QUALITY - OLWR  
PUBLIC SUPPLY WELLS PROJECT

GPS LOG

USER NAME(S): Jennings / Phillips DATE: 10/27/98

UNIT DEQ #: \_\_\_\_\_ FILE #: B102721B

HEALTH DEPT. #: 410016-01 ELEV. 342

USGS #: K13 OLWR #: GW00660

OWNER: Verona QUAD: Verona

LOCATION: SE/NE S 24 T 10S R 5E COUNTY: Lee

LOCATION DESCRIPTION: At old elevated tank at end  
of Tenth St.

CASING DIA: \_\_\_\_\_ PUMP TYPE & SIZE: Turbine; 30 HP

GPS FIELD LOCATION: LAT. 34° 12' 3.9" LONG. 88° 43' 20.9"

GPS CORRECTED LOCATION: LAT. 34.201029 LONG. 88.722856

REMARKS: measured 15' from well

\_\_\_\_\_  
\_\_\_\_\_  
\_\_\_\_\_

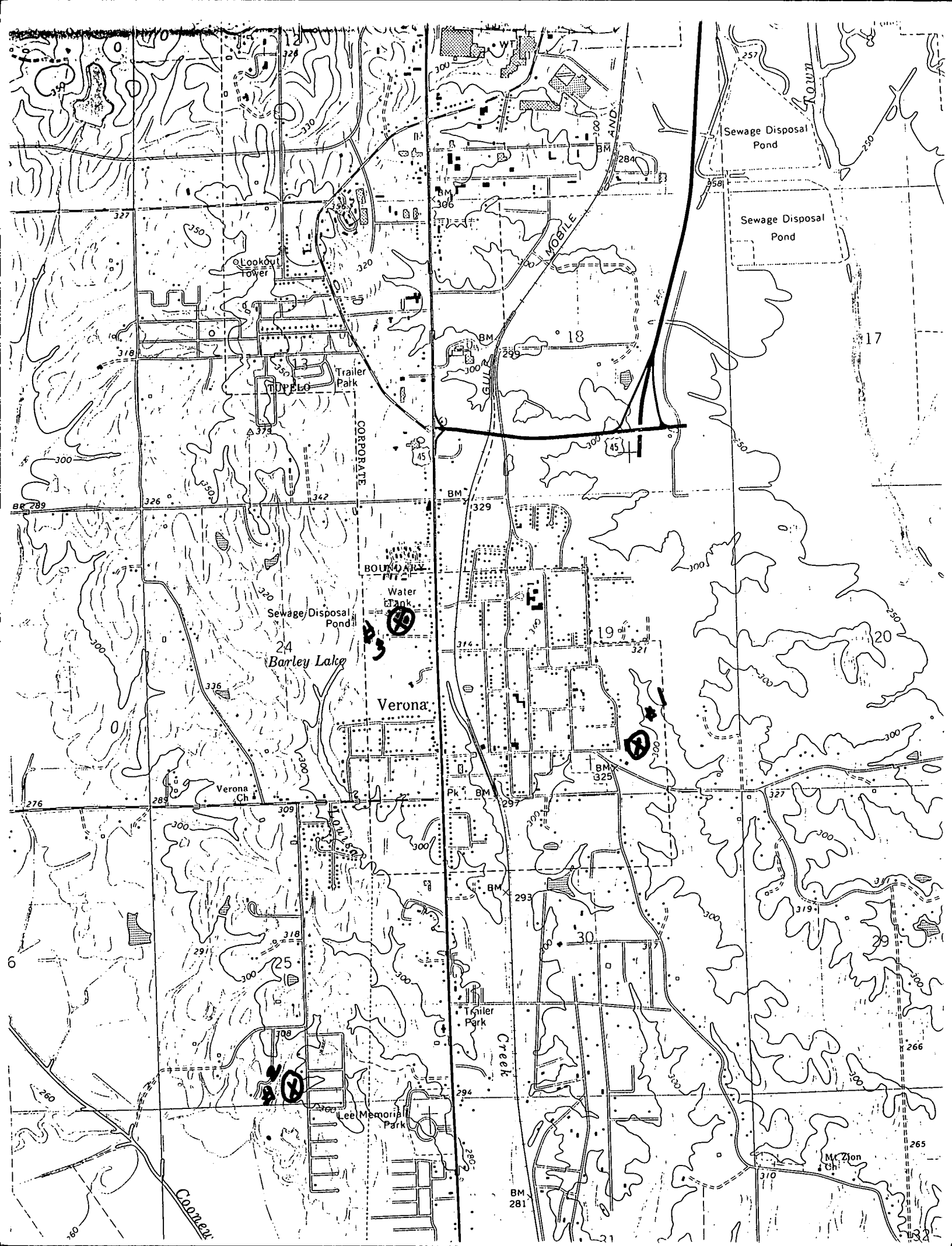

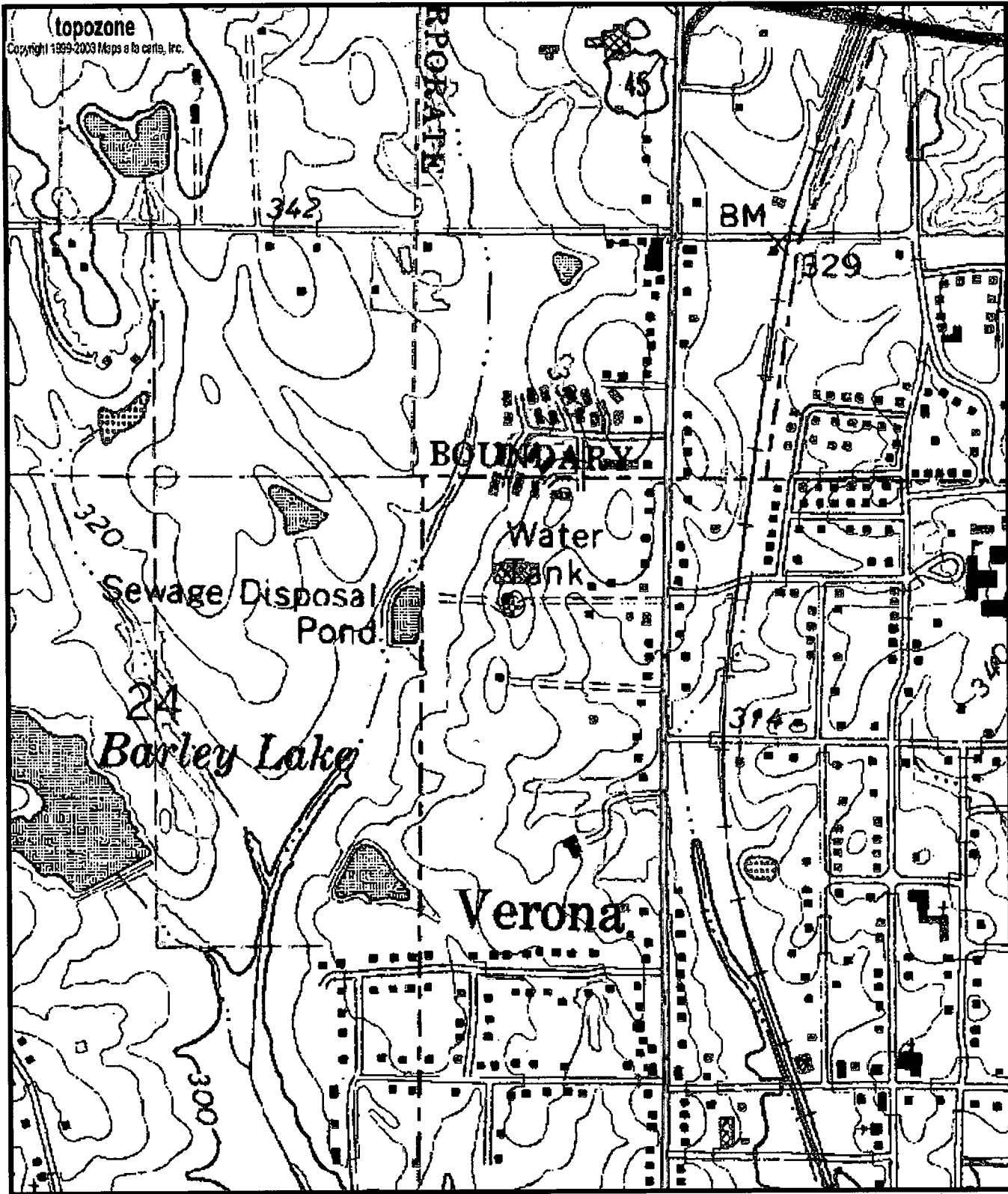

K13  
 6W00660  
 0410016-01

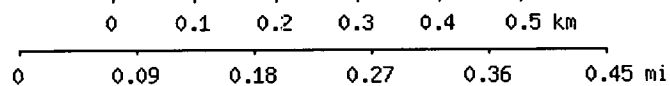

Map center is 34° 12' 04"N, 88° 43' 22"W (WGS84/NAD83)  
**Verona** quadrangle  
 Projection is UTM Zone 16 NAD83 Datum

M=-0.861  
 G=-0.969